

# 360 Smart Camera

→ User Manual ←

## Product Appearance

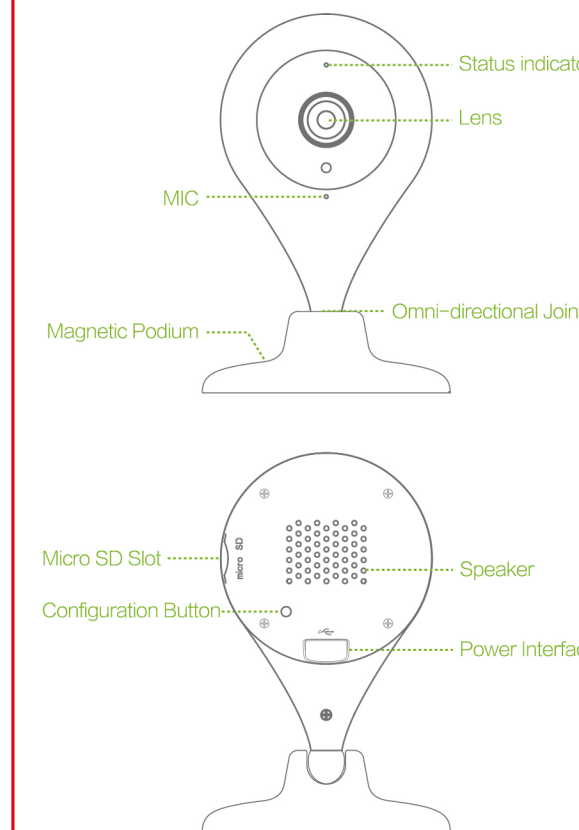

## User Guide

### 1. Connect with power

(1) Insert power line into power interface which behind the camera. When the status indicator lamp turns green, shows the camera start working.

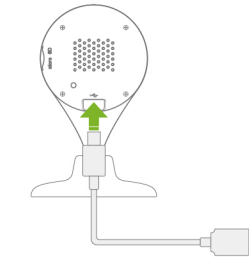

(2) Please make sure your phone has connected to internet.

### 2. Download 360 Smart Camera APP

- from Google Play
- or from Apple Store
- or scan the barcode below



### 3. Add camera

(1) Open 360 Smart Camera APP, click "register" button and start register an account. If you already have an account, login directly.

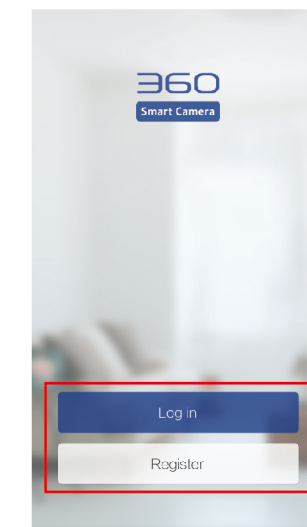

(2) After login, click "+" button which on the right-top corner of screen. Click on "connect to my camera" and follow the voice prompts to complete.

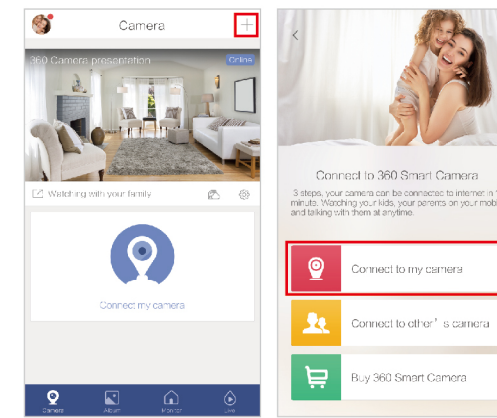

Remarks: During the connection, please pay attention to below tips:

- During acoustic matching, please keep away from noisy environment.
  - Make sure the camera connect to 2.4GHz frequency band WiFi.
  - Please turn off MAC Address Filter function in WiFi router, otherwise the camera may not be connected successfully.
  - The camera temporarily not supports WPA/WPA2 enterprise-class WiFi, please select other options.
  - Suggest connecting nonbridging contact WiFi.
- (3) After adding successfully, start your discovery.

### 4. Fixed camera

- Option 1: Camera can be put on the table.
  - Option 2: The bottom of the camera has a magnetic sticker can be stick to metal surface, such as refrigerator, metal window etc. Warning: Don't put camera on hard disk or computer.
  - Option 3: Use 3M sticker to stick the camera on glass, ceramic glossy wall surface.
- Remark: Mounting accessories and 4 Meters USB cable are available in local Authorized Distributors.



### Packing List

- Please check if all following items are intact.
- 1) Camera x1
  - 2) USB cable x1
  - 3) User Manual x1
  - 4) 3M double sided foam sheet x1
  - 5) Adapter x1

### Product Description

- (1) 720P(1280\*720) high definition provides superb performance and bright luminosity. Night vision mode can be automatically activated as need and the viewing window will be switched to black&white mode.
- (2) When night vision mode is switched on/off, a clicking sound will be heard as internal filter changes.
- (3) No visible light will be generated during night vision mode.

## FAQ

- Q1: How many modes does the indicator have?
- Constant Green Camera activated
  - Flashing Green Configuring WiFi or Camera is off-line
  - Constant Blue Camera on-line
  - Flashing Blue Video being viewed

Q2: Is it normal for the camera to run hot?

Low level of heat is a normal phenomenon during working status. Working temperature may ranges from -5°C to 40°C.

Q3: Announcements

In order to get a better night vision imaging results, please don't put the camera in front of or close to the glass, white walls or other reflective objects. or you will see the picture bright in the vicinity and dark in the distance or white full of the screen.

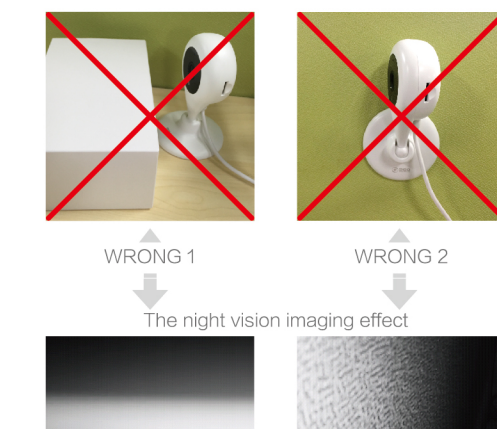

### Correct Demonstration

When you put the camera on the wall or on the table, please make sure none of the obstructions are in front of or close to the camera.



RIGHT1  
RIGHT2  
The night vision imaging effect



## Important Notice

### 1. Privacy Security

For the security of yourself and your family, please ensure that your camera is not binding to unauthorized persons. 360 commit to the strictest measures to guarantee that your personal information and privacy is not released.

### 2. Hazardous substances description

Hazardous substance and element	Camera	Accessories
Lead (Pb)	×	×
Mercury (Hg)	○	○
Cadmium (Cd)	○	○
Hexavalent chromium (Cr (vi))	○	○
Polybrominated Biphenyl (PBB)	○	○
Polybrominated Diphenyl Ethers (PBDE)	○	○

Note 1: Camera body, adaptor and power cable contain electric components (HV Resistor, Ceramic Resistor, diode, etc.) that have Pb quantity greater than 0.1%. The nails of the camera body and the core wires in the data cable may have Pb quantity greater than 0.1% due to high-performance considerations. All of these items comply with the exemption conditions of EU's RoHS directive, and no alternative technologies or components can be applied at present.

Note 2: Environment-friendly Use Period: Camera body, 10 years; Accessories, 10 years. The EFUP is the safety period and number of years when the camera is used as per the instructions of this manual without any leakage of hazardous substances.

- : All components contain hazardous substances below the directive limit of SJ/T11363-2006.
- × : At least one component contains hazardous substances beyond the directive limit of SJ/T11363-2006.

## After-sales Service

### 1. Warranty policy of 360 Smart Camera

This product comes with a One-year Carry-in Limited Local Warranty Service. For detail of warranty service, please kindly contact local Authorized Distributors in your country.

### 2. Non warranty policy of 360 Smart Camera

- (1) Cannot present valid warranty certificate and purchase invoice.
- (2) Damages which result from improper use or handle, water damage, unauthorized maintenance or modification.
- (3) Damage because of force majeure.
- (4) Normal decoloration and wastage during usage will not be included into warranty service.

### Contact with us

Official website: <http://jia.mail.360.com>  
 Official forum: <http://shequ.mail.360.com>  
 Customer service address: 360jia@360.cn  
 Customer service hotline: 400-6822-360(China)

## FCC STATEMENT

1. This device complies with Part 15 of the FCC Rules. Operation is subject to the following two conditions:

- (1) This device may not cause harmful interference, and
- (2) This device must accept any interference received, including interference that may cause undesired operation.

2. Changes or modifications not expressly approved by the party responsible for compliance could void the user's authority to operate the equipment.

NOTE: This equipment has been tested and found to comply with the limits for a Class B digital device, pursuant to Part 15 of the FCC Rules. These limits are designed to provide reasonable protection against harmful interference in a residential installation.

This equipment generates uses and can radiate radio frequency energy and, if not installed and used in accordance with the instructions, may cause harmful interference to radio communications. However, there is no guarantee that interference will not occur in a particular installation. If this equipment does cause harmful interference to radio or television reception, which can be determined by turning the equipment off and on, the user is encouraged to try to correct the interference by one or more of the following measures: Reorient or relocate the receiving antenna. Increase the separation between the equipment and receiver. Connect the equipment into an outlet on a circuit different from that to which the receiver is connected. Consult the dealer or an experienced radio/TV technician for help.

FCC Radiation Exposure Statement  
 This equipment complies with FCC radiation exposure limits set forth for an uncontrolled environment. This equipment should be installed and operated with minimum distance 20cm between the radiator & your body.

## 360 Smart Camera warranty certificate

1. User Information  
 Name \_\_\_\_\_ Telephone No. \_\_\_\_\_  
 E-mail \_\_\_\_\_ Post Code \_\_\_\_\_  
 Mailing Address \_\_\_\_\_

2. Product Information  
 Color \_\_\_\_\_  
 SN \_\_\_\_\_

3. Repair Record

Repair Record	Fault Phenomenon	Accepted Date	Signature of Repair Engineer