

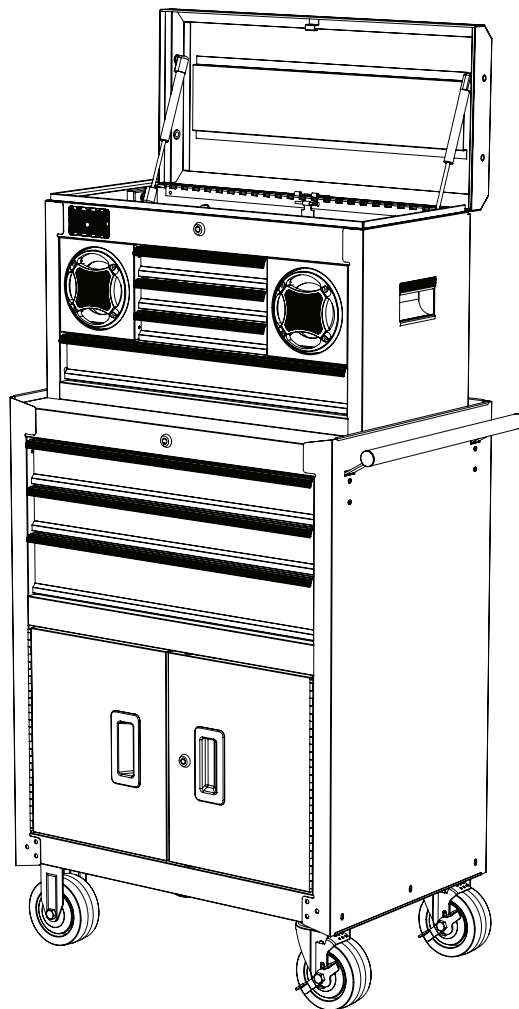

## Operator's Manual

## 26" (66 cm) 2-IN-1 BLUETOOTH® SPEAKER CHEST & CABINET COMBO

PMN: 26" (66 cm) 2-IN-1 BLUETOOTH® SPEAKER CHEST & CABINET COMBO

**IMPORTANT:**

Please read this manual carefully before using this 2-in-1 Bluetooth® Speaker Chest & Cabinet Combo and save it for reference.



# TABLE OF CONTENTS

<b>SAFETY WARNINGS AND CAUTIONS</b>	<b>1</b>
---	----------

---

<b>PARTS AND HARDWARE</b>	<b>2</b>
---------------------------	----------

---

<b>ASSEMBLY INSTRUCTIONS</b>	<b>3</b>
------------------------------	----------

---

<b>BRIEF INTRODUCTION OF BLUETOOTH® SPEAKERS</b>	
INDICATOR LIGHT AND VOICE PROMPT	<b>7</b>

---

<b>OPERATION OF BLUETOOTH® SPEAKERS</b>	<b>8</b>
---	----------

---

<b>TROUBLESHOOTING</b>	<b>9</b>
------------------------	----------

---

<b>STATEMENT</b>	<b>10</b>
------------------	-----------

---

Manufactured by  
**MERIDIAN INTERNATIONAL CO., LTD.**  
Shanghai, China 201615  
1 877 844-8572 | [www.tactixtools.com](http://www.tactixtools.com)  
Made in China

# SAFETY WARNINGS AND CAUTIONS



**WEAR SAFETY GLASSES AND GLOVES WHEN REMOVE STRAPPING AND PACKAGING MATERIALS. STRAPS CAN SNAP WHEN REMOVED CAUSING PERSONAL INJURY.**

- 1 WEAR SAFETY GLASSES** when replacing or repositioning ball bearing drawer slides.
- 2 DO NOT** pull this product, but push the product to prevent personal injury. Swivel caster and push bar must be placed on same side of the product.
- 3 USE THE BRAKE** when this product is not being moved. The brake will prevent accidental rolling which may cause product damage or personal injury.
- 4 DO NOT** open more than one drawer at a time as this may cause the product to tip causing personal injury or product damage.
- 5 DO NOT** alter this product by welding attachments or adding electrical equipment. Do not mount this product on a moving object or vehicle as this may cause personal injury or product damage.
- 6 DO NOT** tow this product with moving equipment or vehicles as this may cause product to tip, causing personal injury or product damage.
- 7 DO NOT** step in drawers or on top of the unit as this may cause the product to tip. This may cause personal injury or product damage.
- 8** Take caution when closing the chest lid and remove your hands before chest lid is closed completely.
- 9** Maximum loading per drawer of the top chest should not exceed 22 lb. (10 kg).  
Maximum loading per drawer of the bottom cabinet should not exceed 66 lb. (30 kg).
- 10** Maximum product weight (including contents) should not exceed 772 lb. (350 kg).
- 11** To lock a chest, close drawers before closing chest lid, and make sure all drawers are firmly closed to ensure proper function of locking bars.
- 12** Always use the proper sized cabinet and chest combination. Improper matching of cabinet and chest components can cause the product to tip which may result in personal injury or product damage.
- 13 DO NOT** use the product on uneven surfaces or inclines as this may cause the product to tip or become unstable resulting in possible personal injury or product damage.

# PARTS AND HARDWARE



M6 x 12 PH Head

4 pcs



M8 Locking Washers

16 pcs



M8 x 25 Hex Head

16 pcs



M8 Washers

16 pcs

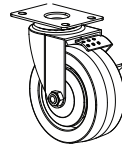

Locking Castors

2 pcs

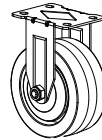

Castors

2 pcs

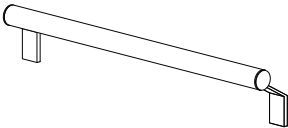

Handle Bar

1 pc



USB Charging Cable

1 pc

## MAINTENANCE

- 1 Automobile waxes will protect and preserve the metal finish of your garage product. Using the standard application instructions, apply wax regularly to your garage product to protect against scratching.
- 2 Use a soft, clean cloth and standard cleaning solutions to remove grease, dirt or oil. Do not use solvents or flammable cleaning liquids.
- 3 Lubricate slides with petroleum jelly twice yearly.
- 4 Lubricate castors with high-quality grease annually.
- 5 Use graphite to lubricate locks yearly.
- 6 Drawer fronts, trim and other surfaces may be cleaned with a mild detergent and water.

# ASSEMBLY INSTRUCTIONS

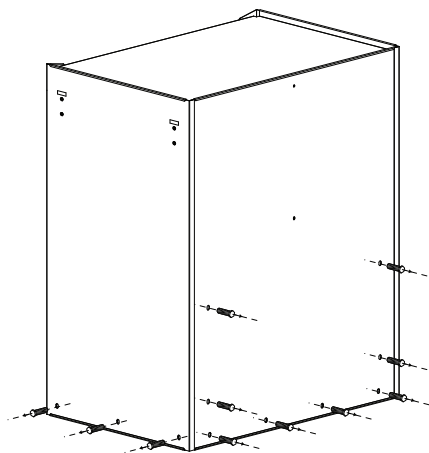

- ❶ Remove the packaging
- ❷ Remove the upper 4 pre-installed bolts (M6x12) from the back panel.
- ❸ Remove the 16 pre-installed bolts from the front, back and side panels of the cabinet. Save these 16 bolts for assembly step 6.

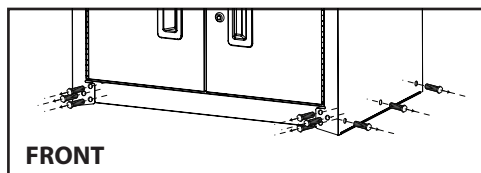

- ❹ Lift off the base cabinet, exposing the top chest.
- ❺ Remove the top chest and set aside.
- ❻ Re-install the bottom plate with the 16 bolts from step 3.

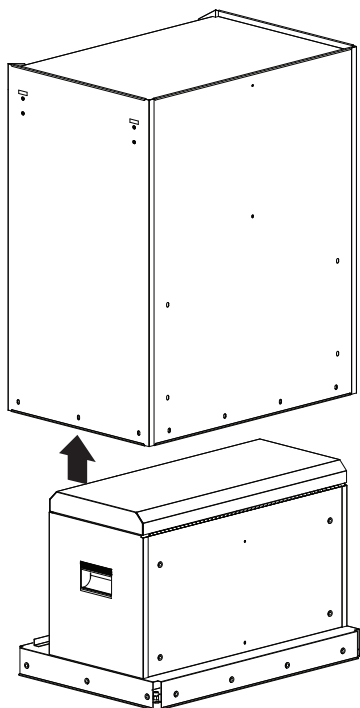

**Caution:**  
2-person lift required.



# ASSEMBLY INSTRUCTIONS

- 7** Lay down bottom cabinet.
- 8** Install castors with 4 hex bolts (M8 x 25) per castor. Ensure swivel castors are installed on the same side as the push handle.

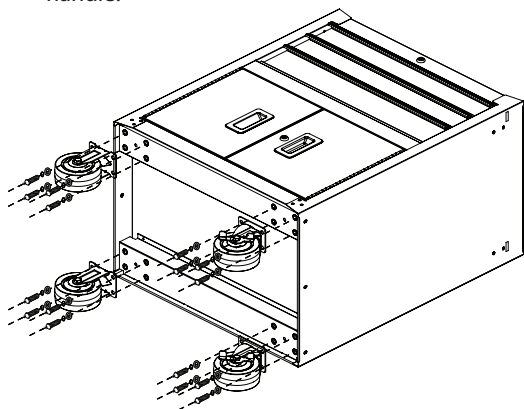

- 9** Insert the handle bar into the square holes of the side.
- 10** Install the 4 PH bolts (M6 x 12).

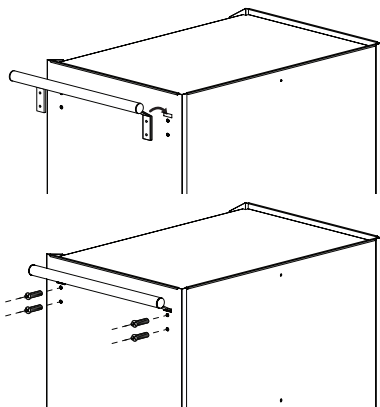

- 11** Place the chest on the cabinet.

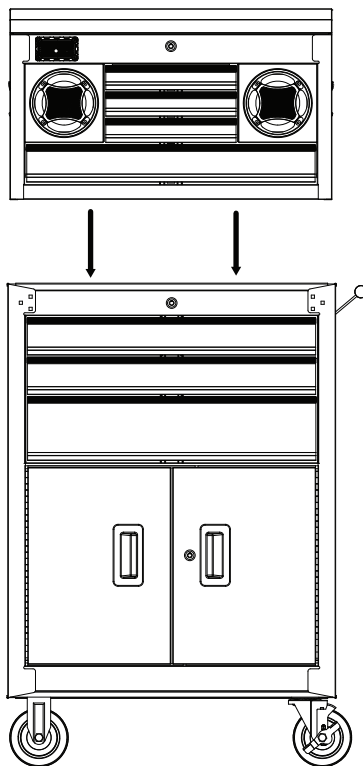

**Caution:**  
2-person lift required.

# ASSEMBLY INSTRUCTIONS

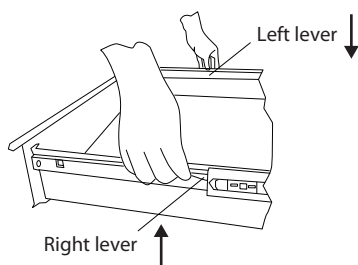
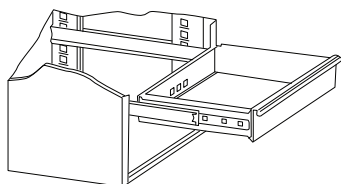

## OPERATION:

### REMOVE THE DRAWER OF THE CHEST AND CABINET.

Empty the drawer.  
Fully extend drawer.  
Left side: push the locking tab down and hold.  
Right side: pull the locking tab up and hold.  
Pull out the drawer to remove.

### RE-INSTALL THE DRAWER OF THE CHEST AND CABINET.

To re-install, extend the drawer slides and bearings in the cabinet to the fully opened position. Align the drawer slides with the extended cabinet slides and push the drawer into the slides until it stops.

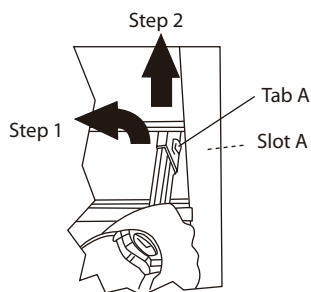

### REMOVE THE SLIDE OF THE CHEST AND CABINET.

To remove the slide from the unit, first remove the drawer (follow the drawer removal procedure). Turn the slide to left (right) and hold. Push the slide up to disengage Tab "A" from Slot "A". Push the slide to release Tab "B" from Slot "B". The slide may now be removed.

### RE-INSTALL THE SLIDE OF THE CHEST AND CABINET.

To re-install the slide, place the slide in the appropriate position, push the slide and engage Tab "B" into Slot "B", then push the slide down to lock Tab "A" into Slot "A".

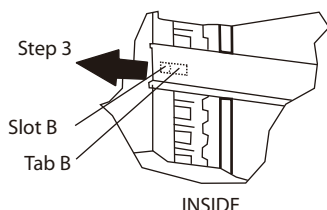



# ASSEMBLY INSTRUCTIONS

## AA Battery installation

- ❶ Remove the metal part 1.
- ❷ Remove the plastic part 2.
- ❸ Install 3 AA batteries into the battery tray.
- ❹ Re-install part 1 and part 2.

(The batteries are not included.)

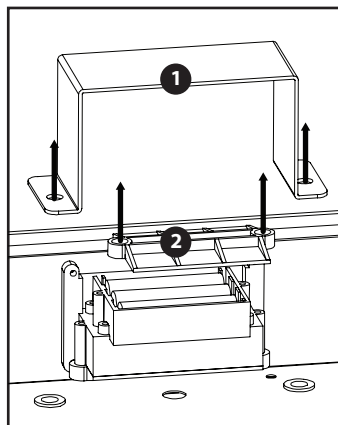

Detail of the circled area.

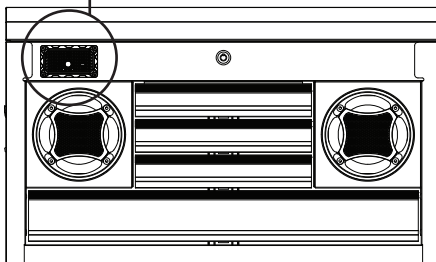

## WARNING

**WHEN USING RECHARGEABLE AA BATTERIES**, use USB charging cable to recharge the batteries.  
**WE RECOMMEND** using 1800mAh or higher capacity AA rechargeable batteries.  
**DO NOT** charge non-chargeable batteries with the USB charging cable.

# BRIEF INTRODUCTION OF BLUETOOTH® SPEAKERS

## INDICATOR LIGHT & VOICE PROMPT



Bluetooth® Speaker Control Panel

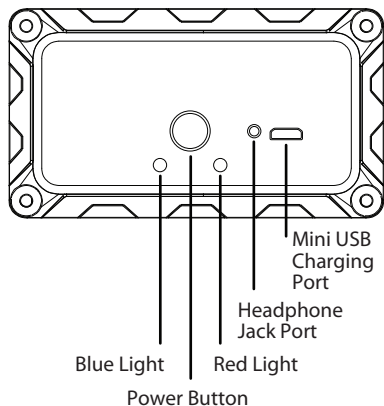

### Charging Mode (red light)

- Remains on when the batteries are charging.
- Turns off when the batteries are fully charged or power off.
- ☀ Flashes when the batteries are not working or out of position.

### Working Mode (blue light)

- Remains on when connected.
- Turns off when power is off.
- ☀ Flashes when power is on and ready to connect.

### Voice Prompt

Power On  
Pairing  
Connect  
Disconnect

## FUNCTIONS AND TECHNICAL SPECIFICATIONS:

- Internal circuit board size: 2 3/4 x 1 3/8 x 1/16" (69.6 x 32.2 x 1.2 mm)
- Weight (battery not included): about 2.12 oz (60 g)
- Multi-functional button
- Charging indicator (red)
- Working indicator (blue)
- Microphone
- Speaker unit: 2 x 4" (5 x 10.1 cm), 4 Ω, 3 W
- Charging current: <800 mA
- Current:
  - ① Working current <1.0 A (Fluctuates with volume and pitch)
  - ② Working voltage range: 3.6-4.2 V (3 x 1.2 V rechargeable AA batteries)
- Audio input: Bluetooth® audio 2.1+edr. The maximum operating range is 33' (10 m) (actual distance depends on the environment).



# OPERATION OF BLUETOOTH® SPEAKERS

1. Plug the speaker to the power through the cable and an adaptor.
  - a. If there are batteries installed, press and hold POWER button for 2 seconds until the blue light flashes indicating it has started working and ready to connect other Bluetooth® devices.
  - b. If batteries are not installed, please wait 5-10 minutes till the red light dies out for the internal electronic components to charge. Then press the POWER button for 2 seconds until the blue light flashes indicating it has started and ready to connect other Bluetooth® devices.
2. Turn on the Bluetooth® of your device (tablets, smart phone, computer, etc.) and search for the speaker (BT-BOX). Pair to the device to connect. Voice prompts "connect" when connected. (Code is generally not needed. If pairing code is required, input 0000).
3. When it's matched successfully, the blue light stays on to indicate connection; all the paired devices will engage automatically next time. **Note:** the speaker automatically seeks connection within 10 seconds after entering the Bluetooth® connecting mode, after that please do it manually.
4. Volume is adjusted on the device. To pause or continue the music, use a short press of the POWER button.
5. After connecting, press POWER button to pick up incoming calls. Volume is adjusted on the device. Face the microphone input when speaking for clear sound pickup.
6. Press and hold the POWER button for more than 2 seconds and less than 30 seconds to turn off the speaker. If pressed for more than 30 seconds, it prompts "disconnect" and then enters into re-pairing mode.
7. Low battery (when batteries are installed): the speaker will prompt "low battery" when the battery is low. It will power off if not charged. To maintain battery life, charge once per month even if not in frequent use.
8. Use an adaptor (5 V,  $\geq 1$  A) or a power bank or a laptop and the supplied cable for power supply and charging. It takes 4 to 12 hours to charge AA batteries (depending on the capacity of the battery).
9. In order to properly use the speaker and ensure its best performance, please read instructions.
  - DO NOT** hit the speaker.
  - NEVER USE** chemicals such as benzene and diluents around speaker.
  - KEEP AWAY** from strong magnetic and electrical fields.
  - KEEP AWAY** from direct light or heat.
  - DO NOT** take apart, repair or renovate by yourself.
  - Keep the sound at reasonable volume to protect your ears.
  - Please dispose of the packaging, battery and electronic waste according to your local regulations.



**1. Q: When on maximum volume, it prompts "Low Battery".**

A: Battery is low. Turn down the volume or charge for two hours before using it again.

**2. Q: The speakers power off after being turned on.**

A: Battery is low, please charge. Another possibility is cable and/or adaptor is not properly connected if there is no battery installed.

**3. Q: Blue light keeps flashing before automatic power off or rebooting.**

A: Battery is low, recharge. Another possibility is the cable and/or adaptor is not properly connected.

**4. Q: Cannot be charged.**

A: Check connection of the adaptor and the cable.

**5. Q: Red light does not turn on or looks dim when in charging.**

A: This is normal; the red light gets dimmer as the voltage gets higher in charging.

**6. Q: No sound comes from the speaker.**

A: Ensure it has been successfully connected to the device, and check the volume setting on the device.

**7. Q: The Bluetooth® connection cannot connect automatically or fails to connect.**

- A:
1. Only previously paired devices will connect automatically.
  2. It takes 10 seconds for the Bluetooth® to work after power on.
  3. Some Bluetooth® devices might not be able to connect due to different Bluetooth® configurations.
  4. The device might be too far from the speaker, or blocked by walls and/or other obstacles.

**8. Q: The button does not work or other malfunctions.**

A: Reboot devices.

The Bluetooth® word mark and logos are registered trademarks owned by the Bluetooth SIG, Inc. and any use of such marks by Meridian International Co., Ltd. is under license. Other trademarks and trade names are those of their respective owners.



## STATEMENT

1. This device complies with part 15 of the FCC Rules. Operation is subject to the condition that this device does not cause harmful interference.
2. This device complies with part 15 of the FCC Rules. Operation is subject to the following two conditions:
  - (1) This device may not cause harmful interference, and
  - (2) this device must accept any interference received, including interference that may cause undesired operation.
3. Please note that changes or modifications not expressly approved by the party responsible for compliance could void the user's authority to operate the equipment.
4. This equipment has been tested and found to comply with the limits for a Class B digital device, pursuant to part 15 of the FCC Rules. These limits are designed to provide reasonable protection against harmful interference in a residential installation. This equipment generates, uses and can radiate radio frequency energy and, if not installed and used in accordance with the instructions, may cause harmful interference to radio communications. However, there is no guarantee that interference will not occur in a particular installation. If this equipment does cause harmful interference to radio or television reception, which can be determined by turning the equipment off and on, the user is encouraged to try to correct the interference by one or more of the following measures:
  - Reorient or relocate the receiving antenna.
  - Increase the separation between the equipment and receiver.
  - Connect the equipment into an outlet on a circuit different from that to which the receiver is connected.
  - Consult the dealer or an experienced radio/TV technician for help.
5. This equipment complies with radio frequency exposure limits set forth by the FCC for an uncontrolled environment. This equipment should be installed and operated with a minimum distance of 20 cm between the device and the user or bystanders. This device must not be co-located or operating in conjunction with any other antenna or transmitter.