

ClearPad Glow

90mm

90mm



150mm

Back

Front

ClearPad Glow

90mm

90mm

INSTALL AND USE:

Peel off the protective film.

Insert the writing panel into the notch of the base.

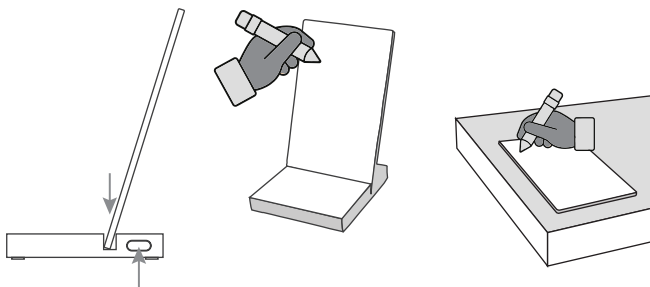

You can write while it is standing up or take it off and place it on a flat surface as well.

Only for use with Chalk Markers.

TURNING ON/OFF GLOW:

Use the included cable to plug ClearPad Glow into a USB power source (laptop, USB adapter, powerbank, etc.)

Press the button to turn on and off ClearPad Glow.

ADJUSTING BRIGHTNESS:

Press and hold to adjust the brightness of the glow. The brightness will cycle back to bright after reaching the lowest setting.

BUILT-IN BATTERY:

ClearPad Glow has a battery built in that will allow 2 hours of glow time.

ClearPad Glow will blink 3 times and turn off when it is time to charge.

CHARGING CLEARPAD GLOW:

Use the included charging cable to keep ClearPad Glow always on or to charge up the battery.

CLEANING INSTRUCTIONS:

Use a clean, dry cloth or tissue to simply wipe the chalk marker off.

Do not use any abrasive or household cleaners.

150mm

Inside

Inside

FCC Caution:

This device complies with part 15 of the FCC Rules. Operation is subject to the following two conditions: (1) this device may not cause harmful interference, and (2) this device must accept any interference received, including interference that may cause undesired operation.

Any changes or modifications not expressly approved by the party responsible for compliance could void the user's authority to operate the equipment.

NOTE: This equipment has been tested and found to comply with the limits for a Class B digital device, pursuant to Part 15 of the FCC Rules. These limits are designed to provide reasonable protection against harmful interference in a residential installation. This equipment generates, uses and can radiate radio frequency energy and, if not installed and used in accordance with the instructions, may cause harmful interference to radio communications.

However, there is no guarantee that interference will not occur in a particular installation.

If this equipment does cause harmful interference to radio or television reception, which can be determined by turning the equipment off and on, the user is encouraged to try to correct the interference by one or more of the following measures:

- Reorient or relocate the receiving antenna.
- Increase the separation between the equipment and receiver.
- Connect the equipment into an outlet on a circuit different from that to which the receiver is connected.
- Consult the dealer or an experienced radio/TV technician for help.

To maintain compliance with FCC's RF Exposure guidelines, This equipment should be installed and operated with minimum distance between 20cm the radiator your body: Use only the supplied antenna.