

材质: 封面 封面封底128G双铜 + 单色印刷
 内页臻品上质80g高白纸 2个小号骑马钉
 大约12页, 尺寸W 105 x H 75mm



User Manual

Wireless Dual Drivers Stereo Headset

Clari Air



www.avantree.com

1. Headset overview

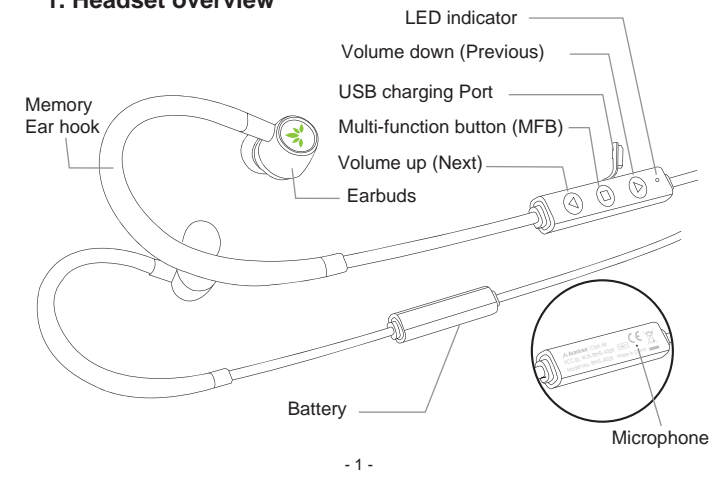

- 1 -

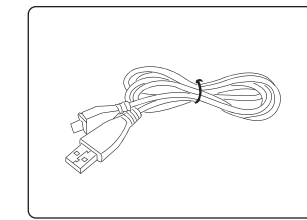

Micro USB charging cable

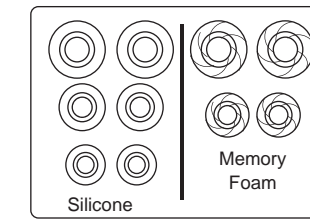

Ear tips

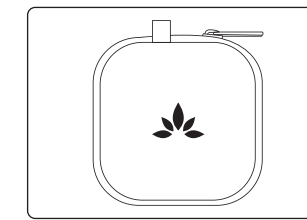

Hard case

- 2 -

2. Working with mobile phone

It is important to pair the headset with your Bluetooth enabled mobile phone for first time use.

2.1 Pairing one phone:

Step 1: Ensure the headset is off.

Step 2: Press and hold the power button (about 5 seconds) until the LED blinks blue and red alternately, you will hear the voice prompt "Power on" and "Pairing".

Step 3: Active Bluetooth on your phone and select "Avantree Clari Air" to connect, once connected you will hear the voice prompt "Connected".

Note: Once paired and connected, the headset will be automatically connected to your phone whenever you turn the headset on again, provided your phone is within range.

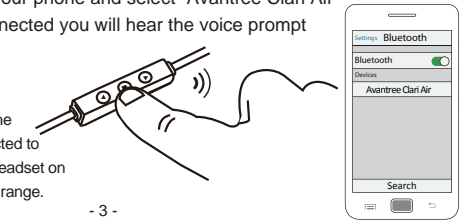

- 3 -

2.2 Connect with two mobile phones simultaneously

STEP 1 Connect headset with the first phone as above. Then turn off Bluetooth of the first phone.

STEP 2 Connect headset with the second phone as above. Then turn off the headset.

STEP 3 Turn on Bluetooth of the first phone. Then turn on the headset.

STEP 4 The headset will automatically connect to two phones. Otherwise it will automatically connect with the second phone, after that please tap from the first phone to manually connect it.

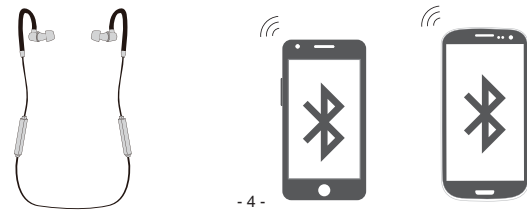

- 4 -

3. Fit

We recommend that you try each eartip (small, medium and large), perform a sound check and choose the eartip that gives the best sound experience.

STEP 1 Hold the headset as shown, green color ring on the left side and red one on the right.

STEP 2 Put the earbuds in your ears, adjust the position for maximum comfort and fit.

STEP 3 The ear loop can be rotated, rotate it to adjust the angle to achieve optimal fit and stability.

STEP 4 Drape the earbuds around the back of your neck and enjoy.

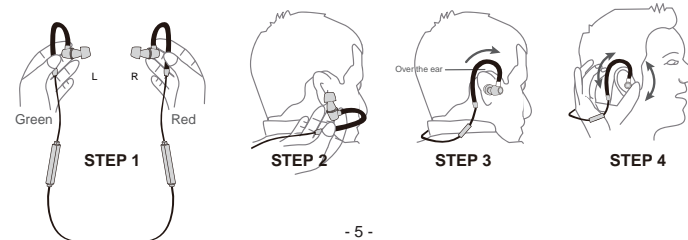

- 5 -

Note: Make sure your phone is in an armband / pocket / handbag on the right of your body. Otherwise, disconnection might be caused by your body blocking the Bluetooth signal.

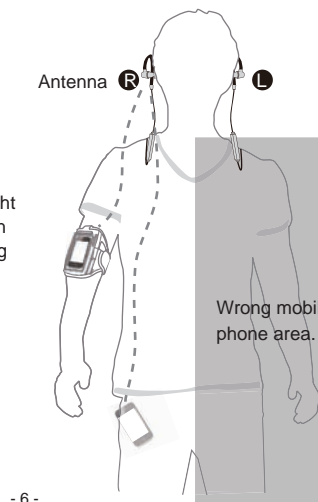

- 6 -

4. How to use

Button	Function	Operation
⏻	Power on	Press and hold MFB for 2 seconds, BLUE LED flashes
	Power off	Press and hold MFB for 3 seconds, RED LED flashes
	Pairing	Press and hold MFB for 5 seconds, RED and BLUE LED flashes alternately.
	Answer a call	Press MFB once
	Reject a call	Press and hold MFB for 1 second
	End a call	Press MFB once
🔊	Play music	Press MFB once
	Pause music	Press MFB once
⏮	Volume up	Short press ⏮ once
	Next track	Press and hold ⏮ for 1 second
⏭	Volume down	Short press ⏭ once
	Previous track	Press and hold ⏭ for 1 second

Note:

1. Some function may require to start the media player to play music at first.
 2. Press ⏮ or ⏭ to turn volume up or down, you will hear beep once reach the maximum or minimum volume.

- 7 -

5. How to reset

You may need to reset Clari Air if it is not working as expected. When Clari Air is reset to factory default settings, all the paired device information will be erased.

Under standby mode (power on but not connected), press V+ and V- buttons simultaneously for about 5 seconds, LED indicator flashes Blue & Red together (seems like pink) 2 times quickly and you will hear "disconnected", "power off", then successfully clear all paired list, the headset will enter pairing mode automatically after power on next time.

- 8 -

6 How to charge

When the LED blinks red, you should recharge your headset.

Remove the Micro USB port protector and charge the headset via the supplied Micro USB cable. It normally takes about 1.5 hours to fully charge the battery. The LED will stay red when charging. Once fully charged, the red LED will turn off and the blue LED will turn on.

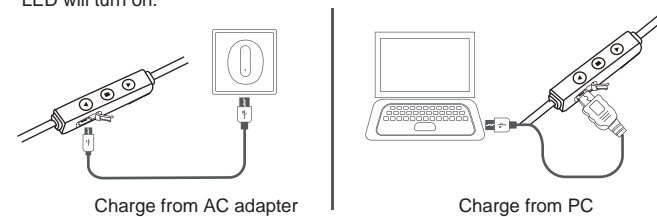

Charging requirement: You can plug our supplied Micro USB cable to your own USB chargers (wall charger/travel charger/car charger, etc) with 5V/500mA-2A or to a PC/Mac USB port. It is OK to use most mobile phone chargers on the market.

- 9 -

7. Product Specifications

Supported Profiles: Headset, Hands free, AVRCP, A2DP

Supported audio codec: SBC, AAC, APTX

Operational range: Class 2, up to 10 meters

Play time: up to 5 hours

Charge time: 1.5 hours

Weight: 21g

Earbud size: (L) 25mm * (D) 12mm

NOTE: The talk and standby time may vary when used with different mobile phones or other compatible Bluetooth devices and are also dependent on different usage styles, settings and operating environment.

Dispose of the packaging and this product in accordance with the latest provisions.



- 10 -



www.avantree.com
 support@avantree.com

Z-PKMN-AS20-V1

This device complies with part 15 of the FCC Rules. Operation is subject to the condition that this device does not cause harmful interference (1) this device may not cause harmful interference, and (2) this device must accept any interference received, including interference that may cause undesired operation.

Changes or modifications not expressly approved by the party responsible for compliance could void the user's authority to operate the equipment.

NOTE: This equipment has been tested and found to comply with the limits for a Class B digital device, pursuant to Part 15 of the FCC Rules. These limits are designed to provide reasonable protection against harmful interference in a residential installation. This equipment generates, uses and can radiate radio frequency energy and, if not installed and used in accordance with the instructions, may cause harmful interference to radio communications. However, there is no guarantee that interference will not occur in a particular installation. If this equipment does cause harmful interference to radio or television reception, which can be determined by turning the equipment off and on, the user is encouraged to try to correct the interference by one or more of the following measures:

- Reorient or relocate the receiving antenna.
- Increase the separation between the equipment and receiver.
- Connect the equipment into an outlet on a circuit different from that to which the receiver is connected.
- Consult the dealer or an experienced radio/TV technician for help.

The device has been evaluated to meet general RF exposure requirement. The device can be used in portable exposure condition without restriction.

FCC ID: 2AITF-BTHSAS20BLK