

Model : PGST-PG-500

Alarm Host



Official website link



Google play link



User Manual

Contents

1.Function Introduction...	2
2.Features	3
3.Installation	5
4.Mobile phone APP.....	8-16
Mobile phone	
APP download	
Configuration	
APP Operation	
5.Function Setting.....	17-27
Initialization	
System Setting	
Return Setting	
6.Daily operation	28
7.Remote Control.....	29
8.SOS.....	30
9. Maintenance.....	31
10.Technical parameters.....	32
11.Notes	32

1.Function Introduction

- support APP Push,SMS push voice monitoring and other multi-channel alarm mode.
- 8 wired defense zones,200 wireless defense zones 【support for renaming】
- Up to learn 8 wireless remotes.
- LCD display with built-in clock,intuitive and convenient
- The whole process of real voice prompts,installation settings and daily operations are more user-friendly.
- Automatically send message when low battery.
- Ac power failure and AC recovery SMS prompt
- Built-in intercom speaker, can realize duplex intercom function.
- Built-in 433 transceiver module, which can be linked to wireless siren and smart home system (optional)
- Set and control the alarm by APP
- Timing arm and disarm function
- Built-in multi-languages,free to switch.
- Remote control in different places: the host arm, disarm, monitor, intercom and so on
- Additional functions: The alarm can be used as telephone, and it can make phone calls,inquire phone charges and prepaid recharge by alarm keyboard.
- One-key control: arming out, arming at home, arming by remote control, arming by remote phone
- Instant, at home, 24 hours, bypass multiple zone programming functions

- Code matching: adding new accessories is convenient, fast, safe and efficient
- Remote control in different places: mainframe arming, disarming, monitoring, intercom and so on
- Event record query: host and APP can query historical event records.
- A variety of arming modes: remote control instant arming, outgoing host delayed arming, home host stay arming, designated time timing arming, remote phone remote arming
- Built-in lithium battery rechargeable battery pack, power failure alarm function.

2.Features

- Simple style, good feel.
- Based on the multitasking design of FreeRTOS system, it has an excellent user operation experience
- WiFi automatic time calibration, to ensure accurate clock and support time zone setting, which is convenient for use in multiple countries
- LCD graphic display, built-in perpetual calendar clock, operation steps, smart phone control, support for multi-language menus in many countries and regions, voice operation prompts
- Embedded powerful 32-bit Cortex-M3 CPU control
- WiFi network alarm, support APP push to ensure stable and reliable alarm performance
- Up to 8 remote controllers and 200 wireless detector learning storage locations

- Supports multiple alarm type settings for main door, hall, SOS, bedroom, window, balcony, perimeter, smoke, gas, carbon monoxide, water leakage, etc.
- Supports multiple extended alarm situations such as main power failure and backup battery power shortage
- With wireless sensor battery voltage low alarm function
- Support multiple alarm modes such as going out arming, stay in arming, 24-hour defense zone, doorbell, etc.

1. fixes the keyboard on the wall through the four positioning holes on the back cover of the keyboard, as shown in the below,

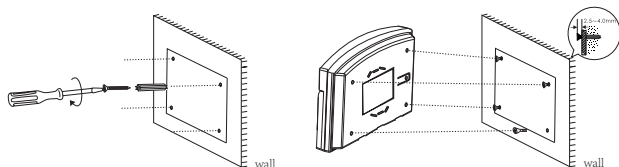

2. fixes the keyboard on the wall or the 86 box installed in the wall through the four positioning holes on the back cover of the keyboard, as shown in the figure below

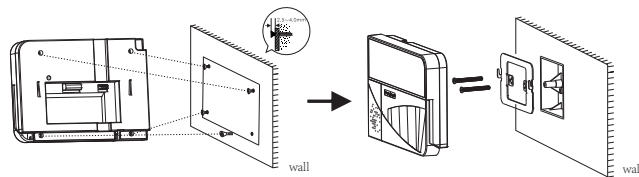

3. Alarm Host Installation

The host should be installed in the center of the protected area, in order to take into account the best reception effect for all wireless detectors. Pay attention to the installation of the host as far as possible away from large metal objects or household appliances with high frequency interference, and avoid shielding objects such as reinforced concrete walls and fire doors.

>>Front view of the panel

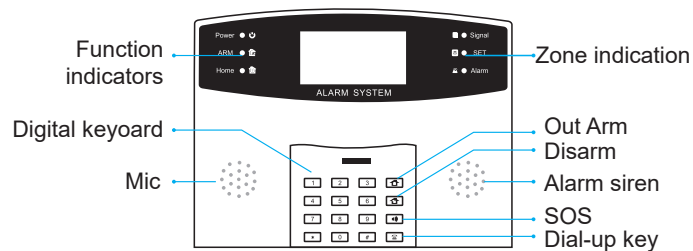

>>Back view of the panel

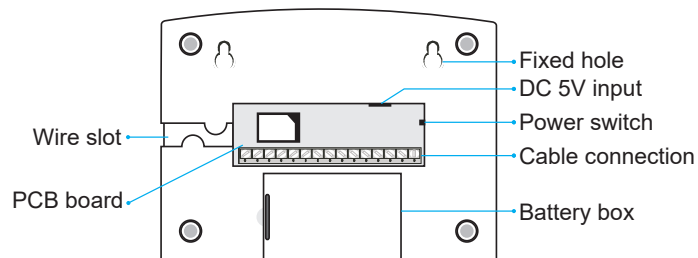

>>SIM Wire connecting terminal

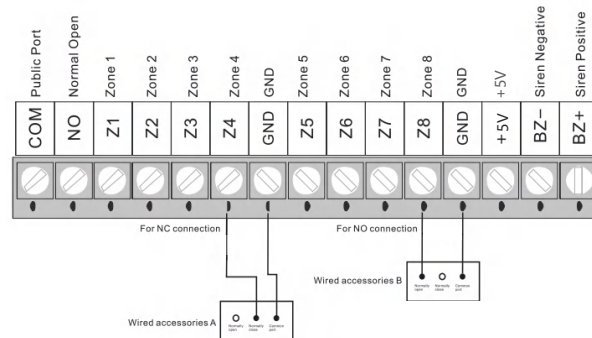

>>LCD display

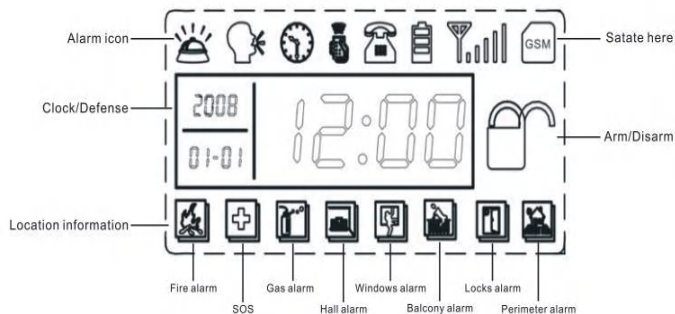

4. Cellphone APP

> > APP download

The Smart Life APP has been released to major global app stores. You can search for "Smart Life" in the app store or scan the QR code on the cover to download. For users in mainland China, please scan the QR code of the official website to download; for users from non-mainland China, please scan the QR code of the Google Play link to download. The smart life APP downloaded from the official website link and Google Play link is the same APP, but the download channel is different.

Note: Mainland China may not be able to download the APP through the Google Play link QR code due to network reasons. Select the corresponding device and swipe left to delete the device. Click the appropriate device to rename the device. The description of the APP in this manual is based on the Android system. Some descriptions may be different due to different versions of the APP or different iOS systems. All the APP versions actually installed on the mobile phone shall prevail.

> > Installation

Use your cellphone to scan the QR code on the back cover directly to download and install it. When the host is in the normal power-on and disarm state: input the command engineering password 6666# -- 00 -- #, and the voice broadcast will announce that it has entered the WIFI distribution network mode.

Make sure the host computer and mobile phone are in the same WIFI network.

Run the mobile APP software, log in with the registered account on the user login interface (New users need to register an account). On the APP device list interface, press the "Smart Configuration"

button in the upper right corner to enter the smart configuration interface. Select the WIFI network in the APP and enter the WIFI password, press the "OK" button to start the configuration.

Method 1: Click to add settings in the APP "Smart Life", and operate according to the APP's prompts (turn on Bluetooth). If the network configuration is successful, the detector will broadcast a voice, indicating that the host has been successfully connected to the Internet. If: WIFI configuration more than 120 seconds without successful configuration, it means WIFI configuration failed.

Method 2: Click to add a device in the APP "Smart Life" - (turn on Bluetooth) - click the socket (Bluetooth + WIFI) - confirm the indicator light flashes quickly - click the fast flash - next step - Continue - If the network configuration is successful, the detector will broadcast a voice, indicating that the host has been successfully connected to the network. If the WIFI configuration exceeds 120 seconds and the configuration is not successful, it means that the network access configuration fails. As shown below:

1. Click to add device:

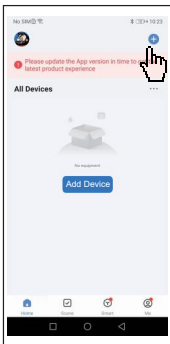

2. Connection

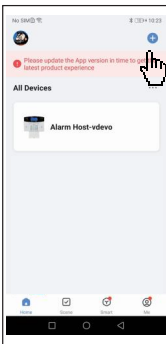
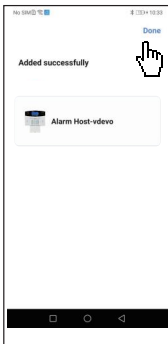
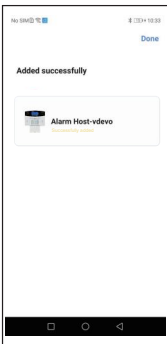

- After pressing the "Start Learning" button, send the remote control learning instruction to the host, press any key of the remote control to be learned to complete the learning, and the host sends the learning success information to the APP.
- The APP pops up "Successful study" to complete the study.
- The APP returns to the remote control setting interface, and recalls the number of remote controls that the host has learned: As shown below,

3. Unbinding the mobile APP from the host

Operating the host:
Main menu - Accessory settings - Unbinding - Confirm. Host prompts "Unbinding"

Add remote control through mobile APP

• Go to the "Accessories" menu.

• Press "Remote Control Settings" to enter the remote control setting interface, and the APP will call the number of remote controls that the host has learned.

• Press the "Add Device" button to enter the remote control learning interface

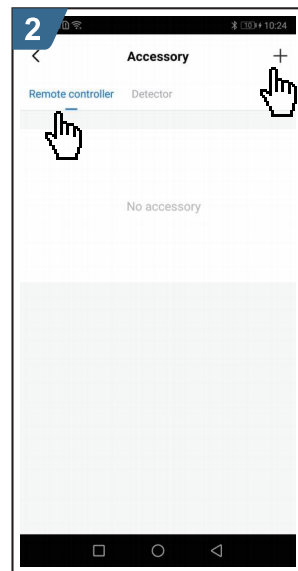
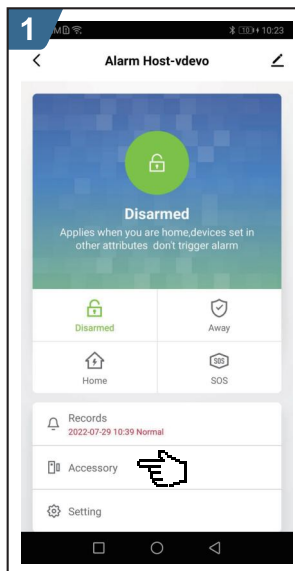

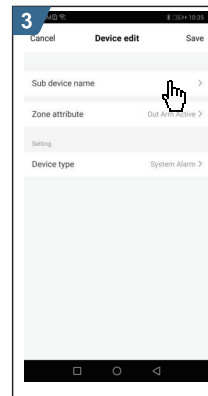
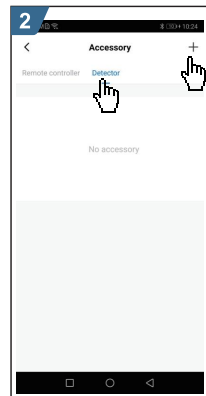
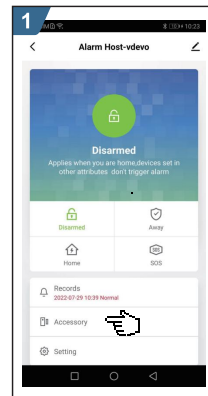
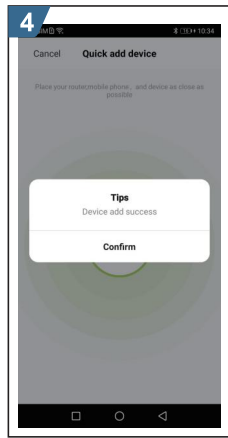
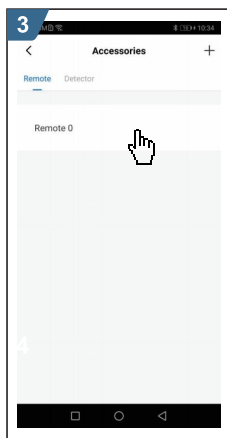

4. Add wireless detectors through mobile APP

- Enter the "Settings" menu.
- Press the "Add Device" button to enter the detector learning interface.
- Press "Detector" to select the name of the detector to be learned.
- Press the "Zone Type" column to select the required defense zone type for the corresponding detector.
- After pressing the "Start Learning" button, send the detector learning instruction to the host.
- Trigger the launch of the learning detector, complete the learning, and the host sends the learning success message to the APP
- The APP pops up "Successful learning" and the APP returns to the detector settings interface, recall the number of all detectors that the host has learned.

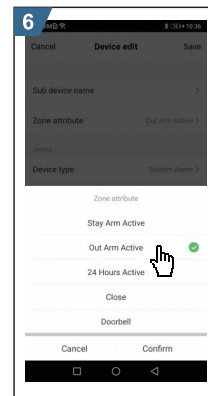
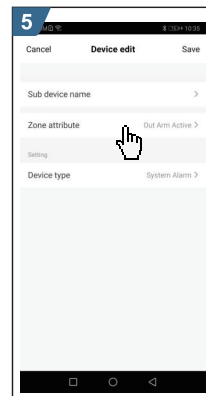
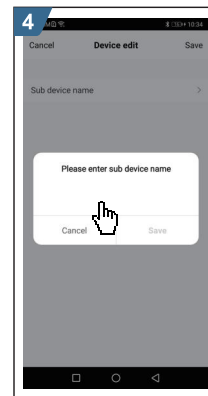

5、Delete the remote control through the mobile APP

- Long press "Remote Control" on the remote control settings interface
- A dialog box pops up, if the user confirms the deletion, press "Yes" and the APP sends the command to delete the remote control to the host.
- The APP returns to the remote control setting interface, and recalls the number of remote controls that the host has learned. If the deletion is successful, the number of remote controls will return to zero.

As shown below:

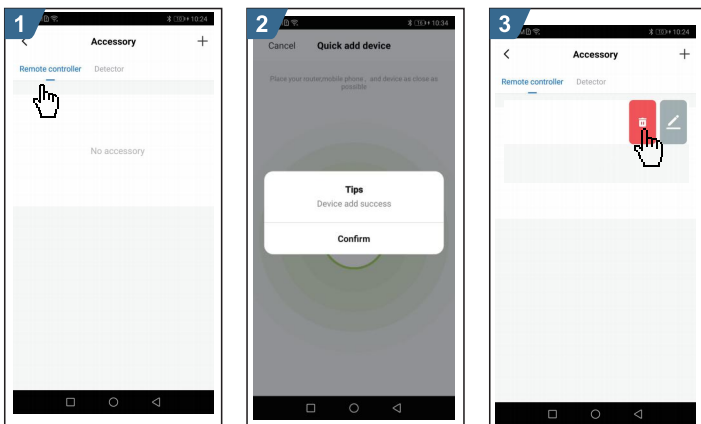

6、Delete wireless detector through mobile APP

- In the detector setting interface, click the "Delete" icon of the detector row to be deleted in the learned detector list.
- A dialog box pops up, if the user confirms the deletion technique "Yes", the APP sends an instruction to delete the corresponding name detector to the host.
- The APP returns to the detector setting interface, and recalls all the detectors that the host has learned. The deleted detectors are gone.

As shown below:

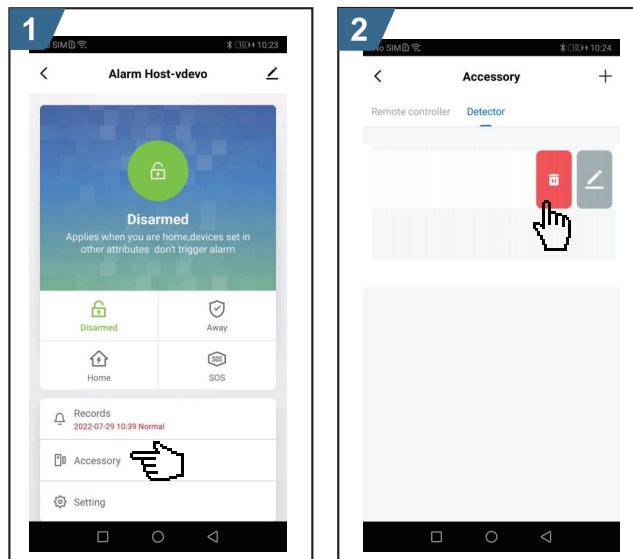

7、Code matching through mobile phone APP and external wireless alarm signal.





- This function only controls the host to transmit the code matching signal to the external wireless alarm in the learning state through the APP.
- See Example 2 [and external wireless alarm code matching].
- During wireless alarm code matching, long press the code matching button and the alarm will ring three times, then release the button to trigger the host to send a signal. When the alarm signal is received by the host, it will give two beeps, indicating that the connection is successful

5.Function Settings















>>System Settings

In the standby state, enter the four-digit project password [6666] project password, press [#] key to confirm. The host voice prompts: "Please enter the command", and at the same time the [SET] light is on and the display shows [-], indicating that it has entered the setting state. When setting the state, you can repeatedly perform a variety of function setting operations. If you stop operating the keys on the host for more than 30 seconds, the host will automatically exit the settings and return to the standby state. Note: The factory default value of the project password is [6666].The following settings are all performed in the setting state, input the setting address and setting content in turn, and press the "#" key to complete the setting.









Host function button

Host SOS button 	<p>1.The host speaker plays the distress alarm sound</p> <p>2.The alarm status of the host shows the distress alarm (from the zone XX)</p> <p>3. APP pushes the device mode to the mobile phone (push device mode:, urgent request save! Zone XX! From XXX alarm host) -> premise APP and host alarm Distribution network, mobile phone open alarm push</p>
Out arming 	<p>1.The host speaker broadcasts the system arming sound</p> <p>2. APP pushes the device mode to the mobile phone (push device mode: go out to arm, The premise is that the APP and the host alarm are connected to the network, and the mobile phone opens the alarm push.</p>
System disarmed 	<p>1.The host speaker broadcasts the disarming sound of the system</p> <p>2. APP pushes the device mode to the mobile phone (push device mode: disarm, the premise is that the APP and the host alarm are connected to the network, and the mobile phone opens the alarm push.</p>
system dial 	When the host network is good, you can directly dial the phone number and press the dial button
* / #	<p>1.*button: go back to the previous level</p> <p>2.#button: confirm</p> <p>3.*button and #button: exit settings</p>

Host screen display status type

Battery capacity	<p>1.The icon does not display when the battery is powered or the external power supply voltage is normal</p> <p>2. The low voltage icon shows: The low voltage icon is displayed correctly, and the APP pushes the alarm event:  low battery! ! From intelligent alarm host</p> <p>3. Main power failure When the main power supply is disconnected from the external power supply, the APP alarms and pushes the power event: AC! ! from the alarm panel</p> <p>4. Main power recovery Connect the main power supply to the external power supply, and the APP alarms and pushes the power supply event: AC recovery! ! From intelligent alarm host</p>
Learning accessory status	<p>1. The icon display when learning remote control: </p> <p>2. The icon display when learning accessories: </p>
clock status	<p>1. Display the clock icon after power on: </p> <p>2. The middle part of the screen will display: year/month/day time</p>
Alarm status	When the host is in alarm, the icon displays: 
Armed status	Press the icon to display when arming away from home or arming at home 
disarmed status	Press the icon when disarmed to display: 
Smoke (fire) Alarm status	The icon displays when a zone is in this alarm type:  
SOS alarm status	The icon displays when a zone is in this alarm type:  
Carbon monoxide (gas) alarm status	When a zone is in this alarm type when the icon is displayed  
Hall alarm status	Icon displayed when a zone is in this alarm type  

Host screen display status type

Window alarm status	Icon displayed when a zone is in this alarm type  
Perimeter Alarm Status	The icon displays when a zone is in this alarm type:  
Balcony alarm status	Icon displayed when a zone is in this alarm type  
Main door (door lock) Alarm status	The icon displays when a zone is in this alarm type:  

set content directory	Setting address	setting content	
WiFi network configuration	00		Input 00-# host voice broadcast has entered WiFi network configuration mode; 1. The network distribution time is 60s, and the voice prompts for successful networking 2. When the configuration time is up, the WiFi configuration fails
Language configuration	11	1-11#	1 Chinese, 2 English, 3 Italian, 4 Polish, 5 Russian, 6 Greek, 7 French, 8 German, 9 Spanish, 10 Portuguese, 11 Hungarian
Remote control code	21	1-8#	example 1, up to 8 can be set
Remote control delete	22		
Wireless defense zone code	23	1-199#	example 2, up to 200 can be set
Delete a wireless zone	24	1-199#	
Delete all wireless defense zones	25		
Zone alarm mode setting	26	1-208#	example 3, up to 208 (including 8 wired zones) can be set
Siren time setting	32	00-15#	00-15 is the ringing time, the unit is minutes, the factory value is [03]
Arming delay time setting	33	00-99#	00 ~ 99 is the arming delay time, the unit is second, the factory value is [00]
Alarm delay time setting	34	00-99#	00~99 is the alarm delay time, the unit is second, the factory value is [00]

set content directory	Setting address	setting content	
Phone dialing times settings	35	0~9#	0~9 is the number of dialing times, the factory default value is [3]
Modify user password	38		0000-9999 Factory default: 1234
Revise engineering password	39	0000-9999#	Enter the four-digit engineering password and press "#". Note: The factory default is: 6666
Host Keypad Lock Settings	40	0-1#	"0" means: close, "1" means: open, the factory value is [0]
Host timing function settings	41	0-1#	"0" means: close, "1" means: open, the factory value is [0]
Host timing arm and disarm settings	42	AABB, XXYX	AABB stands for: disarm time -- hours and minutes, XXYX stands for: arm time hours and minutes
Host reset settings	43		Do not delete remote control accessories
Host history query	44		Press "2" to scroll up, press "8" to scroll down
Clear host history	45		
Arm/disarm SMS prompt settings (optional)	46	0-1#	"0" means: close, "1" means: open, the factory default is [0]

set content directory	Setting address	setting content	
clock setting	48	Year/month / day/hours /minutes	Example4
Delete the alarm	51-56		
Zone alarm type setting	60	1-208#	See example 6 (including 8 wired defense areas)
Host IMEI query	63	0-32#	See Example 7 (99 means no signal)

Example 1. Remote control code

In the disarmed state, enter the engineering command [6666#]-[21] key + [N] (N represents the serial number of the remote control), press the [#] key to confirm, the host will beep once, and the voice prompts "The remote control sends a code" "[]". The pairing icon will be on for a long time, and the LCD will display the remote controller that is pairing at this time. Press any key on the remote controller that needs to be paired; after the host receives the signal, a "beep" will sound, and the voice prompts "Successful learning" "[]". The pairing icon is off, and the remote controller is successfully paired. After the code is successfully matched, it will automatically return to the previous layer. If you need to operate, repeat the operation method of the previous action: [6666#] → [21] → [1-8#]

Note: The same remote controller can only be paired once, and can be paired with up to 8 remote controllers. Support the learning of 8 remote controls, click "+" to learn accessories, Follow the instructions of the host to operate. If the host voice prompts "Accessories have been learned", it means that the code of this remote control has been learned or duplicated with other learned detector codes, please try another remote control and try again.

Example 2. Wireless zone matching

In the disarmed state, enter the engineering command [6666#]-[23], then enter the defense zone to be paired [1-200], and press the [#] key to confirm. The LCD displays the corresponding defense area, and the voice prompts "detector sends a code" to trigger the

detector that needs to be paired, and the host receives the message. After the number is entered, a "beep" will sound, the voice prompts "Successful learning" and two [] pairs are matched, and the icon goes out.

Operation method: [6666#] → [23] → [XX] → [#]

XX stands for: 1-200 zone number.

Example 3. Zone alarm mode and alarm type setting

In the disarmed state, enter the engineering command [6666#]-[26] key, then enter the wireless zone number [1-200], and then enter the alarm type of the accessory [1~8], and press "#" to confirm; The host will beep once, and the voice prompts "set successfully". The accessory alarm mode has been edited successfully.

Operation method: [6666#] → [26] → [XX] → [Y] → [#]

XX represents: two-digit zone number; Y represents: alarm mode

For example: 02 zone alarm mode is set to go out to arm

Operation method: [6666#] → [26] → [02] → [1] → [#]

Zone alarm mode

When the alarm mode of the accessory is set to "0": in any state, the accessory will not trigger the host to alarm;

When the alarm mode of the accessory is set to "1": only when the host is out of the armed state, or stay at home to arm, the accessory will trigger the host to alarm; When the accessory's alarm mode is set to "2": only when the host is arming outside, the accessory triggers the alarm host to give an alarm, and when the host is at home, the accessory triggers the alarm host and does not alarm;

When the alarm mode of the accessory is set to "3": no matter what state the host is in, the trigger of the accessory will cause the alarm host to alarm (it will also alarm when it is not armed).

Example 4. Clock setting method

In the disarmed state, input the engineering command [6666#]-[48], then input the last two digits of the current year [AA]; add the two-digit month [BB]; add the two-digit date [CC]]; add the current hour time (24-hour clock) [DD]; add the current Minute time [EE]; press [#] key to confirm, the host voice prompts, the operation is successful How to do it: 【6666#】→[48]→

【AA】→【BB】→【CC】→【DD】→[EE]→[#]

AA stands for: the last two digits of the current year.

BB stands for: the two-digit number of the current month

CC stands for: Two digits of the current date.

DD stands for: Hours of the current time: (24-hour clock).

EE stands for: Minutes of the current time.

For Example: May 26, 2017 at 17:30 pm

Operation method:[6666#]→[48]→[17]→[05]→[26]→[17]→[30]→[#]

Example 5. Alarm phone number setting

In the disarmed state, enter the engineering command [6666#]-[51-56] key, then enter the mobile phone number, press the [#] key to confirm, the host voice prompts "operation successful".

Operation method: [6666#]→[XX]→[YY...YY]→[#]

XX stands for: 1~6 groups of telephone codes [51~56].

YY--YY represents: set the telephone (mobile phone) number.

For example: take 13811110751 as the first group of alarm calls.

Operation method: [6666#]→[51]→[13811110751]→[#]

Example 6. Alarm type setting

In the disarmed state, input the engineering command [6666#]-[60] key, select the corresponding zone number[02-99] key, then input [1-8] zone alarm type, press [#] to confirm, and the voice prompts" Set up successfully"

Operation method: [6666#]→[60]→[XX]→[A]→[#]

XX represents the zone number: [1-208] correspond to zones 01 to 208 respectively.A stands for alarm type: [1] SOS alarm, [2] Fire alarm,[3] Gas leak, [4] Door lock alarm, [5] Hall alarm, [6] Window alarm, [7] Balcony alarm, [8] Perimeter alarm.The alarm type is sent to the mobile phone by SMS

For Example: Set zone 10 as a fire alarm

Operation method: [6666#]→[60]→[10]→[2]→[#]

> > Exit Settings

After the setting is completed, you need to exit the setting state, enter the [*][#] key, the host will make a beep, and exit the setting state. The [SET] light goes out and returns to the standby state.

> > Exit Settings

Under normal circumstances, the alarm panel usually only has the following four states:

- » **Arming status:** After arming, 1-208 zone alarm is valid.
- » **Arming at Home:** After arming, set it to [Arm at Home] to alarm in a valid zone.
- » **Disarm status:** After disarming, the 1-208 zone will not alarm (except for the 24-hour zone)
- » **Setting status:** When setting, all defense zones will not alarm.

6.Daily operation

The remote control is a device that performs various functions on the alarm host by radio. The function is to facilitate the user to carry out operations such as going out arming, arming at home, emergency alarm, and disarming the alarm host outside the door or entering the house.

» **Arming when going out:** Press the [] key, the main unit is in the arming state immediately. Arrange security tasks(referring to anti-theft) to make the host enter the alert state, also known as fortification and vigilance.

» **Disarm operation:** press the [] key, the main unit will alarm immediately or be in disarm state. Revocation of security tasks (referring to anti-theft), also known as disarming.

» **Arming at home:** Press the [] key to be in the arming state at home (stay behind). When the user is at home, he only needs to set an alert state for the entrance, exit or perimeter, which is also called home defense.

» **Emergency alarm:** Press the [] key, the host will send an alarm immediately. After the host generates an alarm task, the on-site sound and light alarm is issued, and a series of alarm actions such as the alarm content are pushed to the mobile APP.

» **Defense zone triggering:** When the detector in the armed state or set to 24-hour defense zone detects someone or the door is opened, the detector triggers, and an alarm task is generated.

» **Arming delay:** After the host is armed, the extended time is set to avoid the alarm when the user leaves the scene and passes through the arming area. It is also called the exit delay.

» **Alarm delay:** After the user comes back and triggers the detector after passing through the armed area, the host will not alarm immediately, providing a period of time for the user to disarm the host, and the host will alarm if the host cannot be disarmed after timeout, also called entry delay.

7.Remote Control

Dial the phone number connected to the alarm host through the phone (mobile phone). After the set number of rings is passed and the phone is connected, the user operates the key according to the voice prompt.

8.Sos

In the family, some special situations sometimes occur: the elderly or children have a sudden illness and need first aid; a fire suddenly occurs in the home and needs to be rescued; gangsters enter the house to commit robbery and need to report to 110. At this point, just press the [📞] emergency button on the main unit, the [🔺] button on the remote control, and the emergency button. The alarm system will alarm immediately, and automatically make a phone call to alarm.

Remote control operation: Press the [🔺] button on the remote control once.

Host operation: [📞] emergency button on the host keyboard.

9.Maintenance

> > System detection

Although the alarm system is used every day, it must be regularly maintained and tested to ensure the stable, reliable and safe operation of the alarm system. Usually, the alarm host must be inspected comprehensively every three months, and the detector should be inspected once a month, and at least every three months if there is no condition.

> > Host detection:

1. Whether the host can arm and disarm normally.
2. Whether the host alarm can make outgoing calls normally.
3. Whether the signal of the detector can be received normally or whether the backup battery is normal.

> > Probe detection:

1. Manually trigger the detector to check whether the alarm is normal.
2. Check the batteries of all detectors to see if they are under-voltage. Test the launch of the wireless detector to see if it can communicate with the host.

10. Technical parameters

- Input voltage: DC5V
- Working current: screen off <100mA, screen on <200mA
- Stand-by current: <55mA
- Alarm current: <600mA
- Radio frequency: 433MHz
- RF code: 1527(330K)
- Backup battery: 3.7V/1000mAh rechargeable lithium
- Siren Alarm: >100dB@1m
- Wireless distance: <100m
- Operation temperature: -10℃—55℃
- Relative humidity: <80%RH (non-condensing)

11. Notes:

Do not disassemble, repair and modify the product without permission, otherwise accidents and failures may occur. Do not drop the product on the ground or hard objects to avoid strong impact, resulting in malfunction and damage.

FCC Caution:

This device complies with part 15 of the FCC Rules. Operation is subject to the following two conditions: (1) this device may not cause harmful interference, and (2) this device must accept any interference received, including interference that may cause undesired operation. Any changes or modifications not expressly approved by the party responsible for compliance could void the user's authority to operate the equipment.

NOTE: This equipment has been tested and found to comply with the limits for a Class B digital device, pursuant to Part 15 of the FCC Rules. These limits are designed to provide reasonable protection against harmful interference in a residential installation. This equipment generates, uses and can radiate radio frequency energy and, if not installed and used in accordance with the instructions, may cause harmful interference to radio communications. However, there is no guarantee that interference will not occur in a particular installation.

If this equipment does cause harmful interference to radio or television reception, which can be determined by turning the equipment off and on, the user is encouraged to try to correct the interference by one or more of the following measures:

- Reorient or relocate the receiving antenna.
- Increase the separation between the equipment and receiver.
- Connect the equipment into an outlet on a circuit different from that to which the receiver is connected.
- Consult the dealer or an experienced radio/TV technician for help.

To maintain compliance with FCC's RF Exposure guidelines, This equipment should be installed and operated with minimum distance between 20cm the radiator your body: Use only the supplied antenna.