





Illegal operation may cause personal injury, which could be fatal.



Illegal operation may cause damage to property.

Important safety instructions:

- 1) Read these instructions carefully.
- 2) Read all warnings
- 3) Follow all instructions.
- 4) Please do not expose this apparatus to water, corrosive liquid or gas. Please store the apparatus in a dry and clean place.
- 5) Please do not install the speaker system near windows, or any heat sources such as radiators, heat registers, gas stoves or other apparatus that produce heat.
- 6) Do not place any naked flame sources, such as lit candles, on or near the apparatus.
- 7) Clean only with dry cloth.
- 8) Please do not place objects filled with any kind of liquid on the speakers
- 9) To reduce the risk of fire or electric shock, do not expose this product to rain or moisture. Liquids can cause a failure and/or fire hazard.
- 10) Please do not insert metal bar/wire or any other object in the speaker hole.
- 11) Protect the power cord from being walked on or pinched particularly at plugs, and the point where they exit from the apparatus.
- 12) To reduce the risk of electric shock, do not handle the plug with wet hands.
- 13) Before moving the speakers, please pull out the power adapter and disconnect from any other equipment.
- 14) Please do not block any ventilation openings of the device, otherwise it will cause a rise in internal temperature of the apparatus and thus cause damage to the circuit.
- 15) Please do not press the switches or other keys with force.
- 16) Unplug the power cable immediately if your device emits smoke or acts abnormally. Seek professional help from your nearest service center.
- 17) Only use attachments recommended by the manufacturer. Use of other attachments may be hazardous.
- 18) Do not throw used batteries in with your household rubbish. Follow instructions from your local council about safe disposal

Using the Remote Control

Installing the Batteries

Remove the battery cover from the back of the Remote Control as shown and insert 2xAAA size batteries ensuring correct polarity.

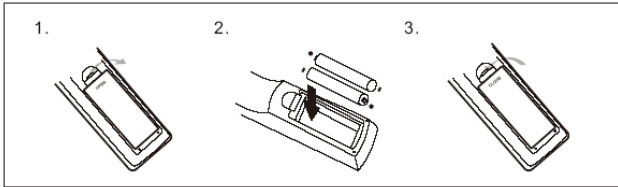

- 1.Power on/off
- 2.Mute
- 3.Repeat key
- 4.Mode key
- 5.0-9 number keys
- 6.EQ
- 7.Record key
- 8.Play/pause
- 9.Volume-
- 10.Volume+
- 11.Previous song
- 12.Next song
- 13.Ok.Vol-
- 14.Ok.Vol+

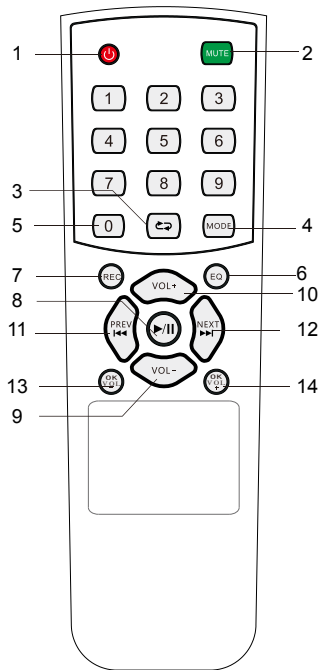

Note for remote:

1. The remote control should be used within 6m from the device, around 30 degree on the left/right side, pointed directly towards the speaker system.

OVERVIEW:

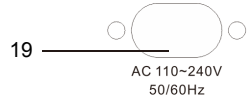
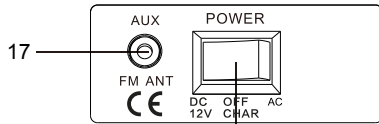
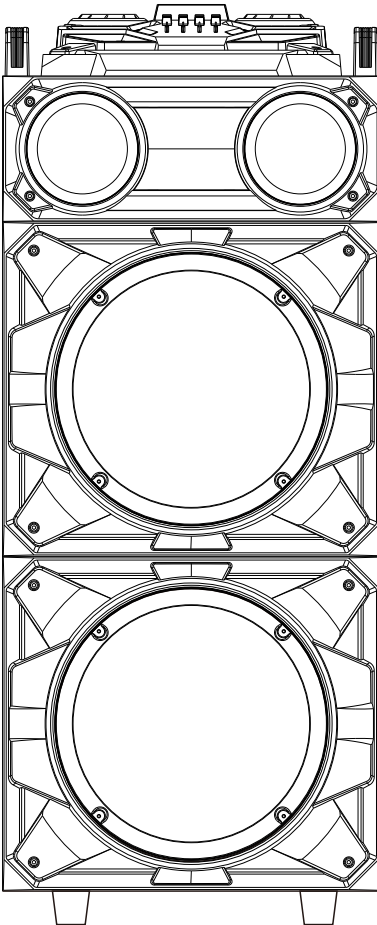
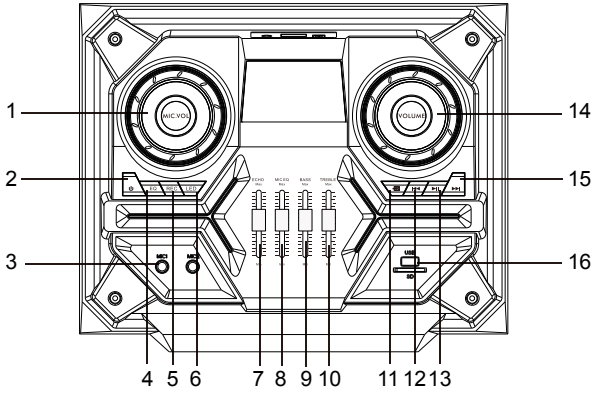

- 1. MIC.VOL
- 2. STANDBY
- 3. MIC INPUT
- 4. EQ
- 5. REC
- 6. LED
- 7. ECHO
- 8. MIC.EQ
- 9. BASS
- 10. TREBLE
- 11. MODE
- 12. PREV
- 13. PLAY/PAUSE
- 14. MAIN VOLUME CONTROL
- 15. NEXT
- 16. USB/SD CARD INPUT
- 17. AUX/FM ANT
- 18. POWER SWITCH

CONNECTING WIRED MICROPHONE

(microphone not supplied)

Connect the microphone to MIC IN input and switch on.

Note:

If you are playing music from any other input, connecting the microphone will not mute the sound output.

Voiceover Function

The voiceover function is available with any input. Play a track through AUX/ USB/ SD/ FM/ Bluetooth; connect a microphone to MIC IN and sing along for a "karaoke" effect.

Built-in recording function:

1. Plug in a microphone to the MIC IN input.
2. Insert USB/SD card into the corresponding port; press Mode button and select USB/SD mode.
3. If the USB/SD card is plugged into the speaker for the first time, the system will automatically create a folder named RECORD to save recorded files (FAT32 usb file system is supported).
4. When you are ready to record, press 'Record' button to go to recording mode. The current sound output will stop and go to mute status, screen shows "Recording". The device starts recording when the screen shows 00:01 and users can use the microphone to record.

USB/ SD CARD SLOT

Keep the speaker away from high temperatures, high magnetic field and high frequency interference. If the speaker hangs, please switch it off and switch on again, or unplug USB/SD/MMC card and re-plug. The speaker will work normally again.

The maximum size of usb/sd device that can be connected is 32GB

MUSIC FORMAT SUPPORT MP3, WMA.

1. USB port, plug and play.
2. SD/MMC slot. Plug and play.
3. Mode key: Choose input source from these options: AUX/USB/SD card/FM/Bluetooth.
4. Play/pause key - when playing, press this key to pause, press the key again to play.
5. Previous/Next key- when playing, single press of this key will play next/previous song as per your wish.
6. Repeat key - when playing, pressing this key can replay the current song or all songs as per your wish . Press once for repeat single; Press twice for all repeat.

FM RADIO FUNCTION

1. Turn on the unit and press repeatedly the MODE key on unit, or the MODE on remote control and select FM function (the display will show the frequency).
2. Press the PLAY button on the unit or the key ►|| on remote control to activate the auto memory (the radio starts an automatic search for available radio stations and saves them automatically). The station's number stored depends on the radio signal in your area. During the search,press PLAY button on the remote control to stop searching.
3. Use the NEXT and PREV, or the keys ►► and ◀◀ on the remote control to listen to the various radio stations saved in memory.
4. To change to a preset station, use the number keys on the remote control. For example, to call up the station number 12, first press 1 and then 2.

BLUETOOTH OPERATION

1. Turn on the machine and press the MODE on unit, or the MODE on remote control to select the Bluetooth function, the display shows "BLUE".
2. In the Bluetooth mode, the symbol  on display will start flashing, the system automatically enters search mode.
3. Activate the Bluetooth feature on the external device to be coupled.
4. Initiate a search for devices. The device shows up as "GD-PS1203".
5. Press the PLAY button on the unit or the key ►|| on remote control, to start playing and the buttons NEXT and PREV, or the keys ►► and ◀◀ for the selection of songs.

CHARGING INSTRUCTIONS -

1. This speaker has a high capacity 12V battery. Please connect to AC port with power cord to charge. The power adapter has an indicator light that will illuminate when the speaker is on charge. It takes around 6-8 hours to fully charge the speakers. Disconnect power adapter as soon as battery is fully charged.

NOTE- over charging will damage the battery

2. Please fully charge the speakers if they are not used in a long time. Please charge the speakers every 2 months, otherwise the battery may get damaged.

Note- When the battery of the speaker is low, please charge it within 48 hours.

Trouble shooting

Users may try to solve common problems by following these guidelines. If the problem persists and can't be solved, please contact Customer Service for assistance.

Troubleshooting

Before repair, please check following problems first

Symptom	May caused by	Solution
No sound comes when the power is on	<ol style="list-style-type: none"> 1.No input sound source 2.Volume knob in the lowest position 3.Voice switch off 4.USB/SD card not plugged 	<ol style="list-style-type: none"> 1.Input AUX signal 2.Adjust volume 3.Turn on voice switch 4.Plug USB/SD card,play MP3
Distortion of sound	<ol style="list-style-type: none"> 1.Volume is too loud 2.Audio file error 	<ol style="list-style-type: none"> 1.Turn the volume down 2.Check and change the audio file
No sound comes from the Microphone	<ol style="list-style-type: none"> 1.Microphone socket may not be plugged properly. 2.Microphone switch may not be on. 3.Microphone volume is on lowest mode. 	<ol style="list-style-type: none"> 1.Ensure the microphone is correctly plugged into the socket. 2. Turn on the microphone 3. Adjust the microphone volume as per users wish
No sound comes after inserting USB/SD card	<ol style="list-style-type: none"> 1. Incorrect file format 2. USB/SD card may not be plugged in properly. 	<ol style="list-style-type: none"> 1. File format should be MP3 2. Plug USB/SD card correctly
Charging indication-red light flashing when there is low charge	Charging adapter is not inserted properly.	It will not affect the speaker system.The light is only used for indicating whether the unit is charging.
Unable to charge or the battery works only for short duration	<ol style="list-style-type: none"> 1.Connect with power cord to charge 2.Battery not fully charged 3.Battery life may have ended 	<ol style="list-style-type: none"> 1.Check if power cord connected properly 2.Extend charging time;normally it takes 6-8 hour to fully charge 3.Replace old batteries with the same specification as the old batteries.
If Speaker makes loud noises	<ol style="list-style-type: none"> 1. Microphone switched on but may be too close to the speaker 2. Microphone switched on but is not being used. 3. Microphone volume may be too loud 4. Mobile phone is being used too close to the speaker 5. Other wireless equipments may be placed very close to the speaker. 	<ol style="list-style-type: none"> 1. Keep the microphone 2 meters away from the speaker 2. Turn off microphone if not in use. 3. Adjust microphone volume to lower mode 4. Keep mobile away from the speaker whilst attending a call. 5. Keep the speaker away from other wireless equipment

SPECIFICATION

Power supply: AC110-240V~,50/60Hz

Power Consumption: 45Wx2

Channel Separation: >40dB

Operating condition Temperature:0~40 Humidity:5%~90%

INPUT

FM Tuner: 87.5MHz-108MHz

USB: MP3/WMA

OUTPUT:

Amplifier Output power: 45Wx2

BASS: +10dB-10dB

Treble: +10dB-10dB

Frequency response: 80Hz-20kHz

S/N ratio: >70dB

Speaker :12inch Woofer×2+3inch×2 Treble

Sensitivity: 500mV

Impedance: 10K

Product Size: L440xW353xH1100mm

FCC STATEMENT:

This device complies with Part 15 of the FCC Rules. Operation is subject to the following two conditions:

- (1) This device may not cause harmful interference, and
- (2) This device must accept any interference received, including interference that may cause undesired operation.

Warning: Changes or modifications not expressly approved by the party responsible for compliance could void the user's authority to operate the equipment.

NOTE: This equipment has been tested and found to comply with the limits for a Class B digital device, pursuant to Part 15 of the FCC Rules. These limits are designed to provide reasonable protection against harmful interference in a residential installation.

This equipment generates uses and can radiate radio frequency energy and, if not installed and used in accordance with the instructions, may cause harmful interference to radio communications. However, there is no guarantee that interference will not occur in a particular installation. If this equipment does cause harmful interference to radio or television reception, which can be determined by turning the equipment off and on, the user is encouraged to try to correct the interference by one or more of the following measures:

Reorient or relocate the receiving antenna.

Increase the separation between the equipment and receiver.

Connect the equipment into an outlet on a circuit different from that to which the receiver is connected.

Consult the dealer or an experienced radio/TV technician for help.

RF warning statement:

The device has been evaluated to meet general RF exposure requirement. The device can be used in portable exposure condition without restriction.