

SHARPER IMAGE

Wireless Tailgate Speaker with FM Radio



User Guide SBT1017

In the Box

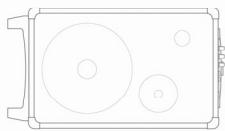
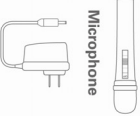

Charging Adaptor

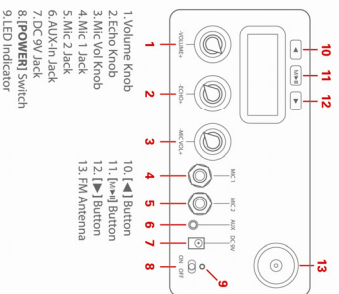

Location of Controls

Pairing the Speaker

- Pairing ON/OFF**
- 1. Switch the [POWER] switch to the ON position. A tone will be heard indicating the speaker is powered ON.
 - 2. Set your Bluetooth-enabled device to search for Bluetooth devices. When your mobile Bluetooth-enabled device finds the speaker, select "SBT1017" from the list of found devices.
 - 3. After a successful pairing, a tone will be heard indicating the speaker is paired.

! If a previously paired device is in range when the speaker is turned on, the speaker will connect to it automatically.

On an iOS or Android Device

- Go to **SETTINGS > BLUETOOTH** (Make sure Bluetooth is turned ON)

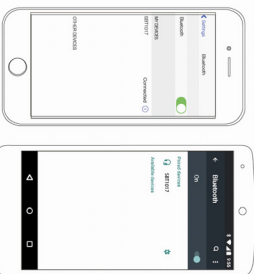

Using the Speaker

- Pairing ON/OFF**
- To use the speaker ON, switch the [POWER] switch to the ON position.
 - To turn the speaker OFF, switch the [POWER] switch to the OFF position.

Adjusting Volume

- Turn the volume knob to the left to lower volume.
- Turn the volume knob to the right to raise the volume.

Playing Music

To enjoy music wirelessly on your speaker, make sure that the speaker is properly paired to your Bluetooth-enabled device. If you are pairing the device for the first time, please consult the "Pairing the Speaker" section of this user guide.

Use the controls on your Bluetooth-paired device to play and pause music or to skip tracks.

Using the Microphone

The speaker can support up to two microphones or guitars (guitar not included). To use a microphone or guitar, plug an 1/8" microphone cable into either the MIC 1 or MIC 2 jacks and the other end into the microphone or guitar output jack.

Adjusting Mic Volume

- Turn the Mic Volume knob to the left to decrease microphone volume.
- Turn the Mic Volume knob to the right to increase microphone volume.

Adjusting Mic Echo

- Turn the Mic Echo knob to the left to decrease microphone echo.
- Turn the Mic Echo knob to the right to increase microphone echo.

NOTE: Music will play while using the microphones.

Using the FM Radio

Bluetooth-enabled radio: place the speaker near a clear, unobstructed space, and extend the antenna for best results.

- Quick press the [M] and [P] buttons to search for signals.
- Long press the [M] and [P] buttons to auto scan, the speaker will select the next radio station with a clear signal.

Using as a Wired Speaker

To use the speaker as a wired device, attach a 3.5mm AUX cable to the AUX-In jack and attach the other end to the readphone jack on your media playing device.

Media playback and volume adjustment is controlled through the connected device. Volume adjustment can also be controlled with the volume knob on the speaker.

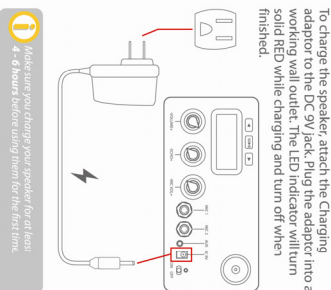

! Make sure you charge your speaker for at least 4-6 hours before using them for the first time.

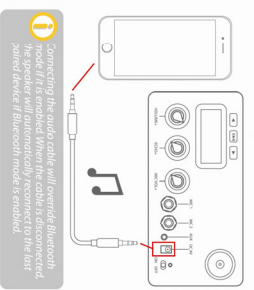

! Connecting the audio cable will enable Bluetooth mode if it is enabled. When the cable is disconnected, the speaker will automatically reconnect to the last paired device if Bluetooth mode is enabled.

Questions and Customer Support

For further assistance or troubleshooting, please call our customer support line:

Phone: 1-877-768-8481
Monday-Friday 8AM-10PM (EST)
www.southernrelecom.com
Click on "Product Support"

Legal Information

READ CAREFULLY AND KEEP THIS MANUAL

Caution: Any changes or modifications to operate approved could void the user's authority to operate the equipment.

- This device complies with Part 15 of the FCC rules. Operation is subject to the following two conditions:
- (1) This device may not cause harmful interference, and
 - (2) This device must accept any interference received, including interference that may cause undesired operation.
- Note:** This equipment has been tested and found to comply with the limits for a Class B digital device, pursuant to part 15 of the FCC Rules. These limits are designed to provide reasonable protection against harmful interference in a residential environment. This equipment does not cause harmful interference to radio or television reception, which can be determined by turning the equipment off and on, the user is encouraged to try to correct the interference by one or more of the following measures:
- Reorient or relocate the receiving antenna.
 - Increase the separation between the equipment and receiver.
 - Connect the equipment into an outlet on a circuit different from that to which the receiver is connected.
 - Consult the dealer or an experienced radio/TV technician for help.

Limited Warranty

90 Day Limited Warranty

In the unlikely event that this product is defective or does not perform properly, you may within ninety (90) days from your original date of purchase return it to the authorized service center for repair or exchange.

TO OBTAIN WARRANTY SERVICE:

- Call the Customer Support number located below, or go to our website portal to receive an SNO number.
 - Provide proof of the date of purchase within the package (dated bill of sale).
 - Prepay all shipping costs to the authorized service center.
 - Include a return shipping address (no PO Boxes), a telephone contact number, and the defective unit within the package.
 - Describe the defect or reason you are returning the product.
- Your product will be repaired or replaced at our option, for the same or similar model of equal value (as defined by the manufacturer) if the product is found to be defective. Products received damaged as a result of shipping will require you to file a claim with the carrier.

The shipping address of the authorized service center is:

Southern Relecom, Inc.
14C 33rd Street
Brooklyn, NY 11232

Should you have any questions or problems concerning this product, please contact our customer service department at:

Customer Support
1-877-768-8481
Monday-Friday 8AM-10PM (EST)
www.southernrelecom.com
Click on "Product Support"

Warranty service not provided

This warranty does not cover damage resulting from: misuse, accident, fire, flood, lightning, tampering, lack of reasonable care, and unauthorized modification. This warranty is voided in the event any unauthorized person opens, alters or repairs this product. All products being returned to the authorized service center for repair must be suitably packaged.

Limitation of Warranty

THE WARRANTY STATED ABOVE IS THE ONLY WARRANTY APPLICABLE TO THIS PRODUCT. ALL OTHER WARRANTIES, EXPRESS OR IMPLIED INCLUDING ALL IMPLIED WARRANTIES OF MERCHANTABILITY OR FITNESS FOR A PARTICULAR PURPOSE ARE HEREBY DISCLAIMED. NO FEDERAL OR WRITTEN INFORMATION GIVEN BY MIT INC.'S AGENTS, OR ANY OTHER SOURCE, SHALL BE CONSIDERED TO IN ANY WAY INCREASE THE SCOPE OF THIS WARRANTY.

REPAIR OR REPLACEMENT AS PROVIDED UNDER THIS WARRANTY IS THE EXCLUSIVE REMEDY OF THE CONSUMER. MIT INC. SHALL NOT BE LIABLE FOR INCIDENTAL OR CONSEQUENTIAL DAMAGES RESULTING FROM THE USE OF THIS PRODUCT OR WARRANTY COUPON. BREAK OR ANY OTHER DAMAGE TO OR DAMAGE TO ANY PART OF THIS PRODUCT IS NOT COVERED BY THIS WARRANTY. THIS DISCLAIMER OF WARRANTIES AND LIMITED WARRANTY ARE GOVERNED BY THE LAWS OF THE STATE OF NEW YORK. ANY IMPLIED WARRANTY OF MERCHANTABILITY OR FITNESS FOR A PARTICULAR PURPOSE ON THIS PRODUCT IS LIMITED TO THE APPLICABLE WARRANTY PERIOD SET FORTH ABOVE.

Some states do not allow the exclusion or limitation of incidental or consequential damages, or limitations on how long an implied warranty lasts so the above limitations on exclusions may not apply to you. This warranty gives you specific legal rights, and you also may have other rights that vary from state to state.



Sharper Image® name and logo are registered trademarks. Manufactured by Southern Relecom, Inc. © Southern Relecom, Inc. All rights reserved.

SHARPER IMAGE