

PBT3028 User Guide



Bluetooth speaker PBT3028 User Manual



www.polaroid.com

Charging the Speaker
To charge the speaker, attach the pin of the supplied charging adapter to the DC 5V charging port on the back of the speaker. Plug the adapter into a working wall outlet.

If using for the first time, please allow **3 - 5 hours** for the speaker to fully charge before using.

Installing/Replacing the Remote Control Batteries
To replace or install the remote control battery, push and slide the battery door out from the remote control. Replace the battery with a new **CR2025** battery with the positive (+) polarity facing up.

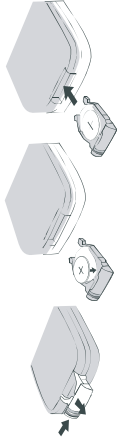

NOTE: There is a protective plastic tab inserted into the battery door of the remote control. When using for the first time, gently pull the protection tab extending out of the remote control's battery door.

(Front)

<p>In the Box</p> <p>⚠ DANGER - LASER RADIATION. AVOID DIRECT EXPOSURE TO THE BEAM.</p> <p>Tower Speaker</p> <p>3.5mm Auxiliary Cable</p> <p>Remote Control</p> <p>Charging Adapter</p>	<p>Location of Controls</p> <p>(Top panel of Speaker)</p>	<p>Location of Controls (cont'd)</p> <ol style="list-style-type: none"> 1. Laser Aperture 2. [L-1/4] Button: <ul style="list-style-type: none"> • Long Press - Decrease volume • Quick Press - Skip to previous track (Bluetooth mode) • Quick Press - Skip to previous FM station (FM Radio mode) 3. [M] Button: <ul style="list-style-type: none"> • Long Press - Change between Bluetooth and FM Radio mode • Quick Press - Play/pause (Bluetooth mode) • Quick Press - Search/save FM stations (FM Radio mode) 4. [R-1/4] Button: <ul style="list-style-type: none"> • Long Press - Increase volume • Quick Press - Skip to next track (Bluetooth mode) • Quick Press - Skip to next FM station (FM Radio mode) 5. [L:] Button: <ul style="list-style-type: none"> • Long Press - Toggle laser ON/OFF <p>(NOTE: Please review ALL warnings in this manual before using the laser function)</p> <ol style="list-style-type: none"> 6. LED Indicator 7. Auxiliary Input Jack (Side) 8. [POWER] Switch (Back) 9. DC 5V Power Jack (Back, Bottom) 	<p>Using the Speaker</p> <p>Powering ON/OFF</p> <ul style="list-style-type: none"> • Move the [POWER] switch to the ON position to turn the speaker ON. • Move the [POWER] switch to the OFF position to turn the speaker OFF. • Press the [L:] button on the remote control to enter/leave standby mode. <p>Volume Adjustment</p> <ul style="list-style-type: none"> • To increase volume, long press the [M-R] button on the speaker or the [VOL+] on the remote control. To decrease volume, press the [L-1/4] button on the speaker or the [VOL-] button on the remote control. • Press the [M] button on the remote control to mute/unmute the speaker. <p>Using the Laser</p> <p>WARNING: When using the laser, do NOT aim or direct toward the eyes or face of anyone nearby as it may cause irreparable damage to one's eyesight. The laser can instantly dazzle viewers, do NOT aim or direct at anyone operating any kind of vehicle, near or far away.</p> <ul style="list-style-type: none"> • Quick press the [L:] button on the speaker or remote control to enable/disable the laser.
<p>Setting Up the Speaker</p> <p>Pairing the Speaker</p> <p>1. Turn the speaker ON by moving the [POWER] switch to the ON position. A tone will be heard indicating the speaker has power and the LED indicator will quickly flash BLUE.</p> <p>2. Set your mobile device to search for Bluetooth devices. When your mobile device finds the speaker, select PBT3028 from the list of found devices.</p> <p>3. Once successfully paired, a tone will be heard and the LED indicator will slowly flash BLUE.</p> <p>For iOS or Android</p> <ul style="list-style-type: none"> • Go to SETTINGS > BLUETOOTH (Make sure Bluetooth is turned ON) <p>The screenshots above are typical for many Bluetooth-enabled devices in the market today and are used to assist in the explanation of the pairing process. Your Bluetooth-enabled device's interface and interaction with the speaker may differ slightly from the illustrations above.</p>	<p>Using the Speaker</p> <p>Playing Music</p> <p>To enjoy music wirelessly on your speaker, make sure you are paired to a Bluetooth-enabled device. Once paired, you can control the media playback and volume adjustment with the controls on your paired device.</p> <p>Playing/Pausing Music</p> <ul style="list-style-type: none"> • To pause media playback, quick press the [M] button on the speaker or remote control. • To resume media playback, quick press the [M] button on the speaker or remote control. <p>Skipping Tracks</p> <ul style="list-style-type: none"> • To skip to the previous track, quick press the [L-1/4] button on the speaker or the [L-1/4] button on the remote control. • To skip to the next track, quick press the [R-1/4] button on the speaker or the [R-1/4] button on the remote control. 	<p>Using the Speaker</p> <p>Powering ON/OFF</p> <ul style="list-style-type: none"> • Move the [POWER] switch to the ON position to turn the speaker ON. • Move the [POWER] switch to the OFF position to turn the speaker OFF. • Press the [L:] button on the remote control to enter/leave standby mode. <p>Volume Adjustment</p> <ul style="list-style-type: none"> • To increase volume, long press the [M-R] button on the speaker or the [VOL+] on the remote control. To decrease volume, press the [L-1/4] button on the speaker or the [VOL-] button on the remote control. • Press the [M] button on the remote control to mute/unmute the speaker. <p>Using the Laser</p> <p>WARNING: When using the laser, do NOT aim or direct toward the eyes or face of anyone nearby as it may cause irreparable damage to one's eyesight. The laser can instantly dazzle viewers, do NOT aim or direct at anyone operating any kind of vehicle, near or far away.</p> <ul style="list-style-type: none"> • Quick press the [L:] button on the speaker or remote control to enable/disable the laser. 	<p>Using the Speaker</p> <p>Playing Music</p> <p>To enjoy music wirelessly on your speaker, make sure you are paired to a Bluetooth-enabled device. Once paired, you can control the media playback and volume adjustment with the controls on your paired device.</p> <p>Playing/Pausing Music</p> <ul style="list-style-type: none"> • To pause media playback, quick press the [M] button on the speaker or remote control. • To resume media playback, quick press the [M] button on the speaker or remote control. <p>Skipping Tracks</p> <ul style="list-style-type: none"> • To skip to the previous track, quick press the [L-1/4] button on the speaker or the [L-1/4] button on the remote control. • To skip to the next track, quick press the [R-1/4] button on the speaker or the [R-1/4] button on the remote control.

Using the Speaker (cont'd)

Using the FM Radio

Once powered ON, long press the [M] button on the speaker. The LED indicator will turn solid RED and the speaker will automatically switch to FM radio mode.

Scanning Stations

- Quick press the [M] button on the speaker while in FM radio mode to have the speaker scan for FM radio stations. The speaker will scan for all nearby stations with a strong enough signal strength and save them as presets.
- Skip through saved stations by quick pressing the [M] and [M] buttons on the speaker or the [M] and [M] buttons on the remote control.

Adjusting Volume

- To adjust volume, long press the [M] and [M] buttons on the speaker or the [VOL+] and [VOL-] buttons on the remote control.

NOTE: For best results, extend the FM antenna cable on the back of the speaker toward an open window or an area with direct line of sight toward the sky.

Using the Auxiliary Input

To use the auxiliary input jack, insert one of the 3.5mm connector of the supplied 3.5mm auxiliary cable into the auxiliary input jack on the side of the speaker. The LED indicator will turn solid BLUE. Insert the other end of the 3.5mm auxiliary cable into the headphone jack of your media-playing device.

All media playback is controlled through the connected device.

Any Bluetooth pairings will be disabled when the auxiliary cable is plugged in. They will automatically re-pair once the cable is disconnected.

Laser Safety Information

This laser product is certified as a Class I Laser product to the requirements of the US Federal Laser Product Performance Standard (FLPPS) contained in the regulations in 21 CFR Subchapter J and EN 60925-1:2014.

A Class I Laser is considered to be safe because the blink reflex will limit the exposure to no more than 0.25 seconds.



The device meets the detectability requirements. Do not attempt to disassemble the unit. This will void the warranty. Use of cosmetics or adjustments or performance of procedures other than those specified herein may result in hazardous radiation exposure. A defective unit must be returned to the manufacturer.

Legal Information

READ THIS CAREFULLY AND SAVE FOR FUTURE REFERENCE

This device is certified for use as a Class B digital device, pursuant to part 15 of the FCC Rules. These limits are designed to provide reasonable protection against harmful interference. This equipment generates, uses and can radiate radio frequency energy and, if not installed and used in accordance with the instructions, may cause harmful interference to radio communications. However, there is no guarantee that interference will not occur in a particular installation. If this equipment does cause harmful interference to radio or television reception, which can be determined by turning the equipment off and on, the user is encouraged to try to correct the interference by one or more of the following:

- Reorient or relocate the receiving antenna.
- Increase the separation between the equipment and receiver.
- Connect the equipment into an outlet on a circuit different from that to which the receiver is connected.
- Consult the dealer or an experienced radio/TV technician for help.

Caution: Any changes or modifications to this device not explicitly approved by manufacturer could void your authority to operate this equipment.

This device complies with part 15 of the FCC Rules. Operation is subject to the following two conditions: (1) This device may not cause harmful interference, and (2) this device must accept any interference received, including interference that may cause undesired operation.

The device has been evaluated to meet general RF exposure requirement. The device can be used in portable exposure condition without restriction.

Legal Information (cont'd)

WARNING Li-Ion Battery Inside

This device contains a lithium-ion battery. Do not damage, open, or dismantle the battery and do not use it in damp and/or corrosive conditions. Use only with compatible chargers. Never dispose of batteries in a fire, and never expose them to high temperatures. Do not expose the product to temperatures exceeding 60°C (140°F).



The crossed-out garbage bin symbol means that you must not dispose of this product together with unsorted household waste.

Rain/Moisture Warning

- Do not expose the unit to extreme temperatures (heat or cold), open flames, humid conditions, or wet conditions.
- Do not submerge in water.
- Do not open this product or attempt to repair the unit yourself should it not be working.

Warranty Information

This product, as supplied and distributed here by AIT, Inc. ("AIT"), to the original consumer purchaser is warranted by AIT against defects in material and workmanship for a period of one year from your date of purchase ("Warranty"). In the unlikely event that this product is defective, or does not perform properly, you may within one year from your original date of purchase return it to the authorized service center for repair or exchange.

TO OBTAIN WARRANTY SERVICE:

- Call the Customer Support number located below, or go to our website portal to receive an SRO number.
- Prepare proof of the date of purchase within the package (dated bill of sale).
- Prepay all shipping costs to the authorized service center, and remember to insure your return.
- Include a return shipping address (no P.O. Boxes), a telephone contact number, and the defective unit within the package.
- Describe the defect or reason you are returning the product.

Your product will be repaired or replaced, at our option, for the same or similar model of equal value if examination by the service center determines this product is defective. Products received damaged as a result of shipping, will require you to file a claim with the carrier.

The shipping address of the authorized service center is:

AIT, Inc. Service Dept. 36
c/o Southern Telecom
400 Kennedy Drive
Sayreville NJ 08872

For further customer service:
Click on Product Support

IN NO EVENT WILL AIT, ITS MANUFACTURERS, DISTRIBUTORS, OR PIRIP HOLDINGS, LLC BE LIABLE FOR ANY INCIDENTAL, DIRECT, INDIRECT, SPECIAL, PUNITIVE OR CONSEQUENTIAL DAMAGES (SUCH AS, BUT NOT LIMITED TO, DAMAGES FOR LOSS OF PROFITS, BUSINESS, SAVINGS, DATA, OR RECORDS) RELATED TO THIS PRODUCT, EXCEPT AS STATED HEREIN. NO OTHER WARRANTIES SHALL APPLY.



PIRIP Holdings, LLC, its Distributors and dealers, fully support all electronic safety initiatives. An responsible, accurate, and complete record of the product's history is maintained. PIRIP Holdings, LLC, will make every effort to ensure that the product is traceable to its source. PIRIP Holdings, LLC, will make every effort to ensure that the product is traceable to its source. PIRIP Holdings, LLC, will make every effort to ensure that the product is traceable to its source. PIRIP Holdings, LLC, will make every effort to ensure that the product is traceable to its source.

