

Installation

Step 1

Connect your Air Vent Clip Fixture to the Wireless Charging Base by screwing in the base into the Swivel Ball and turning the knob clockwise to fasten.

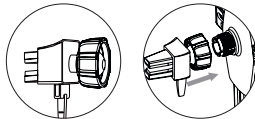

Step 2

Place your smartphone in the dock, directly on top of the charging pad. As you rest your phone in the bracket, the arms will automatically use the pressure of the weight of your phone to deliver a custom-fit and securely hold your device.

Step 3

Connect the unit to one of your vehicle's air vents. Flip the Air Vent Lock switch to the upright position to open up the clip and place the vent clip onto an optimal viewing position. When you have chosen your position, flip the switch to the side to close the clips onto the vent and the clip will close around the air vent blade. The dock is now secured.

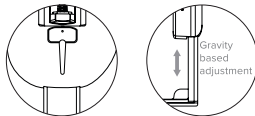

Step 4

Use the Micro-USB charging cable included with your charger to connect the Wireless Charging Base and your vehicle's Car Charger*.



*Car Charger not included. Alogic Cannot guarantee the charging efficiency of your car charger in conjunction with the wireless charging car mount.

Note

- Do not deliberately damage this product and put it in damp, direct sunlight or high temperature environment.
- If improper use, demolition or operation not according to the instructions result in any damage of your device or product, our company will not be liable for any compensation or maintenance responsibility.

NOTE: This equipment has been tested and found to comply with the limits for a wireless power charger, pursuant to Part 18 of the FCC Rules. These limits are designed to provide reasonable protection against harmful interference in a residential installation. This equipment generates, uses and can radiate radio frequency energy and, if not installed and used in accordance with the instructions, may cause harmful interference to radio communications. However, there is no guarantee that interference will not occur in a particular installation. If this equipment does cause harmful interference to radio or television reception, which can be determined by turning the equipment off and on, the user is encouraged to try to correct the interference by one or more of the following measures:

- Reorient or relocate the receiving antenna.
- Increase the separation between the equipment and receiver.
- Connect the equipment into an outlet on a circuit different from that to which the receiver is connected.
- Consult the dealer or an experienced radio/TV technician for help.

CAUTION: Changes or modifications not expressly approved by the party responsible for compliance could void the user's authority to operate the product.

User Quick Guide

Wireless Charger Car Mount

HKWP1100-10Q

Quick Start Guide

Introduction

Air Vent Mount Wireless Charger with Qi Technology is an easy to use car mount with wireless charging for Qi enabled smartphones. gravity link mechanism lets you mount and secure the phone in the optimum position for wireless charging with minimal effort and easily unmount the phone with a single-handed operation.

The innovative design lets you mount the device to your Air Vent with ease.

Specifications

Model	HKWP1100-10Q
Input	DC 5V-2A, 9V-1.67A
Output	DC 5V-1A 9V-1.1A
Conversion	>=72%
Dimensions	101 x 73 x 83mm
Compatibility	All Qi enabled devices

Features

- Lets you mount and secure the phone in the optimum position for wireless charging with a single-handed operation
- The wireless car mount charger can be mounted onto your air vents.
- Equipped with Strong, Elastic & Slip-proof Clips, the charger can be securely mounted on the car air vent.
- Soft rubber padding on the elastic clips provides enhanced protection to your phone when mounted
- Warranty: 1 Year

Package Contents

- Wireless Charging Car Mount x 1
- 1m Micro USB cable x 1
- User Manual x 1

Physical Layout

- Fast Wireless Charging Pad
- Micro USB Power Input Port
- LED Indicators
- Air Vent Clamp Mount
- Air Vent Lock
- Phone Holder

