

FEBO FLAME™

WIFI WITH ELECTRIC FIREPLACE

User Manual

MODEL: ZHS-32-D

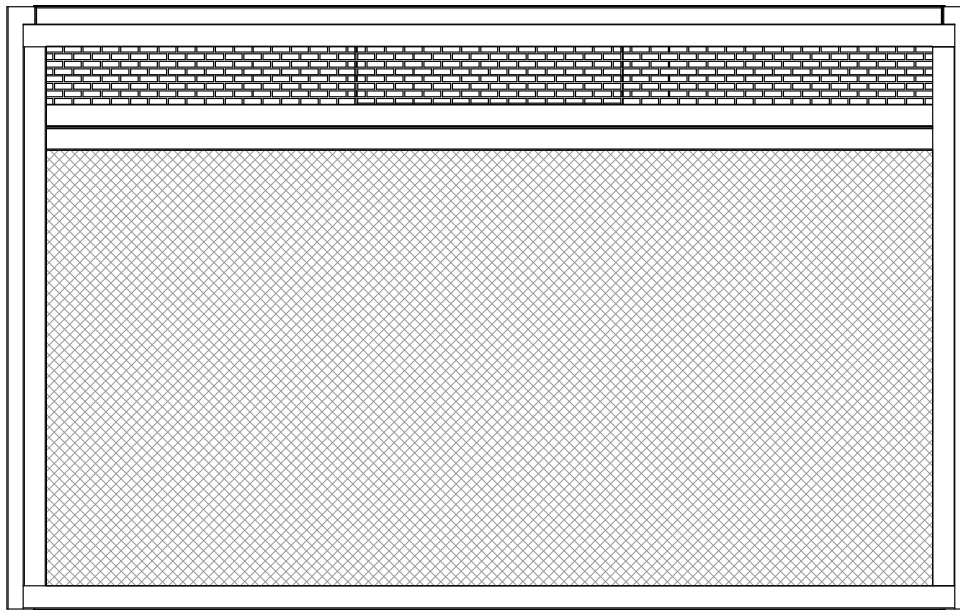

**PLEASE READ THIS MANUAL CAREFULLY FOR ELECTRIC FIREPLACE INSERT BEFORE INSTALL AND USE.
PLEASE DO NOT RETURN ANY PRODUCT TO STORE. FOR ANY MISSING PARTS, HARDWARE OR ASSEMBLY
PROBLEMS, PLEASE CONTACT WITH OUR CUSTOMER SERVICE CENTER.**



EASY TOP (HK) ENTERPRISES LIMITED

524 South Main St, Joplin, MO 64801

TOLL FREE: 1-866-949-3838 EMAIL: support@easytop.com.cn

IMPORTANT SAFETY INSTRUCTION

WARNING: Any use of this appliance other than that recommended by the manufacturer in this owners manual may cause fire, burns, electric shock and/or other serious injuries or death.

When using electrical appliance, basic precautions should always be followed to avoid the risk of fire, electric shock and injury to persons including the following:

1. **Read all instructions before using this appliance.**
2. This appliance is hot when in use. To avoid burns, do not let bare skin touch hot surface. If provided, use handles when moving this appliance. Keep combustible materials, such as furniture, pillows, bedding, papers, clothes, and curtains, etc. at least 3 feet (0.9 meter) away from the front of the appliance. Keep all items away from the sides and rear.
3. Extreme caution is necessary when the appliance is used by or near children or invalids and whenever the appliance is left operating and unattended.
4. Always unplug appliance when not in use. **This unit should be operate under supervision and should not be left on without supervision.**
5. Do not operate any appliance with a damaged cord or plug or after the appliance malfunctions, has been dropped or damaged in any manner. Return appliance to authorized service facility for examination, electrical or mechanical adjustment or repair.
6. Do not use outdoors.
7. This appliance is not intended for use in bathrooms, laundry areas and similar indoor locations. Never locate appliance where it may fall into a bathtub or other water container.
8. Do not run cord under carpeting. Do not cover the power cord with throw rugs, runners, or similar floor coverings. Arrange cord away from traffic area and where it will not be tripped over.
9. To disconnect the appliance, turn all controls "OFF", then remove the plug from the electrical outlet.
10. Connect to properly grounded outlets only.
11. Do not insert or allow foreign objects to enter any ventilation or exhaust openings as this may cause an electric shock or fire, or damage the appliance.
12. To prevent a possible fire, do not block air intakes or exhausts in any manner. Do not use on soft surfaces, like a bed, where openings may become blocked.
13. All electrical appliances have hot and arching or sparking parts inside. Do not use in areas where gasoline, paint, or flammable liquids are used or stored.
14. Use this appliance only as described in this manual. Any other use which is not recommended by the manufacturer may cause fire, electric shock, or injury to persons.
15. **It is strongly recommended that to use the entire 15 amp outlet for the electric fireplace only.** Sharing the outlet with another electronic item could create overload and damage the outlet and electric items in the long term.
16. Avoid using an extension cord because the extension cords may overheat and cause a risk of fire. However, If an extension cord **MUST** be used, the cord must be No. 14AWG minimum size and rated not less than 1875 Watts. The extension cord must be a 3-prong cord with grounding type plug and cord connection and should not exceed 20' (6m) in length.
17. When transporting or storing the appliance, keep both the unit and power cord / plug dry, free from excessive vibration and away from heat sources to avoid causing fire, electric shock, or injury to persons.
18. Do not attempt to burn wood or other materials in this appliance.
19. This appliance, when installed must be electrically grounded in accordance with the current.

Canada: CSA C22.1, Canadian Electrical Code
U.S.A.: ANSI/NFPA NO. 70, National Electrical Code

SAVE THESE INSTRUCTIONS

ITEM# 384-15A-20-33A
MODEL# 16IN-32-110

OPERATING INSTRUCTIONS

Read all instructions and warning prior to operating the appliance.

Ensure that all controls are in the “OFF” status before plugging the appliance into a properly grounded electrical outlet.

This appliance is for use on 120 Volts. The appliance has a 3-prong grounded plug (Figure 1.A). If your electrical outlet has only 2 slots (Figure 1.B), you will have to use an adapter (Figure 1.C) to convert from the 3-prong power cord to a 2-slot receptacle. The green grounding plug extending from the adapter must be securely connected to a permanent ground such as a properly grounded outlet box. The adapter should only be used if a proper 3-slot receptacle is not available.

NOTE: Adapters are not allowed for use in Canada.

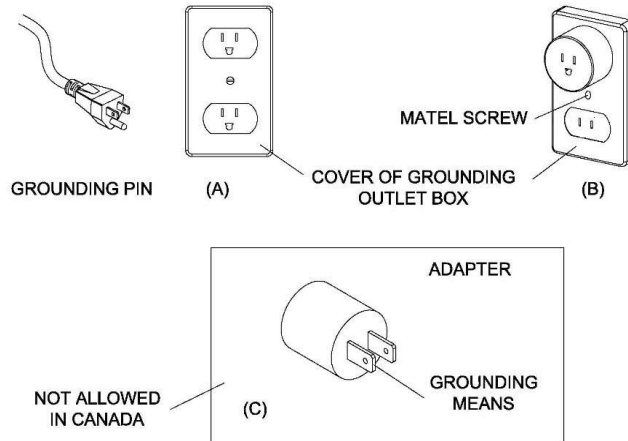

Figure 1

A 15 AMP circuit is required to operate this appliance. If the breaker trips when the appliance is running, you may need to move the appliance to another location or unplug other appliances that are on the same circuit.

The fireplace control functions can be accessed in two ways:

- Using the button control panel, located in the upper right-hand corner of the fireplace
- Using the multifunction remote control

The main control panel is located at the top right corner on the front (see Figure 2).

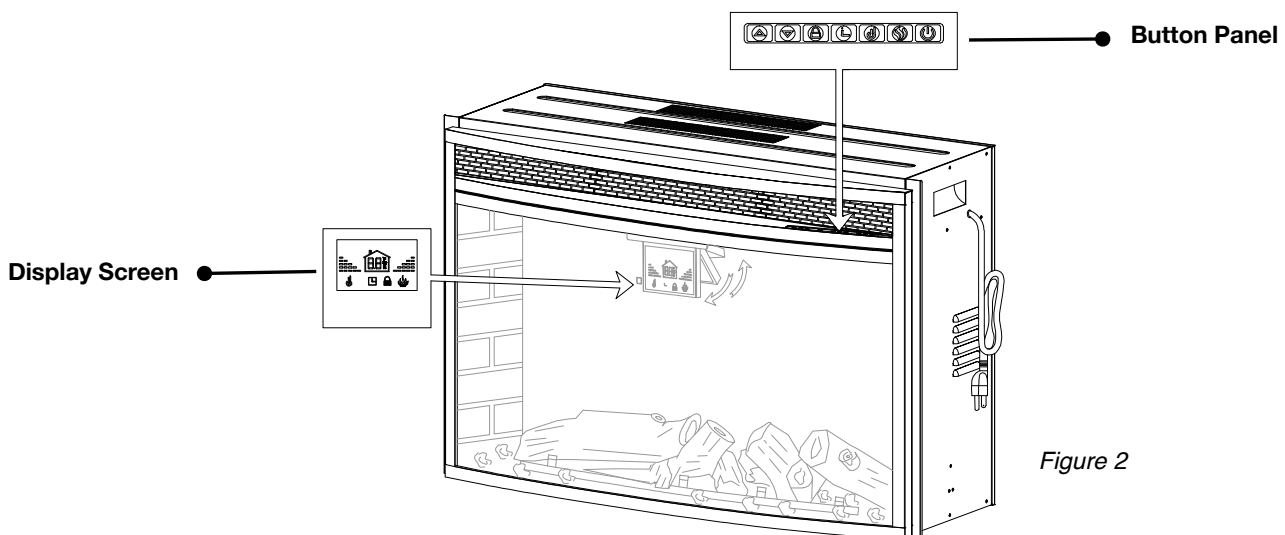

Figure 2

OPERATING INSTRUCTIONS

Using the Control Panel: (Locate in Figure 3)

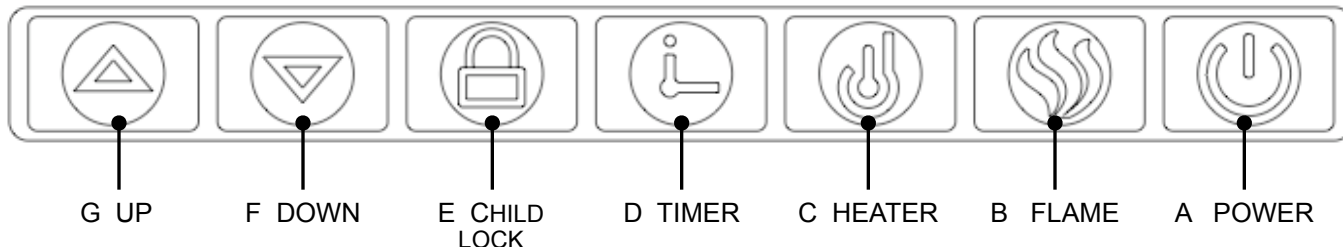

Figure 3

Power(Figure 3.A):

- ◆ The POWER button supplies power to all the features of the fireplace. This button must be ON for any of the features to work properly.
- ◆ You can turn ON the fireplace either by press the POWER button on the Control Panel or the POWER button on the Remote Control (Reference to Page 6).
- ◆ Once turn OFF, all current settings will be stored except Timer and then restored at the next power ON. Unplug the unit will reset the setting to factory default.

Flame Button (Figure 3.B):

- ◆ The FLAME button controls the flame feature and the ember effect ON and OFF.
- ◆ When you press the FLAME button to be ON mode, the intensity of the flame will be dimming on from LOW to HIGH in 3 seconds. When you press the FLAME button again in OFF mode, the flame will be dimming off from HIGH to LOW in 8 seconds.
- ◆ The default setting of the flame is highest flame flame setting, Press UP(G) or DOWN(F) button, you can adjust the flame brightness, there are 5 levels of the brightness.
- ◆ When operating this button, the Display Screen FLAME icon will be twinkling (See Figure 4.B),
- ◆ When you are adjusting the flame brightness with UP(G) and DOWN(F) button, the Display Screen will show corresponding brightness level base on wave number (See Figure 4.F).
- ◆ This feature can also be control with Remote Control (Reference to Page 6).

Heater Control (Figure 3.C):

- ◆ The HEATER button controls the heat ON and OFF feature, It can be used to switch the temperature reading on the Display Screen.
- ◆ The default setting of the heating feature is highest temperature 95F(35C).
- ◆ There are total 7 heating levels from HIGH to LOW (95F/35C to 65F/18C), with press UP(G) or DOWN(F) button, the heating temperature can be set in 5F/3C interval.
- ◆ Press and hold the HEATER button 6 seconds, user can switch between Fahrenheit (F) and Celsius(C) in the Display Screen.
- ◆ When operating this button, the Display Screen HEATER icon will be twinkling. (See Figure 4.C).
- ◆ When turn off the heating feature, the inner blower will continue run 30 seconds to cool down the unit to protect the heating elements before the fireplace completely shuts off.

Timer Control (Figure 3.D):

- ◆ The TIMER button controls the TIMER feature ON and OFF.
- ◆ Press UP(G) or DOWN(F) button, you can set the turn off time from 0.5H to 8H with 0.5H interval.
- ◆ Once TIMER is set, the fireplace will be continue running in its current status until the timer countdown to 0.
- ◆ When operating this button, Display Screen TIMER icon will be twinkling. (See Figure 4.D)
- ◆ This feature also can be control with the Remote Control (Review Page 6).

IF THE FIREPLACE STOP WORKING, THAT ALL FUNCTION BUTTONS CAN NOT BE OPERATING. PLEASE TURN OFF THE FIREPLACE POWER AFTER 8 SECONDS. THEN RESTART.

OPERATING INSTRUCTIONS

Using the Control Panel: (Locate in Figure 3)

Child Lock (Figure 3.E):

- ◆ The CHILD LOCK button controls the locking feature of the fireplace, it can lock all control features on the Control Panel and Remote Control except the child lock on Remote Control,
- ◆ Press and hold the CHILD LOCK button 6 seconds, the locking features can be activated, The CHILD LOCK icon in Display Screen displays locked (See Figure 4.E). All fireplace features are disabled. All the Control Panel buttons and Remote Control are deactivated.
- ◆ Press the CHILD LOCK button on Control Panel 6 seconds again to resume the control functions of Control Panel and Remote Control.

Down(Figure 3.F):

- ◆ Coordinating with FLAME / HEATER / TIMER button, use this DOWN button to decrease.
- ◆ Without press FLAME / HEATER / TIMER button, press this button for the function of the last time used.
- ◆ When FLAME / HEATER / TIMER is not activated, this button will not work.

Up (Figure 3.G):

- ◆ Coordinating with FLAME / HEATER / TIMER button, use this UP button to increase.
- ◆ Without press FLAME / HEATER / TIMER button, press this button for the function of the last time used.
- ◆ When FLAME / HEATER / TIMER is not activated, this button will not work.

Display Screen: (Locate in Figure 4)

Press any key except POWER key on Control Panel and Remote Control, the Display Screen flip down after 3 seconds, it display the current using functions. Without further operations, the Display Screen will automatic flip back up after 17 seconds.

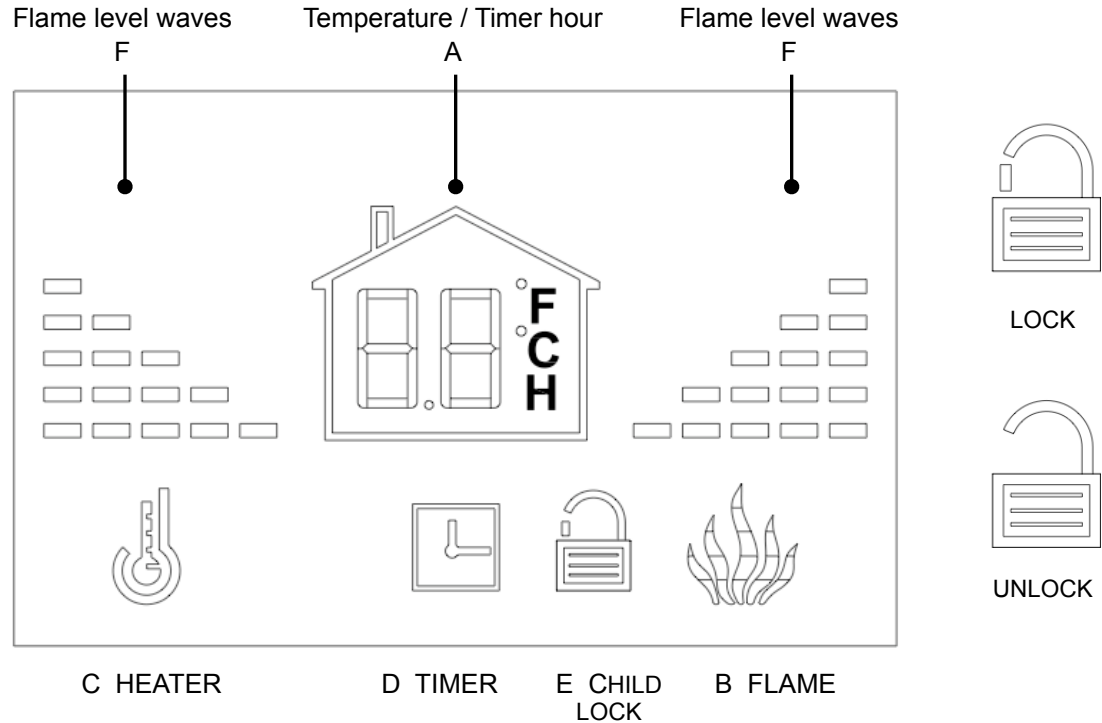

Figure 4

OPERATING INSTRUCTIONS

This fireplace includes a Remote Control. See below for directions to use the Remote Control:

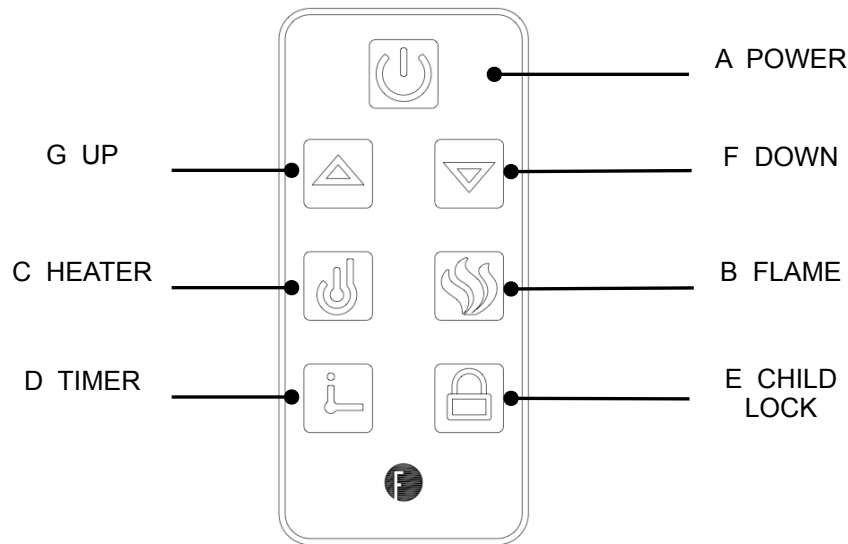

Figure 5

Using the Control Panel: (Locate in Figure 5)

The Remote control comes preassembled with a working battery and a insulation plastic film. Please remove the insulation plastic film from the battery before start using the Remote.

Buttons on the Remote control (as Figure 5 shows) have the same functions as describe above in the page 4 and 5 for the Control Panel (as Figure 3 shows) except below features.

CHILD LOCK button (Figure 5.E)

- ◆ Unlike the same button on the Control Panel, while operate with the Remote control, you just need to press the button to cycle through the CHILD LOCK setting instead of press and hold on the Control Panel.

Warning: Changes or modifications to this unit not expressly approved by the party responsible for compliance could void the user's authority to operate the equipment.

This device complies with Part 15 of the FCC Rules. Operation is subject to the following two conditions: (1) This device may not cause harmful interference, and (2) this device must accept any interference received, including interference that may cause undesired operation.

NOTE: This equipment has been tested and found to comply with the limits for a Class B digital device, pursuant to Part 15 of the FCC Rules. These limits are designed to provide reasonable protection against harmful interference in a residential installation. This equipment generates, uses and can radiate radio frequency energy and, if not installed and used in accordance with the instructions, may cause harmful interference to radio communications.

However, there is no guarantee that interference will not occur in a particular installation. If this equipment does cause harmful interference to radio or television reception, which can be determined by turning the equipment off and on, the user is encouraged to try to correct the interference by one or more of the following measures:

- Reorient or relocate the receiving antenna.
- Increase the separation between the equipment and receiver.
- Connect the equipment into an outlet on a circuit different from that to which the receiver is connected.
- Consult the dealer or an experienced radio/TV technician for help.

OPERATING INSTRUCTIONS

- ◆ There are total 7 adjustable levels from highest to lowest, when the fireplace is first turned on the HEATER will come at the highest temperature 95F/35C, and the lowest temperature is 65F/18C. Press UP and DOWN button to adjust the heater level, 5F/3C each press.
- ◆ When adjusting the flame brightness with UP and DOWN button, the display screen will display the heater setting in using accordingly with either Fahrenheit (F) or Celsius degrees (C). Without further operations, the display screen display room temperature after around 6 seconds. (See Figure 4.A)
- ◆ Once turn off the HEATER, the blower will exhaust air cooling for 1 minute before shut off.

Timer Control (Figure 5.D):

- ◆ This button controls the TIMER on/off.
- ◆ When operating this button, display screen TIMER icon twinkle (See Figure 4.D).
- ◆ Press UP and DOWN button to adjust the timer form 0.5 to 8H, 0.5 hour each press. The display screen will display the timer setting in using accordingly (See Figure 4.A).
- ◆ Once TIMER is set, the whole control system will be shut off after the time was set. During this time, the other functions still can be operated.

Child Lock (Figure 3.E):

- ◆ Press the CHILD LOCK once to activate the child-lock function, once this function is activated, all the other buttons be locked, the display screen CHILD LOCK icon display locked (See Figure 4.E).
- ◆ Press the CHILD LOCK button for 6 seconds again to unlock the control system, and the other buttons can be operated again, the display screen CHILD LOCK icon display unlock (See Figure 4.G).

DOWN(Figure 5.F):

- ◆ Coordinating with FLAME / HEATER / TIMER button, use this DOWN button to decrease.
- ◆ Without press FLAME / HEATER / TIMER button, press this button for the function of the last time used.
- ◆ When FLAME / HEATER / TIMER is not activated, this button will not work.

Up (Figure 5.G):

- ◆ Coordinating with FLAME / HEATER / TIMER button, use this UP button to increase.
- ◆ Without press FLAME / HEATER / TIMER button, press this button for the function of the last time used.
- ◆ When FLAME / HEATER / TIMER is not activated, this button will not work.

MAINTENANCE

WARNING: Before attempting to perform any maintenance on this appliance, turn all controls to the "OFF" position and then unplug. Allow the appliance to be "OFF" for at least 10 minutes before performing any maintenance in order to allow all components to cool properly.

Cleaning:

1. Use a clean dry cloth to clean the fireplace.
2. To remove fingerprints or other marks from glass window, use clean damp cloth. Do not spray glass cleaner or other liquids directly onto the window.
3. Clean metal surfaces with a clean damp cloth making sure not to push dust or debris into any air intake or exhaust vents.
4. Do not use abrasive cleaners or spray liquids on any part of the appliance.
5. Periodic cleaning/vacuuming of the fan/heater unit is strongly recommended to ensure that no dirt or foreign objects build up.

Use range must be greater than 20 cm away from human body.

TROUBLE SHOOTING

WARNING: Turn off the appliance, unplug and let cool for at least 10 minutes before attempting to service. Only a qualified professional should attempt to service or repair the appliance.

PROBLEM	POSSIBLE CAUSE	SOLUTION
Simulated Flame Effect is dim or not present	<ol style="list-style-type: none">1. Dimmer control button is set too low.2. LED strip not functioning.3. "Flame wand" has come loose from bracket.4. "Flame wand" motor is not functioning.	<ol style="list-style-type: none">1. Push flame button to increase light.2. Contact customer service center at toll-free no. 1-866-949-38383. Remove screws holding back panel in place and remove back panel. Secure end of "Flame wand" back into the support bracket.4. Contact customer service center at toll-free no. 1-866-949-3838
The appliance turns off and will not turn back on	<ol style="list-style-type: none">1. The overheat protection device in the appliance has been triggered.2. House circuit breaker has been tripped.	<ol style="list-style-type: none">1. Turn all controls off, unplug the appliance, allow the insert to cool down for at least 10 minutes, and then plug in and restart.2. Reset house circuit breaker.
The appliance does not turn on when the button is pushed to "ON"	The overheat protection device in the appliance has been triggered.	Turn all controls off, unplug the appliance, allow the insert to cool down for at least 10 minutes, and then plug in and restart.
Remote control does not work	<ol style="list-style-type: none">1. Low batteries.	<ol style="list-style-type: none">1. Replace all batteries in the remote control.

NOTE: If you experience difficulties, please do not return this product to store. Any missing parts, hardware or assembly problems, please call our customer service center at 1-866-949-3838.

ONE YEAR LIMITED WARRANTY

PLEASE DO NOT RETURN ANY PRODUCTS TO STORE, ANY MISSING PARTS OR HARDWARE OR ASSEMBLY PROBLEMS, PLEASE CONTACT WITH OUR CUSTOMER SERVICE CENTER AT 1866-949-3838.

The following non-transferable limited warranty applies is extended only to the original consumer-purchaser of this EASY TOP (HK) Enterprises Limited (EASY TOP) product. This product is only warranted against defects in material and workmanship subject to the normal and reasonable use and correct installation of the product for a period of one (1) year from the date of purchase.

This warranty is made to the original owner, provided that the purchase was made through an authorized supplier of the company. Any unauthorized repair, alteration, misapplication, careless handling, improper installation, willful abuse, accident, or misuse of the product shall nullify this warranty. This warranty does not apply to the normal wear and tear. This warranty does not cover light bulbs. The duration of all implied warranties on this particular purpose are limited to the one (1) year duration of the express warranty period specified above.

In no event will EASY TOP be liable for any incidental or consequential damages (including loss of profits) arising from the use of this product. Some jurisdictions do not allow limitations on how long an implied warranty lasts / or do not allow the limitation or exclusion of incidental or consequential damages, so these implied warranty limitations may not apply to you. This limited warranty gives you specific legal rights. You may also have other rights which vary from jurisdiction to jurisdiction. Repair or replacement, at EASY TOP's option, of a defective product is your sole remedy under this limited warranty. In no event will EASY TOP's maximum liability exceed the purchase price of the product paid by the consumer/purchaser.

If replacement parts are needed or to obtain performance of any obligation under this limited warranty, phone EASY TOP's Customer Service Center.

Be prepared to provide evidence of purchase date and proof of purchase, model number of your EASY TOP product, part number and defective part. Register your product within ten days to ensure your warranty. You must pay all expenses incurred in obtaining performance of any obligation under this limited warranty, including transportation, postage, and other incidental service costs. If defective part or parts are requested by Customer Service Center, you must make the product available to us free and clear of all liens and other encumbrances. EASY TOP reserves the right to change prices, specifications and designs and to discontinue models without notice and without incurring obligations.

These limits are designed to provide reasonable protection against harmful interference in a residential installation. This equipment generates, uses, and can radiate radio frequency energy and ,if not installed and used in accordance with the instruction manual, might cause harmful interference to radio communications.

However, there is no guarantee that interference will not occur in a particular installation. If this equipment does not cause harmful interference to radio or television reception, which can be determined by turning the equipment off and on, the user is encouraged to try to correct the interference by one or more of the following measures:

- Reorient or relocate the receiving antenna
- Increase the separation between the equipment and receiver
- Connect the equipment into an outlet on a circuit different from that to which the receiver is connected.
- Consult the dealer or an experienced radio/TV technician for help.

The Remote Control requires 1 Lithium Coin Cell Battery (size CR2025, which is included).

- DO NOT mix old and new batteries.
- DO NOT use rechargeable silver oxide cell batteries with remote control unit
- DO NOT mix alkaline, standard(Carbon-Zinc), or rechargeable(Nickel-Cadmium) batteries.
- DO NOT dispose of batteries in fire. Improper disposal may cause batteries to leak or explode.

APP UI Interface Manual

Using WiFi function to connect the mobile phone with this device(WiFi with electric fireplace)

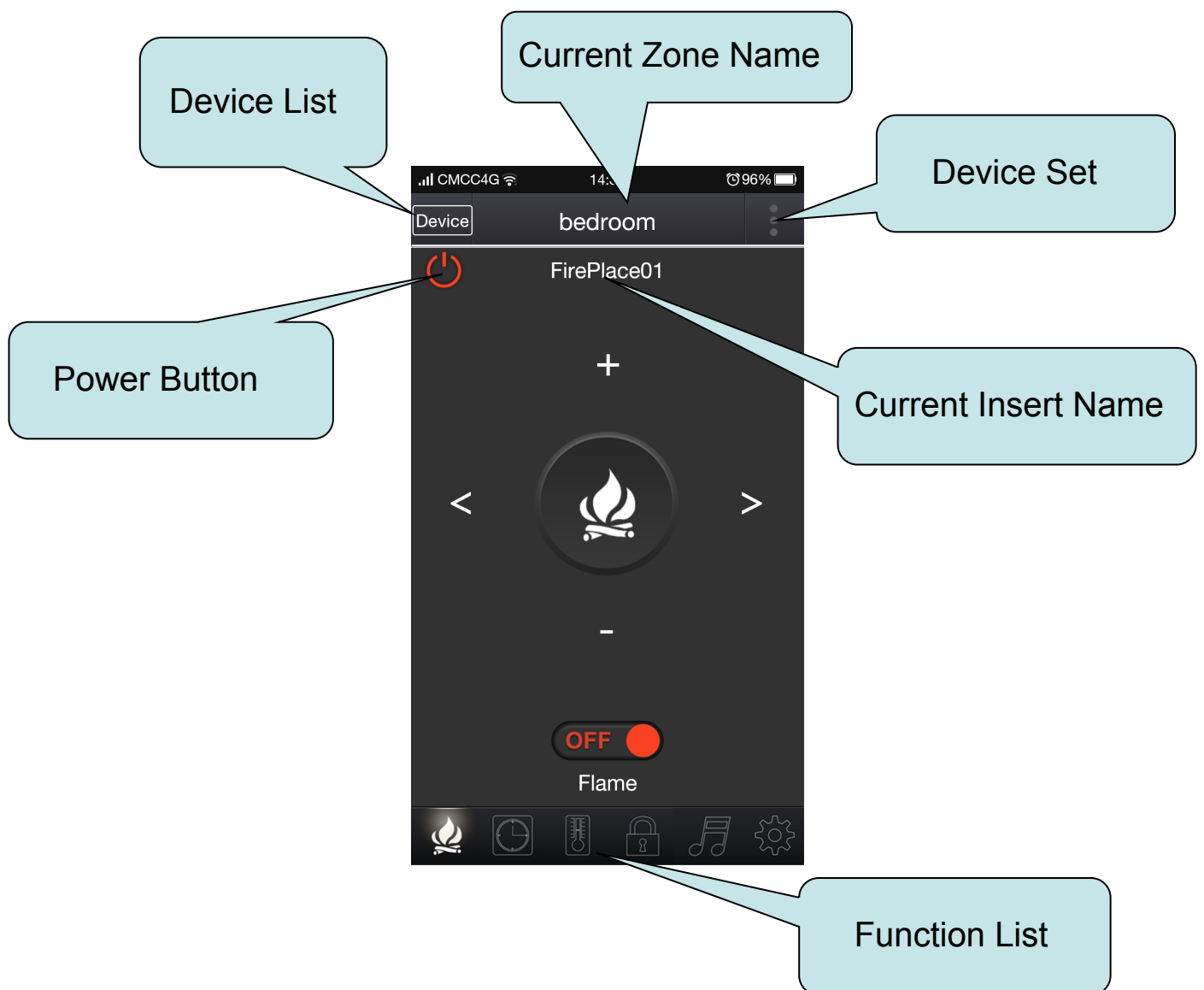

FLAME CONTROL:

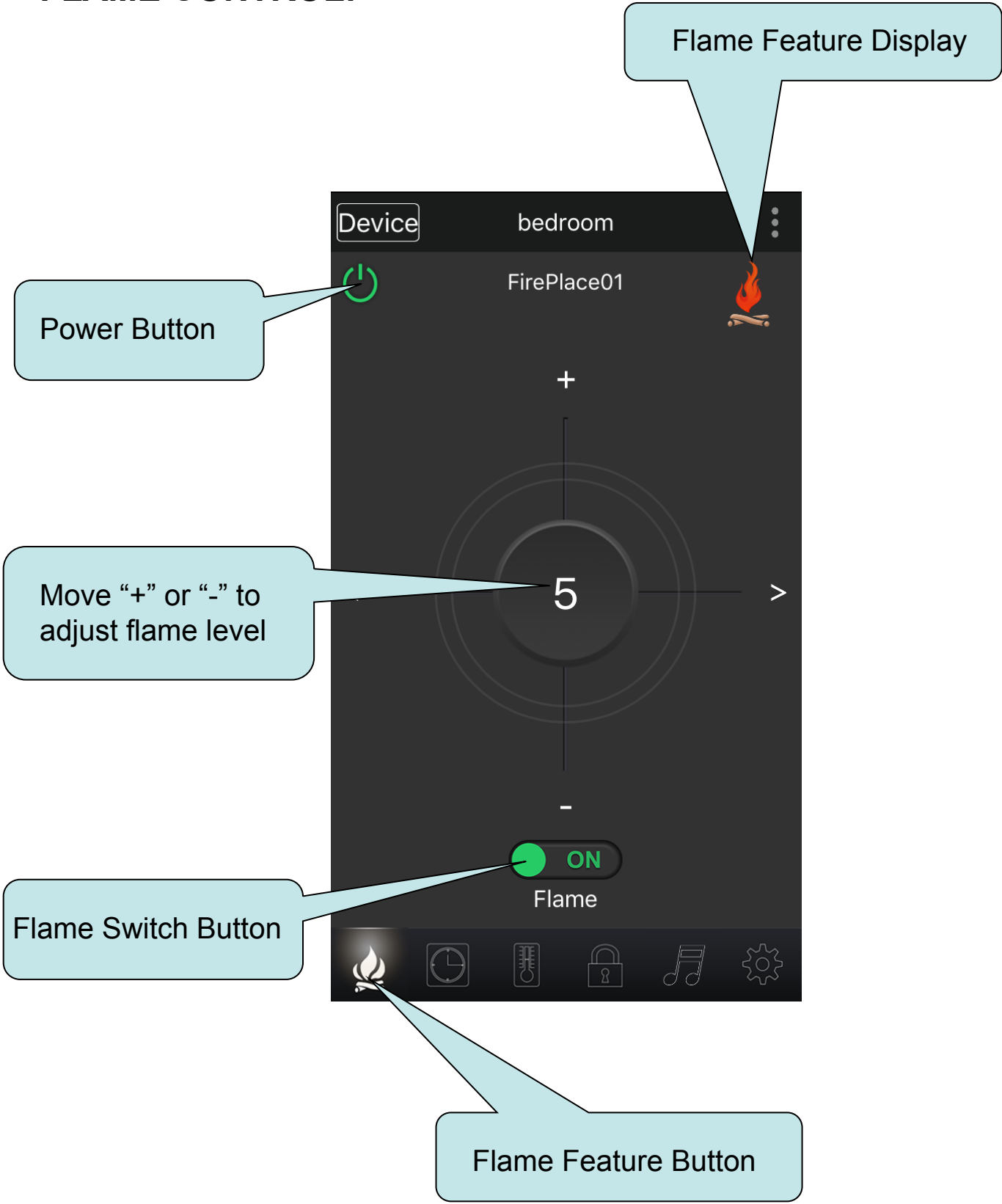

TIMER CONTROL 1:

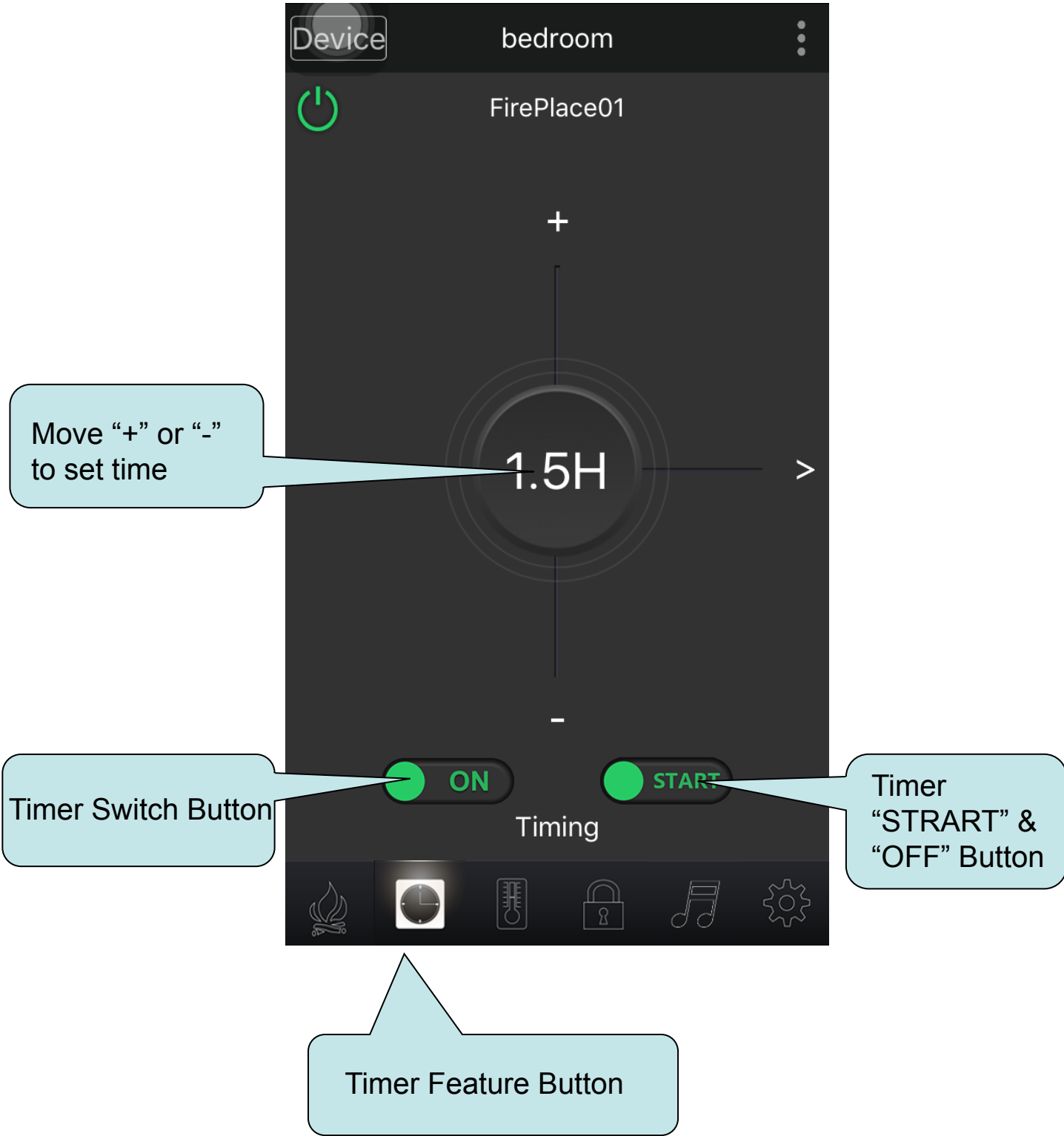

TIMER CONTROL 2:

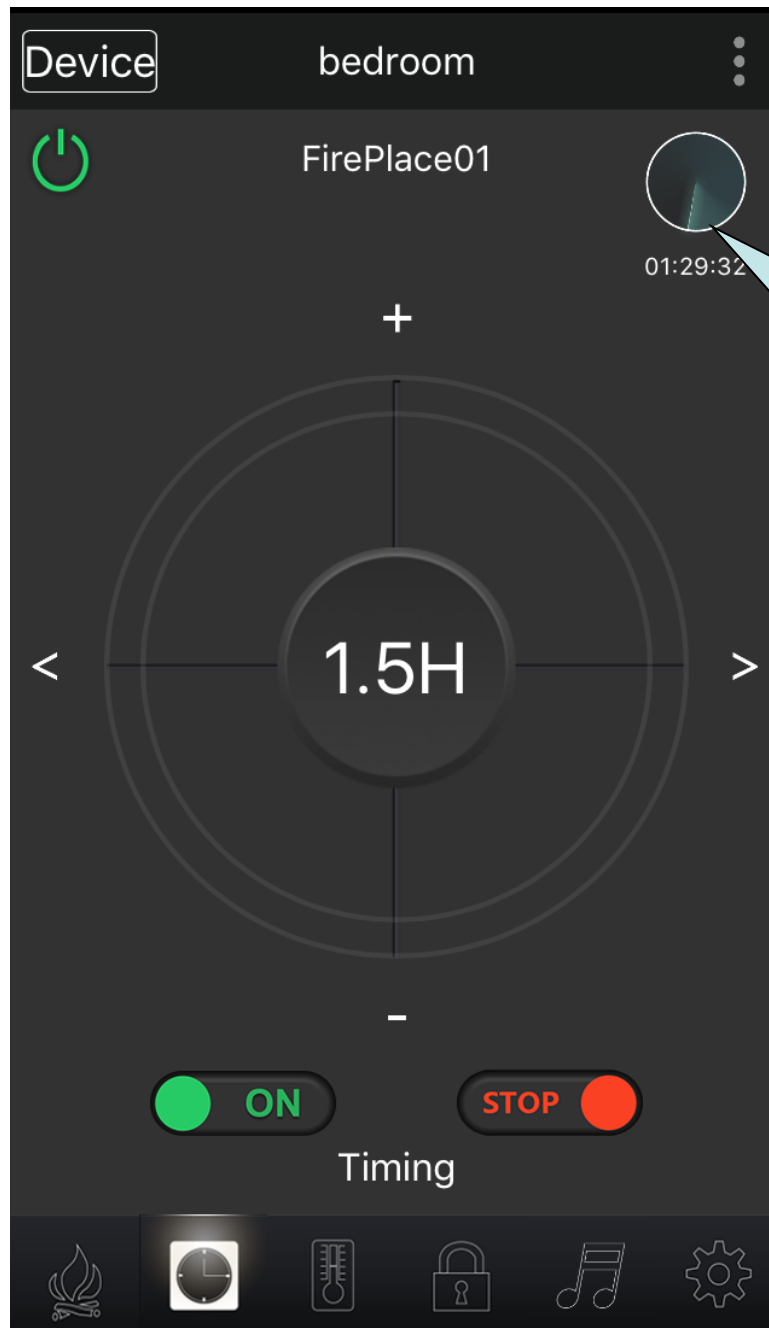

HEATER CONTROL:

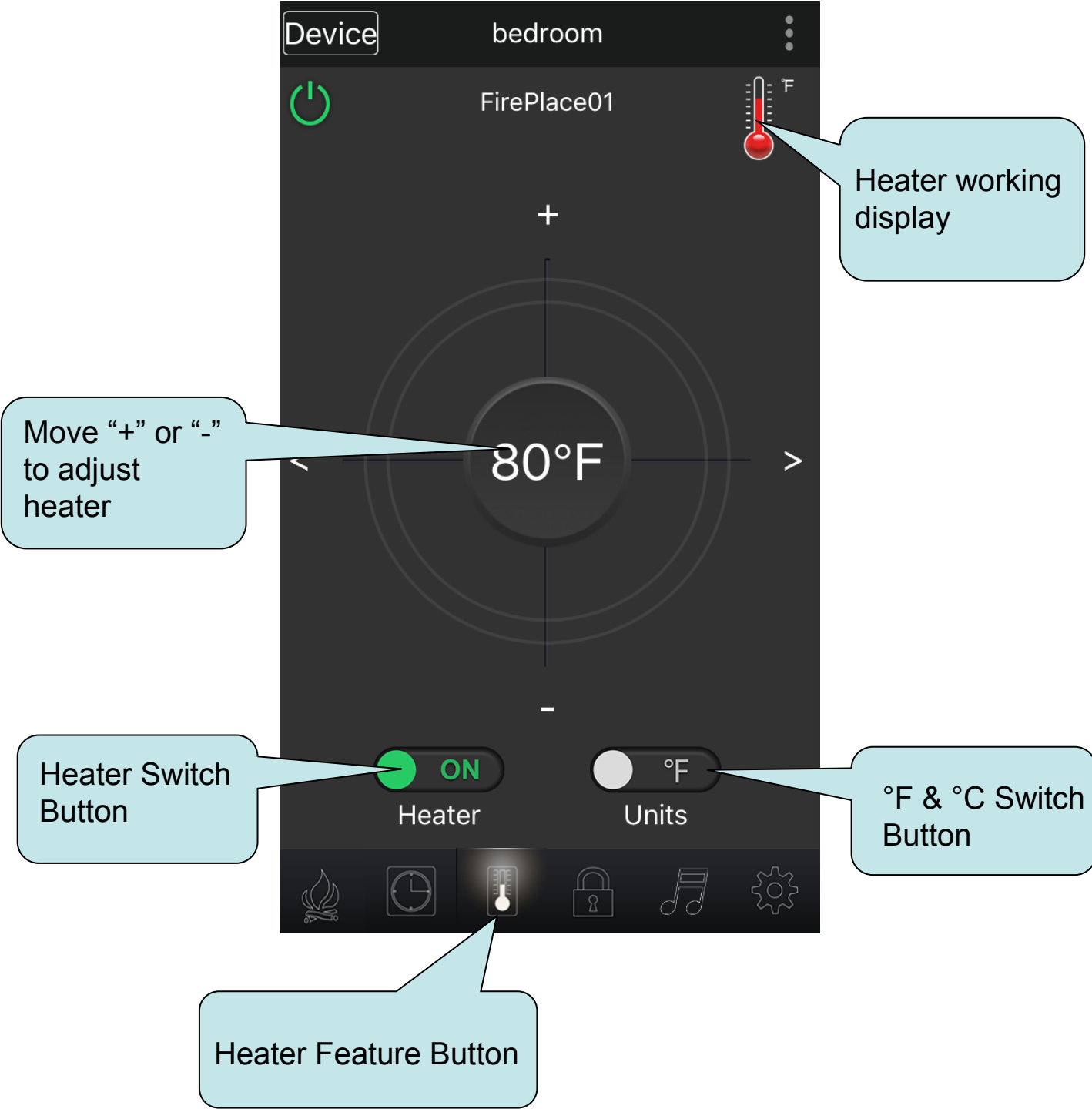

CHILD LOCK:

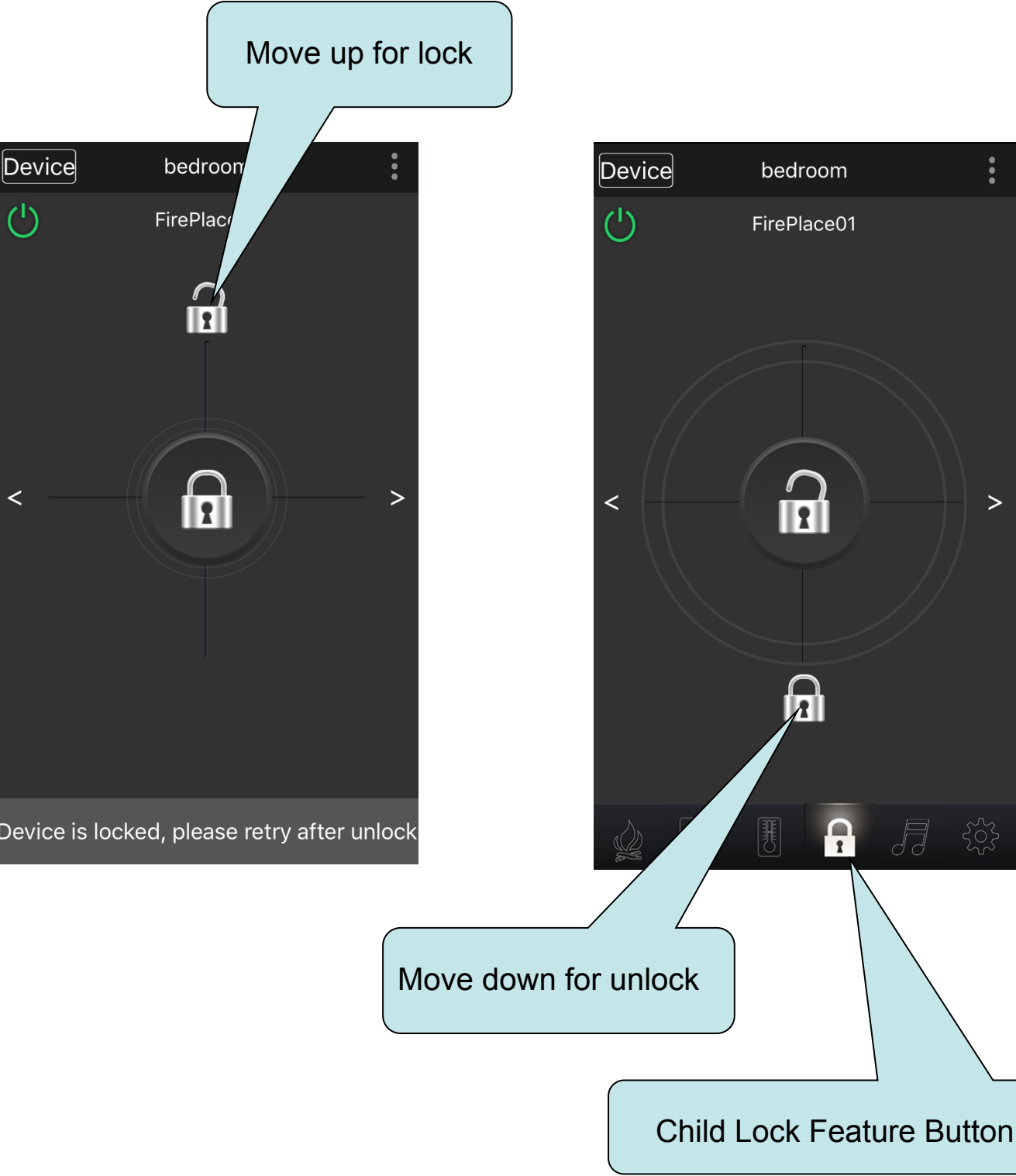

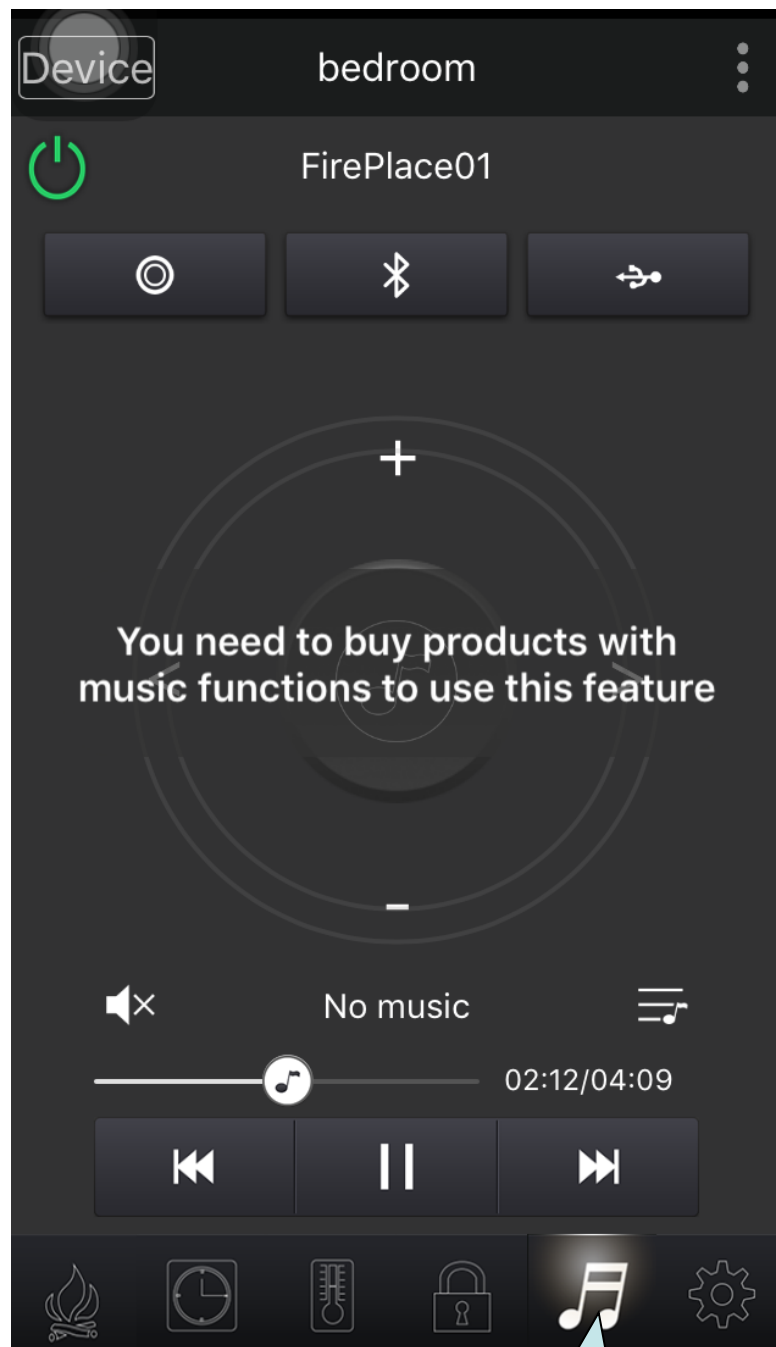

Music Feature Button.
Can not use now.

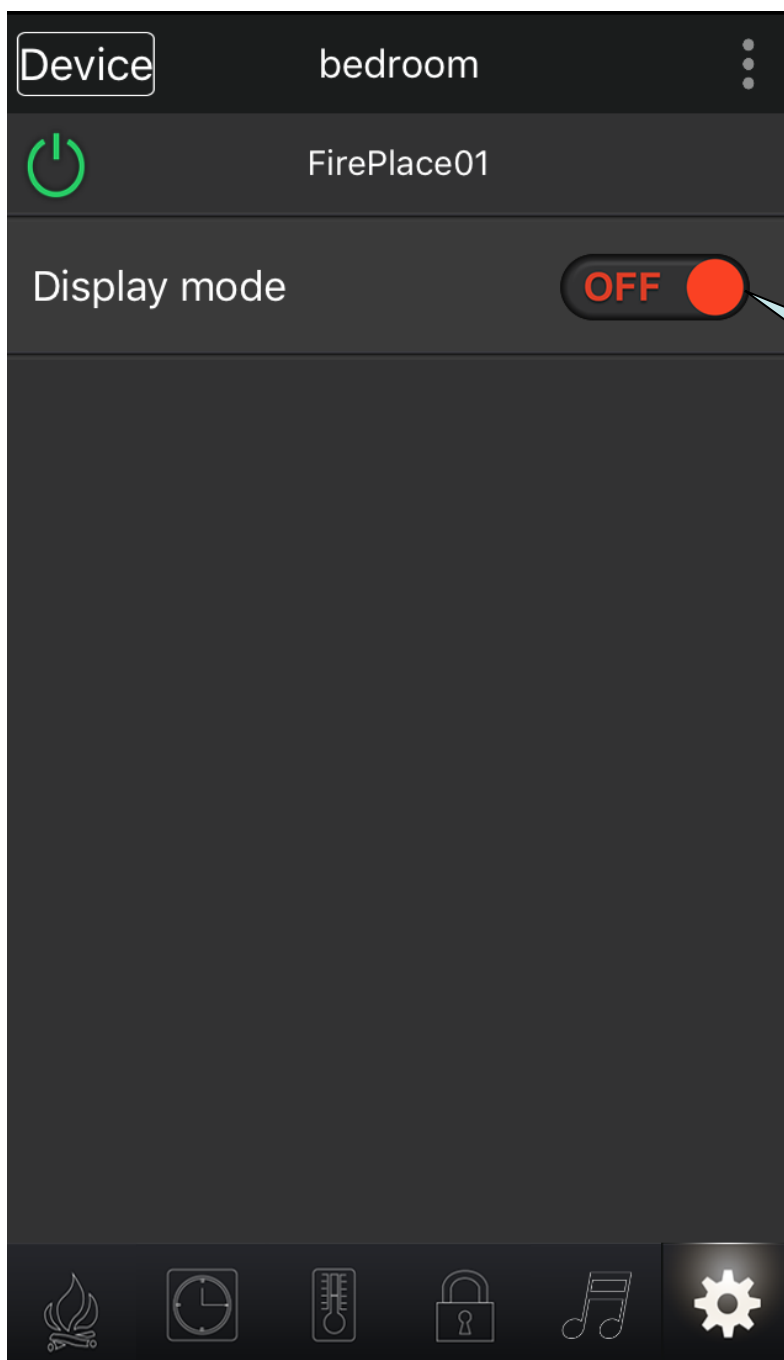

Display Switch Button.

This function must be **off** for operate other function normally.

Set Button

Device List

