

JISIWEI
Not Just A Robot

[HTTP://WWW.JISIWEI.COM](http://www.jisiwei.com)

Shen zhen JISIWEI Intelligent Technology Co., Ltd.

JISIWEI
Not Just A Robot

Smart vacuum cleaning robot
Clean Your House and Share Your Family



Operating Instructions

JISIWEI Cleaning Robot

USER GUIDE

Shen zhen JISIWEI Intelligent Technology Co., Ltd.

Dear Jisiwei Owner,

Thank you for purchasing a robot vacuum cleaner! You've joined the millions of people who clean with robots - the smarter way to get it done.

To get the best performance from your Jisiwei product, please take a moment to read this manual and get acquainted with it, you will know how to use and maintain the robot vacuum cleaner, and it will help you solve the possible problems.

There needs continuous innovation in the future, Jisiwei listens to our customers and makes enhancement to our robots based on your valued feedback. Welcome to visit our website www.jisiwei.com to tell us about your experience with our robot.

Thanks for your support!

Now, let's start a nice journey!

Yours,

Shen zhen JISIWEI Intelligent Technology Co., Ltd.

Tips:

1. Please read all safety and operating instructions before operating your robot
2. Please follow all operating and use instructions.
3. Please clean side brush, main brush, universal wheels timely. Suggest to empty dustbin and filter after every use, so that the robot can do the best service for you!
4. Use robot frequently. Always keep robot charged when not in use, remove the battery from robot and store in a cool, dry place.

Catalogue

1. Product features	1
1.1 Product function	1
1.2 Application	1
1.3 Cleaning Mode	2
2. Using Method	3
2.1 The robot appearance	3
2.2 APP description	4
2.3 Function key description	17
2.4 Remote control	18
2.5 Charging base	20
3.Regular Maintenance	22
3.1 Daily cleaning and brush replacement	22
3.2 Battery replacement	23
4. Troubleshooting	24
4.1 FQA	24
4.2 Common fault	24
4.3 Precautions	25
5. Safety instruction	26

1: Product features

1.1 Product function summary



Automatic cleaning



Intelligent identification of dust



Across obstacle design



Low noise design



Fall-arrest design



Ultra-thin body



Real-time video transmission



Remote control function



Automatic recharge



APP Remote control

1.2 Application

This robot works on wood, tile, marble, short carpet, vinyl and laminate, and adjusts automatically to different floor types.



The robot is only for indoor use, not suitable for water and wet floor. DO NOT use the device to sweep anything that is flammable and explosive (like lighted cigarette) or place it around high volatile liquid (such as gas, cleaning naphtha).

1.3 Cleaning mode

The robot vacuum cleaner has following cleaning modes, it can convert automatically during the cleaning.

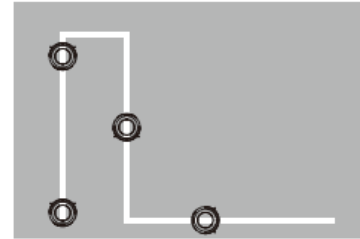

●Auto mode

Auto mode is a high-efficient cleaning mode

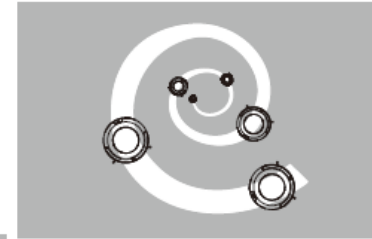

●Wall following

Enable to clean the corners of room

●Spot mode

Enable to quick clean key area of garbage centralized.

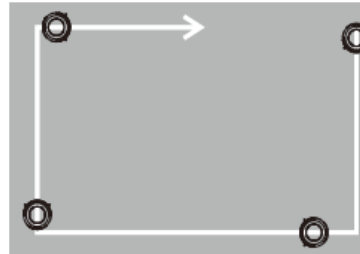

●Random mode

Random cleaning, ensure that no residual at corners.

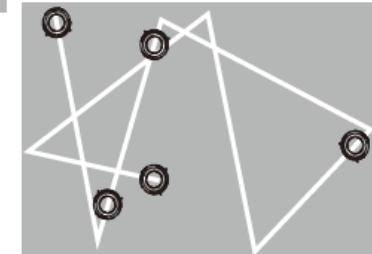

2. Using method

2.1 The robot appearance

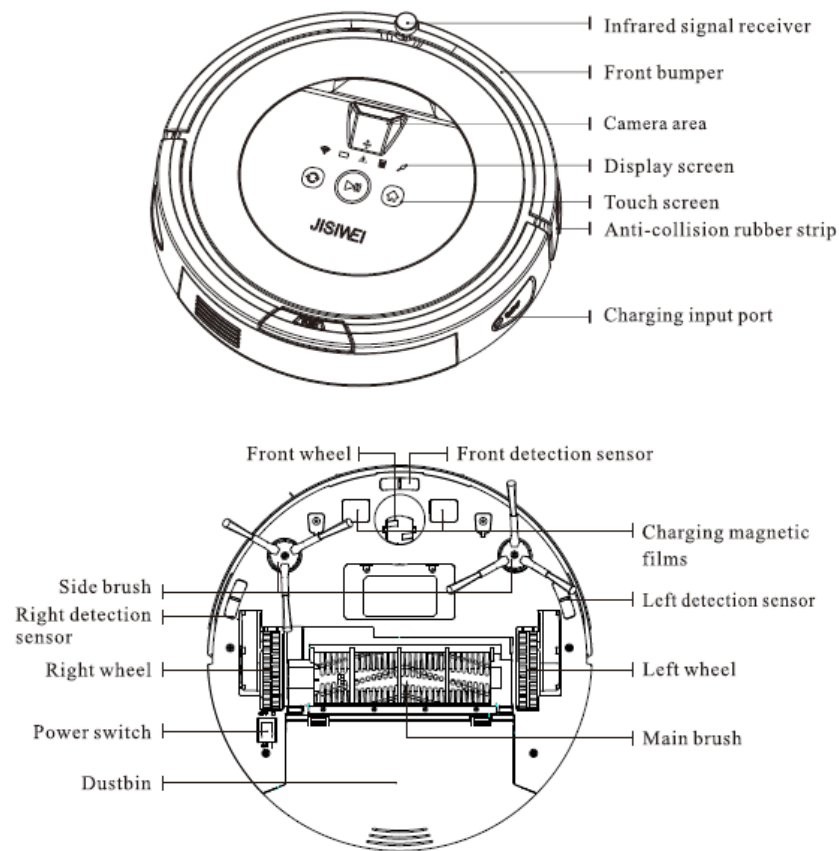

Please charge the robot for 8 hours before using it in the first 3 times, make sure the battery is in a saturation condition.

2.2 APP Instructions of JISIWEI Cloud Guardian Cleaning Robot

2.2.1 Preparing step: bind the robot and APP

2.2.1.1 Connect your phone to WiFi access.

2.2.1.2 Search "JISIWEI" in Apple Store or Google Play, and download JISIWEI APP.



2.2.1.3 Open the APP and register an account with your Email, then click "Login" to enter the main interface.

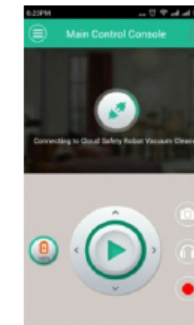
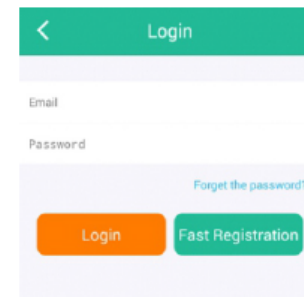

2.2.2 Scan and bind the robot

2.2.2.1 If no device has been bound :

Open the APP and register an account with your Email,click "Login" to enter and a pop-up window in 3s promptsyou to bind a device, click "Go to Bind" and align QR codeat the bottom within frame to scan, after receiving the tips, enter a device name(such as Robot 1),and then click "OK"to finish the binding process, as shown below:



2.2.2.2 If a device has been bound and you want to bind a new one:

In main interface, click the menu at the top left → Main Control Console

Select “Device Manager” to enter and click “Scan QR Code” at the top right, as shown below:

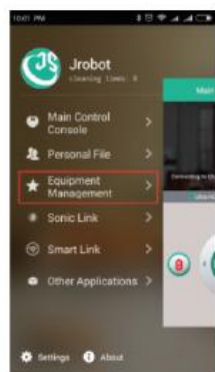

Use your phone camera to scan QR code at the bottom of the cleaning robot, and enter a name for the device (such as “Robot 1”), then click “OK” to confirm, and now the device is bound.

Note: each cleaning robot can be bound with two APPs at most and two of them can control the cleaning robot at the same time. If it fails to bind the device, please operate as the pictures shown below:



JISIWEI smart cleaning robot has three ways for WLAN connect including Smart WLAN Connect, Sonic WLAN Connect and Manual WLAN Connect, the first two ways are advised. Now let's learn the details:

Smart WLAN Connect

A: In main interface, select “Smart WLAN Connect” item

B: Turn on the power key on the robot and wait for blue indicator flashing, it shall keep flashing for 20s-3min. If no flashing, please click “No flashing?”, and check why.

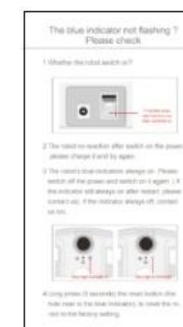

C: If it is flashing, click “Blue indicator is flashing” to enter the next interface, select a WLAN network to be connected and enter correct password, then click: “Join”.



If it fails to connect WiFi access, please click “Any requirements for the robot to WiFi?” and view the solutions, as shown below:



D: Click “Join” and wait until the network is connected, APP shall automatically go back to the main interface when the network connection is successful, click “Start to Play” key on the screen to view videos or control the robot via APP; if it couldn’t control the robot by APP, please exit and login again, as shown below:

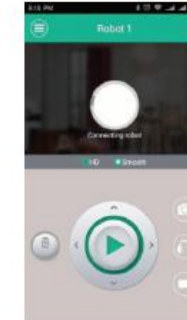

Note:

- 1) Make sure WiFi environment is good;
- 2) It shall automatically join the WLAN network that has ever been connected.

Sonic WLAN Connect

A: In main interface, select “Smart WLAN Connect” item

B: Turn on the power key on the robot and wait for blue indicator flashing, it shall keep flashing for 20s-3min. If no flashing, please click “No flashing?”, and check why.



C: If it is flashing, click “Blue indicator is flashing” to enter the next interface, select a WLAN network to be connected and enter correct password, then click : “Join”.



If it fails to connect WiFi access, please click “Any requirements for the robot to WiFi?” and view the solutions, as shown below:

D: Please follow the voice prompt to increase the phone's sound volume and close it to the robot (within 1 meter), click “Next”, as shown below:

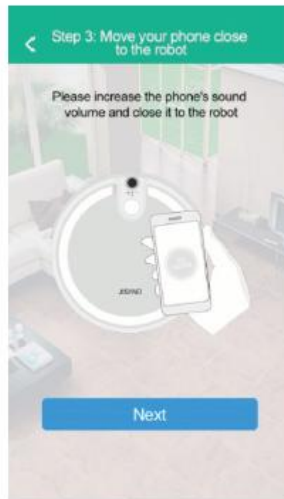

E: Click “Send Sonic Wave” button and follow the voice prompt, when you hear “network setting is successful, it’s restarting for network access”, click “Next”; if you didn’t hear the voice prompt, please click “I didn’t hear the voice prompt of connecting success?” and view the solutions, as shown below:

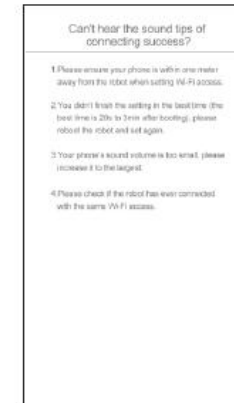
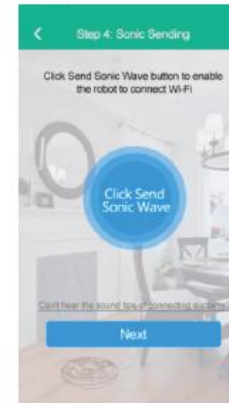

F: Click “Next” and wait until the network is connected, APP shall automatically go back to the main interface when the network connection is successful, click “Start to Play” key on the screen to view videos or control the robot via APP; if it couldn’t control the robot by APP, please exit and login again, as shown below:



Note:

- 1) Make sure WiFi environment is good;
- 2) Please keep your phone close to the robot within one meter;
- 3) It shall automatically join the WLAN network that has ever been connected.

Manual WLAN Connect:

A: In case that the robot's WiFi Hotspot is turned on, you may connect your phone with this hotspot for network access in phone's settings (e.g.: account: JSW336743, no password), as shown below:

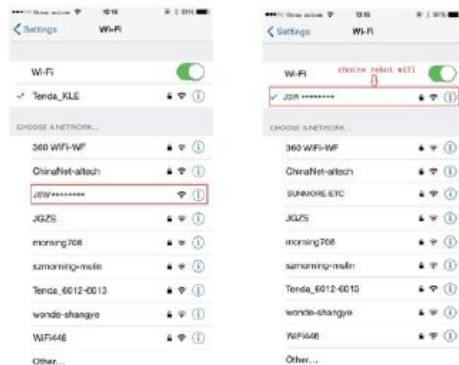

B: Enter APP and click "Settings" item and select "WLAN Settings" in pop-up dialog box, as shown below:

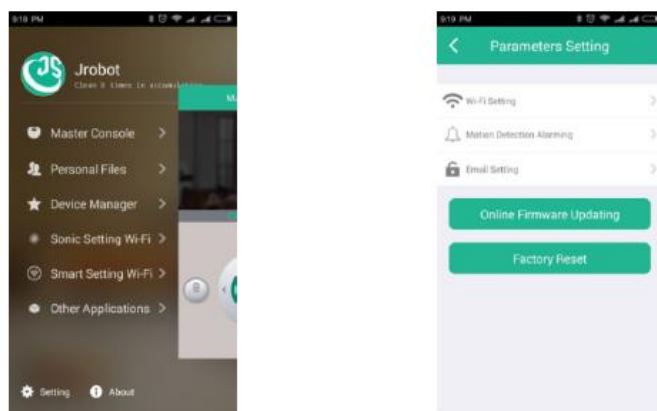

C: Enter local WLAN account and password (such as office or home), click "Save" at the top right corner, as shown in the left picture below; at this moment, you shall hear "network setting is successful, it's restarting for network access", now your phone has been already connected with the robot.

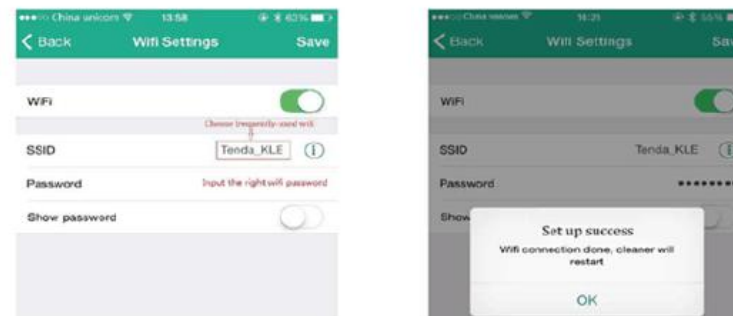

2.2.3 APP Functions and Operations

Note: those APP functions and operations are available only when the robot has been connected with network access.

2.2.3.1 Device Switching

If you buy or bind several JISIWEI cleaning robots, you may enter "Master Console" in main interface to switch the devices, as shown below:

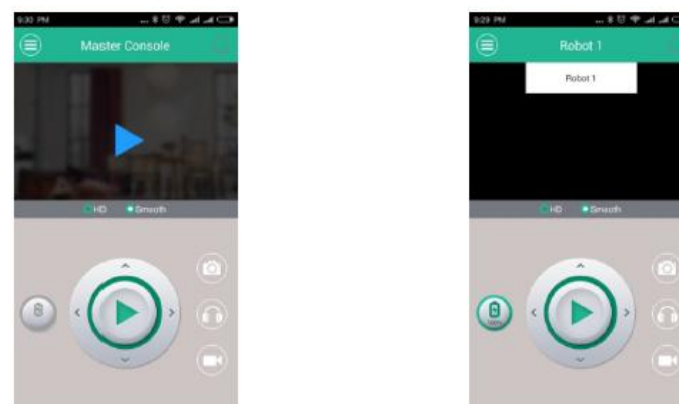

2.2.3.2 Definitions of Function Keys

▶: Start/Pause, press this key to start or pause the robot; four arrow keys around are used to control the robot's moving direction (up/down/left/right); 🔋: battery level, when the battery is low, press this key to make the robot go to charge automatically; 📷: capturing a photo, 🎧: monitoring, 📹: video recording; when the robot is connected with APP, you may press 🎧 key to turn on/off the monitoring function, and press 📷 or 📹 key to capture a photo or record video, the photo/video shall be saved in APP's Personal Files. Function keys of the master console are shown as below:



2.2.3.3)Video Resolutions Switching

Three resolutions are available for video recording including Smooth (480P), HD (720P), Ultra HD (1080P), you can select and switch the resolutions according to the network environment; higher resolution needs a better network environment; if it's not so smooth to play the video, it means the network environment is not good enough, please select lower resolution mode. The default mode is Smooth, as shown below.

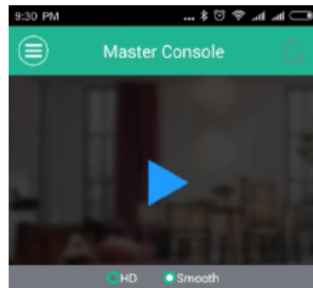

2.2.3.4)Personal Files

In main interface, enter "Personal Files" item to view, play the photos/videos or share to QQ, WeChat, MicroBlog..., as shown below:

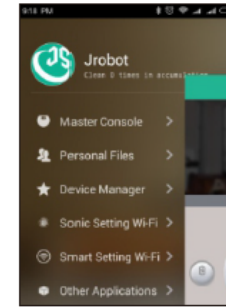

2.2.3.5)Change Personal Info

Enter "Master Console" and click menu icon on the left to enter personal information interface, here you can change your head portrait, password, nickname, sex and family area, as shown below; click "Back" to save and return to the last interface.

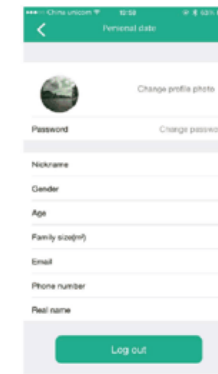
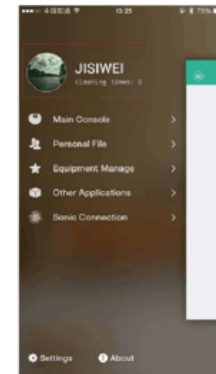

2.2.3.6)Motion Detection Alarming

JISIWEI Cloud Guardian Cleaning Robot is designed with remote control function via high definition camera for you to observe and guard your house; the robot shall send an alarm once any motion or sound is detected, so as to protect your home against burglar, fire and other safety risks. Motion detection is armed as follows:

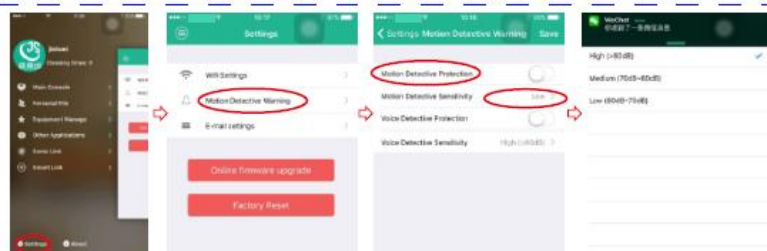

Enable Motion Detection function and select Motion Detection Sensitivity, then click “Save” at the top right corner.

When any object is moved, the robot shall send alarm to the bound APP, the alarm message shall be displayed on the right of Master Console in APP.



Audio Detection is armed as follows:

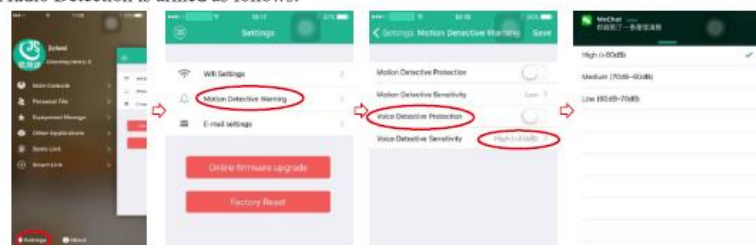

Enable Audio Detection function and select Audio Detection Sensitivity, then click “Save” at the top right corner.

When any sound is detected, the robot shall send alarm to the bound APP, the alarm message shall be displayed on the right of Master Console in APP.



2.2.3.7)Online Firmware Update

This function is mainly available for WiFi camera module, enter “Settings” and select “Online Firmware Update” to update the firmware, the process shall take three minutes or so; the robot shall reboot after being updated, and you may use all APP functions without other additional settings. The updating process is described as below:

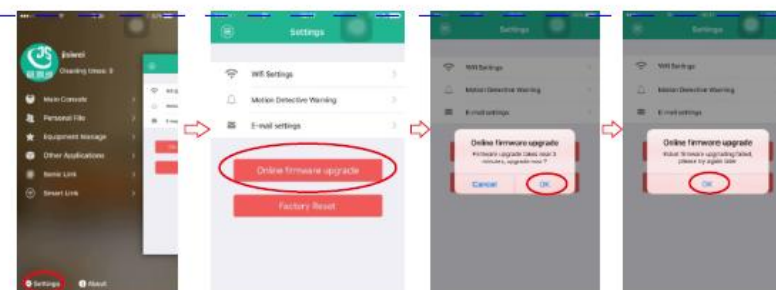

2.2.3.8)Reset

After this operation, all parameters of WiFi module shall restore to factory settings; the robot shall reboot automatically and you need to ste WLAN access again after being reset. (note:only the network settings are restore, not the binding, if you want to unbind, please contact our official customer service)

There are two methods for factory reset:

A: restore via APP in phone, operations are described as follows:

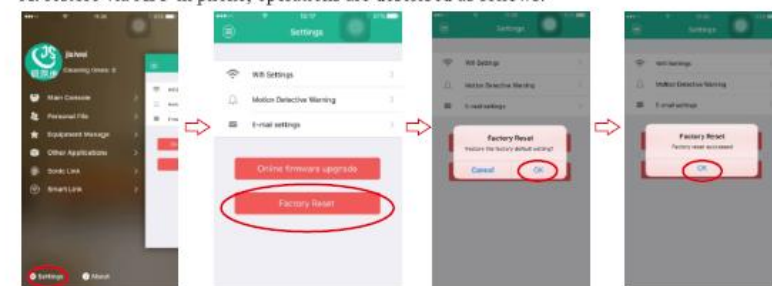

B: Press the combined key to restore factory settings.Extended press the focus cleaning button and automatic recharge button to do factory reset.

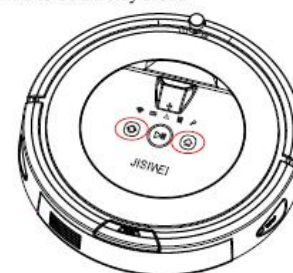

2.3 Function key description

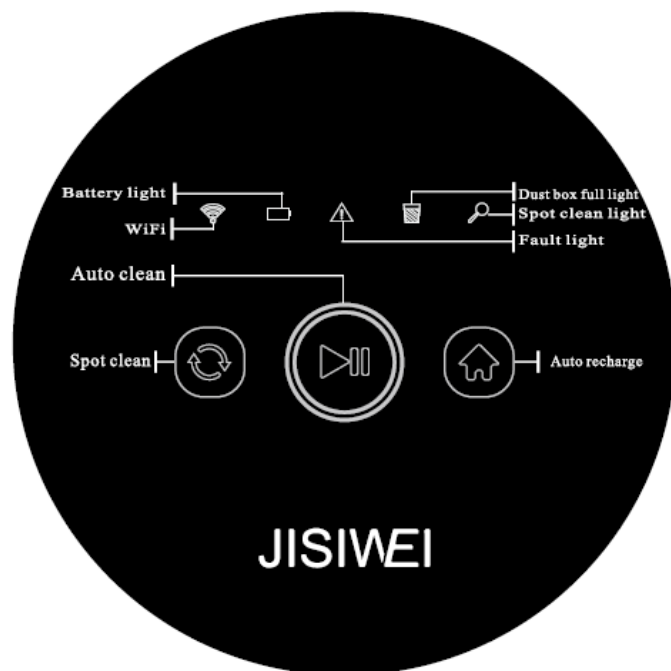

	Auto clean		WiFi
	Auto recharge		Battery light <small>Green says full battery Orange says low battery Red says very low battery</small>
	Spot clean		Fault light
	Spot clean light		Dust box full light

2.3.1 On-off

Turn robot on at the bottom switch of machine, Sweep the floor machine issued a "master hello, JisiweiCloud robot to serve you " after boot into the standby interface, The robot goes into sleep mode if not operate in 20S.

When robot is in sleep mode, only button is valid, the others are in vain.

2.3.2 Auto clean

1. The robot in sleep mode is open to stand-by when pressing button once.
2. Start to auto clean when pressing button at second time, And issued a "began to automatic cleaning" voice prompt;
3. Stop working and return to stand-by when pressing button at third time.
4. The robot will go into sleep mode if not operate in 20s or press button in 3s and a "beep" heard.

2.3.3 Spiral cleaning

1. Press button in stand-by interface to spiral spot cleaning, press button to stop cleaning.

2.3.4 Auto recharge

1. Press button in stand-by interface, the robot can find charge base to charge automatically.

2.4 Remote control

The remote control let you control robot functions conveniently. You can use it to turn on/off and steer it around your room without bending down. Before using your remote, please install 2xAAA battery.

The applicable space of remote control is 3~5 meter, otherwise it can not be used.

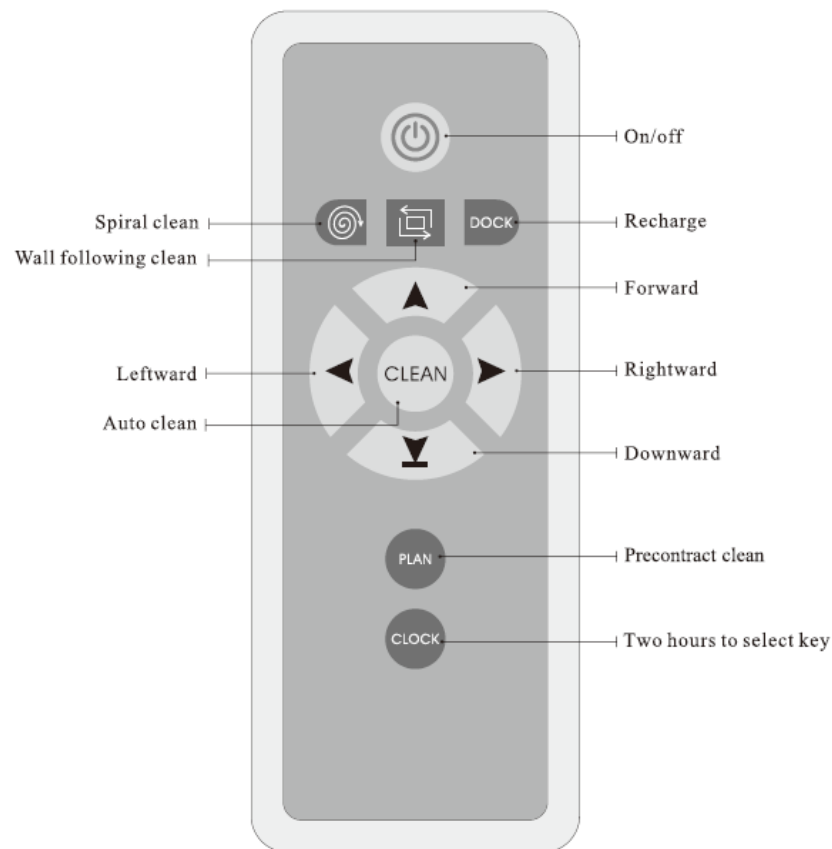

2.4.1 ON/OFF

1. Press to open and enter the stand-by interface when the robot is in sleep mode, then the buttons are in valid. The robot goes into sleep when pressing at other times.

2.4.2 Auto Clean

Press to clean automatically in stand-by interface, press return to stand-by interface.

2.4.3 Spiral clean

1. Press to start spiral clean

2.4.4 Wall following clean

1. Press to start wall following clean.

2.4.5 Auto Recharge

1. Press to charge automatically

2.4.6 Manual clean

1. Press , robot moves , loosen the button then stop.
2. Press , robot moves , loosen the button then stop.
3. Press , robot moves , loosen the button then stop.
4. Press , robot moves , loosen the button then stop.

2.4.7 To make an appointment to clean

1. Press the Begin to make an appointment.
2. Press the Two hours after cleaning.



When using remote control, please be far away from virtual wall and charge base.

2.5 Charging base

2.5.1 Auto recharge

At the end of a cleaning cycle or when robot's battery is running low, it returns to the charging base to charge. Robot needs to find the infrared signal of the charging base in order to return. Always keep the base plugged in. When the charging base is plugged in, its power light blinks red to indicate the base is connected to the power source.

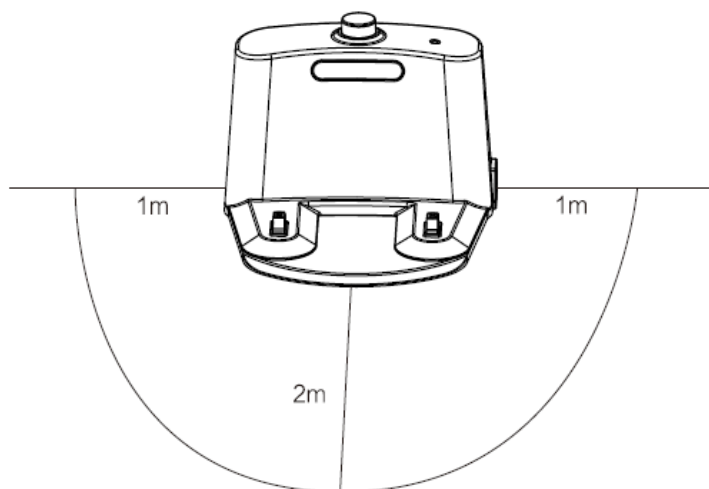

▲Note: Make sure there is no obstacles within the scope of 1m from left and right sides, and the scope of 2m in front of charge base.

2.5.2 Other charge mode

Ensure that power on at the robot bottom, put the robot on the charging base, a red indicator light says it is charging.

Ensure that power on at the robot bottom, unplug input terminal of power adapter that is connected with charging base, Sweeping opportunity "charging connection is successful" voice prompt panel charge fashion at the same time,



Always wipe robot bottom and contact clip of charging base with dry cloth, to prevent dusts lead to poor contact. When charging, be sure to switch on the robot.

3: Regular Maintenance

3.1 Daily cleaning and brush replacement

3.1.1 Empty the dustbin

Empty dustbin after each use. When installation again, please insert dustbin accurately.

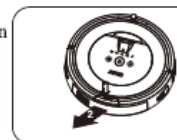

4.3 Raise middle brush upward lightly from one side of bearing steel.



3.2. Replace filter

Remove dustbin, open HEPA cover to take it down. Replace new HEPA and back to install.



4.4 Clean or replace middle brush, install brush to suitable replace.



3.3. Clean or replace side brush

Using a small screwdriver unscrew the screws on the center of side brush, take side brush down, clean or replace brush, then install with screws.



5. Clean the dust sensor
5.1 Take the dustbin down, clean the dust sensor with dry cloth.

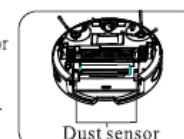

4. Clean or replace middle brush

4.1 Take dustbin down firstly.

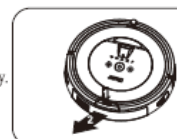

6. Clean the ground detection sensor
Clean up 3 ground detection sensors with dry cloth.



4.2 Open two buttons and remove the cover.

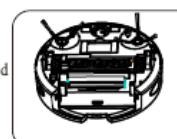

The robot is at failure occasionally, please do not worry, because it has fault diagnosis system. The screen will display fault code (details in line 4.2 of P24), the user can diagnose troubles through reading the manual.



Please turn off the power before cleaning the robot. If do not install brush shaft, the robot can not be opened. If the front wheel is jammed by hair or rubbish, it will not be moved, and easy to damage the floor, so regular checking and cleaning is needed.

3.2 Battery replacement

Please follow the following steps to remove battery:

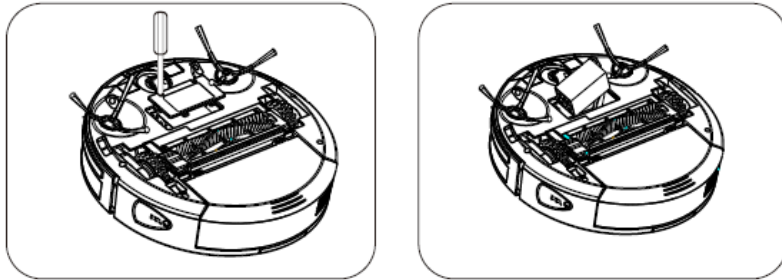

① Unscrew the screw, remove the battery cover ② Replace new battery, and install the cover back

③ Remove the battery and unplug the terminal

Keep the robot in charge when not use. Please charge battery full and remove it from robot when not use for a long time, in order to last the service life of battery. The battery needs to be charged full when use next time, then you can get a best performance of it.

Remote control is with 2xAAA(7#) battery, virtual wall is 2x2# battery, which need to be replaced in time. Please remove battery when not use for a long time.



The robot must use original manufacturer's battery to replace, otherwise may lead to damage or accident.
The robot is prohibited to use non-rechargeable battery.
Turn off the switch when removing the battery.
Pay attention to the battery is negative direction when installing any batteries. Can not abuse with new and old battery.

4: Troubleshooting

4.1 Common problems

- Why my smart robot will be heard loudly suddenly?

This robot has dust recognition function, it will go into spot cleaning after detecting dust, the voice will be loud suddenly at the moment. If it happens at other time, which means the dust sensor needs to be wiped(deatils in line 5 of P22).

- Why the robot do not slow down when approaching some obstacles?
The robot can identify obstacles quickly, which makes it slow down and strike obstacles with its front bumper gently before changing the direction, but if the robot is in a dark color or black background, or the width of obstacle is less than 5cm, its function will be weakened.

4.2 Common faults

Reason	The solution
The main brush stop working	Check whether the main brush is stuck by hair or something, take something off.
Left brush stop working	Check whether the left brush is stuck by hair or something, take something off.
Right brush stop working	Check whether the right brush is stuck by hair or something, take something off.
Left wheel stop working	Check whether the left wheel is stuck by hair or something, take something off.
Right wheel stop working	Check whether the right wheel is stuck by hair or something, take something off.
The host trapped	Put the host on the ground and re-select working mode again
The host is dangling	Put the host on the ground and re-select working mode again.
Detection sensor error	Clean detection sensor, please send to after-sale center to maintain if still not recovered.
Front bumper error	Check whether the front bumper is stuck by something, and take something off.
The power switch is not open, can not charge	Please turn on the switch

4.3 Use restrictions

- Your robot is for indoor use only.
- Your robot contains electronic components, please clean it with dry cloth, do not let it close to water or moisture ground.
- Your robot is not a toy. Do not sit or stand on this device. Small children and pets should be supervised when your robot is operating.
- Check whether side brush, main brush is in right place before cleaning.
- Do not use this device to pick up spills of bleach, paint, or other chemicals, or anything wet
- Before using this device, pick up objects like clothing, loose papers, pull cords for blinds or curtains, power cords, and any fragile objects. If the device passes over a power cord and drags it, there is a chance an object could be pulled off a table or shelf.
- If the room to be cleaned contains a balcony, a physical barrier should be used to prevent access to the balcony and ensure safe operation.
- Remember to remove the battery if not use for a long time or before carrying it.
- This appliance is not intended for use by persons (including children) with reduced physical, sensory or mental capabilities, or lack of experience and knowledge, unless they have been given supervision or instruction concerning use of the appliance by a person responsible for their safety.

5 Safety instruction

- Do not self-disassemble the robot, the user is difficult to maintain without the useful spare parts including robot body, remote control.
- Do not use this device to pick up anything that is burning or smoking.
- Do not use the robot again if it is broken or malfunction no matter any reasons.
- When the robot is working, to prevent falling others, please let others know it is in working
- The packing bag and plastic bag has the danger of suffocation, do not let children play it, and place it far away from children.
- Do not discard the packing material at random, please send to recycle point in order to these material can be reused.
- The cooling hole shall not be blocked when the robot is operating, lest make damage of robot.
- Please ensure voltage rating for enclosed Home Base matches standard outlet voltage.
- Never handle the robot with wet hands.
- Do not pull out the power plug from the socket by pulling power cord
- Charging base is heavy, do not drag or move the base by pulling the power cord, and do not regard power cord as a handle to use
- Do not use a robot with a damaged cord or plug. If the cord or plug is damaged
- Do not overstretch, twist power cord, and do not put the heavy things on the power cord and clamp power cord when the door closed.
- Do not crush or dismantle battery packs. Do not heat or place the battery pack near any heat source.
- Always charge and remove the battery from your robot accessories before long-term storage or transportation.
- Please replace the new battery if the battery is out of its service life.

Warnings:

changes or modifications not expressly approved by the party responsible for compliance could void the user's authority to operate the equipment.

This device complies with Part 15 of the FCC Rules. Operation is subject to the following two conditions: (1) this device may not cause harmful interference, and (2) this device must accept any interference received, including interference that may cause undesired operation.

This equipment has been tested and found to comply with the limits for a Class B digital device, pursuant to Part 15 of the FCC Rules. These limits are designed to provide reasonable protection against harmful interference in a residential installation. This equipment generates, uses and can radiate radio frequency energy and, if not installed and used in accordance with the instructions, may cause harmful interference to radio communications. However, there is no guarantee that interference will not occur in a particular installation.

If this equipment does cause harmful interference to radio or television reception, which can be determined by turning the equipment off and on, the user is encouraged to try to correct the interference by one or more of the following measures:

- Reorient or relocate the receiving antenna.
- Increase the separation between the equipment and receiver.
- Connect the equipment into an outlet on a circuit different from that to which the receiver is connected.
- Consult the dealer or an experienced radio/TV technician for help.

This equipment complies with FCC radiation exposure limits set forth for an uncontrolled environment. This equipment should be installed and operated with minimum distance 20cm between the radiator & your body.