

WIRELESS FM
Transmitter

USER MANUAL

DIAGRAM

EN

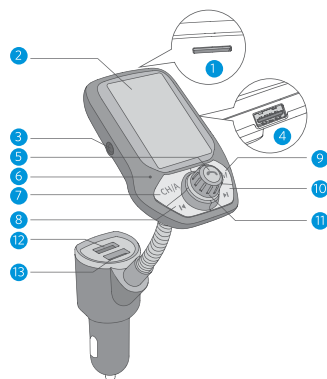

- 1 TF card slot (MAX 32G)
- 2 Display
- 3 Aux in / out port
- 4 U disk (MAX 32G)
- 5 Multifunction Button: Pause / Play / Hands-free calls (Answer / Hang up / Reject a Call)
- 6 Microphone
- 7 CH/A button
- 8 Previous track / rewind
- 9 Menu button
- 10 Next track / fast forward
- 11 Knob button (frequency down / frequency up; Volume Up / Volume Down)
- 12 Charge USB 1 (MAX 5V 2.4A)
- 13 QC 3.0 quick charging port (DC 3.5-6.5V / 3A, 6.5-9V / 2A, 9-12V / 1.5A)

SPECIFICATIONS

Effective distance	5 meters
FM frequency range	88.1MHz-107.9MHz
Compatible audio format	MP3. WMA. WAV. FLAC. AAC
Compatible Bluetooth protocol	A2DP / AVRCP / HSP / HFP
Quick charge port	Support QC 3.0 protocol (DC 3.5-6.5V / 3A, 6.5-9V / 2A, 9-12V / 1.5A)

Power On/ Off

Power On: Activate the car, plug the product into the car cigarette socket. Once the product is plugged in, you can long press the button "⏻" to power on the product.

Power Off: Unplug the product OR long press the button "⏻" together for 3s.

Note: You can charge via the USB Charging port once the product is plugged in.

1. Operation Guide

A. Frequency Adjustment

Power ON: Plug the Bluetooth FM Transmitter into the cigarette lighter socket and the Bluetooth FM Transmitter will turn on automatically.

Scan a frequency (The Bluetooth FM Transmitter tune automatically (intelligent auto tuning):

Step 1: Short press CH/A button, the Interface of fonts and icons is flashing.

Step 2: Short press CH/A button again and the product will scan the blank frequency station automatically in 1 second. It will switch to a blank frequency automatically every time you press CH/A button.

Step 3: After frequency tuning, press the Multifunction  button to exit or wait for 4 seconds to exit automatically.

Synchronize frequency: Adjust both the car radio and the Bluetooth FM Transmitter to run at the same frequency.

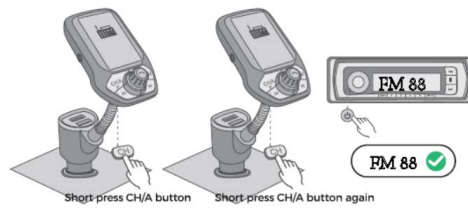

Note: When tuning, you can tune the frequency manually. Short press CH/A button to enter manual tuning mode with the Interface of fonts and icons is flashing.

Then, you can turn the  knob to a blank frequency station (unused frequency).

After frequency tuning, press the Multifunction button to exit or wait for 4 seconds to exit automatically.

B. Bluetooth Connection

Enable Bluetooth on the smart device, search "BH346A" and click to connect.

(Please refer to the following input method in 3.1 of AUX mode, U disk and TF card).

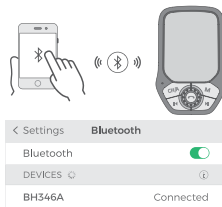

2. Bluetooth Handsfree Function

- A. Answer a Call: Short press the "☎" button.
- B. Hang up a Call: Short press the "☎" button.
- C. Redial the last phone number dialed: Double press the "☎" button.
- D. Reject a Call: Long press the "☎" button for 2 seconds.

3. Music Function (Please confirm the connection is complete first)

3.1 Audio Sources: Bluetooth / AUX in mode / TF Card / U disk

- A. Bluetooth mode: Refer to the instructions of your smart device.
After Bluetooth connected, play music on the smart device and the music can be synchronized to the in-car speaker.
- B. AUX in mode: Connect Bluetooth FM transmitter to the smart device (such as a smartphone) via a 3.5mm audio cable. Then, the in-car speaker can play music.

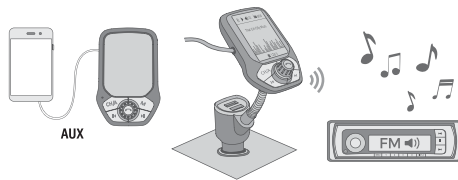

C. TF card / U disk mode: Insert the TF card / U disk, and Bluetooth FM transmitter will recognize automatically and play the music.

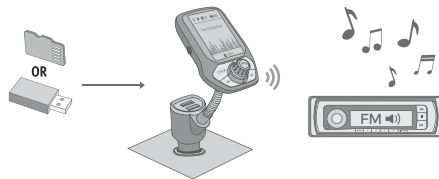

Note:

1. Short press "⏪" button to play / pause; Short press "⏩" or "⏮" button to play the previous or next track; Turn the knob clockwise to increase the volume and turn anticlockwise to decrease the volume (**Aux in mode does not support to adjust volume**).
2. In TF card and U disk mode, long press "⏮" button to rewind or long press "⏩" button to fast forward.

Important note: To guarantee a smooth operation, please adopt only one audio method each time when you play the audio.





3.2 Select an Audio Source

- A. Switch the audio source: Short press M button to switch the audio source among Bluetooth, AUX in mode, TF card and U disk.
- B. Automatic play option via TF card / U disk: Plug and play.
- C. Power-off memory: Reboot the product after power off, and it will enter the previous playing mode (In U disk mode and TF card mode, it will play music automatically; In Bluetooth mode, you need to play music manually).

3.3 Choose a Folder and Play Mode

When playing music from the TF card or U disk:

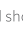
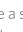
3.3.1 Select a folder

- A. Enter folder scanning mode: Long press M button for 2 seconds, turn the  knob to choose the "Folder" and short press  button to confirm. Short press CH button to return to the previous menu.
- B. Choose a folder: Turn the  knob to select a folder and short press  button to open the folder.
- C. Choose a song: Turn the  knob to choose a song. Short press  button to confirm and play the music.

3.3.2 Choose a Play Mode

- A. Enter Play Mode: Long press M button for 2 seconds, turn the  knob to choose the "Play Mode" and short press button  to confirm.
- B. Choose a Play Mode: Turn the  knob to select a mode among "REPEAT ALL", "REPEAT ONE", "RANDOM" and "REPEAT FOLDER". And short press the  button to confirm.

3.3.3 Select an EQ Mode

- A. Enter EQ mode: Long press M button for 2 seconds, turn the

🕒 knob to select the mode "EQ Mode" and short press the 🕒 button to confirm.

B. Choose a music style: Turn the 🕒 knob to select one among "NORMAL", "CLASSICAL", "POP", "ROCK" and "JAZZ". Short press the 🕒 button to confirm.

4. Quick Charge 3.0 Instruction

A. For the smart device that doesn't support quick charge, the normal output is 5V / 2.4A

B. For the smart device that supports quick charge, the MAX output of the QC 3.0 is DC 3.5-6.5V / 3A, 6.5-9V / 2A, 9-12V / 1.5A.

Warm reminder: AUX Output to the Car

If your car is equipped with an AUX port. During the long driving, or when there are few empty frequencies, you can choose to connect the AUX port of the FM transmitter to the AUX port of the car.

The input audio of the AUX out can be Bluetooth, TF or U disk. For more details, please refer to the instructions.

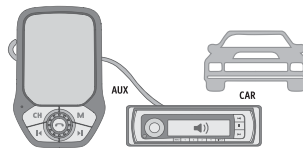

Choose an Input and Output Method

Audio Input: Bluetooth or U disk or TF card or Aux in (Please choose a method to guarantee the smooth experience).

Audio Output: FM or AUX out (Please choose a method to guarantee the smooth experience).

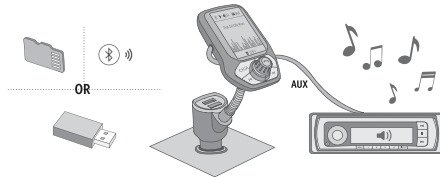

FCC STATEMENT

Note: This equipment has been tested and found to comply with the limits for a Class B digital device, pursuant to part 15 of the FCC Rules. These limits are designed to provide reasonable protection against harmful interference in a residential installation. This equipment generates uses and can radiate radio frequency energy and, if not installed and used in accordance with the instructions, may cause harmful interference to radio communications. However, there is no guarantee that interference will not occur in a particular installation. If this equipment does cause harmful interference to radio or television reception, which can be determined by turning the equipment off and on, the user is encouraged to try to correct the interference by one or more of the following measures:

- Reorient or relocate the receiving antenna.
- Increase the separation between the equipment and receiver.
- Connect the equipment into an outlet on a circuit different from that to which the receiver is connected.
- Consult the dealer or an experienced radio/TV technician for help

Changes or modifications not expressly approved by the party responsible for compliance could void the user's authority to operate the equipment. This device complies with Part 15 of the FCC Rules. Operation is subject to the following two conditions:

- (1) this device may not cause harmful interference, and
- (2) this device must accept any interference received, including interference that may cause undesired operation.