

**VTIN**  
MODEL: BH173A

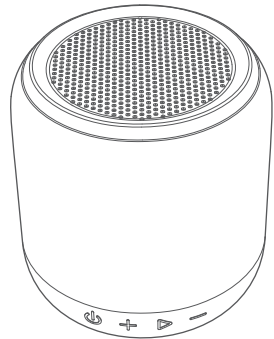

**WIRELESS  
SPEAKER**

VTIN  
K100

① Package

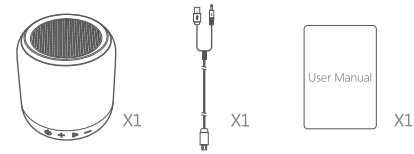

② Diagram

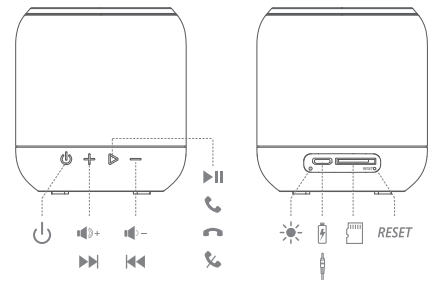

③ Power On/off

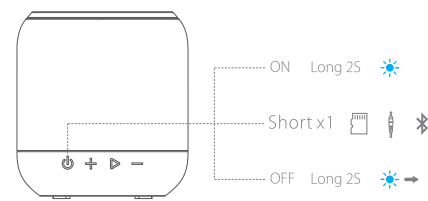

④ How To Pair

Enable your Bluetooth function of your smartphone, search Bluetooth device and select "VTIN K1" to connect.

Suchen Sie das Bluetooth-Gerät und wählen Sie "VTIN K1" zum Verbinden.

Active el Bluetooth de su móvil, busque el dispositivo de Bluetooth y seleccione "VTIN K1" para conectarse.

Allumer votre fonction Bluetooth de votre smartphone, rechercher un périphérique Bluetooth et sélectionnez "VTIN K1" pour se connecter.

Attivare la funzione Bluetooth del tuo smartphone, cerca il dispositivo Bluetooth e seleziona "VTIN K1" per connetterti.

ご使用のデバイスのBluetooth機能をONにして、Bluetoothリストから本機名"VTIN K1"を選び、スピーカーとデバイスを接続してください。

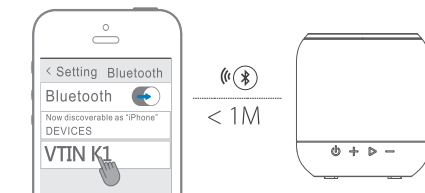

⑤ Volume Control / Music Control

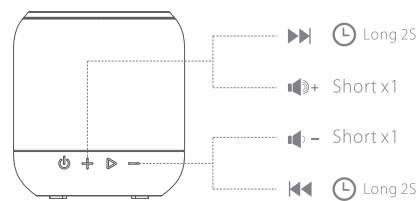

⑥ Play / Pause / Answer / Hang Up / Reject

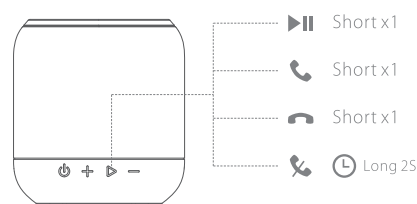

⑦ Charge Battery

To charge, plug one end of the charging cable into the charging port and the other end into the mains.

Um zu laden, stecken Sie ein Ende des Ladekabels in den Ladeanschluss und das andere Ende in das Stromnetz.

Pour charger, branchez une extrémité du câble de chargement dans le port de charge et l'autre extrémité dans le secteur.

Enchúfe el cable de carga en el puerto de carga y conecte el fuente de alimentación para cargar.

Per ricaricare, inserire un'estremità del cavo di ricarica nella porta di ricarica e l'altra estremità nella rete elettrica.

充電ケーブルを入れて充電します。

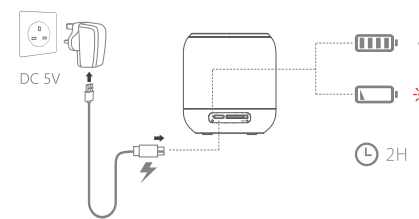

**NOTE:** This equipment has been tested and found to comply with the limits for a Class B digital device, pursuant to part 15 of the FCC Rules. These limits are designed to provide reasonable protection against harmful interference in a residential installation. This equipment generates uses and can radiate radio frequency energy and, if not installed and used in accordance with the instructions, may cause harmful interference to radio communications. However, there is no guarantee that interference will not occur in a particular installation. If this equipment does cause harmful interference to radio or television reception, which can be determined by turning the equipment off and on, the user is encouraged to try to correct the interference by one or more of the following measures:

- Reorient or relocate the receiving antenna.
  - Increase the separation between the equipment and receiver.
  - Connect the equipment into an outlet on a circuit different from that to which the receiver is connected.
  - Consult the dealer or an experienced radio/TV technician for help
- Changes or modifications not expressly approved by the party responsible for compliance could void the user's authority to operate the equipment.

This device complies with Part 15 of the FCC Rules. Operation is subject to the following two conditions:

- (1) this device may not cause harmful interference, and
- (2) this device must accept any interference received, including interference that may cause undesired operation.

**VTIN**

www.ovtin.com  
Support@ovtin.com  
Copyright © VTIN Inc. All rights reserved.

**Patozon**  
by IDG

尺寸: 70 X 90 (mm)  
材质及工艺: 128g 铜版纸 覆哑膜  
装订方式: 折页  
印刷颜色: 四色印刷

设计师: Uri  
日期: 20180503  
备注:

本品牌及其所使用的标志、名称、图像以及所有内容设计,其版权均均为本公司所有,未经授权任何组织、个人、商业团体不得擅自使用、翻印,本公司保留追究其法律责任的权利!