

Play Books

Google Play Books offers a user-friendly interface, an extensive selection of digital books, and various features to enhance your reading experience. Whether you prefer e-books or audiobooks, it provides a convenient and versatile platform to explore, enjoy, and expand your literary horizons.

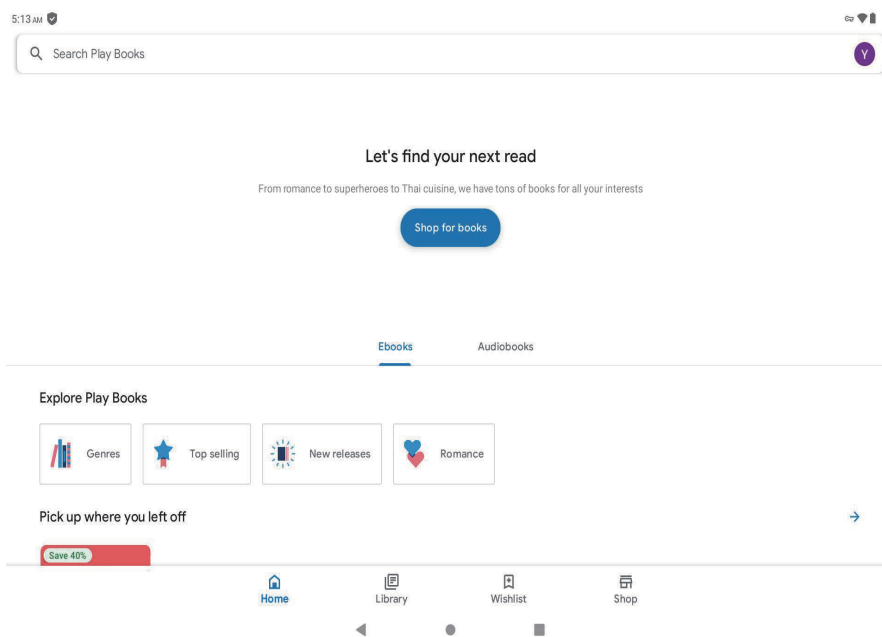

Google Applications

The preinstalled Google applications on your Android-based tablet provide a seamless and user-friendly experience. By registering them with your Google Account or Gmail, you can unlock their full potential and enjoy the benefits they offer.

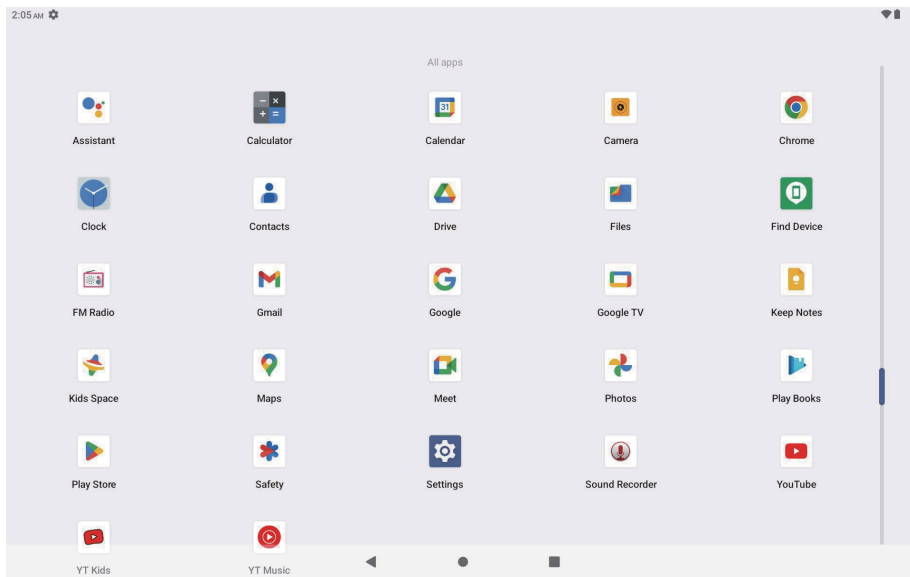

6. Quick Settings

In Android 13, accessing Quick Settings is made effortless through a simple swipe-down gesture from the top of the screen. Once activated, you will find a collection of nine shortcut icons conveniently available for quick access. These icons typically include essential functions such as Wi-Fi, Bluetooth, Auto-rotate, and more.

To further enhance your experience, Android 13 allows you to customize the Quick Settings panel according to your preferences.

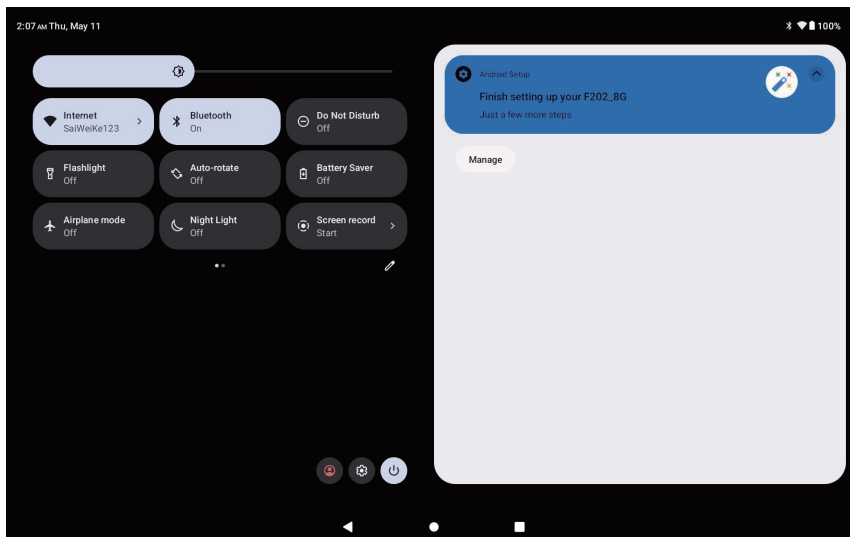

7. Battery Charging

Your Android-based tablet is equipped with a built-in rechargeable lithium battery, which powers the device. To ensure optimal performance and functionality, it is essential to follow the recommended guidelines for the initial use of the battery. Please note the following information:

1. Full Initial Charge: Prior to using the product for the first time, it is highly recommended to fully charge the battery. A full initial charge helps establish the battery's capacity and ensures its proper functioning.
2. Only use the supplied charger or one of the exact same ratings.

The following ratings are for the supplied charger: 5V 2.5A (Max support 9V 3A charger)

Failure to follow the above guidelines can result in damage to the battery and device and result in risk of fire.

Under no circumstances should you attempt to disassemble the battery or its components. Disassembling the battery can lead to hazardous situations, including the risk of fire or chemical exposure.

8. Connecting to the PC

USB Connect: Connection to a computer: You can connect your Tablet to the computer to copy data to and from your device. For this process you need to use the provided USB cable. As in the image below, when your Android Based Tablet Device is connected to a PC you will see “Charging this device via USB” in the notification menu.

Press on the downwards arrow to the right of this text to expand the menu to show other options such as data transfer for your device.

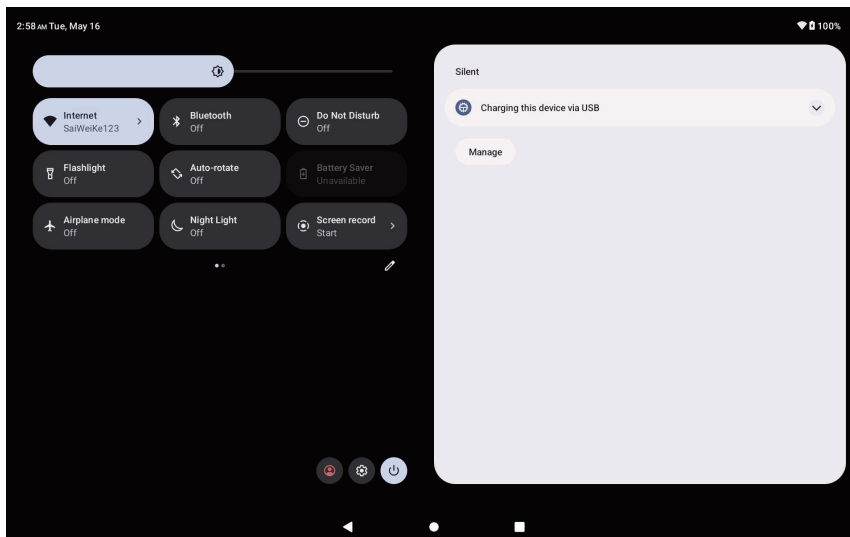

9. Settings

To access the settings in Android 13, navigate to the main menu of your Android-based tablet device and locate the "Settings" application.

Image of what settings will look like on your device:

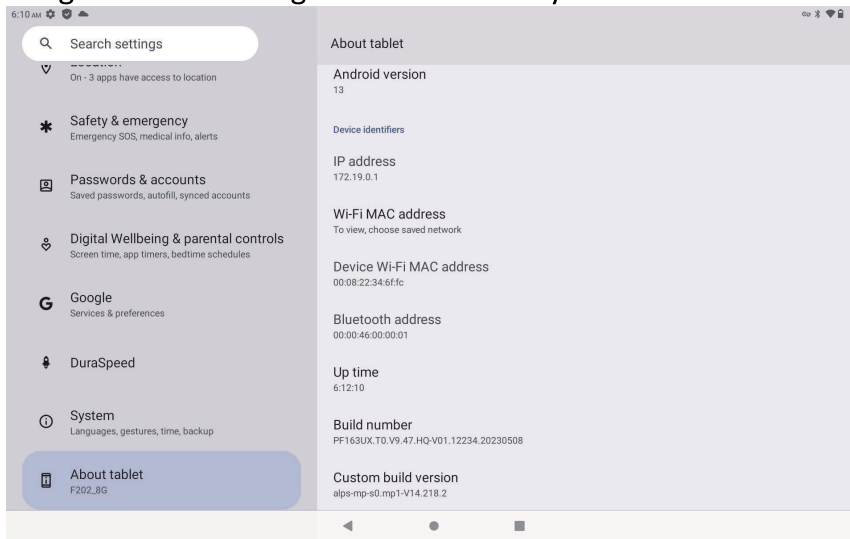

Exploring the settings menu allows you to customize and tailor your device to your specific needs and preferences, ensuring a personalized and optimized user experience.

10. Backup & Reset

In Android 13, the Backup and Reset feature provides a convenient way to safeguard your data and restore your device to its original state if needed. This feature ensures that your personal information, app data, and device settings are protected and easily recoverable in the case that you need to rest your device at any point in time.

11. Product Specification

Model No.	F202_8GB
Display Size	10.1inch
Resolution	1920x1200 FHD with 400cd/m2 Brightness
Chipset	MTK8183 Octa Core, 2.0G
Storage	8GB+128GB
Front Camera	8Mega
Rear Camera	13Mega
Battery	3.8V 6600mAh
WiFi	2.4G &5G AC Dual Bands
Bluetooth	4.2 Version
FM Radio	Yes
GPS	Yes

12. Trademarks

- Google, Android, Gmail, Google Play, Google Play logos and other brands are Google LLC trademarks.
- All other trademarks and copyrights belong to their respective owners.

Transmitter Frequency:	Bluetooth/BLE: 2402-2480MHz 2.4G Wi-Fi: 2412-2472MHz 5G Wi-Fi: 5150-5250 MHz, 5725-5850MHz
Receiver Frequency:	Bluetooth/BLE: 2402-2480MHz 2.4G Wi-Fi: 2412-2472MHz 5G Wi-Fi: 5150-5250 MHz, 5725-5850MHz FM: 87.5-108MHz GPS/L1:1559-1610 MHz; GPS L2:1215-1300 MHz; GPS L5:1164-1215 MHz
RF-Output Power :	BT: 7.1dBm; BLE 1M: 7.91dBm 2.4G Wi-Fi:14.72dBm 5G Wi-Fi: 5150-5250MHz: 14.40dBm 5725-5850MHz:13.54dBm



BE	BG	CZ	DK	DE	EE	IE	EL
ES	FR	HR	IT	CY	LV	LT	LU
HU	MT	NL	AT	PL	PT	RO	SI
SK	FI	SE	NO	IS	LI	CH	TR

In all EU member states, operation of 5150-5250 MHz is restricted to indoor use only.

13. FCC Statements:

FCC Caution:

Any Changes or modifications not expressly approved by the party responsible for compliance could void the user's authority to operate the equipment.

This device complies with part 15 of the FCC Rules. Operation is subject to the following two conditions: (1) This device may not cause harmful interference, and (2) this device must accept any interference received, including interference that may cause undesired operation.

The device has been tested and comply with FCC/ISED SAR limits.

IMPORTANT NOTE:

Note: This equipment has been tested and found to comply with the limits for a Class B digital device, pursuant to part 15 of the FCC Rules. These limits are designed to provide reasonable protection against harmful interference in a residential installation. This equipment generates, uses and can radiate radio frequency energy and, if not installed and used in accordance with the instructions, may cause harmful interference to radio communications. However, there is no guarantee that interference will not occur in a particular installation. If this equipment does cause harmful interference to radio or television reception, which can be determined by turning the equipment off and on, the user is encouraged to try to correct the interference by one or more of the following measures:

- Reorient or relocate the receiving antenna.
- Increase the separation between the equipment and receiver.
- Connect the equipment into an outlet on a circuit different from that to which the receiver is connected.
- Consult the dealer or an experienced radio/TV technician for help.