

NO.1802

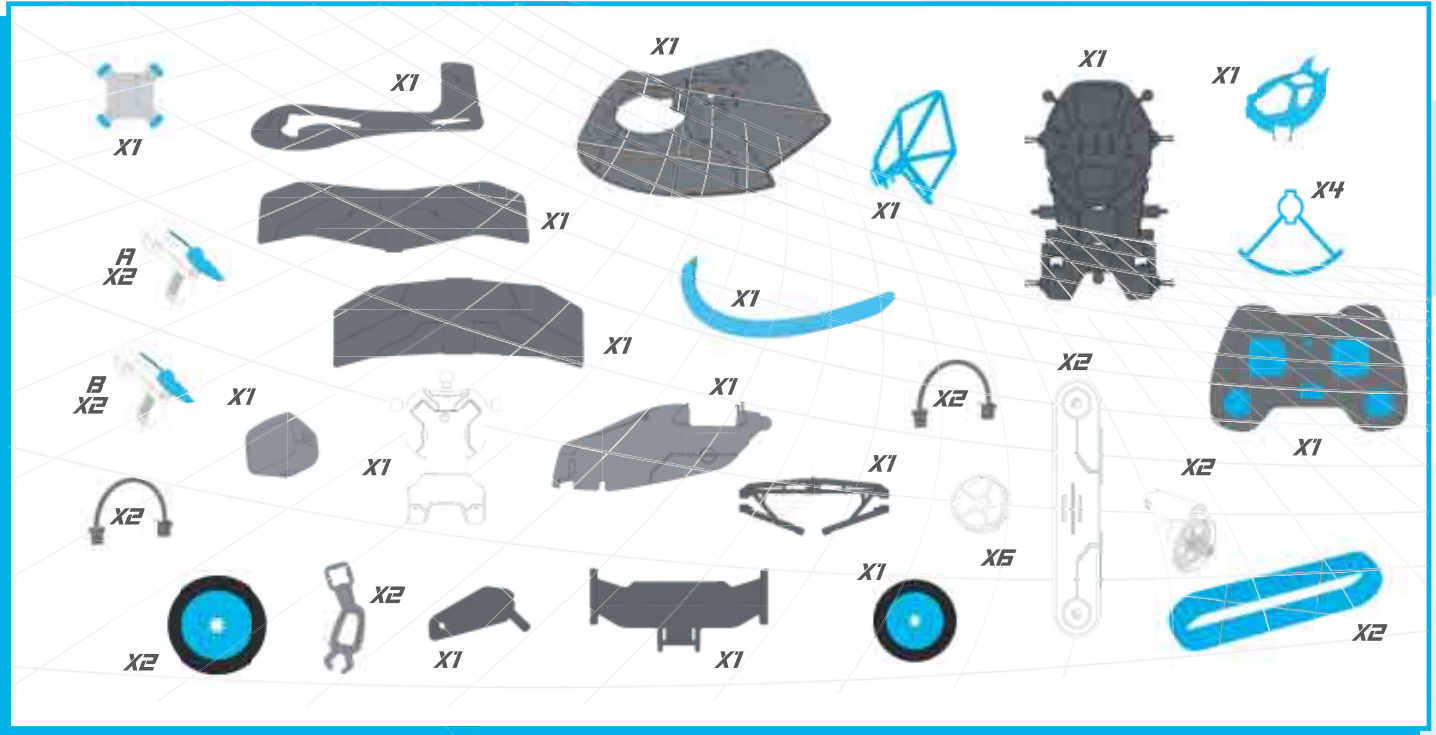

### CHARGING THE A.I.CORE

Attach the USB charging cable to a USB port



The light will be red while charging, and change to green when charging is complete.

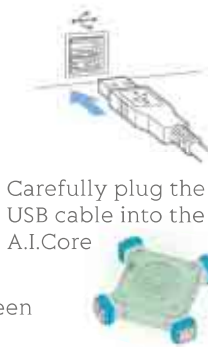

Carefully plug the USB cable into the A.I.Core

### HOW TO INSTALL BATTERIES

Use a phillips head screwdriver to remove the battery door on the back of the controller.

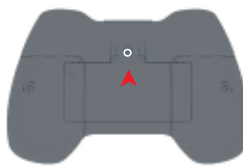

Insert 2 AA batteries in the correct positions, according to the diagram. Replace the battery door and use screwdriver to secure it.

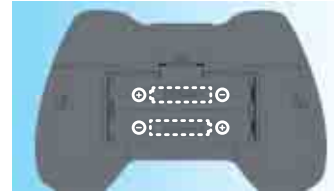

### FCC Statement:

This device complies with part 15 of the FCC Rules. Operation is subject to the following two conditions: (1) this device may not cause harmful interference, and (2) this device must accept any interference received, including interference that may cause undesired operation.

### CAUTION

Changes or Modifications not expressly approved by the party responsible could void the user's authority to operate this device.

NOTE: This equipment has been tested and found to comply with the limits for a Class B digital device, pursuant to Part 15 of the FCC Rules. These limits are designed to provide reasonable protection against harmful interference in a residential installation. This equipment generates, uses and can radiate radio frequency energy and, if not installed and used in accordance with the instructions, may cause harmful interference to radio communications. However, there is no guarantee that interference will not occur in a particular installation.

If this equipment does cause harmful interference to radio or television reception, which can be reception, which can be interference by one or more of the following measures:

- Reorient or relocate the receiving antenna.
- Increase the separation between the equipment and receiver.
- Connect the equipment into an outlet on a circuit different from that to which the receiver is connected.
- Consult the dealer or an experienced radio/TV technician for help.

The device has been evaluated to meet general RF exposure requirement.

### BATTERIES

Battery requirement for controller:  
2 x 1.5V AAA/LR03 (not included)

Battery included in A.I.Core:  
1 x 3.7V 200mAh rechargeable LiPo battery

- Batteries should only be replaced by adults.
- Use only new alkaline batteries.
- Do not mix old and new batteries, or batteries of different types.
- Ensure batteries are installed according to the diagram provided.
- Do not attempt to recharge non rechargeable batteries.
- Do not short circuit the battery contacts.
- Always remove dead batteries from the controller.
- Remove batteries from the controller before storage.
- Always dispose of batteries according to local regulations.



# TANK

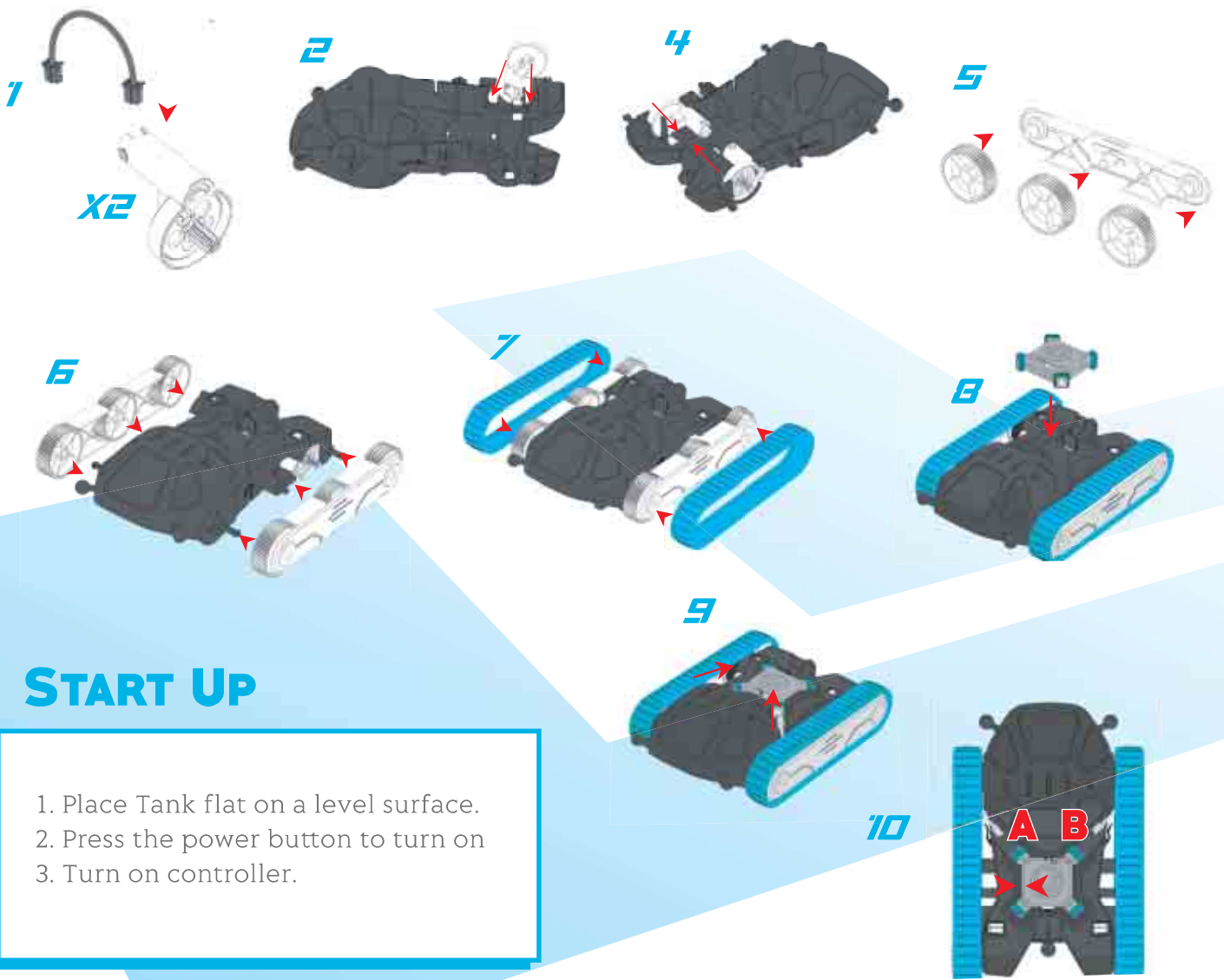
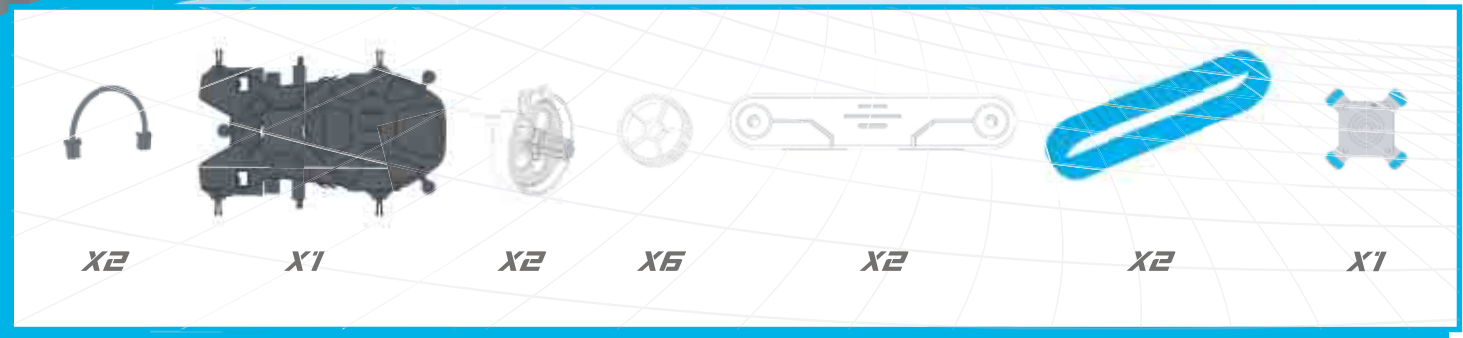

## START UP

1. Place Tank flat on a level surface.
2. Press the power button to turn on
3. Turn on controller.

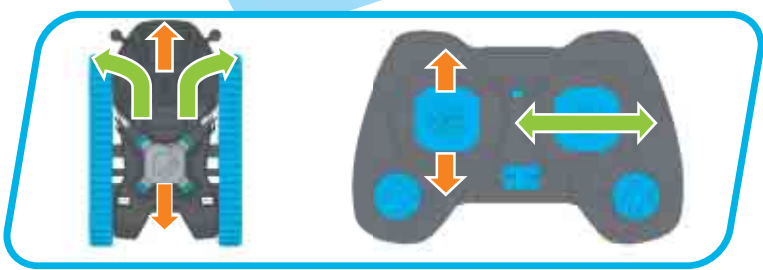

## TIPS

- Use only on smooth indoor surfaces
- Try climbing over small objects
- Use reverse to climb taller objects

# GYROROBOT

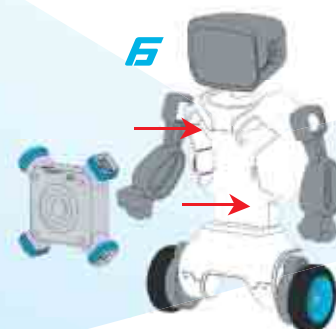
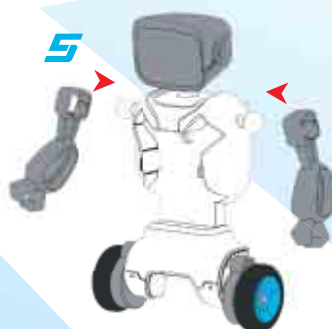
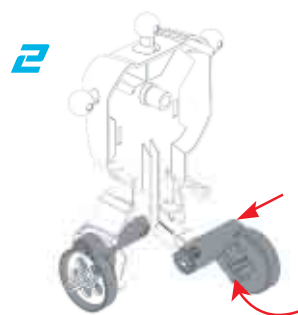
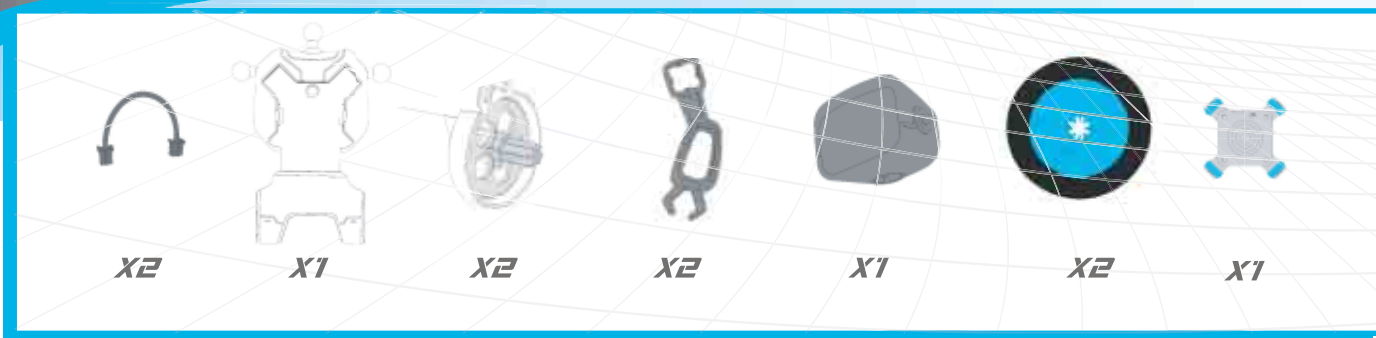

## START UP

1. Place Robot flat on a level surface.
2. Press the power button to turn on
3. Turn on controller.
4. Hold the robot upright with the wheels in contact with surface
5. Press forward on the left controller joystick to begin balancing

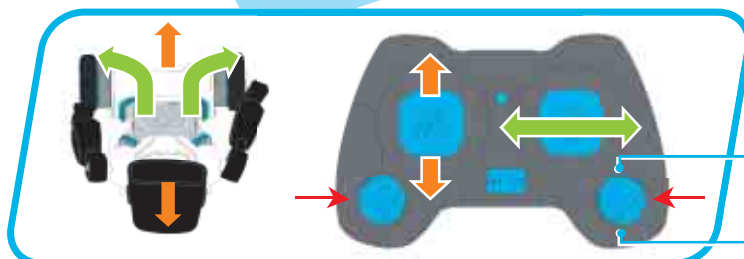
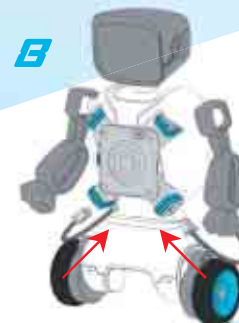
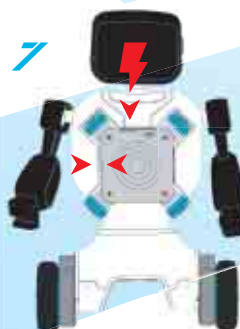

## TIPS

- Use only on smooth indoor surfaces
- Use the trim buttons to adjust balance
- Try adjusting head and arms for new poses

# TRIKE

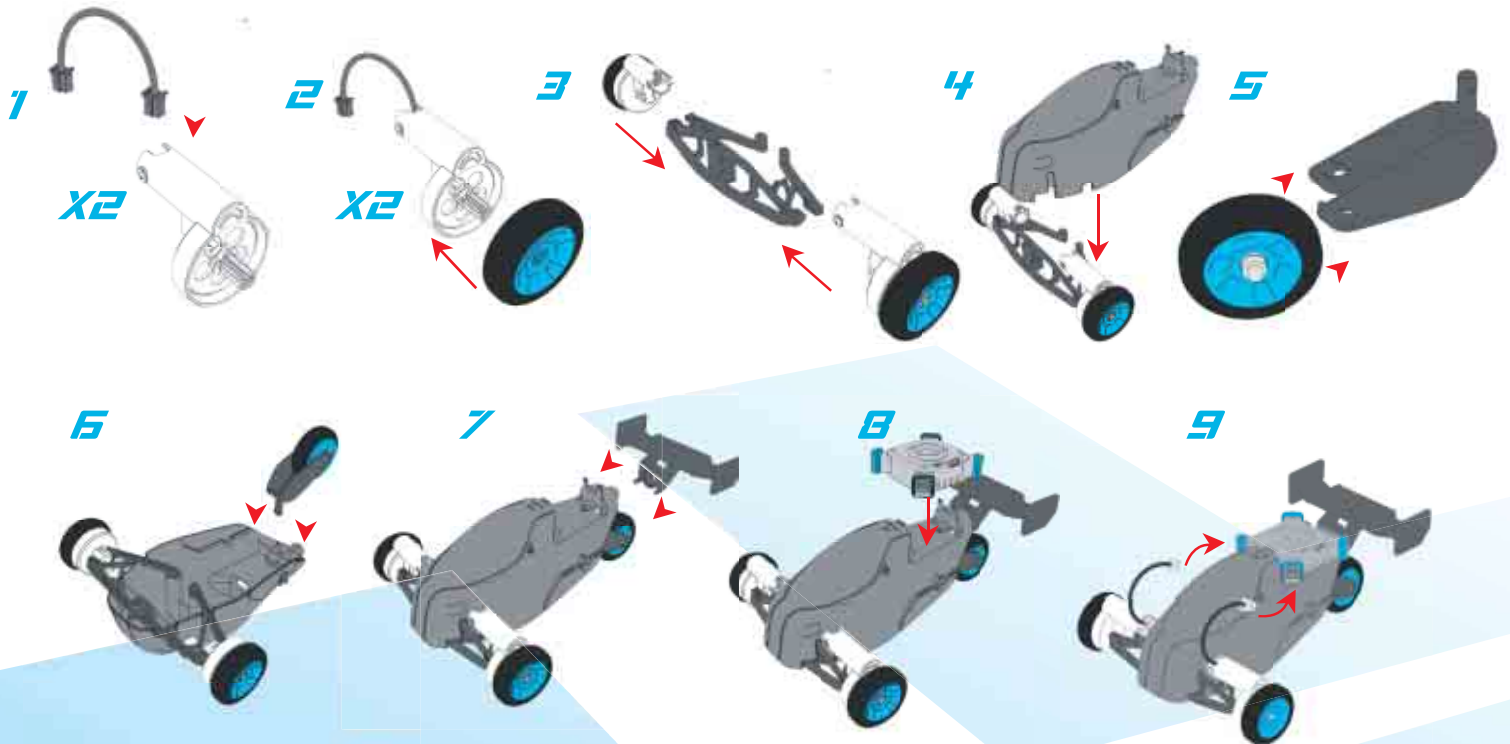
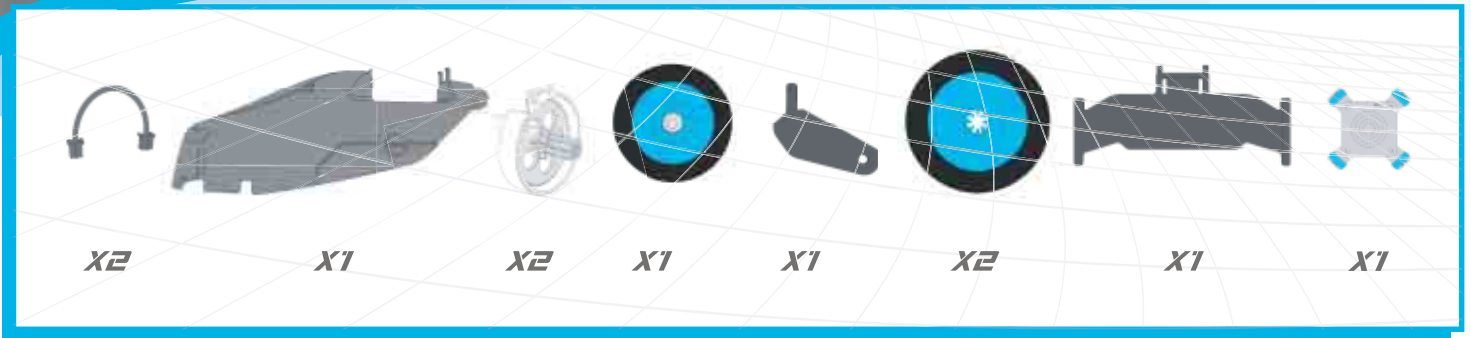

## START UP

1. Place Trike flat on a level surface.
2. Press the power button to turn on
3. Turn on controller.

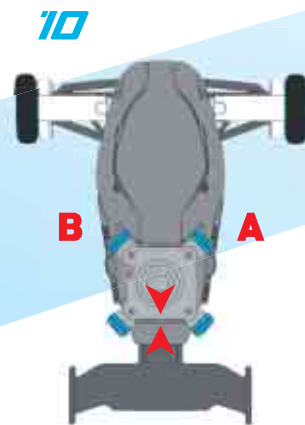

## TIPS

- Use only on smooth indoor surfaces
- Turn quickly to drift
- Use small, smooth control movements

# DRONE



X1

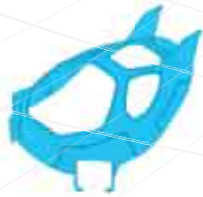

X1



X4



FX2

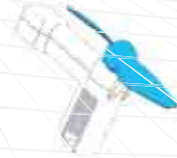

BX2

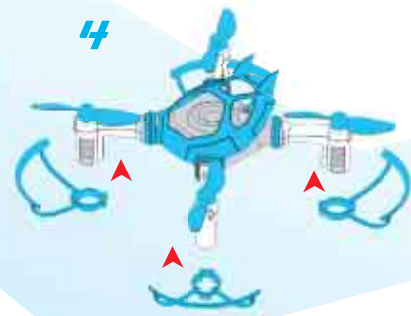
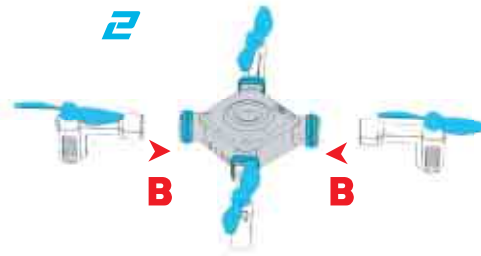
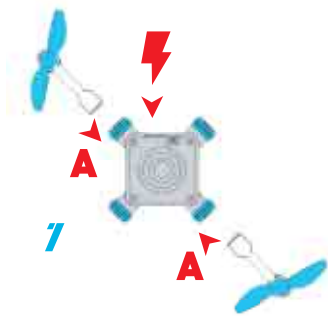

## START UP

1. Place the Drone flat on a level surface.
2. Press the power button to turn on
3. Turn on controller.
4. Press the left joystick up, then down. The controller will beep to confirm
5. Press auto-takeoff button to begin hovering.

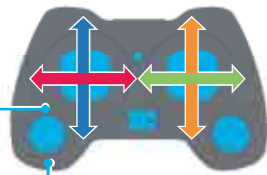
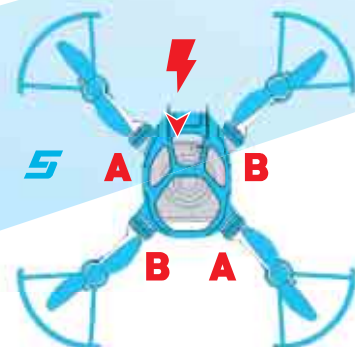

## TIPS

- Fly indoors in a large room
- Avoid flying near people or animals
- Use the Auto-landing button for a smooth landing

# HOVERCRAFT

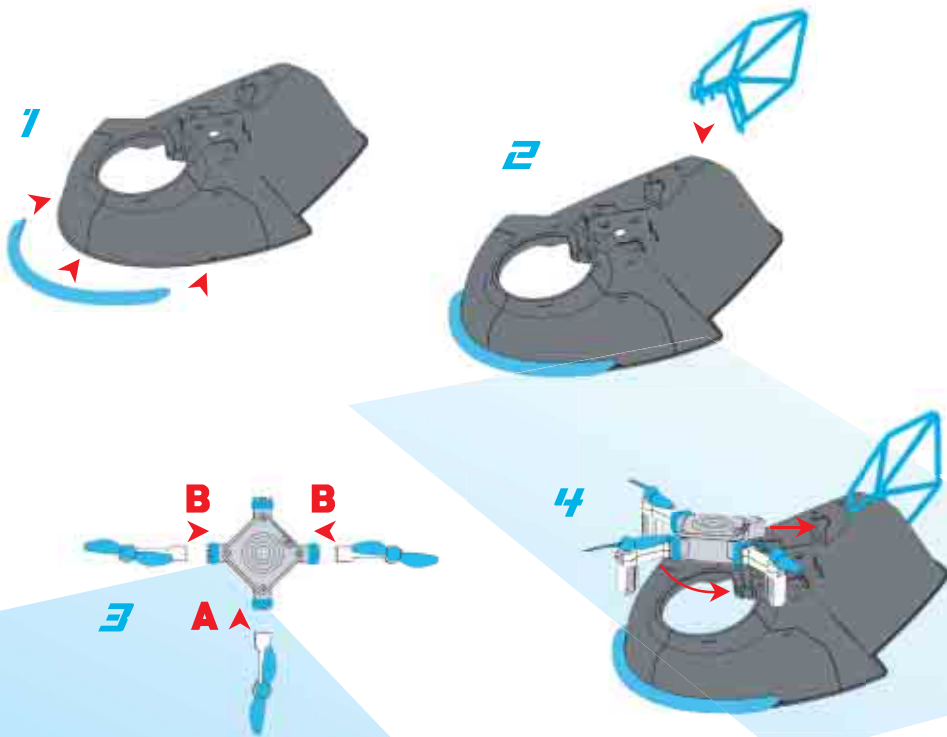
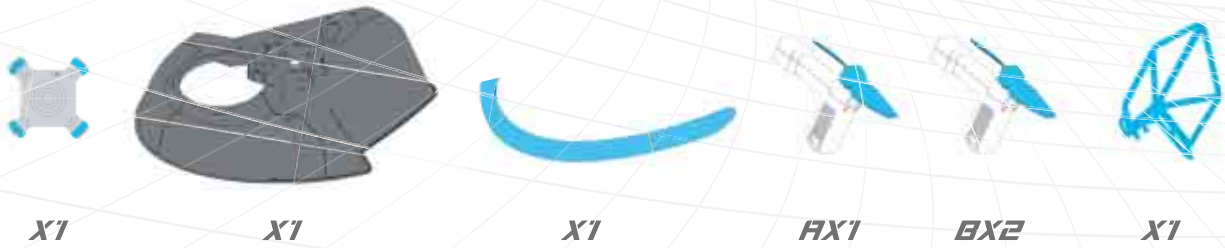

## START UP

1. Place the Hovercraft flat on a level surface.
2. Press the power button to turn on
3. Turn on controller.
4. To hover, Press the left joystick forward once. Press again to hover higher

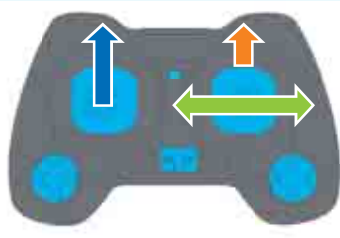
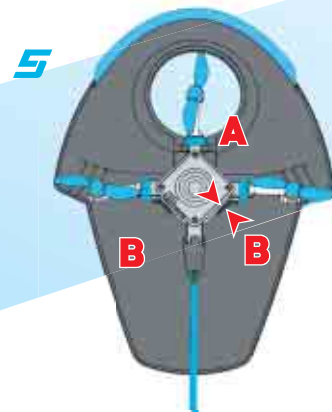

## TIPS

- Use only on smooth indoor surfaces
- Avoid flying near people or animals
- Do not hover over carpeting or water

# TURBOPROP

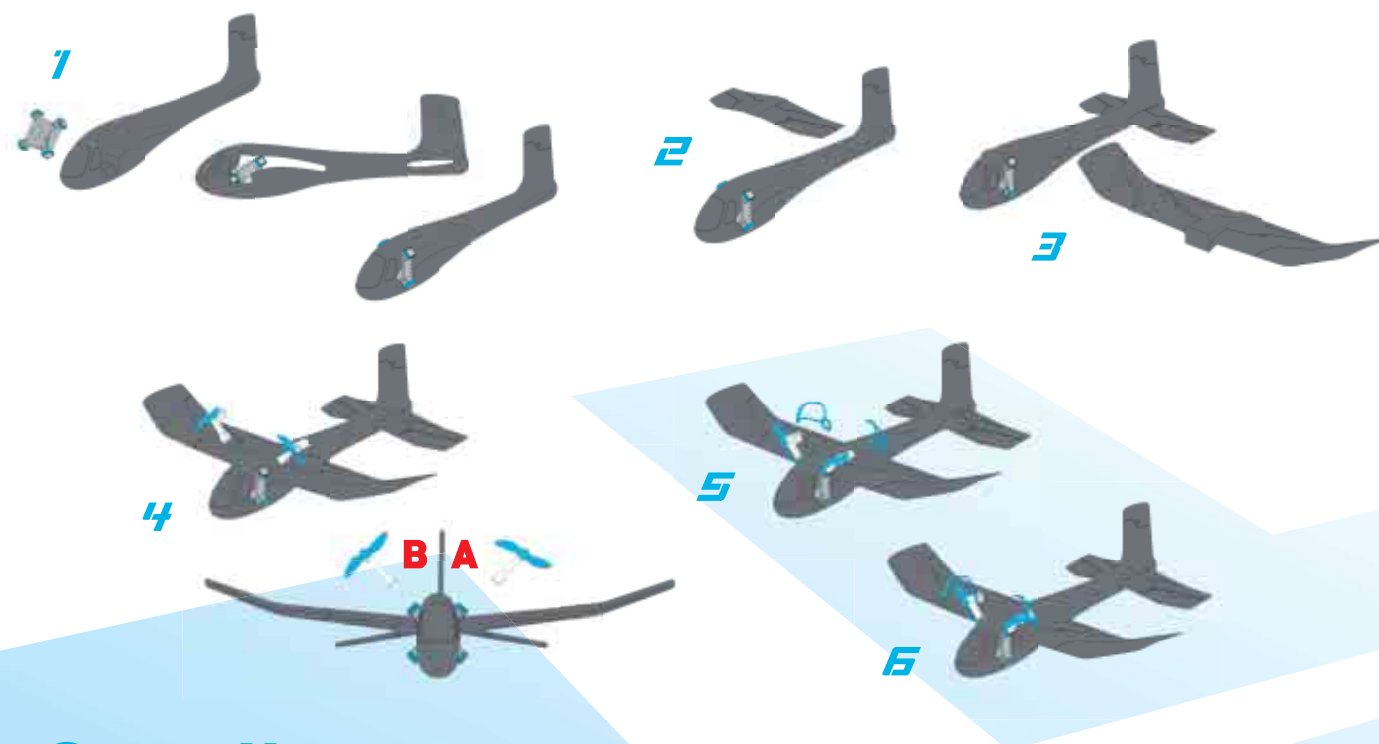
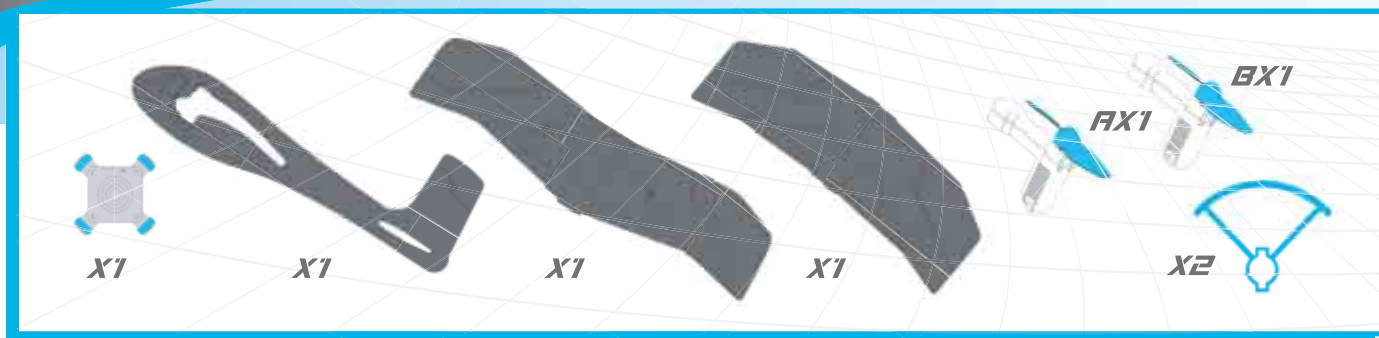

## START UP

1. Place the turboprop flat on a level surface.
2. Press the power button to turn on
3. Turn on controller.
4. Aim the turboprop into the wind, and push the left joystick forward.
5. Launch the turboprop with a smooth level motion.



## TIPS

- Fly only in open areas at least 50x50m
- Avoid flying near trees or power lines
- Fly on a calm day and on grassy location to prevent scuffing on landing.

