

此PDF电子文档支持以下功能\*



### **快速搜索关键词**

在软件中点击搜索或  
查找输入关键词



### **点击目录快速跳转**

点击目录标题快速跳转  
到各个章节内容

\*需阅读软件支持, 以AdobeReader为例。



# CRANE 4

User Guide

# Contents

□ Product List	
Product List	1
□ Get to Know <b>CRANE 4</b>	
Get to Know <b>CRANE 4</b>	3
□ Battery and Charging	
Battery and Charging	4
□ Mounting and Balancing	
Mounting the Tripod	5
Mounting the Camera	5
Installing TransMount Wrist Rest 2S and TransMount Extendable Sling Grip 2S (hereinafter referred to as “Sling Grip” and “Wrist Rest”)	10
Balancing	13
□ How to Use <b>CRANE 4</b>	
Button Description	15
Display Screen Description	16
Icon Description	17
Menu Description	19
Motor Torque Adjustment	23
Bluetooth Shutter Control	24
Gimbal Mode Description	25
Manual Reposition	28
Use with TransMount Video Transmission Transmitter (AI) (hereinafter referred to as “transmitter AI”)	29

<input type="checkbox"/>	How to Use the App	
	Downloading the App	33
	How to Connect	33
	ZY Play Feature Description	35
<input type="checkbox"/>	Firmware Upgrade & Calibration	
	Circumstances When Calibration Is Needed	36
	Six-side Calibration	36
	Motor Fine-Tuning	38
	Firmware Upgrade	38
<input type="checkbox"/>	Product Specifications	
<input type="checkbox"/>	Disclaimer and Warning	
	Reading Tips	43
	WARNING	43
	Safe Operation Guidelines	44
<input type="checkbox"/>	Warranty Card	
	Warranty Period	45
	Warranty Exclusions	45
	Warranty Claim Procedure	45
<input type="checkbox"/>	Contact Card	

## Product List

Before using this product, please check carefully that all the following items are included in the product package. In case that any item is found missing, please contact ZHIYUN or your local selling agent.



CRANE 4 x1



Lower-layer Quick Release Plate x1



Tripod x1

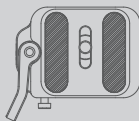

Upper-layer Quick Release Plate x1

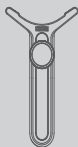

Lens Support x1  
Lens Support Lock Screw x1

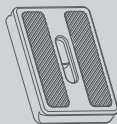

Camera Backing Base x1



Quick Start Guide x1

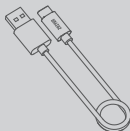

USB Type C Cable x1

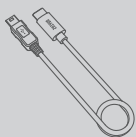

Type-C to Mini USB LN-NBUC-A01  
Camera Control Cable x1

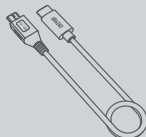

Type-C to Micro USB LN-MBUC-A02  
Camera Control Cable x1

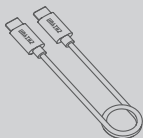

Type-C to Type-C USB LN-UCUC-A02  
Camera Control Cable x1

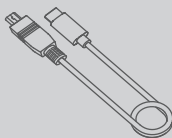

Type-C to Multi USB LN-UCUS-A03  
Camera Control Cable x1



Fill Light Reflector x1



Storage Case x1

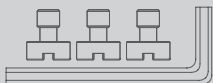

1/4" Screw x3x3  
M4 Wrench x1\*



Sling Grip x1 \*

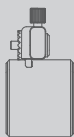

Wrist Rest x1\*

Items marked<sup>“\*”</sup> are included in CRANE 4 COMBO.

Get to Know CRANE 4

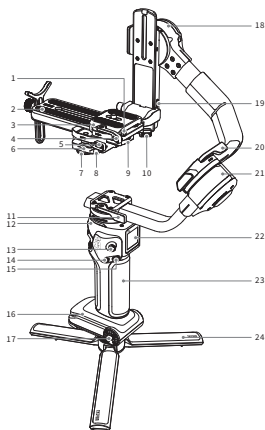

- 1.Upper-layer Quick Release Plate Lock Switch
- 2.Lower-layer Quick Release Plate
- 3.Upper-layer Quick Release Plate Latch
- 4.Upper-layer Quick Release Plate
- 5.Quick Release Plate Latch
- 6.Level Mount
- 7.Camera Installation Latch
- 8.Quick Release Plate Safety Lock
- 9.Quick Release Plate Leveling Base
- 10.Quick Release Plate Leveling Base Latch
- 11.Pan Axis Latch
- 12.Pan Axis Motor
- 13.Joystick
- 14.Photo/Video Button
- 15.Mode Switch

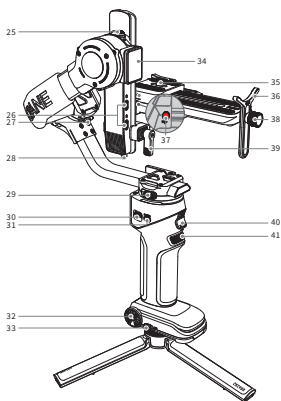

- 16.Gimbal Base
- 17.Sling Grip/Phone Clamp Installation Screw Hole
- 18.Tilt Axis Motor
- 19.Camera/Image Transmission Control Port
- 20.Roll Axis Latch
- 21.Roll Axis Motor
- 22.Touchscreen
- 23.Gimbal Handle
- 24.Tripod
- 25.Tilt Axis Lock Switch
- 26.Focus Motor Control Port
- 27.Roll Axis Lock Switch
- 28.Level Mount Safety Lock
- 29.Pan Axis Lock Switch
- 30.Fill Light Control Wheel
- 31.
- 32.
- 33.
- 34.
- 35.
- 36.
- 37.
- 38.
- 39.
- 40.
- 41.



31. Power Button

32. Wrist Rest Screw

Hole

33. Firmware Upgrade/  
Charging Port

34. Fill Light

35. 1/4" Threaded Hole

36. Lens Support

37. Quick Release Plate Leveling  
Base Latch

38. Lens Support Lock Screw

39. Level Mount Lock Screw

40. Trigger Button

41. Adjustment Wheel

### Battery and Charging

CRANE 4 adopts built-in battery. When using CRANE 4 for the first time, please activate the gimbal by fully charging the battery to ensure the proper function of the gimbal.

Charging method: Use provided USB Type-C cable to connect the USB charger (not included in the package) to charge CRANE 4. It is recommended to use USB chargers that meet the PD protocol. (supports 25W PD charging at most).

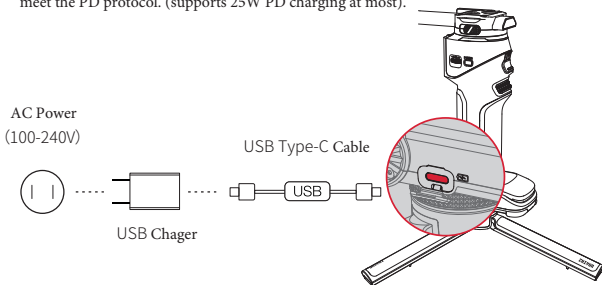

- USB charger is not provided.
- Please power off CRANE 4 to charge.

### Mounting the Tripod

Mount the tripod to the bottom of the WEEBILL 3S handle, then unfold the tripod and place the WEEBILL 3S on a flat surface.

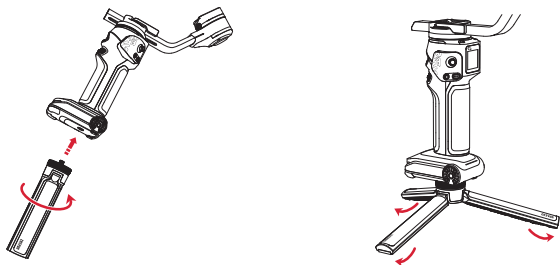

### Mounting the Camera

1. Each axis of the gimbal is equipped with a lock switch. You can use these lock switches to lock the axes for convenient installation and storage. The storage state is the default state. Please toggle the lock switch to unlock the three axes, expand the gimbal as shown in the image, and lock the axes again for convenient camera installation.

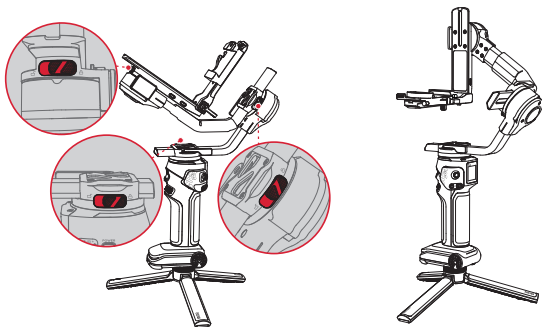

- ⚠ Please mount the camera before powering on CRANE 4 and balance the gimbal. Do not power on CRANE 4 when there is no camera mounted on it.
- Before mounting the camera, make sure it is prepared ahead of time. Remove the lens cap and make sure the camera's battery and memory card are already in place.

2. Install the camera onto the upper quick-release plate and tighten the screws①. Install the upper quick-release plate with the camera onto the lower quick-release plate②, and lock the upper quick-release plate latch③. Mount the lens support onto the lower quick-release plate, adjust the height of the lens support according to the lens position to ensure that the lens support can hold the camera lens securely④, and then tighten the screws⑤.

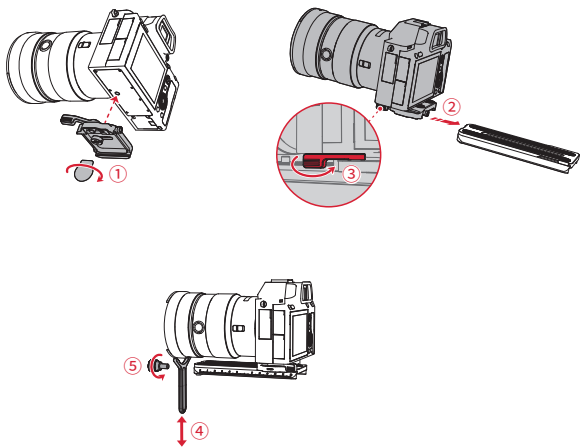

- ⚠ When the camera lens is long and heavy, it is necessary to install a camera lens support to ensure that the lens is securely mounted. You can decide whether to install a camera lens support based on your actual scenarios.

 If installing the camera with a dual-layer quick-release plate does not allow for balancing, you can use a camera backing base and a lower quick-release plate to install the camera. First, mount the camera onto the camera backing base and tighten screw ①. Then, install the camera backing base and camera assembly onto the quick-release plate ② and tighten it with screws ③. Install the camera lens support onto the quick-release plate and adjust the height of the lens support according to the position of the lens so that the support can just hold the camera lens, ensuring that the lens is securely mounted ④. Finally, tighten the screws ⑤.

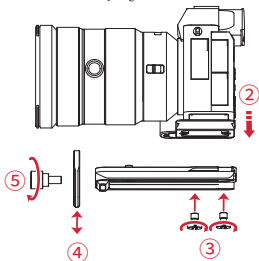
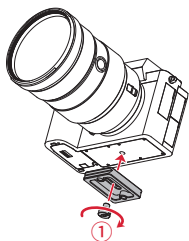

### 3. Installation for Landscape Orientation

Unlock the quick release plate latch ①, then install the dual-layer quick-release plate and camera assembly onto the quick release plate leveling base ②. Finally, tighten the latch ③.

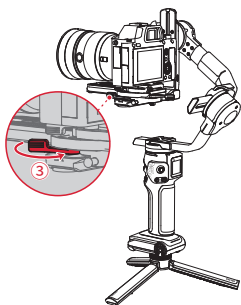
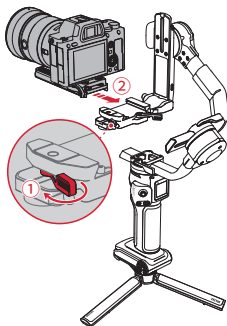

#### 4. Installation for Portrait Orientation

Unlock the quick release plate leveling base latch ①. Hold the leveling base safety lock and push it to the left until it is detached from level mount ②. Install the leveling base onto the tilt axis arm ④, then lock the leveling base latch ⑤. Install the camera and dual-layer quick-release plate assembly onto the leveling base ⑥, and finally, lock the quick release plate latch ⑦.

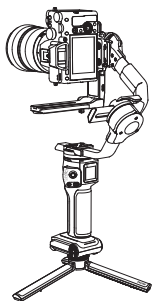
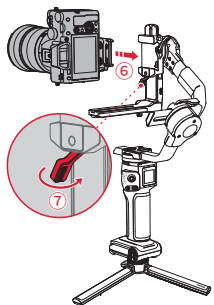
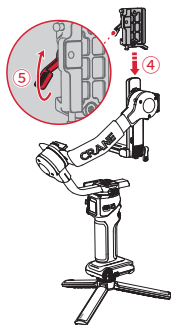
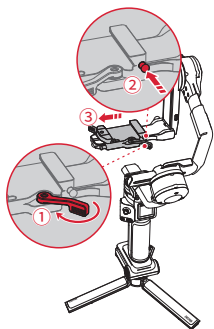

- 💡 To remove the camera (in horizontal/vertical orientation), first unlock the upper quick-release plate latch ①, then hold down the safety lock of the upper quick-release plate ② and slide the camera and upper quick-release plate assembly out together ③.

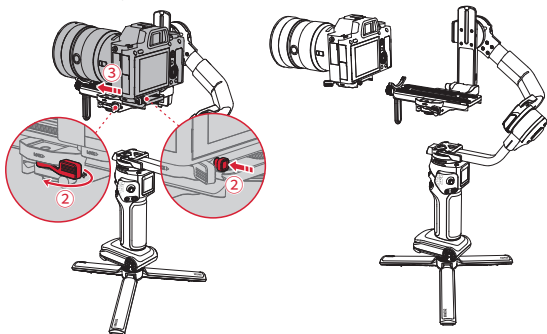

5. Connect the camera control port and camera/image transmission control port of the gimbal with a camera control cable.

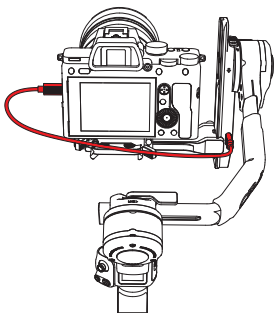

- 💡 There are four camera control cables: Type-C to Multi USB / Type-C to Type-C USB / Type-C to Micro USB / Type-C to Mini USB. Choose the correct cable corresponding to the USB port type of the camera. For the compatibility details, please visit the official website of ZHIYUN ([www.zhiyun-tech.com](http://www.zhiyun-tech.com)) and check the CRANE 4 Camera Compatibility List.

### Installing a Fill Light Reflector

Align the opening of the fill light reflector with the fill light of CRANE 4, then cover the reflector over the fill light to complete installation.

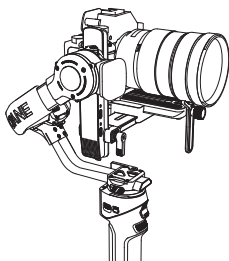
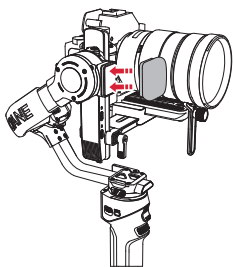



## Installing TransMount Wrist Rest 2S and TransMount Extendable Sling Grip 2S (hereinafter referred to as “Sling Grip” and “Wrist Rest”)

### Installing Sling Grip

Align the installation screw of the sling grip with the installation screw hole ①, adjust the sling grip to the appropriate position and tighten the screw ②. Rotate the sling grip to the far right ③, and tighten the sling grip lock screw after adjustment is completed ④. The sling grip can also be rotated to the far left and adjusted for dual-hand use.

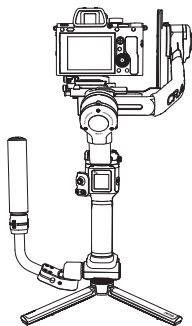
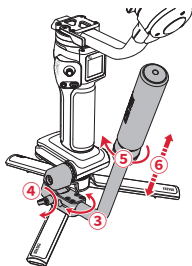
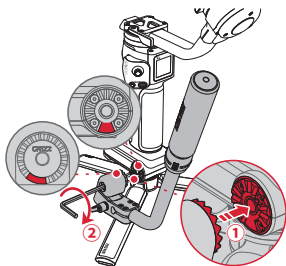

Dual-Hand Mode

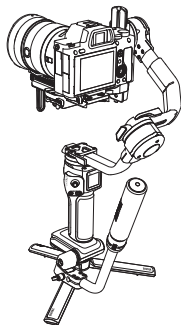

Sling Mode

### Installing Wrist Rest

Align the installation screw of the wrist rest with the installation screw hole ①, adjust the wrist rest to the appropriate position and tighten the screw ②, and the installation is completed. According to usage needs, adjust the position of the screw by rotating the wrist rest angle ③.

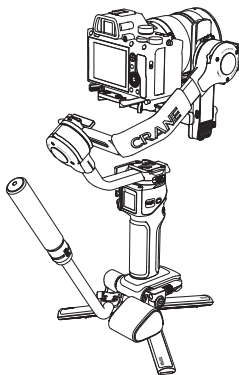
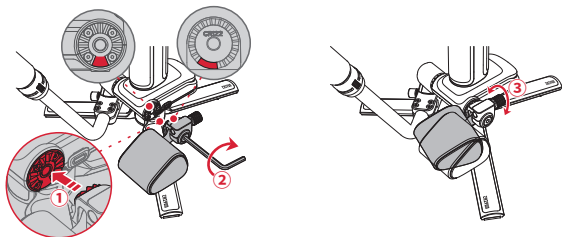

Installation completed

 Please adjust the sling grip and wrist rest to a proper position to avoid an unpleasant user experience. The sling grip is extendable, you can adjust it to the length that best suits you.

## Balancing

### 1. Horizontal Balance of the Tilt Axis

Unlock the tilt axis lock switch ① and loosen the quick release plate latch ② . Push the camera to move forward or backward ③ until the camera can stay still and almost level with its lens facing front ④ . Complete this step by tightening up the quick release plate latch ⑤ .

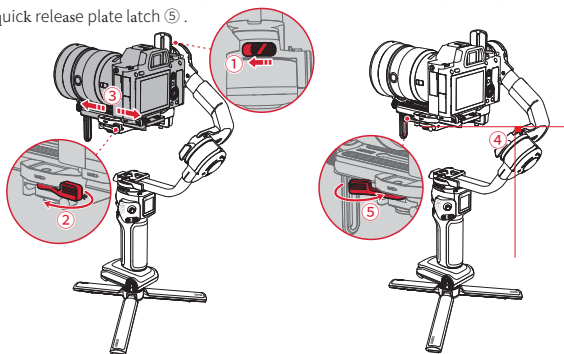

### 2. Vertical Balance of the Tilt Axis

Make the lens face up, loosen the level mount lock screw ① . Push the whole level mount to move forward or backward ② . Push until the camera can stay still with the lens facing up (i.e.the camera stays still and vertical to the ground) ③ . Complete this step by tightening up the screw ④ .

