

# hohem®

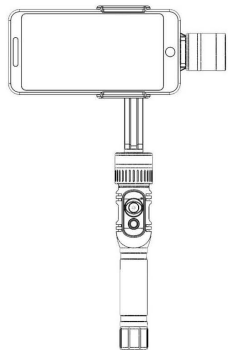

## T2

3-Axis Stabilizing Gimbal  
For Smartphone

Hohem Technology Co.,Ltd

### Product Instruction>>

#### • Product Overview

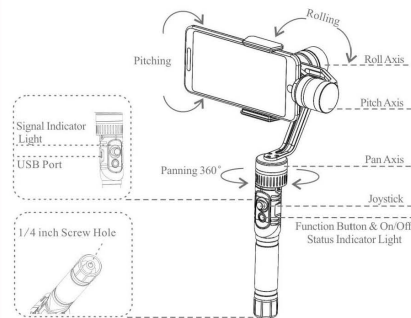

#### • Accessories

Standard Accessories	Optional Accessories
18650 Rechargeable Battery*1	Remote Controller
Micro USB Cable*1	Tripod
Counter Weight*1	Extension Stick
Handbag*1	Bike Mount
User Manual*1	Adapter for Action Camera
Warranty Card*1	/

/1/

### Installation Instruction>>

#### 1 Install the 'Hohem Studio' App



Search for "Hohem Studio" in the App Store or Google Play, and install the app on your mobile phone "Hohem Studio". "Hohem Studio" supports iOS 8.0 and Android 4.4 or above.

#### 2 Prepare the battery



Fully charge the battery before using it for the first time, the charging time is about 2.5 hours while directly charging from the wall charger. (a. Charging status: The light quick splashing, b. Battery fully charged: The light constant on) Please insert the battery as below shown.

\*Charging: Using the standard USB CABLE Connecting to the Gimbal charging port (or other power sources).

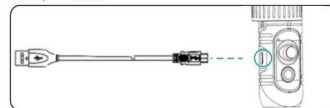

#### 3 Mount the Smartphone

With the T2 Gimbal powered off, loosen the phone holder until the phone is in the right position. And then release your hand.



NOTE: The phone home button side must be placed closed to the pitch motor and ensure it is fixed tightly in order to avoid the gimbal shaking.

#### 4 Balance the Smartphone

Without power on, the gimbal can get self-balance status when you release the hands.

/2/

# hohem®

Hohem Technology Co., Ltd  
http://www.hohem-tech.com  
Email: service@hohem-tech.com

If you have any comments or suggestions about our products, please send email to us. Thank you for your cooperation.

### Firmware Upgrade>>

Please visit the official website <http://www.hohem-tech.com>, and visit the SUPPORT to download the USB driver software, the software of T2 firmware upgrade, the latest firmware and operation manual to upgrade the firmware.

We provide various kinds of optional accessories for our gimbals. Please contact us for more information. Email: [service@hohem-tech.com](mailto:service@hohem-tech.com)

### Disclaimer>>

- Please install and use the product according to the manual!
- Please use the standard battery charger!
- Please reconfirm the gimbal and the smartphone are well installed before power on!
- Keep the battery away from fire and heat source!
- Prohibit any user for any illegal purpose. Users will be responsible for all behavior of purchasing and using the products.
- For any unknown sources or usage, we will not provide any service.
- If there is any question, please contact the technician of Hohem tech, we won't be responsible for any wrong operations by users.
- Hohem tech reserves the right for final explanation.

/6/

### Parameters>>

Handle Size	87.5*13*13mm
Material	Aluminium Alloy
Weight	399g (Including battery) 1136g (Whole package)
Folding Size	322mm * 115mm * 36mm
Pitching Angle	320°
Rolling Angle	320°
Panning Angle	360°
Working Voltage	6.0V-12.0V
Overload Current Protection	1A
Battery Life	2000mAh / 4 hours
Adaption	iPhone5/5s/SE/6/6s/7/6 plus/6s plus/7 plus, SAMSUNG GALAXY, HUAWEI and more Android Smartphone under 6" Screen.
Frequency/Power	2.4GHz / 1.79dBm

### Calibration(Initialization)>>

If the gimbal has the following situations, please calibrate it:

- 1) The pitch angle is not perpendicular to the horizontal surface,
- 2) The roll angle is not parallel to the horizontal surface;
- 3) Under the lock mode, the panning angle drifting.

#### Calibration Operation Instruction:

##### Method 1: Off-line Calibration

- (1) Power on the gimbal (around 3 seconds), long press the middle button of the joystick over 6 seconds till the status indicator light is solid.
- (2) Lay the gimbal on a static flat surface; make sure it has no shaking. Calibration is finish when the status indicator light is continuously flashing for 3 times.
- (3) Power off the gimbal and restart it, if the calibration is unsuccessful, you can repeat step 1(2) to reinitialize.

##### Method 2: Online Calibration

Please visit our official website <http://www.hohem-tech.com>, and visit the SUPPORT to download the calibration software of T2 and operation introduction to calibrate the gimbal.

/5/

### Controls Instruction>>

#### 1 5-Way Joystick

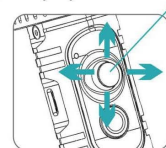

Middle button: Switch the working mode

- ◇ Single Click: Panning Mode Following
- ◇ Double Click: Panning and Pitching Mode Following
- ◇ Triple Click: Lock Mode Following
- ◇ Quartic Click: Vertical Screen Mode/ (Quartic click to quit)
- ◇ Long press for 3 seconds: Zoom in/out by joystick (Single tap to quit)
- ◇ Long press for 6 seconds: Enter the calibration.
- Left/Right: Panning angle adjustment
- Up/Down: Pitching angle adjustment/Zoom in or zoom out

#### 2 Function Button

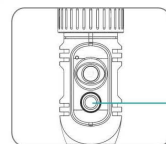

- ◇ Single Click: Take photo (With "Hohem Studio" App)
- ◇ Double Click: Start video (With "Hohem Studio" App)
- ◇ Long Click: Power on/off

### Working Mode Instruction>>

#### 1 Basic Working Modes

Working Mode	Instruction
Panning Following Mode	The phone can move to left or right smoothly along with the handheld moving. The pitching and rolling directions fixed.
Pan & Pitch Following Mode	The phone can move to left or right and pitch up and down smoothly along with the handheld moving. The rolling directions fixed.
Lock Mode	The phone stays in its current orientation. The panning, pitching and rolling direction are all fixed.
Vertical Screen Mode	Live streaming mode with vertical placement.

#### 2 Smart Shooting Modes

##### "Hohem Studio" App

- 📷 Face Auto-Tracking Shooting.

- 📷 Single Click for 180°/360° panorama.

\*Please refers to the APP guidances to get more features, such as "Motion Timelapse", "Single Click for Calibration" and so on.

/4/

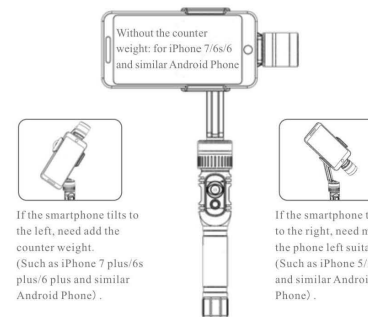

If the smartphone tilts to the left, need add the counter weight. (Such as iPhone 7 plus/6s plus/6 plus and similar Android Phone).

If the smartphone tilts to the right, need move the phone left suitably. (Such as iPhone 5/5s and similar Android Phone).

#### 3 Connect to the "Hohem Studio" App

1. Enable the Bluetooth and turn off the portrait orientation lock on the smartphone.
2. Launch the "Hohem Studio" App and then choose the exact model of your device.
3. Power on the gimbal: Long press the function button until the signal indicator light flashes for twice. (Power off the gimbal: Long press the function button until the signal indicator light flashes for twice).
4. Connect to the gimbal: Follow the instructions to connect to the gimbal.

### Indicator Light Instruction>>

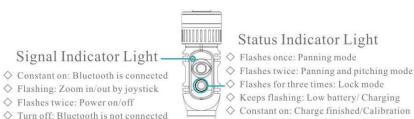

Signal Indicator Light

- ◇ Constant on: Bluetooth is connected
- ◇ Flashing: Zoom in/out by joystick
- ◇ Flashes twice: Power on/off
- ◇ Turn off: Bluetooth is not connected

Status Indicator Light

- ◇ Flashes once: Panning mode
- ◇ Flashes twice: Panning and pitching mode
- ◇ Flashes for three times: Lock mode
- ◇ Keeps flashing: Low battery/ Changing
- ◇ Constant on: Charge Finished/Calibration

/3/

## **Manufacturer declarations**

### **Warranty**

#### **USB**

Due to the used enclosure material, the product shall only be connected to a USB Interface of version 2.0 or higher. The connection to so called power USB is prohibited.

#### **Temperature**

The suitable temperature for the product and accessories is -10°C~40°C.

#### **Battery**

CAUTION RISK OF EXPLOSION IF BATTERY IS REPLACED BY AN INCORRECT TYPE.  
DISPOSE OF USED BATTERIES ACCORDING TO THE INSTRUCTIONS

## **SIMPLIFIED EU DECLARATION OF CONFORMITY**

The simplified EU declaration of conformity referred to in Article 10(9) shall be provided as follows: Hereby, Hohem Technology Co., Ltd. declares that the radio equipment type T2 is in compliance with Directive 2014/53/EU. The full text of the EU declaration of conformity is available at the following internet address: <http://www.hohem-tech.com>

  
signature

#### **FCC caution**

The device has been evaluated to meet general RF exposure requirement, The device can be used in portable exposure condition without restriction  
Federal Communication Commission (FCC) Radiation Exposure Statement  
Power is so low that no RF exposure calculation is needed.

#### **FCC statements**

This device complies with part 15 of the FCC rules. Operation is subject to the following two conditions: (1) this device may not cause harmful interference, and (2) this device must accept any interference received, including interference that may cause undesired operation.

NOTE: The manufacturer is not responsible for any radio or TV interference caused by unauthorized modifications or changes to this equipment. Such modifications or changes could void the user's authority to operate the equipment.

NOTE: This equipment has been tested and found to comply with the limits for a Class B digital device, pursuant to part 15 of the FCC Rules. These limits are designed to provide reasonable protection against harmful interference in a residential installation. This equipment generates uses and can radiate radio frequency energy and, if not installed and used in accordance with the instructions, may cause harmful interference to radio communications. However, there is no guarantee that

interference will not occur in a particular installation. If this equipment does cause harmful interference to radio or television reception, which can be determined by turning the equipment off and on, the user is encouraged to try to correct the interference by one or more of the following measures:

- Reorient or relocate the receiving antenna.
- Increase the separation between the equipment and receiver.
- Connect the equipment into an outlet on a circuit different from that to which the receiver is connected.
- Consult the dealer or an experienced radio/TV technician for help.