

iSteady™

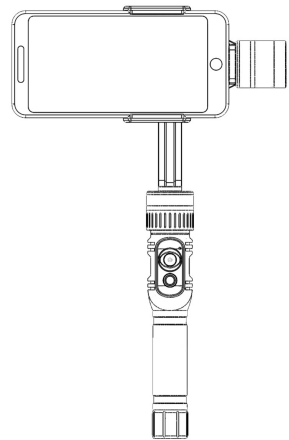

3-Axis Handheld Stabilizer For Smartphone

Hohem Technology Co. , Ltd

Product Instruction >>

• Product Overview

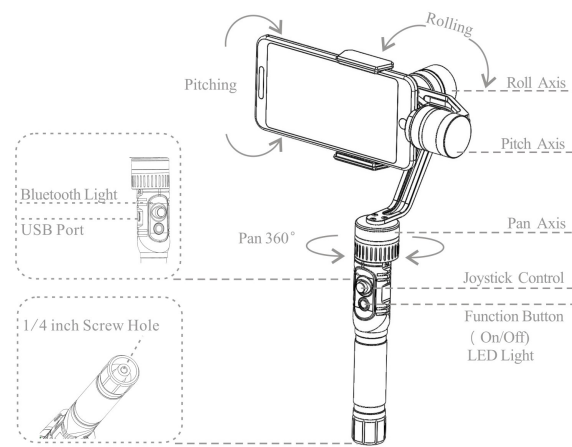

• Accessories

Standard Accessories	Optional Accessories
18350 Rechargeable Battery*2pairs	Remote Controller
Battery Charger-S*1	Tripod
Micro USB Cable*1	Telescopic Rod
User Manual*1	Bike Mount
Warranty Card*1	Battery Extension Suit
Balance Weight*1	/

User Manual >>

• Attention!! Please confirm the phone have been installed well and keep balance the roll axis at the condition of not powered on before power on the gimbal!

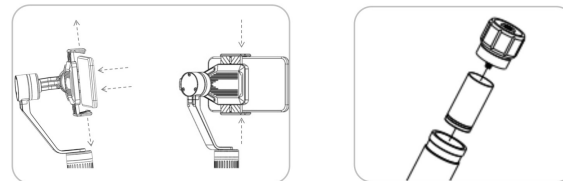

1 Install The Smartphone

Pull the clamps of the smartphone holder, place the smartphone, and press the lock button on the side of the holder. Ensure your smartphone is fully seated.

2 Batteries Input

Unscrew the battery cover at the bottom of iSteady, insert two 18350 batteries (insert two 18650 batteries if mount the battery extension tube) and screw tight the battery cover.

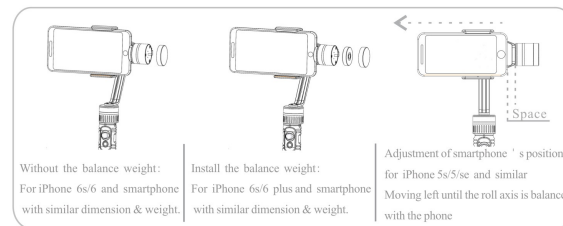

3 Adjustment of smartphone's position & balance weight

Unscrew the cover of balance weight, and fine adjustments may needed to getting better product performance as shown below

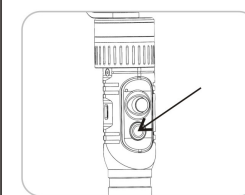

4 Power on

After confirm that the smartphone and batteries have been install well,and press the function button until the bluetooth light flashing for two times,the iSteady will power on.

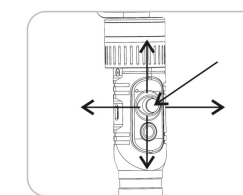

5 Mode or function switch

Switch working modes by joystick, and take photos or video by function button.Please refer to the working mode&operation instruction.



6 Enter the smart working mode

- 1 Download 'FIEDORA' APP:Scan QR code.iPhone visit AppStore to download,and Android visit GooglePlay to download.
- 2 Connected the iSteady:Open Bluetooth and 'FIEDORA',and choose iSteady to connect at 'FIEDORA'.After connection finished,the Bluetooth light is keep on and the smartphone show the information is connected.
- 3 Smart working mode:Please refer to the 'FIEDORA' APP instruction.

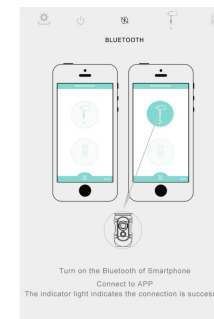

Working Mode&Operation Instructions>>

• Working Mode &LED Instruction

Working modes	LED	Instruction
Pan Follow Mode	Single Flash	Roll& Pitch are Locked,Pan will smoothly follow the rotate direction of handle bar.
Pan&Pitch 2-axis Follow Mode	Double Flash	Roll is Locked,Pan&Pitch will smoothly follow the rotate direction of handle bar.
All Locked Mode	Triple Flash	Pan, Roll and Pitch are all Locked
Smart Follow Mode	/	Enter the FIEDORA,and you can choose various functions of the smart follow
Self-motion Panorama Mode	/	Enter the FIEDORA,and you can choose self-motion taking panorama for 360°
Manual Adjustment Pitch Mode	/	Expect the Pan&Pitch 2-axis Follow Mode,you can adjust the pitch angle manually,and stay for 0.5 second to attain the pitch angle.

Attention!!If the LED flash quickly, it means battery low voltage warning! Product stops working,and need to change to fully charged batteries.

• Bluetooth Signal Light Instruction

Bluetooth Light Situation	Instructions	
Turn on	Solid Light	Bluetooth is connected
	Flash	Bluetooth is connected,and means the Up/Down functions of Joystick are Image Zoom In/Out.
Turn off	Bluetooth is not connected	
Quick flash for two times	When power on, means accomplishing	
	When power off, means accomplishing	

• Joystick Operating Instruction

Operation	Functions	Comments
Middle Button	Single Click	Switch Working Mode
	Double Click	Switch to Pan & Pitch 2-axis Follow Mode
	Triple Click Press for 6 seconds	Switch to All Locked Mode
Up/Down	Calibration	/
	Pitch angle adjustment (Image Zoom in / out)	When the bluetooth is solid light:Pitch angle adjustment.When the bluetooth is flash:Image Zoom In/Out.And these functions's switch need to press and hold the function button for 3 seconds
Left/Right	Pan angle adjustment	Support 360° adjustment

• Function Operation

Operating	Functions	Comments
Long press	Power on/off	Bluetooth light flash 2 times: means power on/off
Single press	Photograph	Open the bluetooth and smartphone, and connect with iSteady
Double press	Video	

• Product Specifications

	Standard	Range	Comments
Working Voltage	8.4V	6.0V ~ 12.V	/
Pitch Angle	0°	-160° (down) ~+160° (up)	Handheld in vertical
Roll Angle	/	-160°~+160°	
Pan Angle	/	360°	
Overload Current Protection	1A		
Dimension	124mm*95mm*304mm		
Weight	420g (iSteady Main Unit) 850g (Whole Package)		
Compatibility	Support iPhone6/6s plus, iPhone6/6s, iPhone5/5s/se, and smartphone with similar dimension&weight		

• FIEDORA APP Instruction

1. Open the bluetooth of smartphone.
2. Scan the QR code and enter the download interface.
3. According to your smartphone system to download the APP FIEDORA.
4. Open the FIEDORA APP and choose to connect with iSteady or remote controller.



5. Enter the Smart Follow Mode:

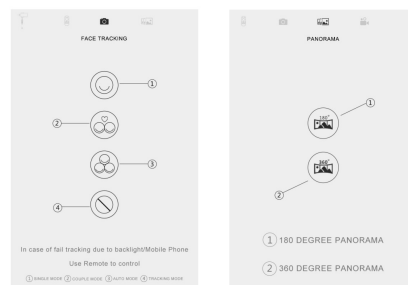

Using Skill>>

- 1)Smooth&steady image quality :Hold the iSteady as far as possible to keep the arm steady for movement, and also walk lightly and smoothly at a uniform speed.
- 2)Fixed-film:If you want to take photos or video with a fixed object, you can first adjust the pitch angle and then switch into the all locked mode locked the pan and pitch angle.
- 3) "0" height film :You can hold the iSteady handle up and the smartphone down, and the height of the smartphone is almost zero , and to adjust the angle by joystick .Like that you can take photos or video with the object of low position.

Firmware Upgrade>>

Please visit the official website of Hohem Tech www.hohem-tech.com to download the USB driver software ,iSteady firmware upgrade software, iSteady latest firmware and the iSteady upgrade operation manual, etc, and do those operations strictly according the manual.

Calibration>>

If the iSteady Gimbal have the following phenomenon,please calibrate it:

- 1)After power on ,there is deviation between the the pitch angle and the horizontal;
- 2)There is deviation between the roll angle and the horizontal;
- 3)When keep the head static, there is frequent small angle correction in the head angle.

Calibration operation introduction

Method 1:Off-line calibration

- 1)Power on the gimbal, wait at least 3 seconds.
- 2)Long press the middle button of the joystick, keep over 6 seconds ,and all the motors will be closed ,at this time the LED indicator of the function button will light up and keep on.
- 3)Please put the iSteady as the picture , and keep it and the leveled platform stationary.Observe the LED indicator, until the LED flash three-times and then keep on means the calibration is completed.
- 4)Attention: Do please remain the platform horizontal, after put the iSteady on the platform do keep the gimbal and also the horizontal platform stationary. And please put the function button face up in order to observe the LED indicator clearly.
- 5)After you do the calibration successfully ,please power off the iSteady.
- 6)Power on the iSteady, check if the iSteady still have the status that you have to do the calibration.if not please enjoy your use for the iSteady.If the status still exist, please confirm if there is incorrect operation through the calibration and then do the calibration operation again until the iSteady work normally.

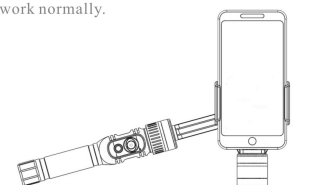

Method 2:Online calibration

Please visit the official website of Hohem Tech <http://www.hohem-tech.com> to download the Calibration Software of iSteady and operation introduction to calibrate.

Attention>>

- Please install and use the product according the manual!
- Do use the standard battery charger!
- Do reconfirm the Gimbal and the camera install well before power on
- Keep the battery away from fire and heat source!
- Prohibit any user for any illegal purpose.Users will be responsible for all behavior of purchase and use products.
- For any unknown sources or using,we will not provide any service.
- If there is any question please contact the technician of Hohem tech, we won't be responsible for any wrong operation by users.
- Hohem tech reserves the right for final explanation.

RF exposure information: To maintain compliance with FCC RF exposure requirements, use the product that maintain a 20cm separation distance between the user's body and the host.

FCC statements:

This device complies with part 15 of the FCC rules. Operation is subject to the following two conditions: (1) this device may not cause harmful interference, and (2) this device must accept any interference received, including interference that may cause undesired operation.

NOTE: The manufacturer is not responsible for any radio or TV interference caused by unauthorized modifications or changes to this equipment. Such modifications or changes could void the user's authority to operate the equipment.

NOTE: This equipment has been tested and found to comply with the limits for a Class B digital device, pursuant to part 15 of the FCC Rules. These limits are designed to provide reasonable protection against harmful interference in a residential installation. This equipment generates uses and can radiate radio frequency energy and, if not installed and used in accordance with the instructions, may cause harmful interference to radio communications. However, there is no guarantee that interference will not occur in a particular installation. If this equipment does cause harmful interference to radio or television reception, which can be determined by turning the equipment off and on, the user is encouraged to try to correct the interference by one or more of the following measures:

- Reorient or relocate the receiving antenna.
- Increase the separation between the equipment and receiver.
- Connect the equipment into an outlet on a circuit different from that to which the receiver is connected.
- Consult the dealer or an experienced radio/TV technician for help.