

Product Overview

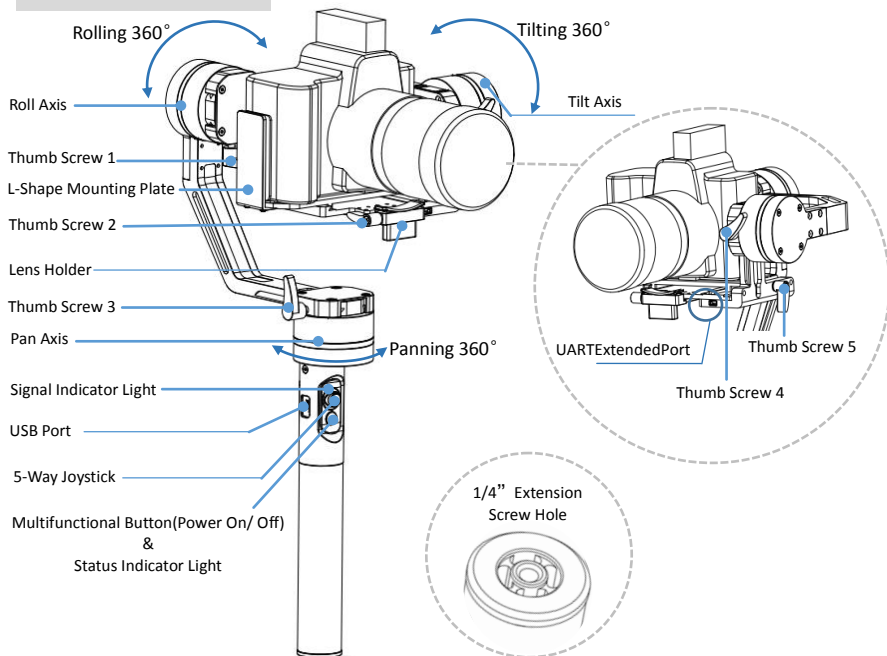

Accessories List

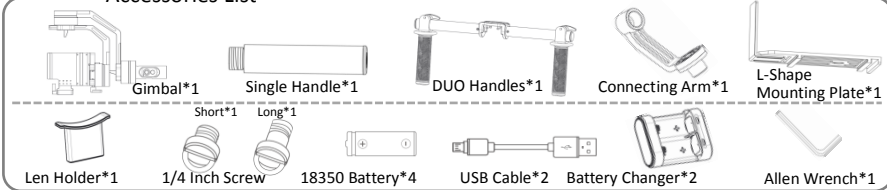

Quick Installation

1. Insert 4PCS 18350 batteries, ensure battery positive pole upside *4 PCS

(Please use the standard charger for charging)

2. Camera Installation: (1) Install Mounting Plate

Adjust the screw making mounting plate appropriate position.

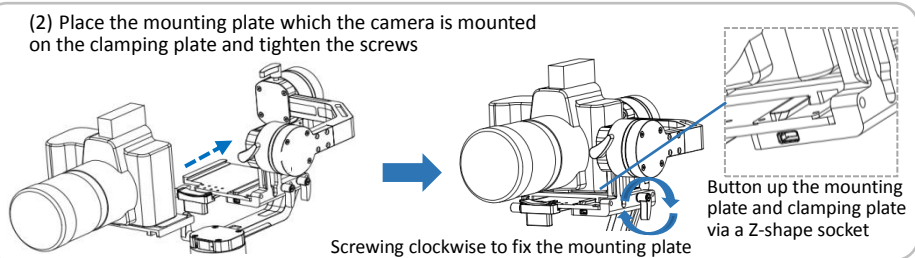
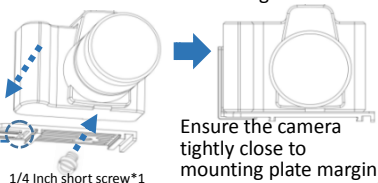

3. Balancing: (1) Balancing the Tilt Axis

a. Adjust tilt axis balance in horizon direction: Place the gimbal like picture 3-1-a, hold the roll axis and keep it in horizontal steady, position the camera lens pointing forwards and loosen the lens, observe the camera status.

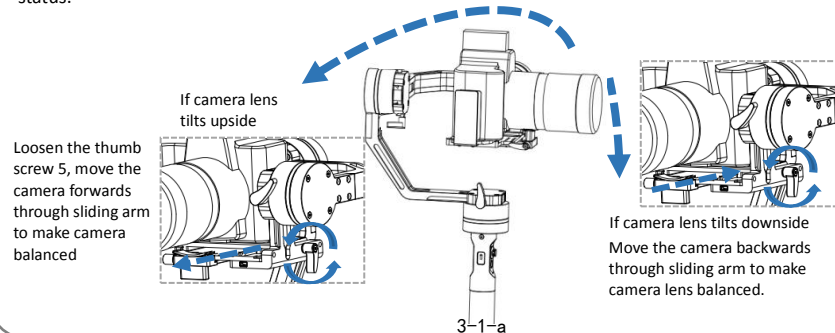

b. Adjust tilt axis balance in vertical direction: Place the gimbal like picture 3-1-b, hold the roll axis and keep it in horizontal steady, position the camera lens pointing upwards, then loosen the lens, observe the camera status.

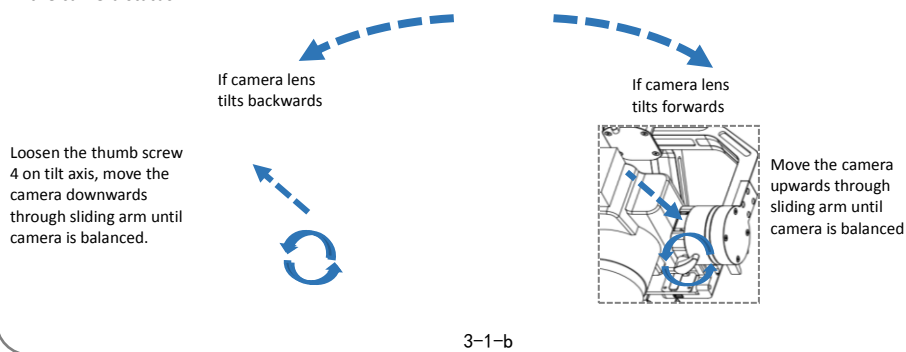

(2) Balancing the Roll Axis

Place the gimbal like picture 3-2, hold the roll axis and stay level, then loosen the camera, observe the roll axis status.

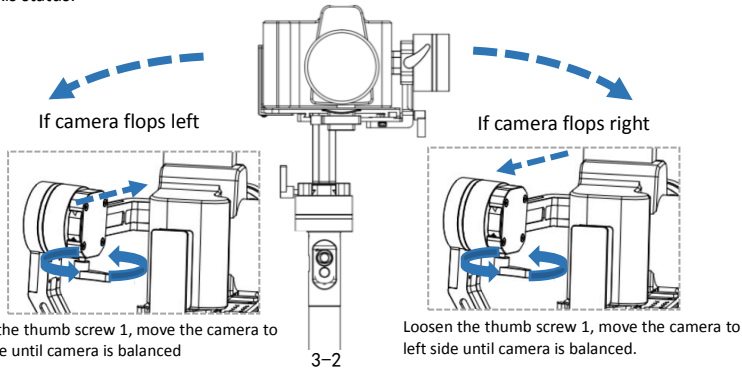

(3) Balancing the Pan Axis

Place the gimbal like picture 3-3, hold the pan axis and stay level balanced, then release the camera, observe the lens status.

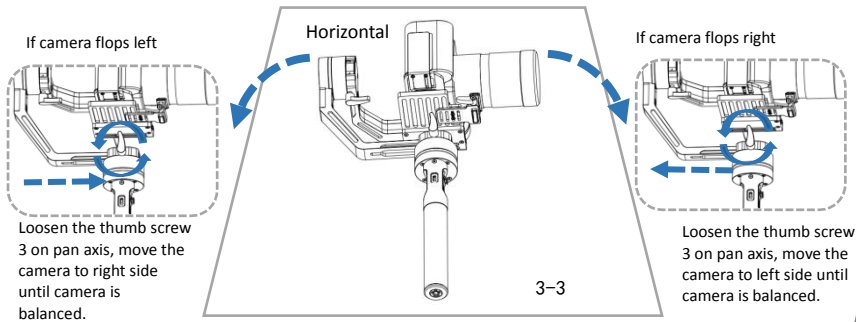

4. Lens Is Fixed By The Lens Holder

After tilt, roll, pan axis balancing done, fix the lens by lens holder.

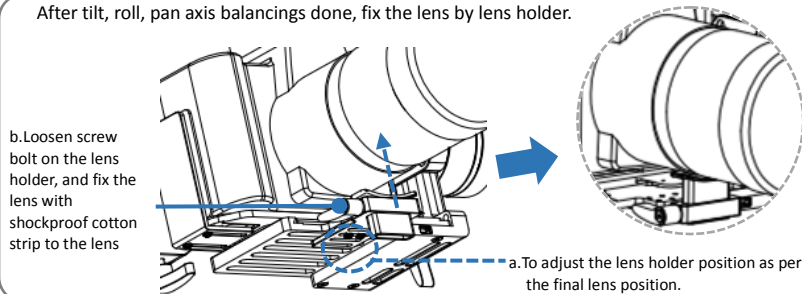

Multiple Configurations

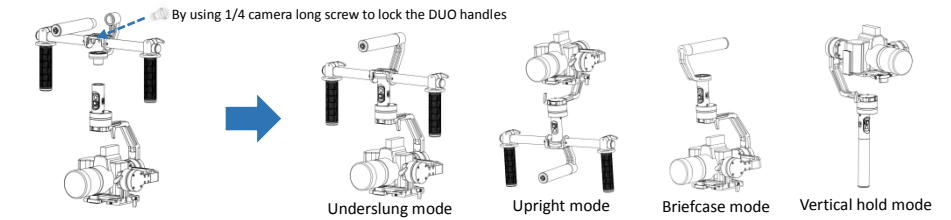

Operating Instructions

5-Way Jostick

UP/DOWN: Adjust tilt angle	RIGHT/LEFT: Adjust pan angle
----------------------------	------------------------------

Multifunctional button (Switch working modes & status indicator light)

Single press: Panning mode following, tilt axis & roll axis both locked, camera can move to left or right smoothly, indicator light flash for once.

Double press: Panning & Tilting mode following, roll axis locked, camera can move to left/right, and pitch rotate, indicator light flash for twice.

Triple press: locked mode, all 3 axis locked, the camera stays in its current orientation, indicator light flash for triple.

Long press for 6 seconds: Enter into initialization calibration mode, status light is normal on.

Multi Functional Button & Status Indicator Light

Power on: Long press for 3 seconds until the status indicator light flash for twice.

Power off: Long press for 3 seconds until the status indicator light flash for twice.

*More controllable functions can be realized by connecting auxiliary device in the UART extended port.

APP Connecting Instruction

(Support iOS system 8.0 or above and Android system 4.4 or above)



(1) Scan the QR code and download APP "Hohem Gimset" in APP Store or Google Play

(2) Launch the bluetooth on the smartphone

(3)

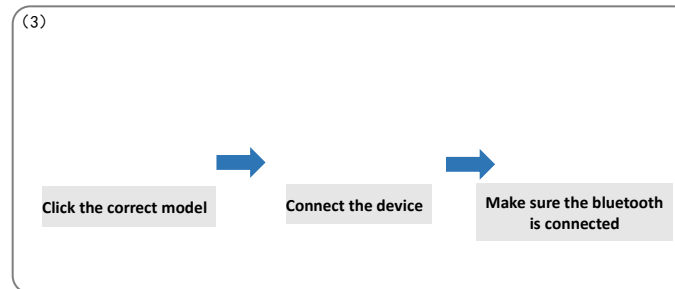

Please scan the QR code to get more functions introduction



Please scan the QR code to get more products enquiries

FCC statements:

This device complies with part 15 of the FCC rules. Operation is subject to the following two conditions: (1) this device may not cause harmful interference, and (2) this device must accept any interference received, including interference that may cause undesired operation.

NOTE: The manufacturer is not responsible for any radio or TV interference caused by unauthorized modifications or changes to this equipment. Such modifications or changes could void the user's authority to operate the equipment.

NOTE: This equipment has been tested and found to comply with the limits for a Class B digital device, pursuant to part 15 of the FCC Rules. These limits are designed to provide reasonable protection against harmful interference in a residential installation. This equipment generates uses and can radiate radio frequency energy and, if not installed and used in accordance with the instructions, may cause harmful interference to radio communications. However, there is no guarantee that interference will not occur in a particular installation. If this equipment does cause harmful interference to radio or television reception, which can be determined by turning the equipment off and on, the user is encouraged to try to correct the interference by one or more of the following measures:

- Reorient or relocate the receiving antenna.
- Increase the separation between the equipment and receiver.
- Connect the equipment into an outlet on a circuit different from that to which the receiver is connected.
- Consult the dealer or an experienced radio/TV technician for help.

The device has been evaluated to meet general RF exposure requirement, The device can be used in portable exposure condition without restriction

Federal Communication Commission (FCC) Radiation Exposure Statement

Power is so low that no RF exposure calculation is needed.