



Smart Lock



WARNING

- Do not use an electric screwdriver for installation. (Use a Phillips screwdriver)
- Do not install the batteries before installing the lock.

Visit reagle.io/support for more information

QUICK START

1 Install Reagle Smart Lock (See installation guide)

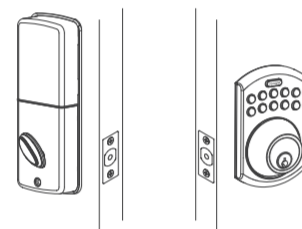

2 Download Reagle App

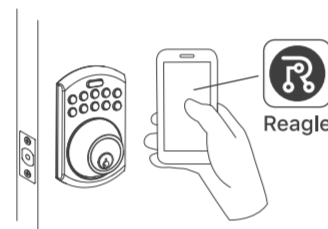

3 Set Up Reagle Smart Lock with the App

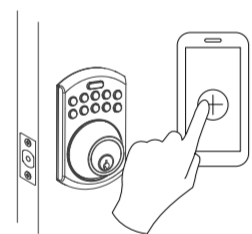

4 Connect with HomeKit (iOS only)

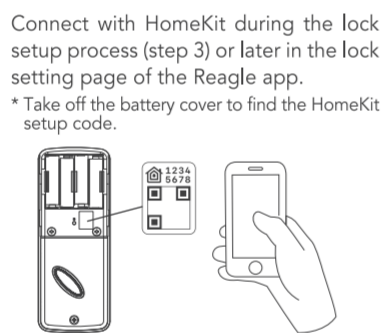

PACKAGE CONTENTS

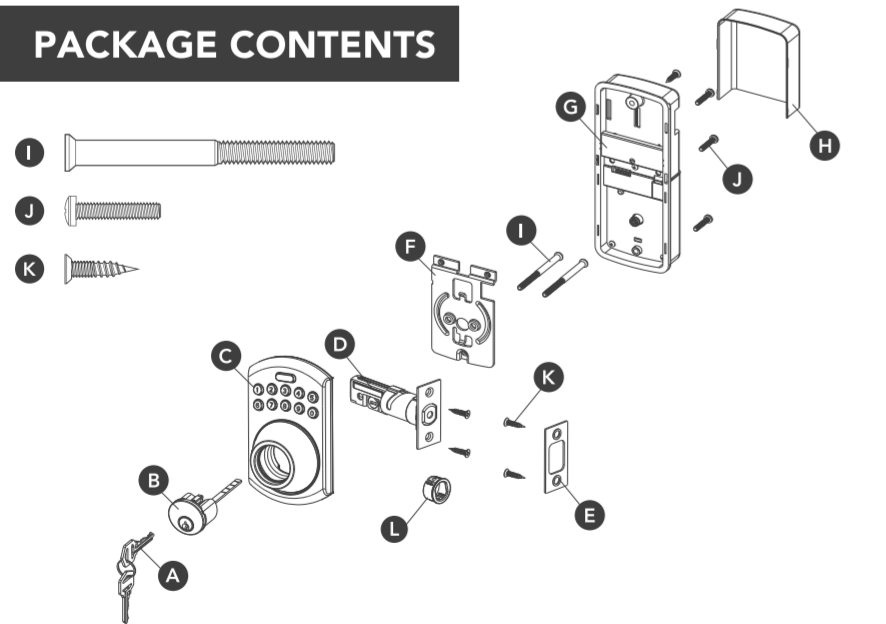

Part	Description	Quantity	Part	Description	Quantity
A	Key	2	G	Interior Assembly	1
B	Cylinder	1	H	Battery Cover	1
C	Deadbolt Keypad Assembly	1	I	Deadbolt Chassis Screws	2
D	Deadbolt Latch	1	J	Machine Screws	3
E	Strike Plate	1	K	Wood Screws	5
F	Mounting Plate	1	L	Drive-in Sleeve	1

INSTALLATION GUIDE

1 Latch Adjustment

To fit the 2-3/8" (60 mm) or 2-3/4" (70 mm) backset*, the latch needs to be adjusted. To adjust the length, twist the faceplate to extend the latch length until it stops. It will fit the 2-3/4" (70 mm) backset. Reverse the direction to fit the 2-3/8" (60 mm) backset.

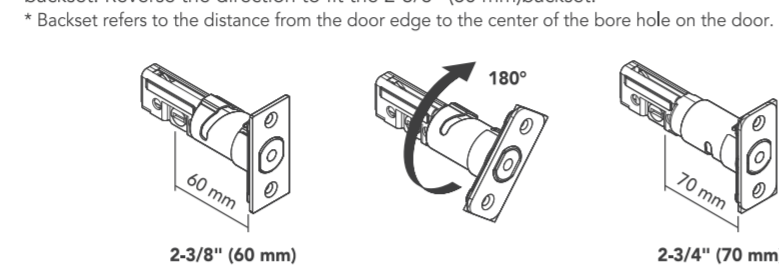

2 Drive-in Latch (If required)

Remove original latch faceplate. Align the drive-in sleeve as illustrated and snap into the latch case.

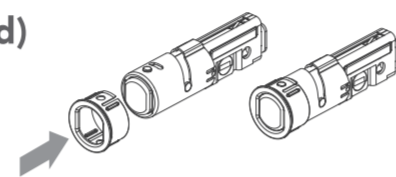

3 Install Latch

Make sure the arrow mark on the latch pointing up before inserting the latch.

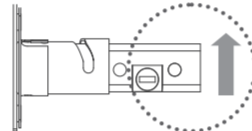

Insert the latch into the door. Use 2 wood screws to secure latch.

Insert the drive-in latch into the hole on edge of door.



Install the strike plate into your door frame and tighten it with wood screws.

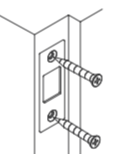

4 Install Keypad Assembly

Install cylinder into the deadbolt keypad assembly with tailpiece in horizontal position inserted through hub of the latch.

Route the cable under the latch to the interior side of the door.

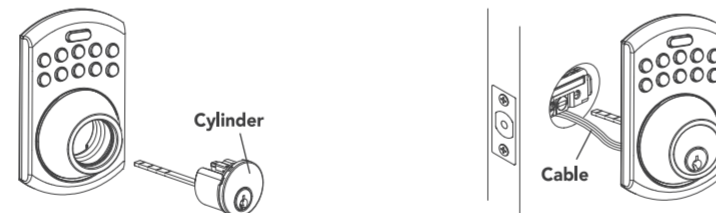

5 Install Mounting Plate on the Inside of your Door

Route the cable through the cable hole of the mounting plate. Fix the mounting plate with screws. If outside lock assembly is lopsided, please loosen the screws to adjust its position and tighten the screws again.

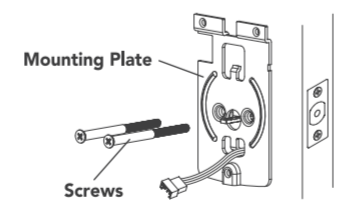

6 Identify Door Handing

Face the door from the outside. The door is left-handed if the hinges are on the left side of the door, whereas the door is right-handed if the hinges are on the right side of the door.

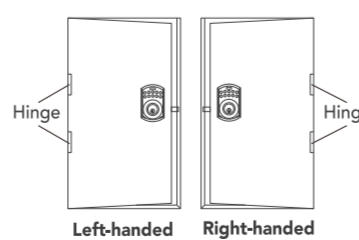

7 Adjust Thumb Turn Piece

Rotate the thumb turn piece to the LEFT at 45 degrees for right-handed doors. Rotate the thumb turn piece to the RIGHT at 45 degrees for left-handed doors.

Note : The thumb turn piece is opposite to the latching side.



8 Install Interior Assembly

Remove the battery cover. (push it up first then pull it out)

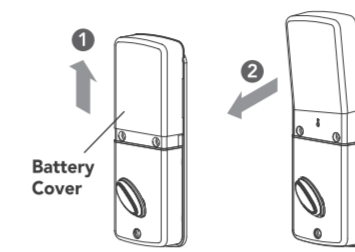

Connect the cable into the back of the interior assembly. Ensure that the deadbolt tailpiece is engaged with turn piece, then attach the interior assembly to the door with screws. Use the optional wood screw to secure the interior assembly to wood doors only.

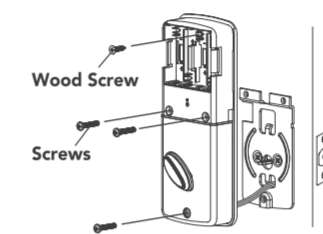

9 Insert Batteries

Insert 4 (AA) 1.5 V alkaline batteries and slide the battery cover back onto the interior assembly.

- Remarks:
- Please use alkaline batteries. Do Not use rechargeable batteries.
 - All settings will be retained in the memory even if the batteries are completely dead.

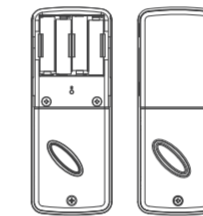

DRILLING GUIDE (IF REQUIRED)

If you do not have existing holes for a standard deadbolt lock on the door, please follow the instructions. Please skip this section if you just want to replace your existing deadbolt with Reagle smart lock.

1 Determine the Position of Backset

"Backset" refers to the distance between the door edge and the centre of the crossbore for the deadbolt. Adjustable latch fits both backset of 2-3/8" (60 mm) and 2-3/4" (70 mm).

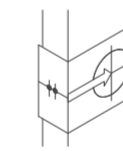

2 Use the Paper Template to Mark Drilling Spots

Select the height and backset as desired on the door face; use the TEMPLATE as an indication to mark the center of the crossbore on the door and the center of the door edge.

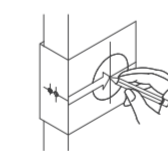

3 Drill Holes

Use the marks as a guide to drill a hole Ø2-1/8" (54 mm) through the door face for the lockset, then a hole of Ø1" (25.4 mm) for latch.

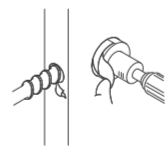

4 Chisel out a Groove for the Latch

Insert the latch and ensure it is parallel to the door face. Mark the outline of the faceplate, then take out the latch.

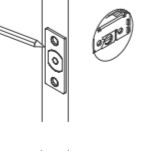

Chisel 5/32" (4 mm) deep along the outline to allow the faceplate to be aligned with the door edge.

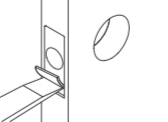

5 Drill a Hole for the Strike Plate

To identify the centre of strike: close the door to lay the latchbolt against the door frame. Mark the centre line on the doorframe exactly opposite the latch hole in the door edge.

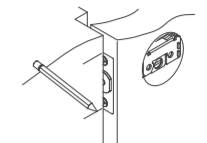

Measure one half of door thickness from door stop and vertically mark centre line of strike. Drill 1" (25.4 mm) hole, 1" (25.4 mm) deep at intersection of horizontal and vertical line of strike. Chisel 5/64" (2 mm) deep along the strike outline to allow the strike to be aligned with the doorframe.

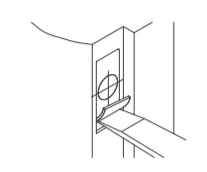

Compliance

FCC Interference Statement:

This equipment has been tested and found to comply with the limits for a Class B digital device, pursuant to Part 15 of the FCC Rules. These limits are designed to provide reasonable protection against harmful interference in a residential installation. This equipment generates, uses and can radiate radio frequency energy and, if not installed and used in accordance with the instructions, may cause harmful interference to radio communications. However, there is no guarantee that interference will not occur in a particular installation. If this equipment does cause harmful interference to radio or television reception, which can be determined by turning the equipment off and on, the user is encouraged to try to correct the interference by one of the following measures:

- Reorient or relocate the receiving antenna.
- Increase the separation between the equipment and receiver.
- Connect the equipment into an outlet on a circuit different from that to which the receiver is connected.
- Consult the dealer or an experienced radio/TV technician for help.

FCC Caution:

Any changes or modifications not expressly approved by the party responsible for compliance could void the user's authority to operate this equipment.

This device complies with Part 15 of the FCC Rules. Operation is subject to the following two conditions: (1) This device may not cause harmful interference, and (2) this device must accept any interference received, including interference that may cause undesired operation.

RF WARNING STATEMENT:

The device has been evaluated to meet general RF exposure requirement. The device can be used in portable exposure condition without restriction.

Product Information

Model Name: PLDB-DIA01

Safety and other important information regarding your Reagle smart lock can be found in the Reagle App in Help > Legal & Compliance and at www.reagle.io/support.

Before using your Reagle smart lock, please read the terms of use, privacy notice, rules, and policies in the Reagle App in Help > Legal & Compliance and at www.reagle.io/support. These terms, notices, and policies are collectively, the "Agreements". By using your Reagle smart lock, you agree to be bound by the Agreements.

Reagle smart lock is covered by a Limited Warranty, detailed in the Reagle App in Help > Legal & Compliance and at www.reagle.io/support.

Apple®, iPad®, iPad Air®, iPhone®, and iPod touch® are trademarks of Apple Inc., registered in the U.S. and other countries. Homekit™ is a trademark of Apple Inc. Siri® is a trademark of Apple Inc. App Store is a service mark of Apple Inc.

Use of the Works with Apple HomeKit logo means that an electronic accessory has been designed to connect specifically to iPod touch, iPhone, or iPad, respectively, and has been certified by the developer to meet Apple performance standards. Apple is not responsible for the operation of this device or its compliance with safety and regulatory standards.

The Bluetooth® word mark and logos are registered trademarks owned by the Bluetooth SIG, Inc. and any use of such marks by PKInno Inc. is under license. Other trademarks and trade names are those of their respective owners.

Android is a trademark of Google LLC. Google Play and the Google Play logo are trademarks of Google LLC.

WARNING
This Manufacturer advises that no lock can provide complete security by itself. This lock may be defeated by forcible or technical means, or evaded by entry elsewhere on the property. No lock can substitute for caution, awareness of your environment, and common sense. Bulbair's hardware is produced in multiple performance grades to suit the application. In order to enhance security and reduce risk, you should consult a qualified locksmith or other security professional.

