

HAVIT

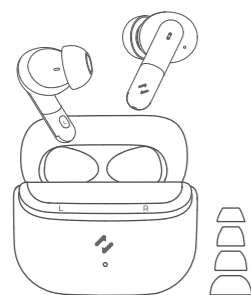

TW982
TRUE WIRELESS STEREO EARBUDS
USER MANUAL

Package Content

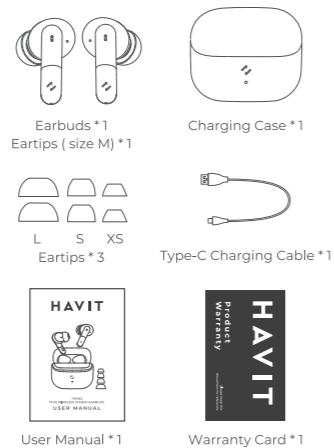

Product Overview

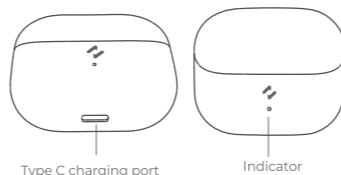
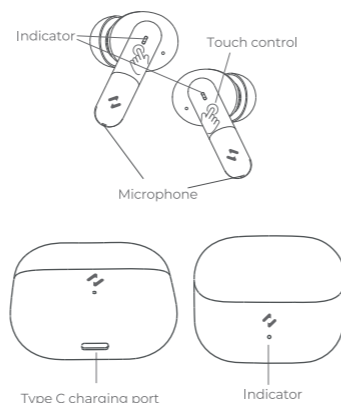

Wearing

Earbuds are fitted with middle size eartips and you can try size S and L, if cannot fit well, Please follow the images to wear the earbuds properly.

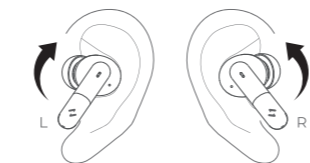

Power on / off



Manual operation

*Power on : Touch and hold any earbud for 3S.
*Power off : Touch and hold any earbud for 3S.

Pairing

*Please remove the protective film of earbuds and charge the case fully for the first time usage.

- Turn on the Bluetooth of your device.
- Open the case and earbuds are in pairing mode while one of the indicator flashes alternately with white and orange light.
- Select HAVIT LIFE OTT on the list.
- HAVIT LIFE OTT now is paired with your device and earbud indicator is off.

Note

The earbuds are automatically connected to the last paired device when the case is open.



Touch Control



- Play/Pause**
Tap either earbud twice
- Previous song**
Touch and hold the left earbud for 1S
- Next song**
Touch and hold the right earbud for 1S
- Answer/End the call**
Tap either earbud twice
- Reject the call**
Touch and hold either earbud for 1S
- Voice Assistant**
Tap the left earbud 3 times
*Note: Mono using is also available
- Game Mode**
Tap the right earbud 3 times

Earbuds Charging

Put the earbuds in the case and close the case. The earbuds are charging.

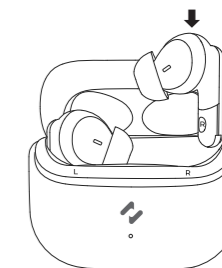

Case Charging

Charge the case with type C charging cable, preferably from any PC or laptop as compared to a USB charger.

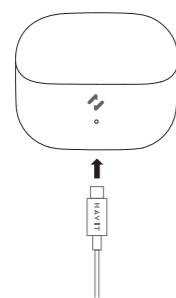

A full charge of the case takes about 1.5 hours.

Orange indicator flashes per 1S Charging
Case Indicator is off Fully charged

Reset

- Put earbuds in the case and close the case.
- Open the case again, touch and hold the two earbuds at the same time for 5S until orange indicator flashes 5 times. Reset is done.
- Turn on Bluetooth of your device and connect HAVIT LIFE OTT again.

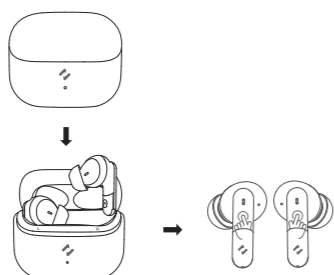

Open the case and earbuds are inside
Touch and hold the two earbuds for 5S

Safety Tips

- Do not expose the earbuds to liquids, moisture or humidity as there are electronics and battery inside battery inside.
- Don't try to disassemble your earbuds. There are no user serviceable parts inside.
- Try not to drop the earbuds and keep them away from sharp objects such as keys in your pockets.
- Clean earbuds tips, metal contact surface of earbuds and case with alcohol cloth regularly to ensure there is no dust accumulation and keep good quality sound experience.
- Charge your earbuds below 5V/1A charger.
- Do not expose the earbuds to extremely high or low temperatures as this may damage the battery or even deform the plastic parts.
- Listen to the music at high volume is harmful to the ears.
- 10) Don't throw the earbuds in a fire to dispose it otherwise inside battery may explode.

FCC ID: 2AIGI-TW982

FCC Warning

FCC STATEMENT
1. This device complies with Part 15 of the FCC Rules. Operation is subject to the following two conditions:
(1) This device may not cause harmful interference, and
(2) This device must accept any interference received, including interference that may cause undesired operation.
2. Changes or modifications not expressly approved by the party responsible for compliance could void the user's authority to operate the equipment.
NOTE: This equipment has been tested and found to comply with the limits for a Class B digital device, pursuant to Part 15 of the FCC Rules. These limits are designed to provide reasonable protection against harmful interference in a residential installation.
This equipment generates uses and can radiate radio frequency energy and, if not installed and used in accordance with the instructions, may cause harmful interference to radio communications. However, there is no guarantee that interference will not occur in a particular installation. If this equipment does cause harmful interference to

radio or television reception, which can be determined by turning the equipment off and on, the user is encouraged to try to correct the interference by one or more of the following measures:
Reorient or relocate the receiving antenna.
Increase the separation between the equipment and receiver.
Connect the equipment into an outlet on a circuit different from that to which the receiver is connected.
Consult the dealer or an experienced radio/TV technician for help.
RF warning statement:
The device has been evaluated to meet general RF exposure requirement. The device can be used in portable exposure condition without restriction.

Batteries:

A warning that batteries (battery pack or batteries installed) shall not be exposed to excessive heat such as sunshine, fire or the light.
1) Replacement of a battery with an incorrect type that can defeat a safeguard;
2) Disposal of a battery into fire or a hot oven, or mechanically crushing or cutting of a battery, that can result in an explosion;
3) Leaving a battery in an extremely high temperature surrounding environment that can result in an explosion or the leakage of flammable liquid or gas;
4) A battery subjected to extremely low air pressure that may result in an explosion or the leakage of flammable liquid or gas.



www.havitsmart.com