



# # LIVE MY SOUND

HAKII MARS

## USER GUIDE

### THE PACKAGE CONTENT



Bluetooth Speaker x1

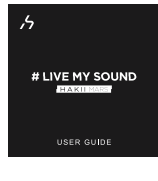

User Guide x1

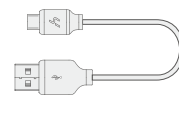

Micro USB charging cable x1

### PRODUCT OVERVIEW

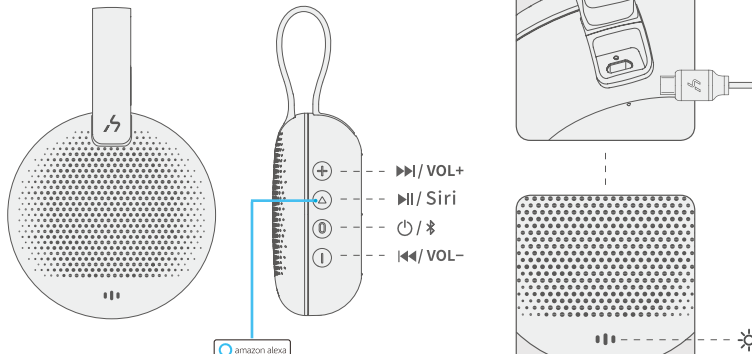

### POWER

Press and hold the power button for 2s to switch HAKII MARS on.  
The product indicator turns flashing white, and the HAKII MARS is ready to be set up.

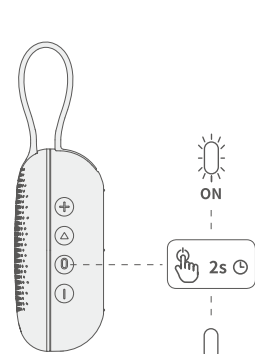

### CONNECT

When the product indicator flashes white, switch on Bluetooth on your device. Find the device list and select HAKII MARS BLE. The product indicator turns solid white, a sound prompt is heard and HAKII MARS is ready to play.



Note: Keep the distance between your smart phone and the Bluetooth Speaker within 3 feet (for pairing only)

### • Speaker Button Controls

#### Calling Functions:

Answer a call: Press   
End a call: Press   
Reject a call: Long Press

#### • Music Functions:

Pause / Resume Music: Press   
Skip to the next song: Press and hold   
Skip to the previous song: Press and hold   
Volume up: Press   
Volume down: Press   
Alexa activation button: Quickly press 2 times  
Siri: Long Press to activate voice recognition (when connecting the iPhone)  
Disconnect the bluetooth: Quickly press 2 times  
Power ON/OFF: Press and hold

### • Charging the Bluetooth Speaker

Please make sure the Speaker is full of charged before using it for the first time.

1. Connecting the included charging cable to the charging port of the speaker.
2. The red indicator will turn on when charging, it will die out after full charged.
3. Charging time: 3.5 hours. Play time: 12 hours

### Setting up Alexa Command Functionality:

1. Search and download the Amazon Alexa APP from APP Store or Google Play on your device.
2. Connect the Speaker to your device via Bluetooth. Login your Amazon account in the APP.
- 3.1) Open the Amazon Alexa APP and select DEVICES > + > Add Device > Headphones  
3.2) Wait till the device code has shown and select: HAKII MARS BLE (via IOS mobile phone) or HAKII MARS (via Android mobile phone). If you can't find device code for long time, please exit Amazon Alexa APP and reopen it.  
3.3) Finish your setting.  
3.4) Try to activate the Alexa with double press the button on Speaker and talk with Alexa!

### • Alexa Support & Additional Tips:

For the latest topic in Alexa-related support, visit:

<https://www.amazon.com/gp/help/customer/display.html?nodeId=201602060>

To visit the Alexa website: <http://alexa.amazon.com>

To download the Amazon Alexa App:

1. Amazon Appstore: <https://www.amazon.com/dp/B00P03D4D2>
2. Google Play: <https://play.google.com/store/apps/details?id=com.amazon.dee.app>
3. Apple App Store: <https://itunes.apple.com/us/app/amazon-echo/id944011620>

### • Reference command

Command Type	Function	Phrase
Daily Life	To ask the local weather (and set your location in your Alexa account)	"Alexa, how is the weather?" "Alexa, how is the weather in ___(location)?"
	To ask for traffic conditions (and to set up your starting and ending points in your Alexa account)	"Alexa, how is traffic?"
	To ask for another location's current time	"Alexa, what time is it in ___(location)?"
Amazon Music (Payment Required)	To view the current message (after opening the notification that you have received it)	"Alexa, what are my notifications?" "Alexa, what did I miss?"
	Play by Song and Artist Name	"Alexa, play, _____"
	Add songs to Favorites	"Alexa, I like this song." "Alexa, Thumbs up."
	Skip ahead or backwards to the next or previous song	"Alexa, play the next song." "Alexa, play the previous song."
Radio (iHeartRadio, Tunein)	Play by Singer's Name	"Alexa, play, _____"
	To play an iHeartRadio show (such as channel star 101.3)	"Alexa, play star 101.3 from iHeartRadio."
News	To play a Tunein radio show	"Alexa, play Tunein"
	To play/Read a Newsletter	"Alexa, news update."
Audio Books (Payment Required)	To play Sports News (Using a Set Team of Followers in Account)	"Alexa, sports update."
	To play an audio book	"Alexa, play an audio book."
	To skip ahead or behind to the next or previous chapter	"Alexa, next chapter." "Alexa, previous chapter."
Universal Playback Controls	To skip to Section [X]	"Alexa, go to chapter [X]."
	To fast-forward and rewind (approx. 30 seconds)	"Alexa, skip forward/back."
	To Pause	"Alexa, pause."
	To Resume Play	"Alexa, resume."
	To Play Next/Previous Song	"Alexa, play."
	To Stop Playing	"Alexa, play the next song." "Alexa, play the previous song."
	To Adjust to a Volume (Ex.: Adjust to 50)	"Alexa, stop."
Communication	To Increase or Decrease the Volume	"Alexa, set the volume to 50." "Alexa, volume up (or) volume down."
	To Ask What Song is Playing	"Alexa, what is playing?"
	To call somebody	"Alexa, call _____"
	To send message to somebody	"Alexa, send message to _____"

### Update your Speaker software

1. Connect the Speaker to your device via Bluetooth.
2. Make sure you had download the Amazon Alexa APP.
3. Search and download the "BT AMA OTA" APP from APP Store or Google Play on your device.
4. Open the "BT AMA OTA" APP and Click > HAKII MARS BLE (via IOS mobile phone) or HAKII MARS (via Android mobile phone) > Skip, enter the upgrade page.
5. If your device is the newest version, it won't be prompt to upgrade file. If your device is not the newest version, it will be prompt to upgrade file. Select "Online file", the upgrade button will turn to light blue, and download the Network File. After this, it will show aq file had download.
6. Then, it will show "Upgrade Success, Please reboot device" after upgrade success. If it shows "Fall, Upgrade Fail" that means you should to try download the upgrade file and try again.
7. Next time when your device need to upgrade again, just need click on the downloaded file name to automatically upgrade.

### Specifications

Wireless Version: 5.0  
Waterproof: IPX7  
Battery Capacity: 3.7 V / 1000 mAh  
Input voltage: DC 5V / 1A  
Dimension: 154 \* 98 \* 43.5 mm  
Weight: 182 g

### Warning:

1. Please follow the instructions in this manual.
2. Please use and store this product in the ambient temperature environment.
3. Do not use this product near the heat source, such as a radiator, a hot air conditioner, a stove, or other instruments that produce heat.
4. No matter the product is damaged for any reason, it must be dealt with in time with the after-sale personnel of us. Any unauthorized demolition and modification will make the warranty invalid.

### Important Safety Instructions

- Do NOT make unauthorized alterations to this product.
- Use this product only with an agency approved power supply which meets local regulatory requirements (e.g., FCC, CE, RoHS, Telec, CCC, KC)
- Do not expose products containing batteries to excessive heat (e.g. from storage in direct sunlight, fire or the like).
- IPX7 is not a permanent condition, and resistance might decrease as a result of normal wear.

### NOTE:

This equipment has been tested and found to comply with the limits for a Class B digital device, pursuant to Part 15 of the FCC Rules. These limits are designed to provide reasonable protection against harmful interference in a residential installation. This equipment generates, uses and can radiate radio frequency energy and, if not installed and used in accordance with the instructions, may cause harmful interference to radio communications. However, there is no guarantee that interference will not occur in a particular installation. If this equipment does cause harmful interference to radio or television reception, which can be determined by turning the equipment off and on, the user is encouraged to try to correct the interference by one or more of the following measures:

- Reorient or relocate the receiving antenna.
- Increase the separation between the equipment and receiver.
- Connect the equipment into an outlet on a circuit different from that to which the receiver is connected.
- Consult the dealer or an experienced radio/TV technician for help. Changes or modifications not expressly approved by HAKII could void the user's authority to operate this equipment.

This device complies with part 15 of the FCC Rules and with Industry Canada license-exempt RSS standard(s). Operation is subject to the following two conditions: (1) This device may not cause harmful interference, and (2) this device must accept any interference received, including interference that may cause undesired operation.

This device complies with FCC and Industry Canada radiation exposure limits set forth for general population. It must not be co-located or be operating in conjunction with any other antennas or transmitters.

### RF warning statement:

The device has been evaluated to meet general RF exposure requirement. The device can be used in portable exposure condition without restriction.

HAKII hereby declares that this product is in compliance with the essential requirements and other relevant provisions of Directive 2014/53/EU and all other applicable EU directive requirements.

### For Europe:

#### Frequency band of operation 2400 to 2483.5 MHz:

- Bluetooth: Maximum transmit power less than 20 dBm EIRP.
- Bluetooth Low Energy: Maximum power spectral density less than 10 dBm/MHz EIRP.
- DON'T attempt to remove the rechargeable lithium-ion battery from this product. Contact your local HAKII retailer or other qualified professional for removal.

Please dispose of used batteries properly, following local regulations. Do not incinerate.

This symbol means the product must not be discarded as household waste, and should be delivered to an appropriate collection facility for recycling. Proper disposal and recycling helps protect natural resources, human health and the environment. For more information on disposal and recycling of this product, contact your local municipality, disposal service, or the shop where you bought this product.

### WARRANTY TERMS AND CONDITIONS

HAKII offers ONE (1) year warranty on all HAKII® products from the date of original purchase. The products should be purchased either from HAKII owned retail store or HAKII authorized dealers.  
Proof of purchase is needed to prove the product is purchased from HAKII authorized sales channels. HAKII offer free repair or replacement service during the warranty period.

#### THE FOLLOWING ARE NOT COVERED BY THE WARRANTY:

1. Defects that cause by not following the products user manual, or using the parts that are not made or authorized by HAKII, or using the pirated software.
2. Defects that caused by disassembling the products by any unauthorized maintenance center or person.
3. Defects that caused by accident or any force majeure event, such as fire, water, external extrusion force or drop, lightning, earthquake, typhoon, etc.
4. Deterioration of the components or the parts used on products, the nature of which is to become worn or depleted with use, such as headphone ear pads, silicon ear tips, batteries, etc.
5. Fake commodities are not covered by the warranty.
6. For unspecified terms, refer to the local laws and regulations where the sales stores and dealers located.

To claim repairs under warranty, please contact the dealers or retailers where the relevant product is purchased. To validate your warranty, you will need to provide the original sales invoice or other proof of ownership and date of purchase.

Please scan the QR code below or login to the official website [www.hakii.com](http://www.hakii.com) to quickly perform after-sales service:

