



1. Physically Connection

Condition 1:

You have a modem / CPE provided by ISP, following the below connection step

Condition 2:

Your Internet connection is directly through an Ethernet cable, connect the Ethernet cable directly to the AirMesh router's **WAN** port, and power up the device.



Quick Setup Guide

Whole Home Wi-Fi System

Version:1.0

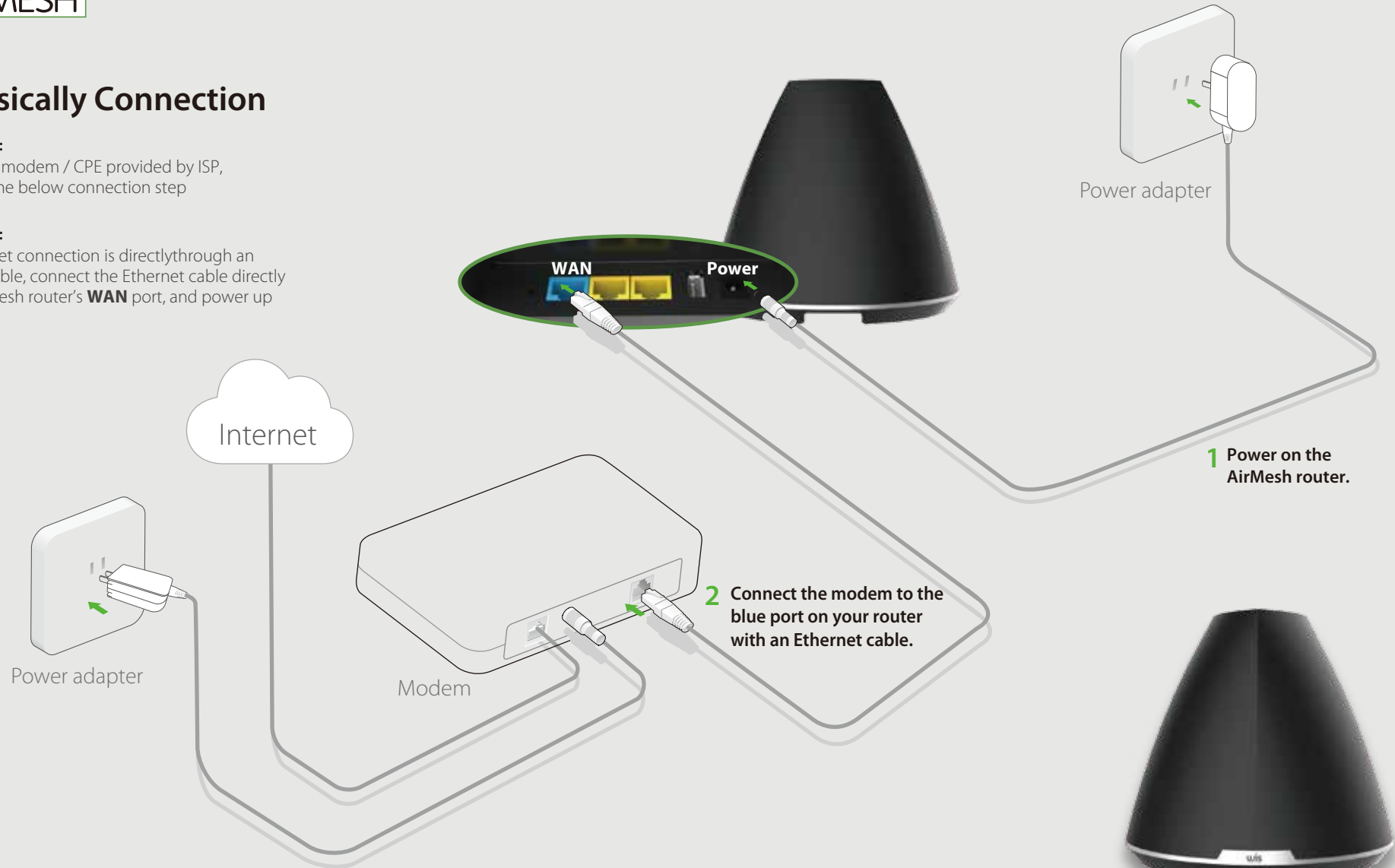

2.Install AirMesh Satellite

Step1 Power on the AirMesh Satellite

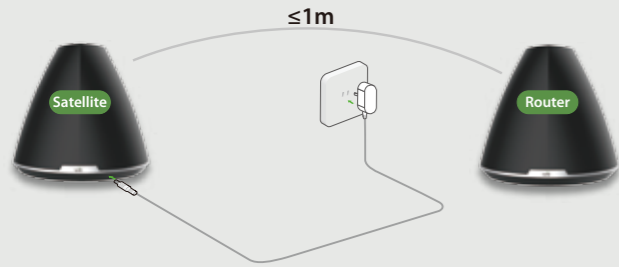

Power on AirMesh Router and AirMesh Satellite, the distance between AirMesh Router and AirMesh Satellite is less than **1 meters**.

Step2 Auto pairing



In the pairing process, AirMesh Satellite's LED lights have several colors

Orange:

Can't connect to the AirMesh Router, Please let the AirMesh Satellite close to the AirMesh Router

Green:

In connection process

Blue:

Connected

Note: The AirMesh Router's LED light always blue

Step3 Place AirMesh Satellite

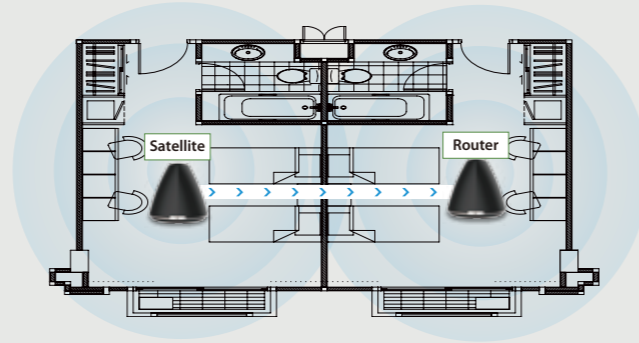

Move the AirMesh Satellite to the place near the poor signal area, while checking the signal LEDs on the satellite in order to get the best signal quality.

When installation is complete, AirMesh Satellite's LED lights have several states

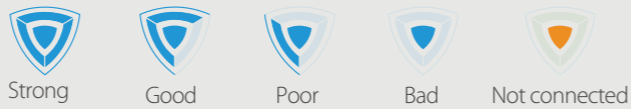

3.Interface

AIR MESH Router

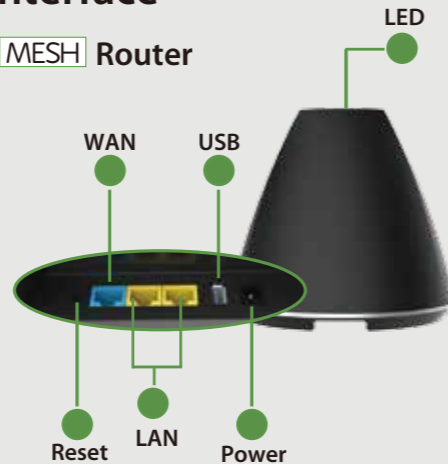

AIR MESH Satellite

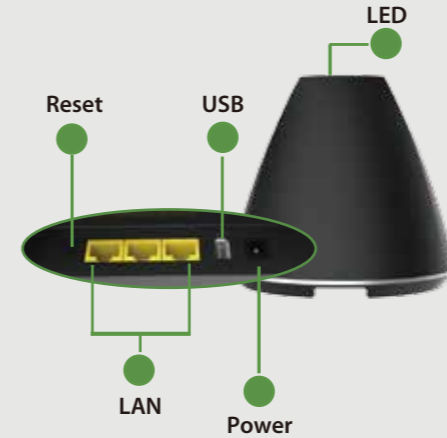

4.Configure AirMesh Router



Configure by WEB Page

- 1.Computer connect to the AirMesh's lan port through cable line or connect to wifi whose ssid is **Wisvivo** by wireless.
- 2.Input <http://wis.net> at web browser.
- 3.When login page appears enter "admin" in the password field.



Configure by APP

- 1.Download APP by scanning the QR Code of the first page.
- 2.Phone connect to wifi whose ssid is **Wisvivo** by wireless.
- 3.Open the APP, scan the AirMesh Router, finish the configuration wizard.

5.Pack List



AirMesh Router x1



AirMesh Satellite x1



Power Cable x2



Ethernet Cable x1



Community: community.wisnetworks.com
 Sales e-mail: info@wisnetworks.com Web: www.wisnetworks.com
 Address: No.77, FuTe West 3 Road, China (Shanghai) Pilot Free Trade Zone

FCC STATEMENT

1. This device complies with Part 15 of the FCC Rules. Operation is subject to the following two conditions:

(1) This device may not cause harmful interference.

(2) This device must accept any interference received, including interference that may cause undesired operation.

2. Changes or modifications not expressly approved by the party responsible for compliance could void the user's authority to operate the equipment.

NOTE: This equipment has been tested and found to comply with the limits for a Class B digital device, pursuant to Part 15 of the FCC Rules. These limits are designed to provide reasonable protection against harmful interference in a residential installation.

This equipment generates uses and can radiate radio frequency energy and, if not installed and used in accordance with the instructions, may cause harmful interference to radio communications. However, there is no guarantee that interference will not occur in a particular installation. If this equipment does cause harmful interference to radio or television reception, which can be determined by turning the equipment off and on, the user is encouraged to try to correct the interference by one or more of the following measures:

- Reorient or relocate the receiving antenna.

- Increase the separation between the equipment and receiver.

- Connect the equipment into an outlet on a circuit different from that to which the receiver is connected.

- Consult the dealer or an experienced radio/TV technician for help.

FCC Radiation Exposure Statement

This equipment complies with FCC radiation exposure limits set forth for an uncontrolled environment. This equipment should be installed and operated with minimum distance 20cm between the radiator & your body