

epik Learning Tab™ Jr.

## Quick Start Guide

This Quick Start Guide will help you get started with your new  
Epik Learning Tab™ Jr. For additional assistance, visit:  
[support@epiklearning.com](mailto:support@epiklearning.com) Tel. 888-999-1244



# 1

## Before Starting

Make sure a Wi-Fi connection is available. We recommend using a Google Account (or Gmail) with your tablet if you do not have one. This guide will help you sign up for a free Google Account.

## Charging

1. Before first use, we recommend charging the tablet for 6 hours.
2. Plug in the included AC adapter.
3. Connect the USB cable from the AC adapter to the tablet.

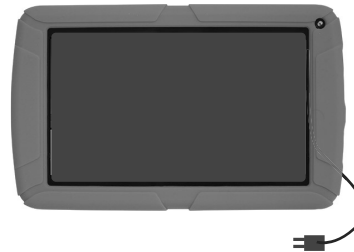

## 2 Turn Power On

1. Press and hold the **POWER** button for 3 seconds until the lighted screen appears.



### 3 Language Selection

1. Scroll through the languages and highlight your preference.
2. Tap **Next**.

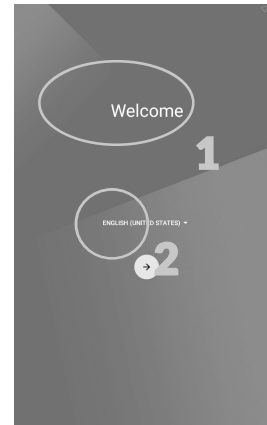

## 4 Connect to Wi-Fi

1. Tap your Wi-Fi Network name.
2. If your Network has a password you will be prompted to enter it.
3. Tap **Connect**.

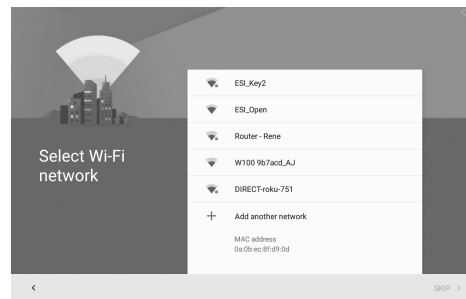

## 5 Got Google?

1. In case you use another Android device you have the option to copy the data from it.
2. If not tap on the "No Thanks" option and tap on "Next"

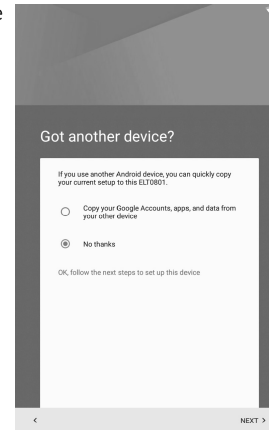

## 6 Add your account

1. If you already have a Google Account, enter your email and tap NEXT, and enter your password, then skip to step #9.
2. If not, tap **"Or create a new account"** and you can set one up.

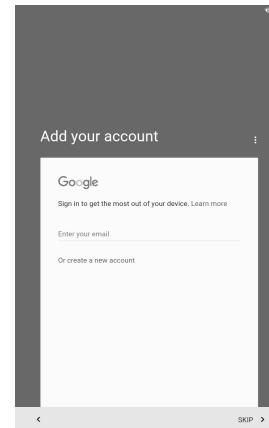

## 7 Create a Google account

1. Enter your first and last name in the appropriate boxes.
2. Tap the "Next" button to continue

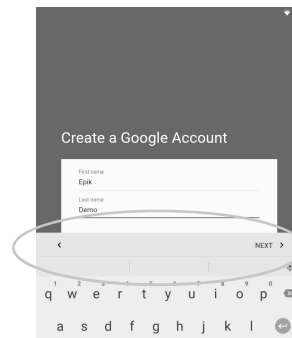



## 8 Basic Information

1. Enter your birthday and gender and tap "Next"

Basic information

Enter your birthday and gender

Month Day Year

Gender

< NEXT >

## 9 How you'll sign in

1. Enter your desired username (new email) you would like
2. Tap "Next" to continue

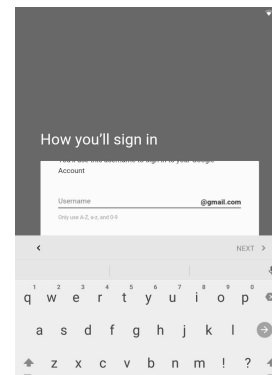

## 10 Create password

1. Enter a password in the first box and repeat it in the second box.
2. Tap "Next" to continue

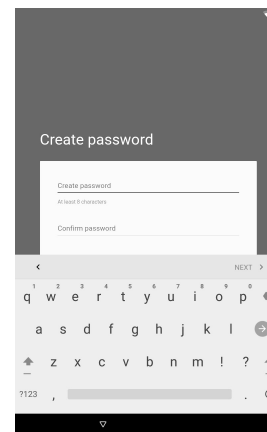

## 11 Add phone number

1. Follow the instructions on screen if you would like add a phone
2. If not, you can do this later by logging in to google.com.
3. Tap "**Skip**"

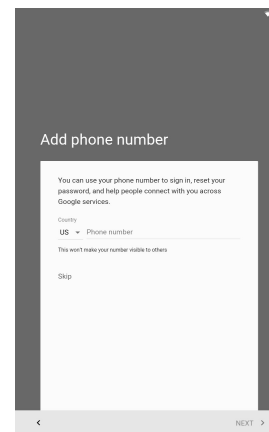

## 12 Privacy and Terms

1. Review the Privacy and Terms
2. Scroll down to the bottom
3. Tap on "I Agree"

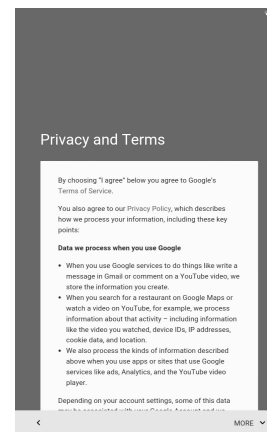

## 13 Your Google account

1. Review your Google account and tap "Next"

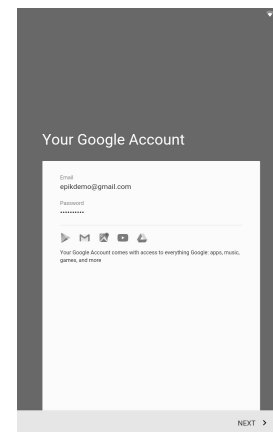

# 14 Google services

1. Review your Google account and tap "Next"

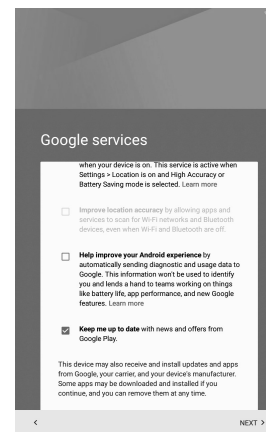

## 15 Set up payment info

1. You may choose to add a credit card to your account for digital purchases. This can be done later at [wallet.google.com](https://wallet.google.com).
2. To add it later tap on "No Thanks" and tap on "Continue"

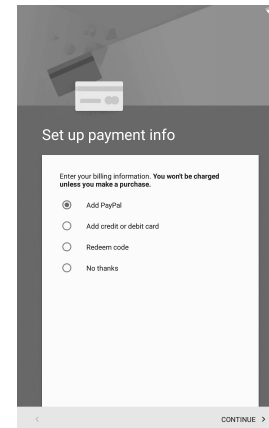



# 16 Date & Time

1 Enter your correct Date & Time and tap on "Next"

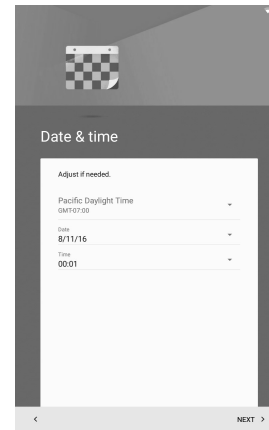

## 17 Add another Email

- 1 If desired you can add another email this can be done later in "Settings" "Accounts"
- 2 Tap "Not Now" then tap on "Next"

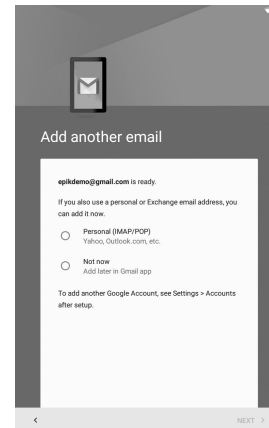

## 18 Protect your Tablet

- 1 If desired you can protect your device by adding a required PIN, pattern or password to unlock screen. This can be done at a later time in **"Setting"** **"Security"**

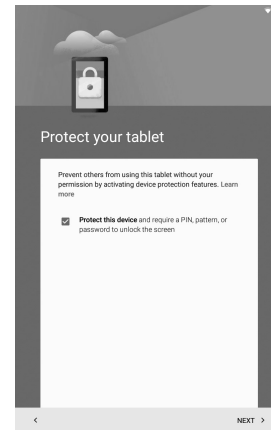

## 19 Epik Learning Tab™ Jr. Setup - Step 1

You will now set up your Epik Learning Tab JR™ parent account. Fill in all fields including name, email, postal code...

epik Learning Tab™ Jr.

**TABLET REGISTRATION**

**STEP 1: REGISTER YOUR CLICKN KIDS TABLET:**

PARENT'S FIRST NAME	PARENT'S LAST NAME
PARENT'S EMAIL ADDRESS	ZIP CODE
PARENT'S BIRTHDAY MM-DD-YYYY	CHILD'S BIRTHDAY MM-DD-YYYY

**STEP 2: SET-UP KIDS PLACE-PARENTAL CONTROLS:**

[TAP HERE TO CONTINUE SET-UP...](#)

[PRIVACY POLICY](#)

## 20 Epik Learning Tab™ Jr. Setup - Step 2

Fill in all fields including parent PIN code. Tap **Continue** to reveal the **Next** button.

epik Learning Tab™ Jr.

**STEP 2: KIDS PLACE PARENTAL CONTROLS SET-UP**

**ENTER YOUR PARENTAL CONTROL PIN AND PIN RECOVERY OPTIONS**

PLEASE ENTER A 4 DIGIT PIN      PLEASE REPEAT THE PIN

PLEASE ENTER PARENT'S EMAIL ADDRESS      PLEASE ENTER A HINT FOR YOUR PIN

CONTINUE

## 21 Epik Learning Tab™ Jr. Setup - Step 3

Fill in security questions. Tap **Continue** on to reveal the **Next** button.

epik Learning Tab™ Jr.

**STEP 3: KIDS PLACE PARENTAL CONTROLS SET-UP**

**SET-UP SECURITY QUESTIONS TO RESET FORGOTTEN PIN**

**QUESTION 1:** What was your first car make?

ANSWER HERE

**QUESTION 2:** What was the name of your elementary / primary school?

ANSWER HERE

**CONTINUE**

## 22 Kid's Place Setup

Read and Accept the Kid's Place Terms and Conditions.  
Read the Kid's Place Quick Tips.

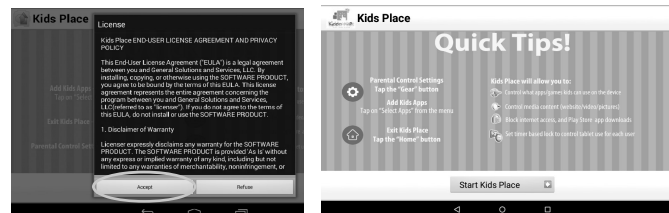

#### FCC Statement

This equipment has been tested and found to comply with the limits for a Class B digital device, pursuant to part 15 of the FCC Rules. These limits are designed to provide reasonable protection against harmful interference in a residential installation. This equipment generates, uses and can radiate radio frequency energy and, if not installed and used in accordance with the instructions, may cause harmful interference to radio communications. However, there is no guarantee that interference will not occur in a particular installation. If this equipment does cause harmful interference to radio or television reception, which can be determined by turning the equipment off and on, the user is encouraged to try to correct the interference by one or more of the following measures:

- Reorient or relocate the receiving antenna.
- Increase the separation between the equipment and receiver.
- Connect the equipment into an outlet on a circuit different from that to which the receiver is connected.
- Consult the dealer or an experienced radio/TV technician for help.

Caution: Any changes or modifications to this device not explicitly approved by manufacturer could void your authority to operate this equipment.

This device complies with part 15 of the FCC Rules. Operation is subject to the following two conditions: (1) This device may not cause harmful interference, and (2) this device must accept any interference received, including interference that may cause undesired operation.

#### RF Exposure Information

The device has been evaluated to meet general RF exposure requirement. The device can be used in portable exposure condition without restriction.





**Have fun!**

We hope you enjoy playing and learning on your new

epik Learning Tab™ Jr.

