

1. Overview

KEY TOOL MAX PRO is a professional smart device with multi-function, Bluetooth and WIFI communication interface are interlarded inside, which is convenient for connecting and controlling Xhorse Key Cutting machine.

Supports various OBD functions such as Vehicle diagnosis, Immo programming, Throttle program, TPMS, and Maintenance light reset.



2. Main Functions

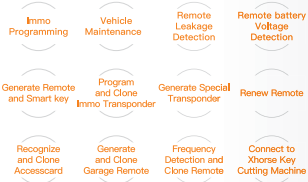

6.4 Indicator status

① When the device is turned on or charging, the POW indicator light is on.

② When the device is working, the CON indicator is on.

6.5 Device reset

① Press the ON/OFF button for 12 seconds, the device will restart automatically.

② Press the ON/OFF button about 1-2 seconds, the screen displays shutdown and restart options, select the corresponding option to shut down or restart the device.

7. Maintenance

- Do not hit it violently, shake or throw it.
- Do not wash main body and other parts with water or other liquid directly, and do not clean KEY TOOL MAX PRO with wet cloth.
- Do not place KEY TOOL MAX on high temperature, high humidity or dusty places.
- Do not take KEY TOOL MAX PRO apart or retrofit it in private otherwise mainboard will be damaged or battery will on fire and etc.
- Please keep screen, camera and other key parts well and prevent sharp objects to do damage to them.
- The leakage detection and voltage detection functions are limited to the leakage detection and voltage detection of the remote, please do not use it for the detection of other products. All functions should be used strictly in accordance with the scope of use of the device, as exceeding the scope will damage the device.

3. Performance

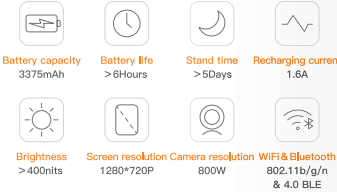

4. Packing List

Item	Quantity
KEY TOOL MAX PRO device	1
OBD to DB15 cable with light	1
Remote programming cable	1
Leakage detection cable	1
USB cable	1
User Manual	1

- ※ Situations on the below can not get free maintenance
- Damage caused by not following the use instructions.
 - Damage caused by repairing or retrofitting in private.
 - Damage caused by fall, crash or inappropriate voltage.
 - Damage caused by inevitable force.
 - Damage caused by using in harsh environment or on the vehicle and ship for a long time
 - Get main body dirty and worn due to use.

Please get in contact with dealer or scan the QR code behind the instruction, download Xhorse official APP to get after-sale and technical support.

Xhorse reserves all rights to this manual. Without permission, it is forbidden for any individual or organization to use any form of reproduction and dissemination of any part of this manual. Due to product improvements, the contents of this manual may be changed without notice.

Note: When the 125k works, it's a mobile device.

5. Appearance

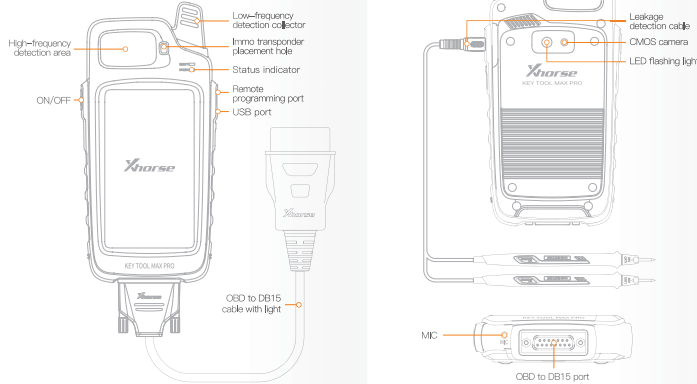

FCC statements:

This device complies with part 15 of the FCC rules. Operation is subject to the following two conditions: (1) this device may not cause harmful interference, and (2) this device must accept any interference received, including interference that may cause undesired operation.

NOTE: The manufacturer is not responsible for any radio or TV interference caused by unauthorized modifications or changes to this equipment. Such modifications or changes could void the user's authority to operate the equipment.

NOTE: This equipment has been tested and found to comply with the limits for a Class B digital device, pursuant to part 15 of the FCC Rules. These limits are designed to provide reasonable protection against harmful interference in a residential installation. This equipment generates uses and can radiate radio frequency energy and, if not installed and used in accordance with the instructions, may cause harmful interference to radio communications. However, there is no guarantee that interference will not occur in a particular installation. If this equipment does cause harmful interference to radio or television reception, which can be determined by turning the equipment off and on, the user is encouraged to try to correct the interference by one or more of the following measures:

- Reorient or relocate the receiving antenna.
- Increase the separation between the equipment and receiver.
- Connect the equipment into an outlet on a circuit different from that to which the receiver is connected.
- Consult the dealer or an experienced radio/TV technician for help.

The SAR limit of USA (FCC) is 1.6 W/kg averaged over one gram of tissue. Device type XDKMPO (FCC ID: 2047-XDKMPO) has also been tested against this SAR limit. This device was tested for typical body-worn operations with the back of the handset kept 10CM from the body.

To maintain compliance with FCC RF exposure requirements, use accessories that maintain a 10CM separation distance between the user's body and the back of the handset. The use of belt clips, holsters and similar accessories should not contain metallic components in its assembly. The use of accessories that do not satisfy these requirements may not comply with FCC RF exposure requirements, and should be Avoided.

CE/UKCA statements:

Declaration of Conformity: Hereby, Shenzhen Xhorse Electronics Co., Ltd. declares that the radio equipment type XDKMPO is in compliance with directive 2014/53/EU and RER 2017 (SI 2017/1206).



Specific Absorption Rate (SAR)

- Your device is tested to comply with applicable requirements and regulations of the European Union/UK of human exposure to radio wave.
- Specific Absorption Rate (SAR) is used to measure radio waves absorbed by a body. The device complies with RF specifications when the device used at a distance of 0 mm from your body. The SAR limit is 2.0 W/kg averaged over 10 gram of tissue in the European Union/UK.
- This product was tested and recorded the maximum SAR value was 0.301W/kg for the body.

	Bands	Operation Frequency	Max Power
Wi-Fi	2.4G/5G	2412-2467MHz	ERP 13.91 dBm
Bluetooth	2.4G/5G	2402-2480MHz	ERP 7.36 dBm
NFC	13.56MHz	13.56MHz	N/A
434MHz	434MHz	434MHz	N/A
125KHz	125KHz	125KHz	N/A

Do not use the device in the environment at too high or too low temperature, never expose the device under strong sunshine or too wet environment. The suitable temperature for the product is -20~60°C.

When charging, please place the device in an environment that has a normal room temperature and good ventilation. It is recommended to charge the device in an environment with a temperature that ranges from 5°C-25°C.

CAUTION: RISK OF EXPLOSION IF BATTERY IS REPLACED BY AN INCORRECT TYPE. DISPOSE OF USED BATTERIES ACCORDING TO THE INSTRUCTIONS.

6. Setting



6.1 First Time to use

For the first time to turn on the KEY TOOL MAX PRO, you need to select language, region (System default setting is China Standard Time Zone), connect to WiFi and login with a registered account. If you don't have an account, please register as the picture on the left.



6.2 Power Off

① Before entering the system, press and hold the ON/OFF button for a while, 'power off' and 'reboot' will be shown on the screen, click on 'power off', device will shut down.

IC statements:

This device complies with Industry Canada (IC) radio-communication standards. Operation is subject to the following two conditions:

- This device must not cause interference, and
- This device must accept any interference, including interference that may cause undesired operation of the device.

Cet appareil est conforme avec Industrie Canada RSS exemptes de licence (standards).

Son fonctionnement est soumis aux deux conditions suivantes:

- cet appareil ne peut pas provoquer d'interférences, et
- cet appareil doit accepter toute interférence, y compris celles pouvant causer un mauvais fonctionnement de l'appareil.

This Class B digital apparatus complies with Canadian ICES-003.

Cet appareil numérique de la classe B est conforme à la norme NMB-003 du Canada.

This device has been tested for compliance with IC SAR values at a typical operating near the body. To ensure that RF exposure levels below the IC-sar tested, use accessories with this equipment to maintain a minimum separation distance of 10cm between the body of the user and the device. These accessories should not contain metallic components. It is possible that the accessories used close to the body that do not meet these requirements are not consistent with the SAR limits and it is advisable to avoid using them.

Ce dispositif a été testé pour la conformité avec les valeurs SAR à un fonctionnement typique près du corps. Pour assurer que les niveaux d'exposition aux radiofréquences en deçà des niveaux testés, utilisez des accessoires avec cet équipement pour maintenir une distance de séparation minimale de 10cm entre le corps de l'utilisateur et l'appareil. Ces accessoires ne doivent pas contenir des composants métalliques. Il est possible que les accessoires utilisés près du corps qui ne répondent pas à ces exigences ne sont pas compatibles avec les limites SAR et il est conseillé d'éviter de les utiliser.



② After entering the system, press and hold the ON/OFF button for a while, the interface displays the following icons, click to shut down Option, the device will shut down.



6.3 Connect to Key Cutting Machine

KEY TOOL MAX PRO can connect the Key Cutting Machine by using Bluetooth to operate; click on the interface [Select], the interface displays the current connectable device, select the device to be connected according to the serial number.