



Operation Guide



BW20

Neckband Hearing Amplifier

Xiamen NewSound Technology Co.,Ltd
Address: 1st and 2nd Floor, No.13
of Xiangyue Road, Torch Hi-Tech Industrial
Development Zone, Xiang'An District, Xiamen, China.

THANKS

Congratulations! Welcome to a New Life created by NewSound Neckband Hearing Amplifier. Please read this manual carefully before use.

Intended use

This instrument is an electronic device which amplifies sounds from the surrounding environment. This new generation neckband TV hearing amplifier enables hearing impaired people enjoy a colorful life. BW20 applies 2.4GHz Wireless data transmission technology, which can work with TV through transmitter. Remote Microphone in Audio transmitter Box will free you from complicated line connection, no longer need to connect audio line with TV. Even other scenes, such as churches or lectures, it will be your great partner.

Configuration



BW20 Neckband Hearing Amplifiers, TV hearphones

- | | |
|-------------------------|---------------------------|
| ① Multi-function Button | ⑥ Indication Light |
| ② Volume Up | ⑦ TV002 Remote Microphone |
| ③ Volume Down | ⑧ USB Cable |
| ④ USB Charging Port | ⑨ Adapter |
| ⑤ Receiver (head phone) | ⑩ Earphone Domes |

Configuration



TV002 Remote Microphone

- | | |
|------------------------|-------------------|
| ① Power Button | ⑤ Microphone |
| ② Pairing Button | ⑥ Wallpost |
| ③ Indication Light | ⑦ 3.5 Audio Cable |
| ④ 3.5 Audio Cable Port | |

Indication light guide



BW20 Neckband Hearing Amplifiers (TV earphones)

① Long press power button for three to five seconds	Glows red light
② Power on (not pairing with TV002)	Shines Red and Blue alternatively
③ Power on (paired with TV002)	Shines blue
④ Power off	Glows red and then disappear
⑤ Charging	Solid blue
⑥ Full charge	Solid green



TV002 Remote Microphone

① Pairing	Shines blue and green alternatively
② Pairing done	Shines blue slowly
③ Power off	Shines green and then disappears
④ Power off	Shines blue and then disappears
⑤ Charging	Solid blue
⑥ Full charge	Solid green

How to Use

When paired with TV002, BW20 can make it easier to watch TV, listen to radio and also other sound source from limited distance.

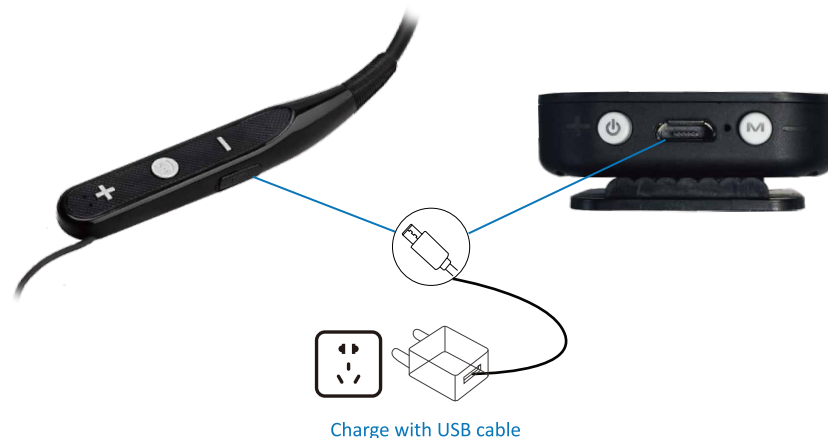

1: Charge with USB cable

BW20: As shown above, please open the cover of USB port and insert the USB cable correctly for charging.

TV002 remote microphone: Correctly connect the USB cable into the USB charging port between Power Button and Pairing Button.



NOTICE: 1) Do NOT use BW20 when charging.
2) The device is fully charged after production. It's recommended to charge the device first before use due to some power consumption during transportation and storage.

2. How to Use

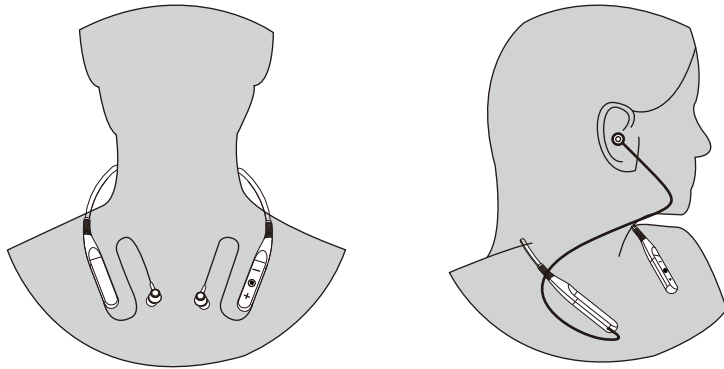

- 1) As shown above, slightly lift both ends, wear around the neck with volume button upwards and on the left.
- 2) Insert the earphones into both ears. Please note it is the hearing amplifier mode when turned on. The volume is already set at appropriate level after production. It's recommended to first adjust volume to your comfortable level.

3. ON and OFF

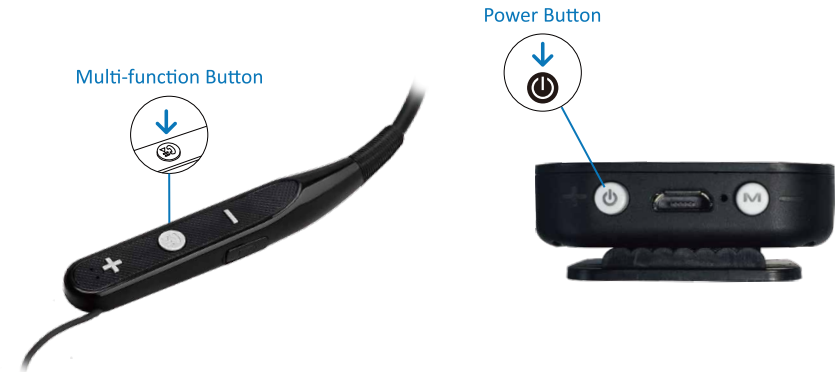

BW20:

To turn on: Long press “Multi-function button” for 3-5 seconds to turn on the device.

There are two possible color indications.

BW20 is not paired with TV002: Shining red and blue alternatively.

BW20 is paired with TV002: Shining blue.

To turn off: Long press “Multi-function button” for 3-5 seconds, indication light will glow red and then disappear.

TV002 remote microphone:

To turn on: Long press “Power button” for 3-5 seconds, indication light will glow green first and then turn blue.

To turn off: Long press “Power button” for 3-5 seconds, indication light will glow blue and then disappears.

4. Adjust volume

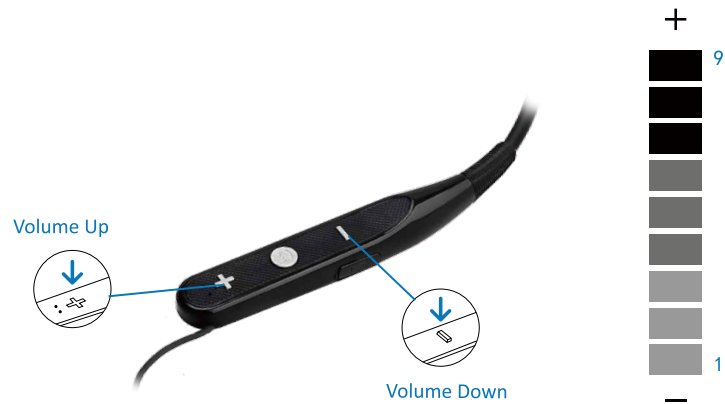

As shown above, short press “volume+” to increase volume, short press “volume- ” to decrease volume.

Attention: There are a total of nine levels of volume. When reach the minimum volume, you will hear beep sound. When reach the maximum volume, you will hear “Di” sound.

5. Program Switch

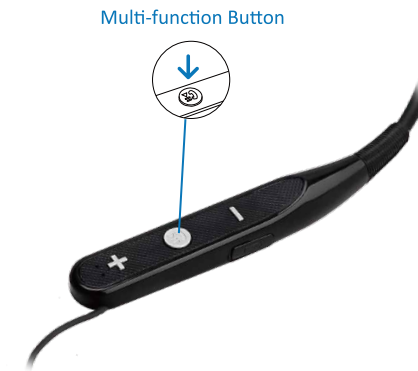

As shown above, short press “Multi-function button” to switch among four modes. BW20 provides four pre-setting program modes.

Program	Recommended environment	Indicator
Program 1	Normal (hearing amplifier mode)	One beep sound
Program 2	Restaurant (hearing amplifier mode)	Two beep sound
Program 3	Outdoor (hearing amplifier mode)	Three beep sound
Program 4	TV watching (remote microphone)	Four beep sound

Kindly note: Every time you turn on BW20, it will revert to last time setting of program and volume.

6. Pairing with TV002 remote microphone

Short press “Multi-function button” to switch among four modes. BW20 provides four pre-setting program modes.

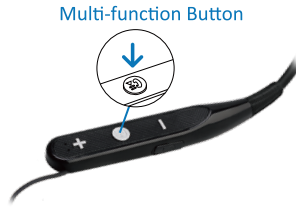

Step 1: Turn on BW20, short press “Multi-function” button to switch to program 4 “TV watching”



Step 2: Turn on TV002, long press “Pairing button” for three to five seconds, the indication light will shine blue and green alternatively.



Step 3: Place TV002 near to BW20 within 20cm and wait for 5 seconds. Short press TV002 “Pairing button”, then the indication light on TV002 and BW20 will both shine blue, and the earphone will beep sound to remind you the pairing is successfully done.



Note: If you need TV002 to pair with more than one BW20, please repeat step 1 2 3 on each device.

Step 4: Place TV002 near to TV speaker, there are two methods for choice.

1. (Recommendation) Wallpost is supplied in the package. You can stick the wallpost under TV002 and then stick TV002 near to the TV speaker.
2. Alternatively, please use 3.5 audio cable to connect TV002 with audio out of TV.

Attention: The effective connection distance is 10 meters. Please use the device within this specified distance to avoid malfunction

Step 5: Wear BW20 and start to enjoy your TV programs.

7. Control by App

1) Download the app

Note: The SoundWear App is available for most Apple and Android devices. Please check your Apple App Store or your Google Play Store for compatibility.

Search “**SOUNDWEAR**” in your Apple App Store or your Google Play Store, download and install the app.

2) Connect with your device

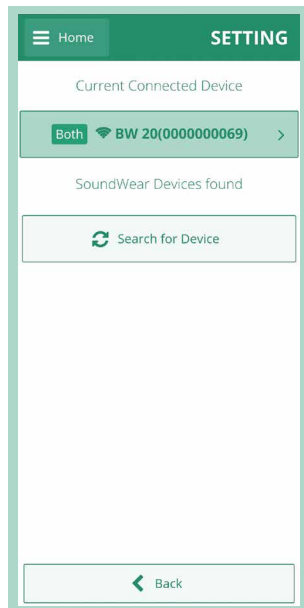

Now you can control your device by APP including change program, control the volume and adjust the band.

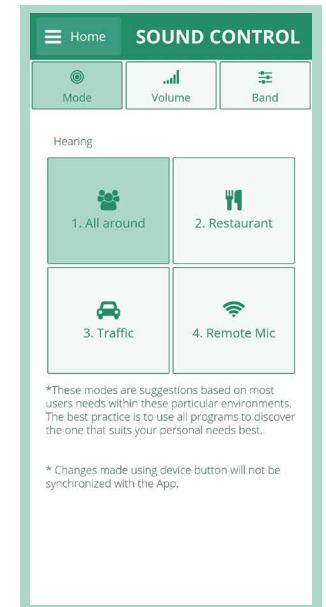
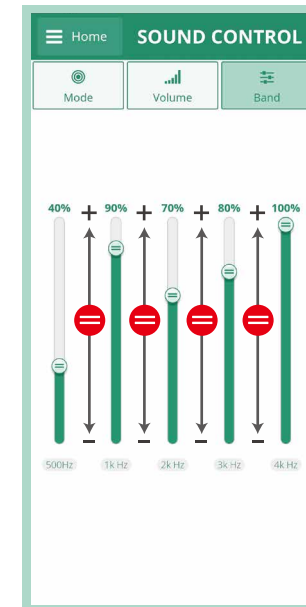
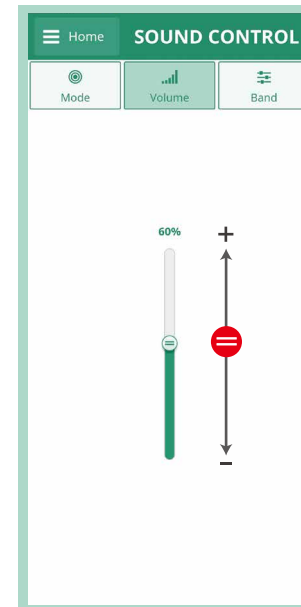

FCC Statement

Changes or modifications not expressly approved by the party responsible for compliance could void the user's authority to operate the equipment.

This equipment has been tested and found to comply with the limits for a Class B digital device, pursuant to Part 15 of the FCC Rules. These limits are designed to provide reasonable protection against harmful interference in a residential installation. This equipment generates uses and can radiate radio frequency energy and, if not installed and used in accordance with the instructions, may cause harmful interference to radio communications. However, there is no guarantee that interference will not occur in a particular installation. If this equipment does cause harmful interference to radio or television reception, which can be determined by turning the equipment off and on, the user is encouraged to try to correct the interference by one or more of the following measures:

- Reorient or relocate the receiving antenna.
- Increase the separation between the equipment and receiver.
- Connect the equipment into an outlet on a circuit different from that to which the receiver is connected.
- Consult the dealer or an experienced radio/TV technician for help

This device complies with part 15 of the FCC rules. Operation is subject to the following two conditions (1) this device may not cause harmful interference, and (2) this device must accept any interference received, including interference that may cause undesired operation.