

## QUICK START GUIDE

# #FINDYOURGO

**QUICK START GUIDE:** For optimum Gravity Neckband performance, charge overnight with Micro USB prior to using.

### 1 FIRST TIME SETUP



Press and hold Play button for **8 seconds**. Release.

### 2



Lights will flash **blue/red** to indicate Bluetooth Pairing mode.

### 3



Turn on the Bluetooth in your device.

Select JLab Gravity in your Bluetooth device list.

Light on JLab Gravity will slow blink blue indicating Bluetooth is connected.

### Cable Management System

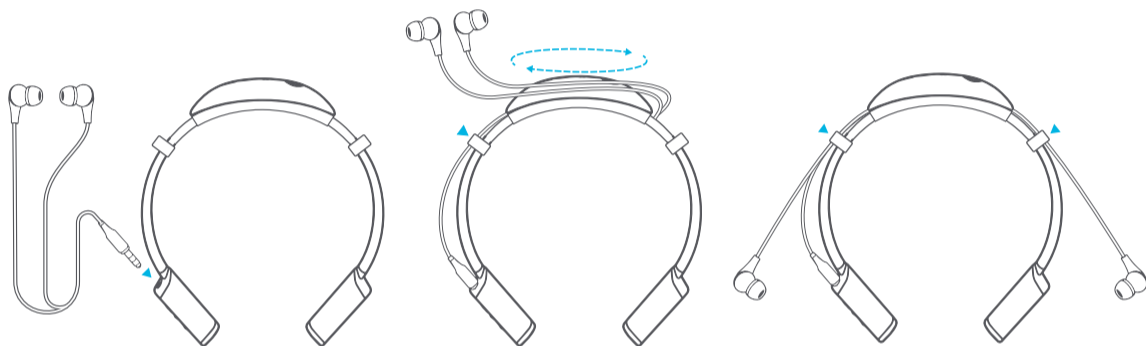

1 Insert earbuds in to earbud jack.

2 Wrap cord around Cable Management System.

3 Adjust cord to desired length.

### Charging

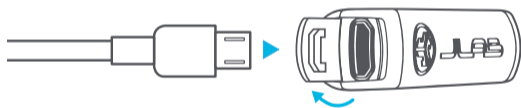

Open USB door and insert micro USB to neckband and connect USB to power source.

To ensure the water resistance of your Gravity Neckband, the cover for the Micro USB port must be firmly closed.

### Neckband Adaptor Ports/Buttons



For full User Manual + other JLab products visit [jlabaudio.com](http://jlabaudio.com)

### FCC Information

This equipment has been tested and found to comply with the limits for a Class B digital device, pursuant to Part 15 of the FCC Rules. These limits are designed to provide reasonable protection against harmful interference in a residential installation. This equipment generates, uses and can radiate radio frequency energy and, if not installed and used in accordance with the instructions, may cause harmful interference to radio communications. However, there is no guarantee that interference will not occur in a particular installation. If this equipment does cause harmful interference to radio or television reception, which can be determined by turning the equipment off and on, the user is encouraged to try to correct the interference by one or more of the following measures:

- Reorient or relocate the receiving antenna.
- Increase the separation between the equipment and receiver.
- Connect the equipment into an outlet on a circuit different from that to which the receiver is connected.
- Consult the dealer or an experienced radio/TV technician for help.

If you cannot eliminate the interference, the FCC requires that you stop using your product. Changes or modifications not expressly by the party responsible for compliance could void the user's authority to operate the equipment.

This device complies with Part 15 of the FCC Rules. Operation is subject to the following two conditions: (1) this device may not cause harmful interference, and (2) this device must accept any interference received, including interference that may cause undesired operation.

### Battery Caution & Disposal Information

- Improper operation of the battery (e.g., overcharging, crushing, puncture, excessive heat or moisture) may produce smoke. In such an event, ventilate the area.
- Extinguish any flames with carbon dioxide, dry-powder fire extinguisher, or cover with sand or mud.
- Do not disassemble, crush, puncture or incinerate.
- Do not expose to temperatures above 140° F.
- Do not dispose of the battery in the trash.
- Charge fully before storage or if stored for longer than three months.
- Do not dispose of batteries in a fire.
- Batteries should be disposed or recycled per state and local guidelines.

FCC ID: 2AHYVGOBT

# #FINDYOURGO

[JLABAUDIO.COM](http://JLABAUDIO.COM)



Date: 05.04.17

PROJECT: Gravity Neckband Quick Start Guide

STOCK: 220g, MATTE

INK: 4/4 CMYK / CMYK

SIZE: Custom Die line