

LATEST AND GREATEST

Our team is constantly improving your product experience. This model may have new features or controls which are not detailed in this guide.

For the latest version of the manual, scan the QR code below.



OFFICIAL AUDIO PARTNER OF MAJOR LEAGUE SOCCER

BETTER TOGETHER

JLab is a proud to provide Major League Soccer athletes and gamers with the best personal tech in the locker rooms, for travel and pre-game focus. We're introducing JLab's real innovation and surprisingly awesome value to the passionate, authentic fans of MLS.

FCC ID: 2AHYV-OSPRT

WITH LOVE FROM THE LAB

We have lots of different ways to show we care.

GET STARTED + FREE GIFT

Product updates | How-to tips | FAQs & more

Go to jlab.com/register to unlock your customer benefits including a free gift.

Gift for US only. No APO/FPO/DPO addresses.

3 MONTHS FREE

Get 3 free months of Tidal with your purchase.

Visit jlab.com/tdia. Happy listening!



THE COMPLETE EXPERIENCE



Download the JLab Store app for sound tools, exclusive product alerts, and the latest news.



WE GOT YOUR BACK

We're obsessed with creating the best possible experience around owning our products. If you have any questions, concerns, or feedback, we're here for you. Contact a real human on our U.S.-based customer support team:

Website: jlab.com/contact

Email: support@jlab.com

Phone U.S.: +1 (405) 445-7219 (Check hours jlab.com/hours)

Phone U.K./EU: +44 (20) 8142 9361 (Check hours jlab.com/hours)

Visit jlab.com/warranty to initiate a return or exchange.

CHARGING EARBUDS

Placing in the charging case will auto power OFF and start charging. **Blue lights** will indicate earbuds are charging and will turn OFF when fully charged.

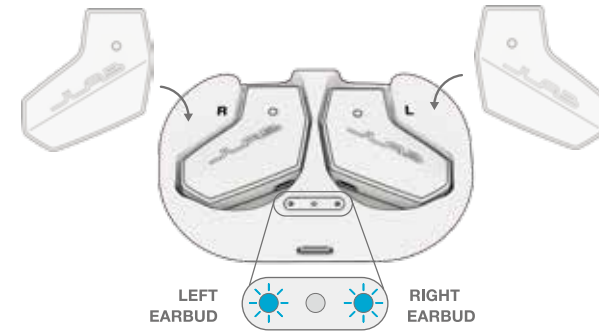

Removing the earbuds will auto power ON and connect to last device.

CHARGING CASE

Connect included USB-C cable to charge.

LEDs **pulse white** when charging and **turn solid white** when fully charged.

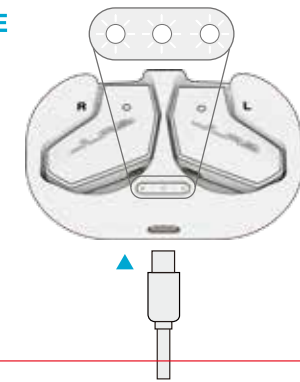

MULTIPOINT (connect 2 devices simultaneously)

1 Once **FIRST** device is connected, turn off Bluetooth in device settings. JLab Open Sport will auto enter Bluetooth Pairing.

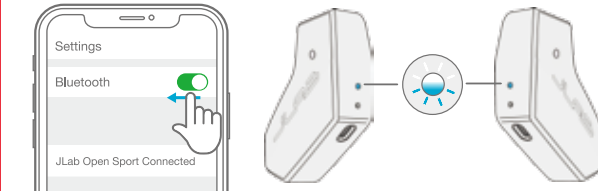

2 Enter your **SECOND** device Bluetooth settings and connect to JLab Open Sport.



3 Enter your **FIRST** device Bluetooth settings. Turn on Bluetooth and connect to JLab Open Sport.

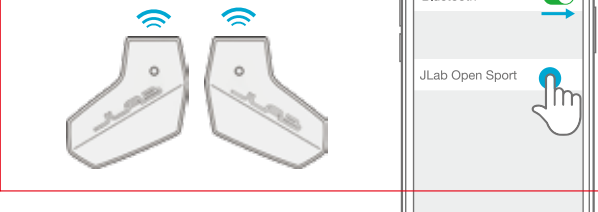

TROUBLESHOOTING

No audio in one earbud or earbuds disconnected (Manual Reset)

1 Keep earbuds in the charging case and forget "JLab Open Sport" in your Bluetooth device settings.

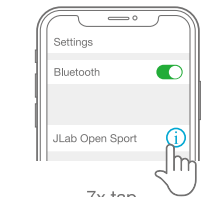

7x tap



2 Quick tap 7x on one earbud in charging case.

7x tap



3 Quick tap 7x on other earbud in charging case.

4 Take both earbuds out of the charging case. One earbud will blink blue/white indicating ready to pair to your device.

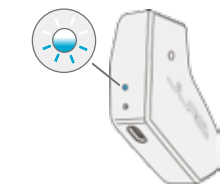

OPENSport
OPEN-EAR WIRELESS EARBUDS

QUICK START GUIDE



WELCOME TO THE LAB

The Lab is where you'll find real people, developing really great products, in a real place called San Diego.

PERSONAL TECH DONE BETTER



Designed for You

We actually listen to what you want and we're always looking for ways to make everything easier and better for you.



Lab Quality Sound

Choose from different settings and customize your sound style to match exactly what you're doing.



Surprisingly Awesome Value

We always pack in the most functionality and fun into every product at a truly accessible price.

#yourkindoftech

Tech all about you

BLUETOOTH PAIRING

1 Take out of the case and remove stickers. Place them back in the case.



2 Blue lights on case indicates charging. Remove earbuds from case.

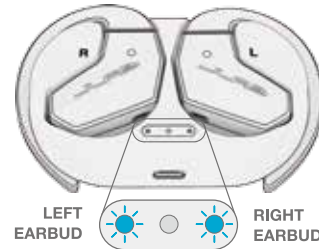

3 One will blink blue/white indicating ready to pair to your device. Select "JLab Open Sport" in your device's Bluetooth settings.

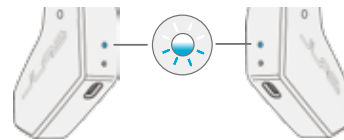

ADDING NEW/ADDITIONAL BLUETOOTH DEVICES:

Turn OFF Bluetooth from any previously connected device. Turn ON Bluetooth from new device. Earbuds will automatically enter Bluetooth Pairing. Select "JLab Open Sport" in new device settings to connect.

BUTTON FUNCTIONS



VOLUME DOWN: 1x Tap

SIRI (iOS) or "OK GOOGLE" (ANDROID): 2x Tap

TRACK BACK: Press hold 1+ sec

SWITCH EQ: 3x Tap (Switch JLab Signature/Balanced)

VOLUME UP: 1x Tap

ANSWER: 2x Tap

HANG UP: 2x Tap

REJECT INCOMING CALLS: Press hold 1+ sec

PLAY / PAUSE: 2x Tap

TRACK FORWARD: Press & hold 1+ sec
SWITCH EQ: 3x Tap (Switch JLab Signature/Balanced)

TURN OFF WITHOUT CASE: Turn off Bluetooth from device settings. JLab Open Sport will power off after 3 minutes.

FITTING WITH HOOKS

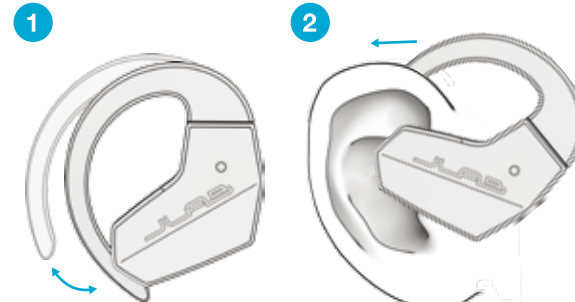

Bend and form the hook to desired preference.

Place hook behind ear and move back toward ear.



Rotate and adjust for best fit.

FITTING WITH FRAMES

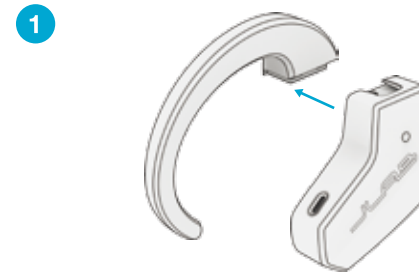

Slide ear hooks sideways to remove.

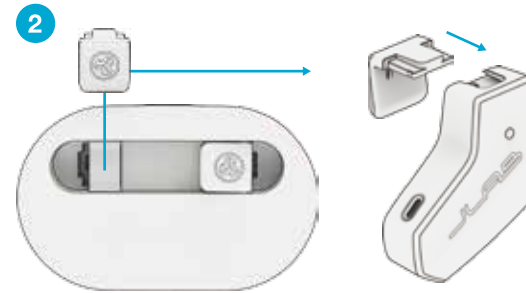

Remove the clips from the bottom of the charging case and slide on each Open Sport.

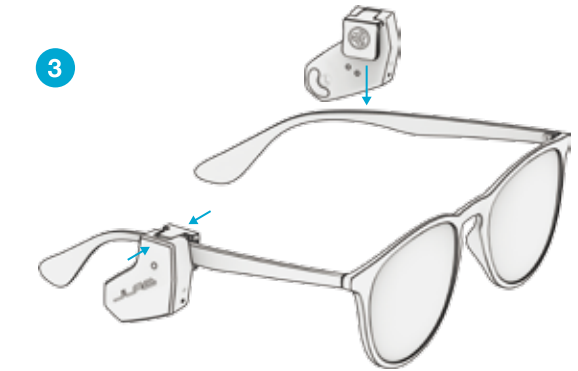

Slip over frames and adjust the clip tension by pinching in while on frames.

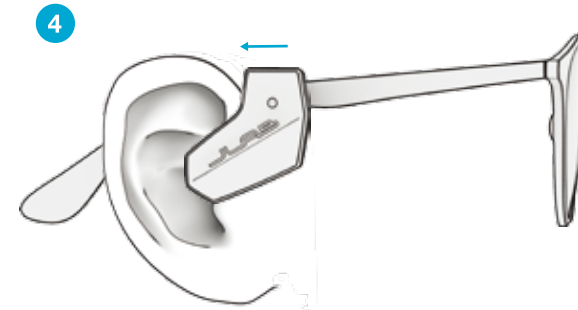

While wearing, move Open Sport closest to ear for best performance.