

FCC warning:

Any Changes or modifications not expressly approved by the party responsible for compliance could void the user's authority to operate the equipment.

Note: This equipment has been tested and found to comply with the limits for a Class B digital device, pursuant to part 15 of the FCC Rules. These limits are designed to provide reasonable protection against harmful interference in a residential installation.

This equipment generates uses and can radiate radio frequency energy and, if not installed and used in accordance with the instructions, may cause harmful interference to radio communications. However, there is no guarantee that interference will not occur in a particular installation. If this equipment does cause harmful interference to radio or television reception, which can be determined by turning the equipment off and on, the user is encouraged to try to correct the interference by one or more of the following measures:

- Reorient or relocate the receiving antenna.
-Increase the separation between the equipment and receiver.
-Connect the equipment into an outlet on a circuit different from that to which the receiver is connected.
-Consult the dealer or an experienced radio/TV technician for help.

This device complies with part 15 of the FCC Rules. Operation is subject to the following two conditions: (1) This device may not cause harmful interference, and (2) this device must accept any interference received, including interference that may cause undesired operation.

VOICE PROMPTS

"Ready to Pair": JBuds Air Pro are ready to pair to Bluetooth device
"Bluetooth Connected": Earbud is connected to device

"Battery Full": 100-80%
"Battery Medium": 80-20%
"Low Battery": Less than 20%
When power decreases to 10%, "Low Battery" will play

EQ SETTINGS: Voice prompts will indicate EQ settings.

JLab SIGNATURE: JLab C3™ signature sound with amplified vocals and bass
BALANCED: Even sound with no additional enhancements
BASS BOOST: Amplified bass and sub-bass

FITTING

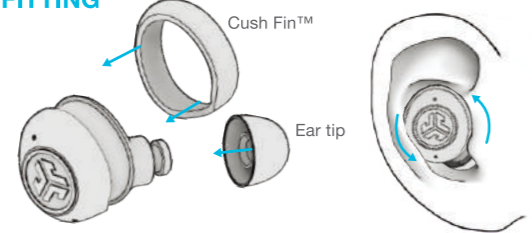

Try all the optional Cush Fins and ear tips for best fit and proper seal. Place in ear and rotate for best fit.

QUICK TIPS

- Fully dry off the earbuds before putting in the charging case to avoid any damage to the case. The earbuds are sweat/water resistant but the case is not.
• Either earbud can connect to your device and be used independently. Simply take out the earbud from charging case and it will auto connect.
• Choosing the correct ear tip makes a significant improvement in audio quality due to proper seal for the driver. Try all ear tips for best results.

TROUBLESHOOTING

No audio in one earbud or earbuds disconnected (Manual Reset)

1 Keep earbuds in the charging case and forget "JLab JBuds Air Pro" in your Bluetooth device settings.

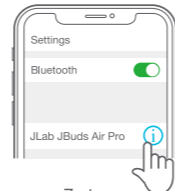

7x tap



2 Quick tap 7x on one earbud in charging case. Earbud blinks blue 4 times.

7x tap



3 Quick tap 7x on other earbud in charging case. Earbud blinks blue 4 times.

4 Take both earbuds out of the charging case. One earbud will blink blue/white indicating ready to pair to your device.



FREE GIFT

when you register this product
jlab.com/register
Product updates | How-to tips
FAQs & more
Gift for US only. No APO/FPO/DPO addresses.

3 MONTHS FREE TIDAL

With purchase. Visit jlab.com/tidal

Contact Us

If you're unsatisfied with your purchase, please contact us and we'll take care of you! You can contact our US based customer support team:
Website: jlab.com/contact
Email: support@jlab.com
Phone U.S.: +1 (405) 445-7219 (Check hours jlab.com/hours)
Phone U.K./EU: +44 (20) 8142 9361 (Check hours jlab.com/hours)
Visit jlab.com/warranty to initiate a return or exchange.

Our team is constantly improving your product experience. This model may have new features or controls which are not detailed in this guide. For the latest version of the manual, please visit jlab.com/manuals

Access the full product manual at
jlab.com/manuals



Additional languages can be found at
jlab.com/manuals

FCC ID: 24HYV-JAPROL
FCC ID: 24HYV-JAPROR
IC:21316-JAPROL
IC:21316-JAPROR
HVIN:JBUDS AIR PRO L
HVIN:JBUDS AIR PRO R



JBUDSAIR
PRO
QUICK START GUIDE

ISED warning:

This device contains licence-exempt transmitter(s)/receiver(s) that comply with Innovation, Science and Economic Development Canada's licence-exempt RSS(s). Operation is subject to the following two conditions:

- (1) This device may not cause interference.
(2) This device must accept any interference, including interference that may cause undesired operation of the device.

L'émetteur/récepteur exempt de licence contenu dans le présent appareil est conforme aux CNR d'Innovation, Sciences et Développement économique Canada applicables aux appareils radio exempts de licence. L'exploitation est autorisée aux deux conditions suivantes:
1) L'appareil ne doit pas produire de brouillage;
2) L'appareil doit accepter tout brouillage radioélectrique subi, même si le brouillage est susceptible d'en compromettre le fonctionnement.

SAR warning

IC Radiation Exposure Statement
This equipment complies with ISED radiation exposure limits set forth for an uncontrolled environment.
In case this equipment has to subject to IC SAR (Specific Absorption Rate) exposure test, this equipment is designed to meet the requirements for exposure to radio waves established by the ISED. These requirements set a SAR limit of 1.6 W/kg averaged over one gram of tissue. The highest SAR value reported under this standard during product certification for use when properly worn on the body or on the head, with no separation. To meet RF exposure guidelines and reduce exposure to RF energy during the operation, this equipment should be positioned at least this distance away from the head

CE

This product can be used in Europe without restrictions.
frequency bands:2402Mhz-2480Mhz, maximum output power:s10dBm
Address: GuangDong Simpreal Intelligent Technology Co., LtdRoom 2408, JiaHong ZhenXing DaSha, DongGuan Avenue #13, DongCheng District, DongGuan City, GuangDong Province, P.R. China
model:JBuds Air Pro

BLUETOOTH PAIRING

1 Take earbuds out of case and remove stickers. Place earbuds back in case and close door.

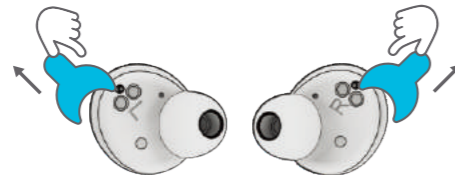

2 Blue lights on case indicates charging. Remove earbuds from case.

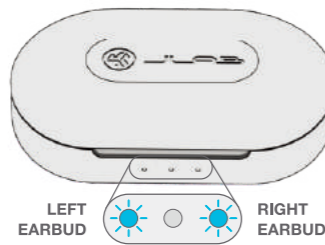

3 One earbud will blink blue/white indicating ready to pair to your device. Select "JLab JBuds Air Pro" in your device's Bluetooth settings.

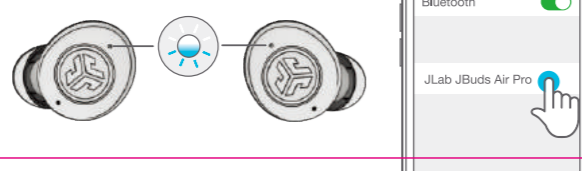

ADDING NEW/ADDITIONAL BLUETOOTH DEVICES:

Turn OFF Bluetooth from any previously connected device. Turn ON Bluetooth from new device. Earbuds will automatically enter Bluetooth Pairing. Select "JLab JBuds Air Pro" in new device settings to connect.

BUTTON FUNCTIONS



- VOLUME DOWN: Single Tap
SIRI (IOS) or "OK GOOGLE" (ANDROID): Double Tap
MUSIC / MOVIE MODE: Press hold 1+ sec
TURN ON: Press hold 3+ sec
CHANGE EQ: Triple Tap (JBuds Air Pro will cycle 3 EQ settings)
VOLUME UP: Single Tap
ANSWER: Single Tap
HANGUP: Double Tap
REJECT INCOMING CALLS: Press hold 1+ sec
PLAY / PAUSE: Double Tap
TRACK FORWARD: Press & hold 1+ sec
TURN ON: Press & hold 3+ sec
BE AWARE: Triple Tap

TURN OFF WITHOUT CASE: Turn off Bluetooth from device settings. Earbuds will power off after 3 minutes.

CHARGING EARBUDS

Placing in the charging case will auto power OFF and start charging. Blue lights will indicate earbuds are charging and will turn OFF when fully charged.

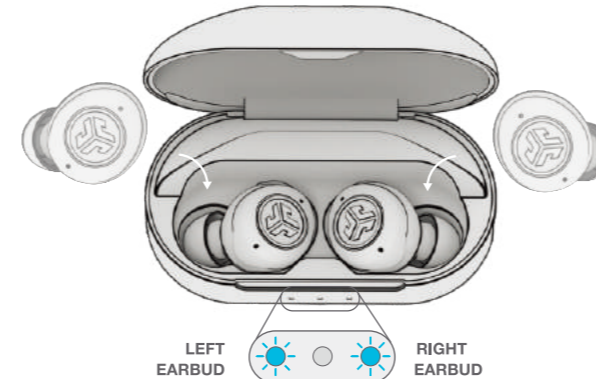

Removing the earbuds will auto power ON and connect to last device.

CHARGING CASE

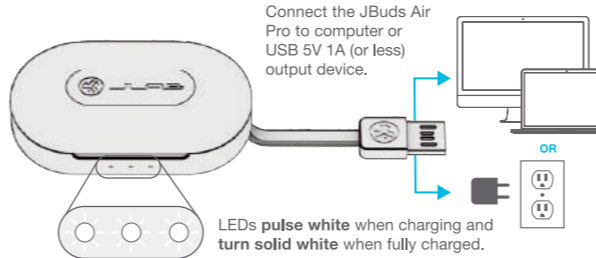

Connect the JBuds Air Pro to computer or USB 5V 1A (or less) output device.
LEDs pulse white when charging and turn solid white when fully charged.

MULTIPOINT (connect 2 devices simultaneously)

1 Once FIRST device is connected, turn off Bluetooth in device settings. JBuds Air Pro will auto enter Bluetooth Pairing.



2 Enter your SECOND device Bluetooth settings and connect to JBuds Air Pro.



3 Enter your FIRST device Bluetooth settings. Turn on Bluetooth and connect to JLab JBuds Air Pro.



OFFICIAL AUDIO PARTNER OF MAJOR LEAGUE SOCCER

#FINDYOURGO

For full User Manual + other JLab products visit
JLAB.COM



Date: 12.22.21

PROJECT: JBuds Air Pro QSG

STOCK: 220g, MATTE

INK: 4/4 CMYK / CMYK

FLAT SIZE: 13.5433" x 4.7244 "

FOLDED SIZE: 3.3858" x 4.7244"