

English

ReVent[®]

model
RVM80

Smart Phone Fan

Installation Guide

Read and Save These Instructions

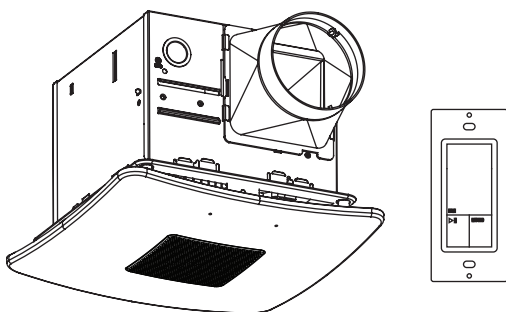

Need Help?

Watch the installation video at:
reventfans.com/install

Questions? Call
1-877-543-8698 (English) or
1-800-615-5439 (French)

Please Read and Save These Instructions

Table of Contents

page 1	Table of Contents
page 1	Specifications
page 2	What's Inside The Box
page 3	Safety Information
page 4	Planning Your Installation
page 5	Connecting The Duct
page 6	Removing Your Old Fan
page 7-12	SheetLock® Easy Roomside Installation
page 12-17	Installation For New Construction Framing
page 17	Care And Cleaning
page 18-20	Installing The Control
page 21	Using The Control
page 21	Connecting to Bluetooth Speaker
page 22	Using Phone's Assistant
page 22	Voice Control
page 23	Make or Take a Call and Text
page 23	Pairing a Second Wall Mounted Control
page 24-25	Frequently Asked Questions
page 26	3-Year Limited Warranty

Specifications

RVM80

performance at 4" ducting

Static Pressure (in wg)	Airflow (cfm)	Sound (sones)	Energy (watts)	Duct Size
*0.1	80	0.9	21	4 in

*certified by HVI

Voltage	120 V
Frequency	60 Hz
Fan Weight	7.8 Lbs (3.54 Kg)
Shield Size	11 x 11 in (27.9 x 27.9 cm)
Housing Length*	8 ³ / ₈ in (21.3 cm)
Housing Width*	7 ⁷ / ₈ in (20 cm)
Housing Depth*	6 ³ / ₈ in (16.2 cm)

*This may require modification of your current opening. Some hand tools required. Power tools may also be necessary.

Safety Information

1.) WARNING - TO REDUCE THE RISK OF FIRE, ELECTRIC SHOCK, OR INJURY TO PERSONS, OBSERVE THE FOLLOWING:

- a) Installation work and electrical wiring must be done by qualified person(s) in accordance with all applicable codes and standards, including fire-rated construction.
 - b) Sufficient air is needed for proper combustion and exhausting of gases through the flue (chimney) of fuel burning equipment to prevent back drafting. Follow the heating equipment manufacturer's guideline and safety standards, such as those published by the National Fire Protection Association (NFPA), the American Society for Heating, Refrigeration and Air Conditioning Engineers (ASHRAE), and the local code authorities.
 - c) When cutting or drilling into wall or ceiling, do not damage electrical wiring and other hidden utilities.
 - d) Ducted fans must always be vented to the outdoors.
 - e) If this unit is to be installed over a tub or shower, it must be marked as appropriate for the application and be connected to a GFCI (Ground Fault Circuit Interrupter) - protected branch circuit.
- 2.) Use this unit only in the manner intended by the manufacturer. If you have questions, contact the manufacturer.
- 3.) Before servicing or cleaning unit, switch power off at service panel and lock the service disconnecting means to prevent power from being switched on accidentally. When the service disconnecting means cannot be locked, securely fasten a prominent warning device, such as a tag, to the service panel.
- 4.) This ventilation fan is approved for use over a bathtub or shower when installed in a GFCI protected circuit. Do not use unapproved fans over a bathtub or shower that are not approved for that application.
- 5.) Install ductwork in a straight line with minimal bends.
- 6.) Use 120 V, 60 Hz for the electrical supply and properly ground the unit. Follow all local safety and electrical codes.
- 7.) Do not use this fan with any solid-state control device; such as a dimmer switch. Solid-state controls may cause harmonic distortion, which can cause a motor humming noise, as well as increase risk of fire or electric shock.
- 8.) To reduce the risk of fire or electric shock, do not block air entry shield.
- 9.) Mount with the lowest moving parts at least 8.2 ft (2.5 m) above floor or grade level.
- 10.) **Never** place a switch where it can be reached from a tub or shower.
- 11.) Not to be installed in a ceiling thermally insulated to a value greater than R40. (This is required for installation in Canada only).
- 12.) Not for use in cooking areas. (See PAGE 5 for details)
- 13.) This product must properly connect to the grounding conductor of the supply circuit.

Follow the heating equipment manufacturer's guideline and safety standards, such as those published by the National Fire Protection Association (NFPA), the American Society for Heating, Refrigeration and Air Conditioning Engineers (ASHRAE), and the local code authorities.



WARNING: Not suitable for use as a range hood.



CAUTION: For General Ventilating Use Only - Do Not Use To Exhaust Hazardous Or Explosive Materials And Vapors.



CAUTION: Do not install in locations where the temperature will exceed 104°F (40°C).



IMPORTANT: Exercise care to not damage existing wiring when cutting or drilling into walls or ceilings.



NOTE: Make sure duct work size is a minimum of the discharge. Do not reduce. Reducing the duct size can increase fan noise.



IMPORTANT: You may want to consult with a qualified licensed electrician regarding the wiring of your ventilation fan.



WARNING: To reduce the risk of electric shock, please disconnect the electrical supply circuit before servicing.



CAUTION: This product must be properly grounded.

Go to reventfans.com to obtain a copy of this manual.

Planning Your Installation

When installing the ventilation fan in a new construction site, install the main body of the FAN and duct work during the rough-in construction of the building. The SHIELD should be installed after the finished ceiling is in place.

When installing in existing construction, use the provided cutout TEMPLATE for the ceiling. SHIELD edge should overlap finished ceiling.

Not for use in cooking area - see diagram below.

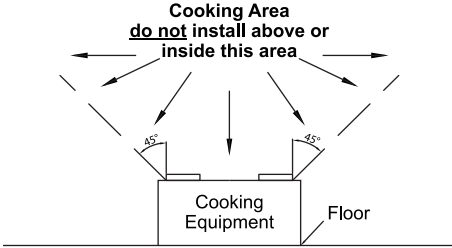

Do not install ventilation fan in areas where the duct work will require configuration as shown.

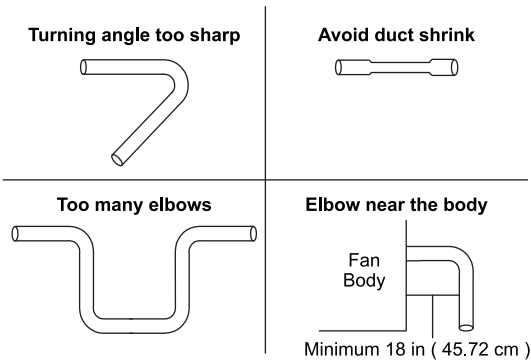

 **NOTE:** If installing in existing construction, you may need to have access to space above and below the installation location.

There are multiple installation configurations possible for this ventilation fan. Not all configurations are shown. If your installation requires a variation other than those shown, consult with a licensed contractor to determine the best installation for your project. If you are replacing an existing fan, ensure that the new FAN will adequately cover the existing opening.

Connecting the Duct

- Install a circular duct to outlet and secure it with duct tape or clamps.
- Install the duct to the outlet with a gradient 1° ~ 2° to the outside as shown.
- The ducting from this FAN to the outside of the building has a strong effect on the air flow, noise and energy use of the fan. Use the shortest, straightest duct routing possible for best performance, and avoid installing the FAN with smaller ducts than recommended. Insulation around the ducts can reduce energy loss and inhibit mold growth. Fans installed with existing ducts may not achieve their rated airflow.
- 4 in (10.16 cm) round is recommended for best performance.
- Ensure duct joints and exterior penetrations are sealed with caulk or other similar material to create an air-tight path, to minimize building heat loss and gain, and to reduce the potential for condensation.
- Place/wrap insulation around duct and/or FAN in order to minimize possible condensation buildup within the duct, building heat loss and gain.

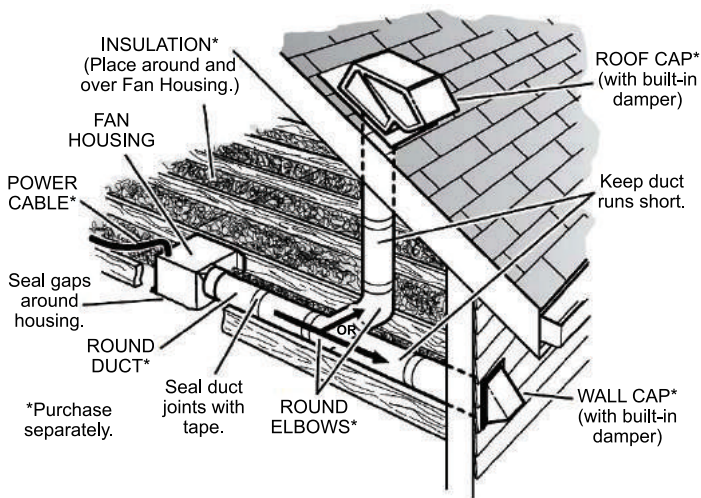

Removing Your Old Fan

Watch the video: reventfans.com/how-to-remove-an-old-bath-fan

1.) Disconnect the electrical power supply and lock out the service panel for the existing fan.

2.) Remove the grille from the existing fan. Pull the grille down to expose it's two springs. Squeeze each spring together and pull down again to release the springs from the motor plate slots.

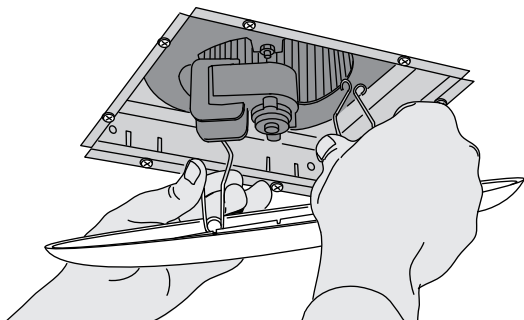

3.) Your existing fan may be attached in several ways. Look for attachment screws in the ceiling and remove. Your fan may also be attached on the attic side, which will require you to access it from the attic. Locate attic attachment screws and remove.

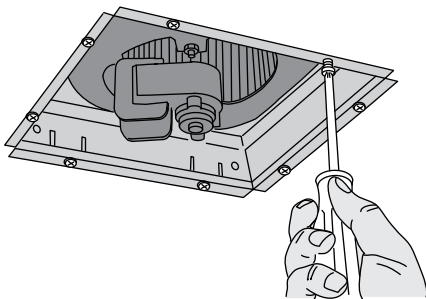

4.) Remove the old fan. This may require cutting and pulling. Wear gloves and eye protection.

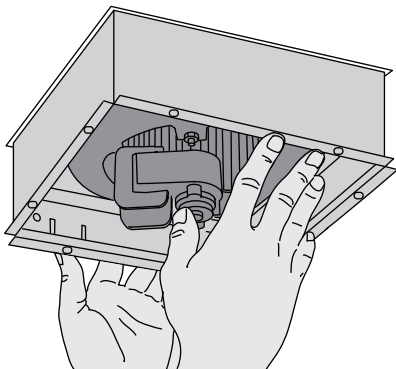

SheetLock® Easy Roomside Installation

Watch the video: reventfans.com/install

⚠ WARNING: Disconnect all AC Power Breakers or Fuses before attempting to cut into your ceiling.

1.) Place the provided sheetrock cutout TEMPLATE on ceiling where you wish the FAN to be (DAMPER and electrical positions shown on TEMPLATE). We suggest using painter's masking tape to hold the template in place while cutting. If there is a pre-existing fan opening, use aligning windows to find it's edges. Either cut through the provided guide slots in the TEMPLATE, or mark your cut lines with a pencil and remove the TEMPLATE. Use a sheetrock jab saw to cut your fan opening in the ceiling.

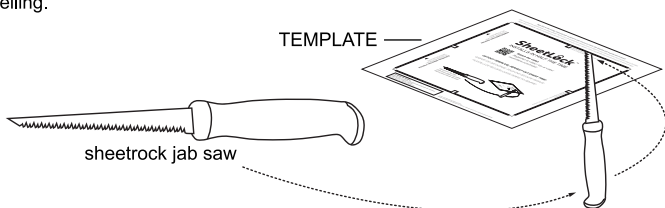

2.) Use a flathead screwdriver to raise the DAMPER away from the notch in the FAN body, then slide the DAMPER up half way until the notch in the side of the DAMPER aligns with the upper set of guides. Remove the DAMPER from the FAN.

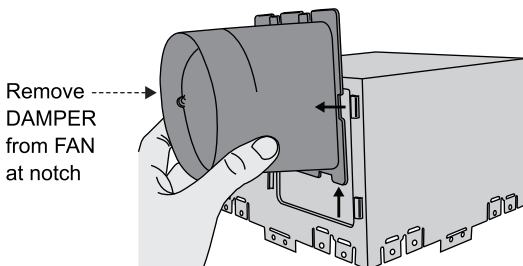
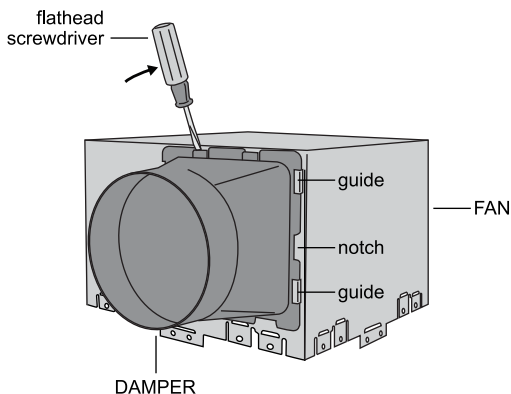

3.) Attach DAMPER to ducting. Tape DAMPER to ducting with duct tape. Set the connected DAMPER and ducting in the ceiling opening, then set the FAN in the ceiling opening as well.

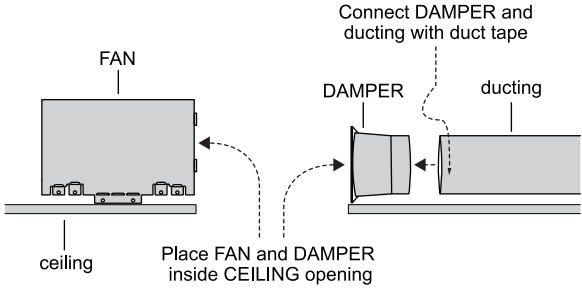

4.) Attach conduit with wiring to FAN.

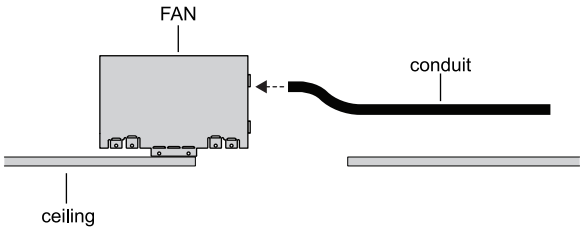

5.) Reattach DAMPER to FAN inside the ceiling, damper should click into place securely.

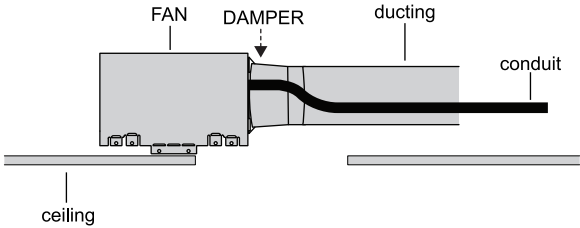

6.) Select a set of holding tabs, depending on the thickness of your sheetrock.

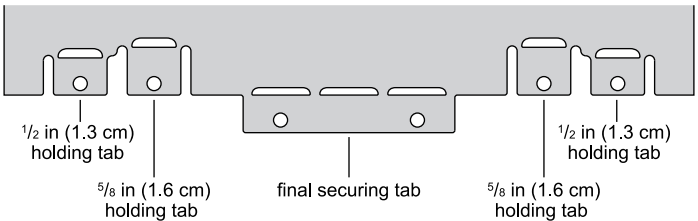

7.) Bend the holding tabs you selected outward.

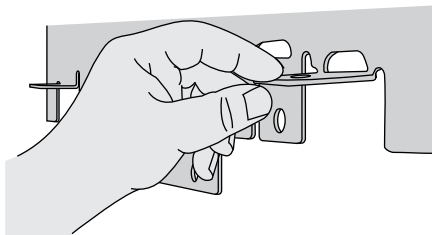

8.) Set FAN into place in the opening using holding tabs, now the tabs hold the fan in position in the ceiling opening.

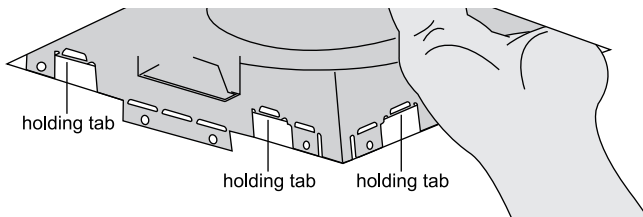

⚠ WARNING: Disconnect the AC power before any work is done to any part of the circuit ReVent® is connected to. If you do not understand this warning, seek the services of a qualified licensed electrician.

⚠ WARNING: Copper to copper only. Do **not** use aluminum wire.

⚠ WARNING: Follow all local electrical and safety codes, and NEC (National Electrical Codes).

⚠ CAUTION: If your house wires do not match these colors, determine what each house wire represents before connecting. You may need to consult a qualified licensed electrician to determine this safely.

9.) Disconnect FAN motor from electrical enclosure. Remove the electrical cover set screw and slide open the electrical enclosure.

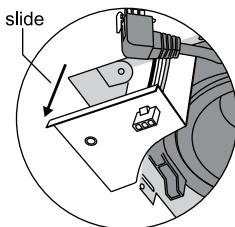
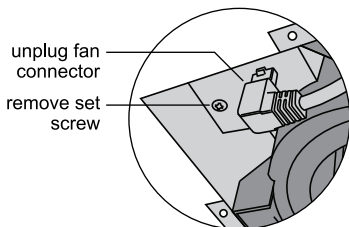

10.) Connect wiring using the provided QUICK CONNECTS. Match wire colors as shown:

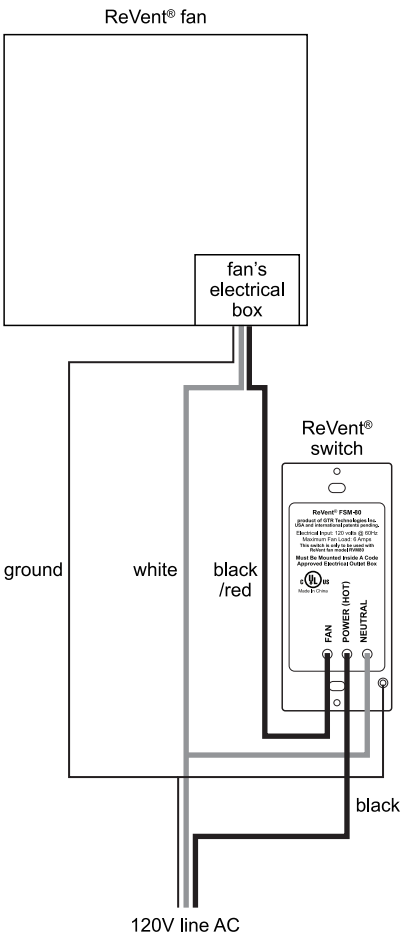
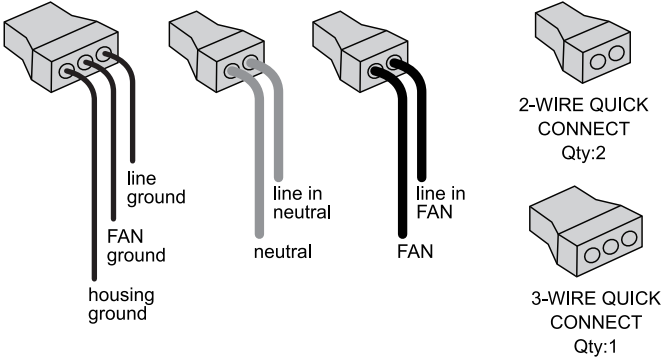

11.) Once connected, reattach the electrical enclosure.

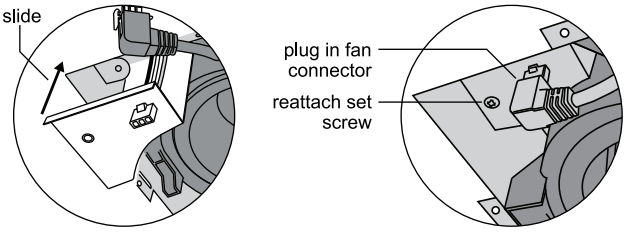

12.) Press and bend the final securing tabs flat against ceiling to lock the FAN in place.

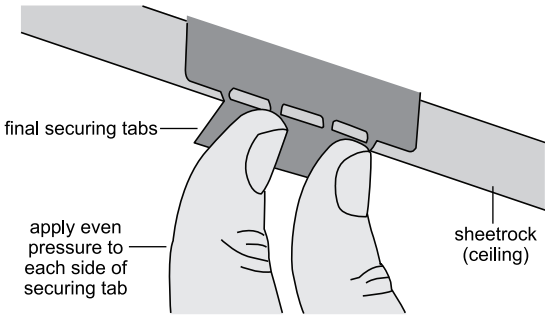

13.) Align TRIM RING notch to vent (DAMPER) position. Attach TRIM RING to FAN. TRIM RING attaches to FAN body and clicks into place when secure.

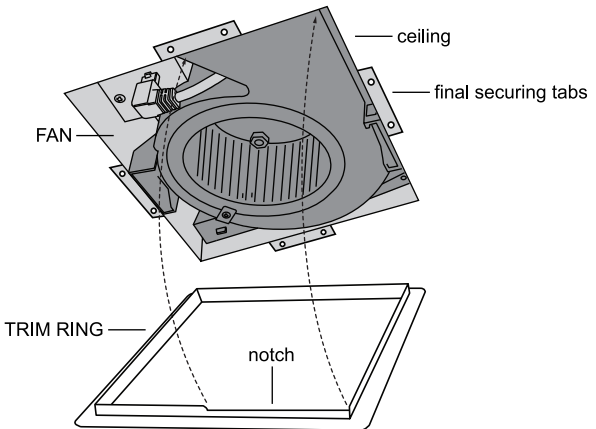

14.) Connect music wire to music plug. Attach the SHIELD by squeezing the mounting springs together and inserting the springs into the spring guides in the FAN.

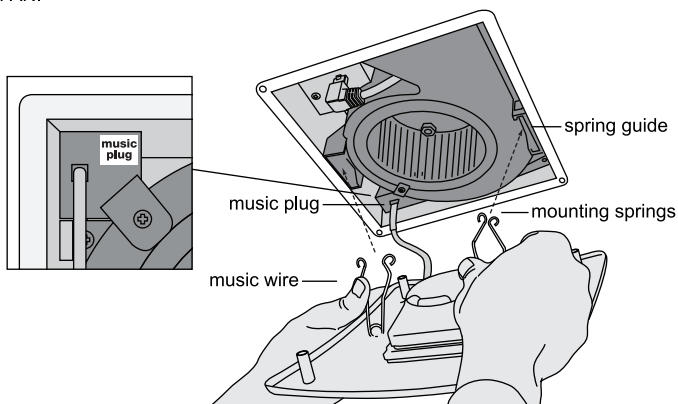

Installation For New Construction Framing

 **NOTE:** Even with new construction, you can use the SheetLock® installation method; however, ReVent® can still be installed using a method home builders would be more familiar with, as outlined in this section.

 **WARNING:** Disconnect all AC Power Breakers or Fuses before attempting to cut into your ceiling.

1.) Select a set of holding tabs, depending on the thickness of your sheetrock.

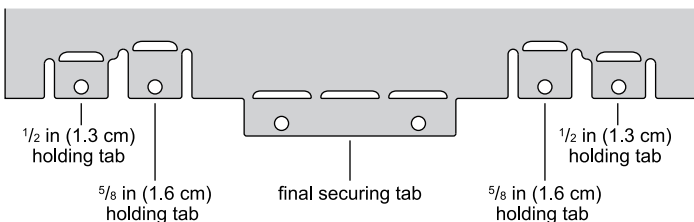

2.) Bend the holding tabs you selected outward.

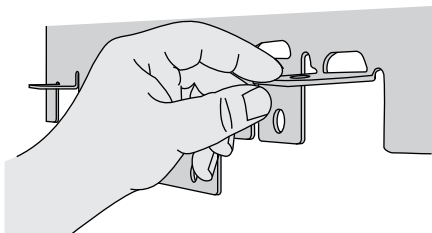

3.) Attach FAN to ceiling joists with BRACKETS using ROUNDHEAD WOOD SCREWS, then install the sheetrock for your ceiling.

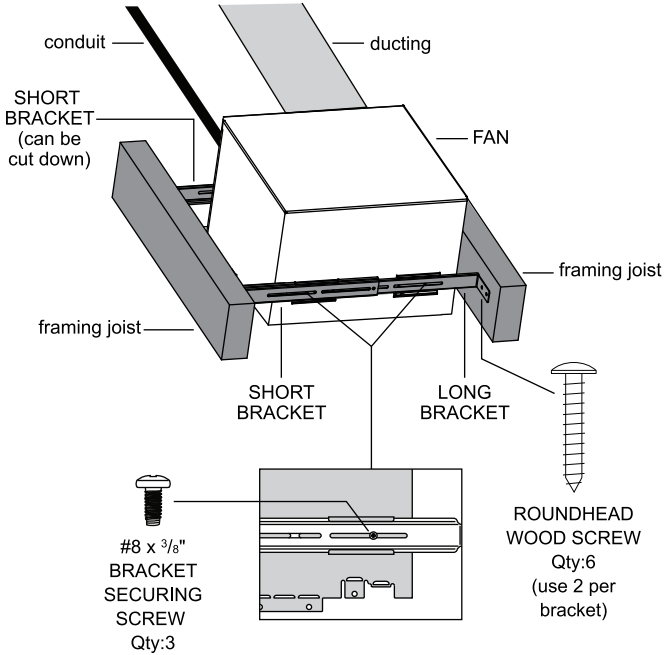



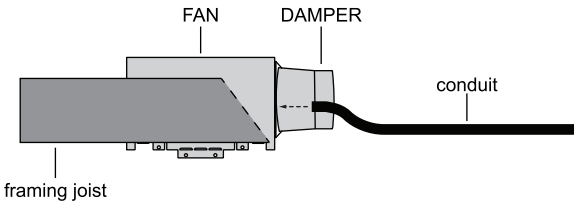

4.) Attach conduit with wiring to FAN.

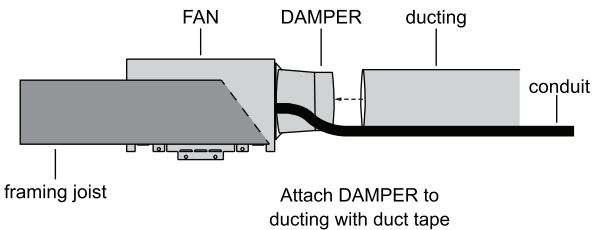

5.) Attach DAMPER to ducting.



-  **WARNING:** Disconnect the AC power before any work is done to any part of the circuit ReVent® is connected to. If you do not understand this warning, seek the services of a qualified licensed electrician.
-  **WARNING:** Copper to copper only. Do **not** use aluminum wire.
-  **WARNING:** Follow all local electrical and safety codes, and NEC (National Electrical Codes).
-  **CAUTION:** If your house wires do not match these colors, determine what each house wire represents before connecting. You may need to consult a qualified licensed electrician to determine this safely.

6.) Disconnect FAN motor from electrical enclosure. Remove the electrical cover set screw and slide open the electrical enclosure.

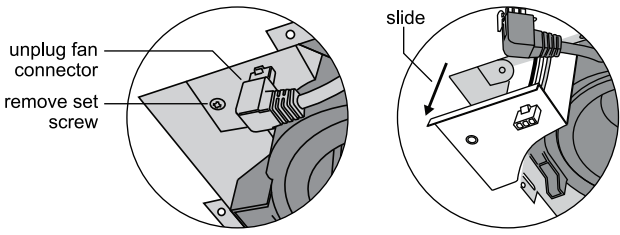

7.) Connect wiring using the provided QUICK CONNECTS. Match wire colors as shown:

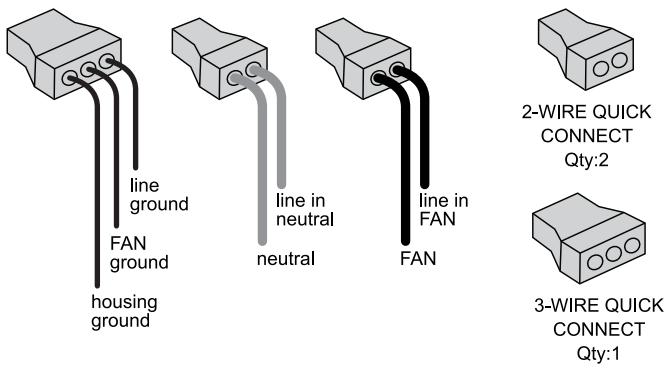

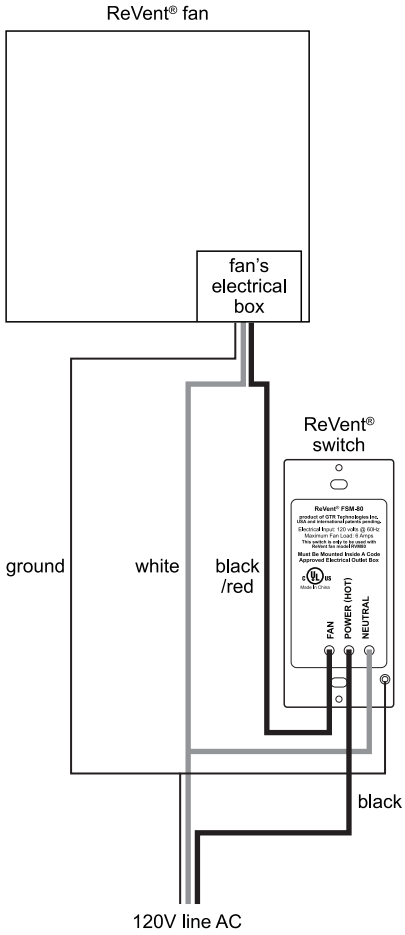

8.) Once connected, reattach the electrical enclosure.

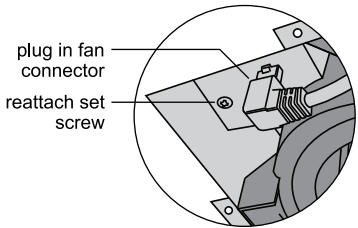
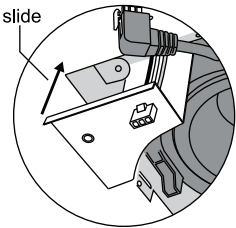

9.) Press and bend the final securing tabs flat against ceiling to lock the FAN in place.

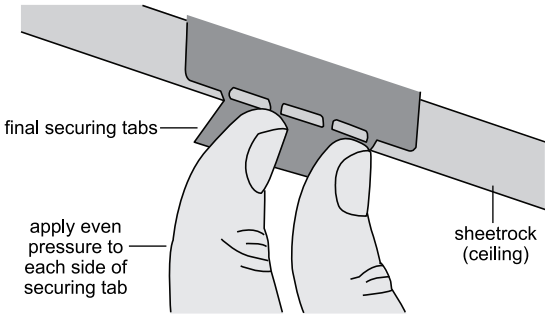

10.) Align TRIM RING notch to vent (DAMPER) position. Attach TRIM RING to FAN. TRIM RING attaches to FAN body and clicks into place when secure.

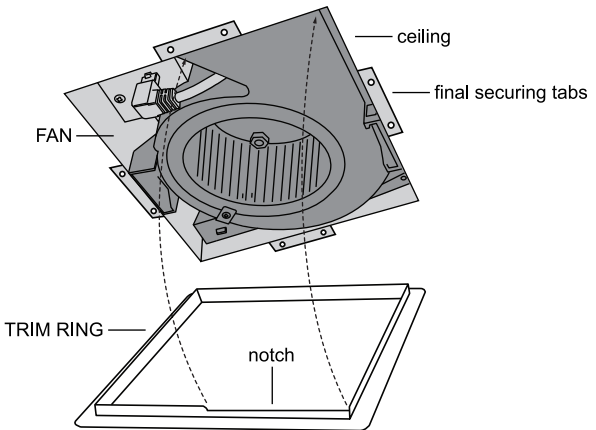

11.) Connect music wire to music plug. Attach the SHIELD by squeezing the mounting springs together and inserting the springs into the spring guides in the FAN.

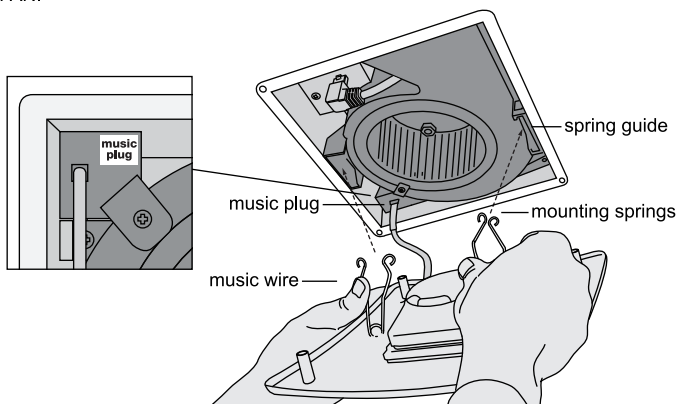



Care and Cleaning

⚠ WARNING: To reduce the risk of electric shock, fire, or injury to persons, disconnect or turn off the breaker and lock the power supply at the panel to prevent the power from being turned on before servicing or cleaning the unit.

- 1.) Remove the SHIELD by squeezing the springs and pulling down.
- 2.) Remove dust and dirt from the FAN with a vacuum cleaner.
- 3.) Dampen cloth with dish detergent. Wipe the FAN and dry with a cloth.
- 4.) Replace the SHIELD.

Installing The Control

 **WARNING:** Turn off circuit breaker or remove fuse(s) and test that power is off before wiring. Wiring the control live can cause serious risk of electrical shock and/or damage to the control, voiding the warranty. For safety, this product must be installed in a grounded wall enclosure. If you are unfamiliar with methods of installing electrical wiring, secure the services of a qualified licensed electrician. Use only copper wire, do **not** use aluminum wire with this device.

 **ELECTRICAL SHOCK WARNING:** This control is an automatic on device. At no time should a person work on the fan/light or any appliance connected to this control without the electrical circuit breaker or fuse switched off. This CONTROL could turn on the attached device by the unintended presence of condensation while the work is being performed. Always disconnect the AC power before any work is done to any part of the circuit this CONTROL is connected to. If you do not understand this warning, seek the services of a qualified licensed electrician.

 **CAUTION:**

- Never place the CONTROL where it can be reached from a tub or shower.
- Use only a 120V AC 60Hz power supply connection.
- For indoor use only.
- Do not exceed the CONTROL's maximum electrical load ratings, as indicated on the product label.
- Must be installed and used in accordance with your local electrical codes.
- If a bare copper or green ground connection is not available in the wall box, contact a qualified licensed electrician for installation.
- For use with permanently installed 120V AC powered fans only.
- Use only #14 or #12 copper wire connections.

 **IMPORTANT:** Read each step carefully and perform in sequence. The CONTROL will not work or will become damaged if wires are connected incorrectly. To prevent damage, connect the CONTROL exactly as shown in the installation diagrams, otherwise warranty will be voided. Prior to wiring, straighten or clip ends of wire such that ends of each wire are straight (if using the CONTROL to replace an existing switch). Strip wire insulation at the end of each wire to expose 16 mm (0.63 in) of copper. Where instructed to make a connection, twist ends of stripped wires together and twist a proper connector clockwise until secure. The Operating Control is a Type 1 Action Control, Independently Mounted, Pollution Degree 2, tested to an impulse voltage of 2500V, and has an Operating Temperature Range of 0°C - 40°C.

 **WARNING:** To avoid fire or risk of electrical shock, turn off power at circuit breaker or disconnect fuse. Test the power is off before you begin wiring.

FCC ID: 2AHXP-RVM80 Canada IC : 21435-RVM80

This device complies with Part 15 of the FCC Rules and RSS-210 of Canada. Operation is subject to the following two conditions: (1) this device may not cause harmful interference, and (2) this device must accept any interference received, including interference that may cause undesired operation.

1.) For new installations, install a 8.9 cm (3.5 in) deep single-gang or multi-gang electrical wall enclosure, or (replacement of existing switch) remove existing wall plate and switch device being replaced.

2.) Attach 120V AC 60Hz 3-wire power (Hot / Neutral / Ground) inside the wall enclosure with a minimum of 15.2 cm (6 in) leads. Attach fan three wire leads inside the wall enclosure also with minimum 15.2 cm (6 in) leads. If an existing power connection is used in an existing wall enclosure you must confirm proper AC 120V Hot / Neutral / Ground are available.

3.) Attach wires. Make sure the wall enclosure, fan, and the CONTROL are properly grounded. Make sure ground wire is securely fastened. Tighten all ground screws or wire nuts securely. Use the proper sized wire nut for #14 or #12 wire. Make sure to strip back the copper wire 1.6 cm (5/8 in) and twist wire and nut clockwise.

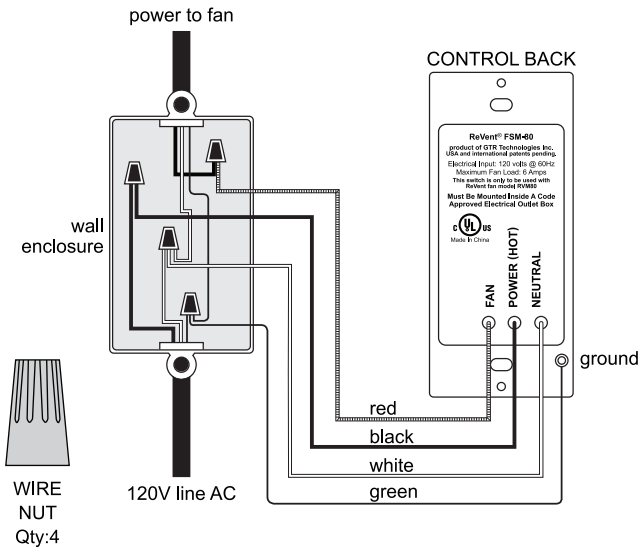

4.) Tuck wires into wall enclosure and fasten the CONTROL to the wall enclosure with the two screws provided.

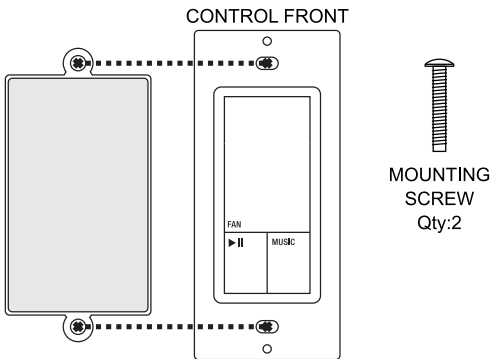

5.) Attach a wall plate. Wall plates that fit this control can be purchased at any hardware store. This control can be used with any decora style wall plate (examples below).

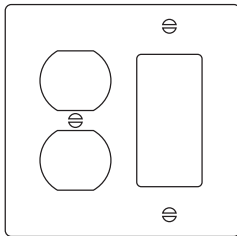
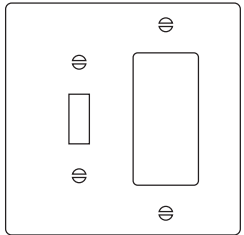
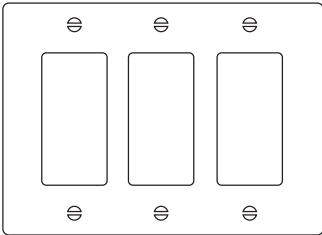
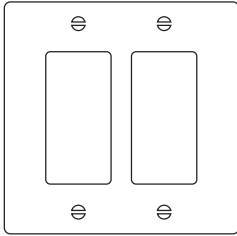
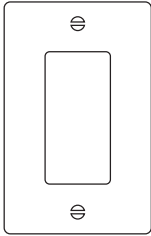

Using The Control

FAN ON/OFF:

- 1.) Press FAN ON/OFF button turn fan ON.
- 2.) When the FAN is ON, Press FAN ON/OFF button to turn the fan OFF.

MUSIC:

- 1.) Press MUSIC button to turn speaker ON. Speaker will automatically connect to the last connected device. If no device automatically connects, the speaker will go into pairing mode.
- 2.) At any time, press and hold MUSIC button for 3 seconds to start pairing mode. This will disconnect any connected device. Speaker will play pairing mode chime and the status light will blink on and off.
- 3.) When speaker is ON, press MUSIC button to turn speaker OFF.

PLAY/PAUSE:

- 1.) When phone is connected, press the PLAY/PAUSE button to PLAY music on the phone. Press the PLAY/PAUSE button again to PAUSE the music.
- 2.) When phone is connected, quickly press PLAY/PAUSE twice to SKIP to the next song.
- 3.) When phone is connected, hold the PLAY/PAUSE button for 3 seconds to activate the phone's assistant.
- 4.) Press the PLAY/PAUSE button to answer an incoming call. Press the PLAY/PAUSE button again to end the call.

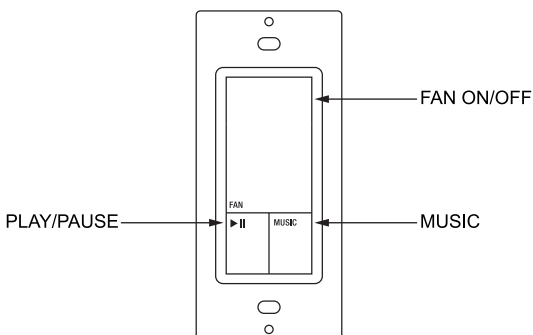

Connecting to Bluetooth Speaker

- 1.) Press MUSIC button. The speaker will play a chime to indicate that the speaker is ON. The status light will start blinking.
- 2.) Speaker will automatically try to connect to the last connected device. If no phone automatically connects, the speaker will automatically go into Pairing Mode.
- 3.) When speaker is in Bluetooth Pairing Mode, go to phone's Bluetooth settings and select "ReVent Music Fan".
- 4.) Connected chime will play. The status light will be solid blue indicating that the phone is connected.
- 5.) The music from the connected phone will play on the speaker. You can now talk to your phone's virtual assistant or make or take a call through the fan's speaker and microphone.

Using Phone's Assistant

- 1.) When phone is connected via Bluetooth, you can talk to your phone's virtual assistant directly through the fan's microphones even when your phone isn't in the room.
- 2.) Activate the phone's assistant by saying "Hey Siri" or "OK Google". If the fan is ON when a conversation with the assistant starts, it will turn OFF for the duration of the conversation. The fan will turn back ON after the conversation ends.
- 3.) Wait for the assistant's tone and then say your command.
- 4.) Here are some commands to try:

IPHONE

- "Hey Siri, play some music"
- "Hey Siri, what is the weather today?"
- "Hey Siri, call Chris"
- "Hey Siri, change the volume to 50%"

ANDROID

- "OK Google, play some music"
- "OK Google, what is the weather today?"
- "OK Google, call Chris"
- "OK Google, change the volume to 50%"

Voice Control

PHONE ASSISTANT:

- 1.) When your phone is connected to Bluetooth, say "Hey Siri" or "OK Google" to activate your phone's assistant even when your phone isn't in the room.
- 2.) Wait for the assistant tone to play on the speaker and then say your command.
- 3.) Your assistant's response will play over the speaker.

CALL CONTROL:

- 1.) When your phone is connected to Bluetooth and you are receiving an incoming call, answer the call by saying "pick up".
- 2.) When your phone is receiving an incoming call, decline the call by saying "hang up".

Make or Take a Call and Text

MAKE A CALL:

- 1.) To make a call through ReVent Music Fan, make sure your phone is connected via Bluetooth.
- 2.) Start the call by:
 - Using the phone assistant to make the call. Try saying “Hey Siri, call Chris” or “OK Google, call Chris”
 - Manually starting the call on your phone.
- 3.) If the fan is ON when a phone call starts, it will turn OFF to make sure the quality of the microphone audio is as clear as possible. Once the call ends, the fan will automatically turn back ON.

TAKE A CALL:

- 1.) When a phone is connected via Bluetooth and receiving an incoming call, answer by saying “Pick up”, answering manually on your phone, or press the PLAY/PAUSE button on the control. To decline an incoming call, say “hang up” or decline the call manually on your phone.
- 2.) If the fan is ON when receiving an incoming call, the fan will turn OFF. Once the call ends, the fan will automatically turn back ON.

END A CALL:

- 1.) End a call on the phone by saying “Hang up”, ending the call manually on the phone, or by pressing the PLAY/PAUSE button on the wall mounted control.
- 2.) If the fan was ON when the call started, it will turn back ON when the call is over. If music was playing when the call started, it will resume when the call ends.

TEXT MESSAGES:

- 1.) Send a text message by saying “Hey Siri” or “OK Google” and wait for the chime.
- 2.) Say “Text” and then the name of the person you want to send a text message to.
- 3.) Then say the message that you want to send.
- 4.) To read your text messages say “Hey Siri” or “OK Google” and then “read my messages”. Note: You might be required to manually unlock your phone before your assistant reads your messages.

Pairing a Second Wall Mounted Control

If a second wall mounted control is needed, it can be ordered from ReVentfans.com.

You can pair it to the fan by following these easy steps:

- 1.) To connect a new control to the fan or re-pair the original control, completely turn off the power to the switch and fan using the circuit breaker.
- 2.) Turn the power back on and within 20 seconds, hold the PLAY/PAUSE button for 5 seconds.
- 3.) The status light will blink 5 times when paired successfully.

Frequently Asked Questions

(Fan)

Q: How do I clean my FAN?

A: It's important to clean the SHIELD cover from time to time. Dust particles can build up on the SHIELD. See PAGE 17 for care and cleaning instructions.

Q: What is CFM?

A: CFM is a measurement of air movement (cubic feet per minute). The higher the CFM, the more air movement.

Q: What is a sone?

A: Sone is the rating used to describe the sound level. The lower the sone the quieter the fan. A sone is not a decibel. Fans around 1 sone or less are considered quiet while fans around 2 sonas or more are considered loud.

Q: Can I install my bathroom ventilation FAN directly over a bathtub or shower?

A: Yes, but your FAN must be rated for over a shower/bath installation (all ReVent models are) and must be on a GFCI protected circuit. Consult a qualified licensed electrician about ground fault protected safety circuits.

Q: Do I have to vent my FAN to the outside?

A: Yes. All spot ventilation fans must be vented to the outside. Follow your local code and consult it for advice. See PAGE 5 for national venting installation suggestions and guidelines.

Q: Why do the windows and mirrors fog even when the FAN is running?

A: If windows and mirrors are very cold, condensation can still form on those surfaces. If the bathroom is sealed tightly, replacement air may not be entering the room fast enough to displace moist air. You need a gap under the bathroom entrance door to allow air to enter the bathroom. If your home uses 3 inch diameter ducting, upgrading the duct pipe to 4 inch diameter can greatly increase the airflow. The vent pipe length should be 10 feet or less with minimal bends (See PAGE 5). Ensure that the vent pipe is not blocked.

Q: My FAN is operating, but the air is moving slower than normal.

A: Check for obstructions in the ductwork. A common problem is debris blocking the roof cap or outside wall vent. Older homes may have 3 inch diameter ducting and changing the duct pipe to 4 inch diameter can greatly increase airflow.

Q: Why is there water dripping from my FAN?

A: Dripping water is typically condensation from a cold vent pipe. Insulating the ductwork and FAN housing can help solve condensation problems. Running the FAN longer will ensure moisture is completely removed from the duct. Another possibility is rain entering the vent pipe through the roof vent opening.

Q: I have installed my FAN and it is not working, what do I do?

A: Make sure the black and white plug-in connector on the FAN is clicked into place. Check all electrical connections like wire nuts and quick connects. Make sure the circuit breaker is turned ON after completing all the electrical work. If you have any concerns consult a licensed electrician.

Q: Why did my FAN turn off after 30 minutes?

A: The FAN has a built in 30 minute timer to automatically turn the FAN off.

Q: Why does the FAN turn off while talking on a phone call or talking to the phone's assistant?

A: The FAN turns off automatically during a phone call or during a conversation with the phone's assistant to make sure the microphones pick up the best audio quality possible. This will make phone calls crystal clear and conversations with the phone's assistant easy.

(Control)

Q: My existing switch only has two wires. How do I properly connect the CONTROL to the FAN?

A: You will need to test these wires with a voltage tester to determine which one is power and which one goes to the fan. The black wire on the CONTROL connects to the wire that is tested to be the incoming power. The red wire on the CONTROL connects to the wire that is tested and confirmed to connect to the FAN. You will need a neutral and a ground. Please refer to PAGES 18-20 for instructions on how to properly wire the CONTROL. If you have any concerns, we suggest hiring or consulting a licensed electrician.

Q: Will the CONTROL still work without a neutral wire?

A: A neutral is required to operate the CONTROL. Generally, there will be a neutral wire available in your junction box (wall box). Older homes or homes where code was not followed can make it a problem to find a neutral. If that's the case for you, then you'll need an electrical testing device to find a neutral wire. We suggest you use a qualified licensed electrician to do this work.

Q: I still have additional questions.

A: Contact us at info@reventfans.com or call our service department at (877) 543-8698. We are happy to assist you with any additional questions.

3-Year Limited Warranty

GTR Technologies Inc. (GTR) warrants to the original purchaser of its products that such products will be free from defects in materials and workmanship for a period of three years from the date of original purchase. There are no other warranties, express or implied, including but not limited to, implied warranties of merchantability or fitness for a particular purpose.

During this three-year period, GTR will, at its option, repair or replace, without charge, any product or part which is found to be defective under normal use and service. This warranty does not extend to lighting such as LED's, Fluorescent, Incandescent, tubes, starters or bulbs.

This warranty does not cover:

- (a) normal maintenance and service or
- (b) any maintenance or repair, faulty installation or installation contrary to recommended installation instructions.

The duration of any implied warranty is limited to the three-year period as specified for the express warranty. Some areas do not allow limitation on how long an implied warranty lasts, so the above limitation may not apply to you.

GTR's obligation to repair or replace, at GTR's option, shall be the purchaser's sole and exclusive remedy under this warranty. GTR shall not be liable for incidental, consequential, or special damages arising out of or in connection with product use or performance. Some areas do not allow the exclusion or limitation of incidental or consequential damages, so the above limitation may not apply to you.

This warranty gives you specific legal rights, and you may also have other rights, which vary from area to area.

This warranty supersedes all prior warranties.

This warranty is only valid inside the boundaries of the USA and Canada.

To qualify for warranty service, you must:

- (a) notify GTR via phone at 1-877-543-8698 (English) or 1-800-615-5439 (French) or via email at info@reventfans.com,
- (b) give the model number identification, and
- (c) describe the nature or any defect in the product or part.

At the time of requesting warranty service, you must provide evidence of the original purchase receipt.

GTR Technologies Inc.
www.reventfans.com

Need Help?

Watch the installation video at:
reventfans.com/install

Questions? Call
**1-877-543-8698 (English) or
1-800-615-5439 (French)**
info@reventfans.com

ReVent® is a product of GTR Technologies Inc. All rights reserved.
USA and international patents pending.
PART# RVP-123-WH-01 082521

Français

ReVent[®]

Modèles n^{os}
RVM80

Guide d'installation

Veillez lire ces instructions et les conserver.

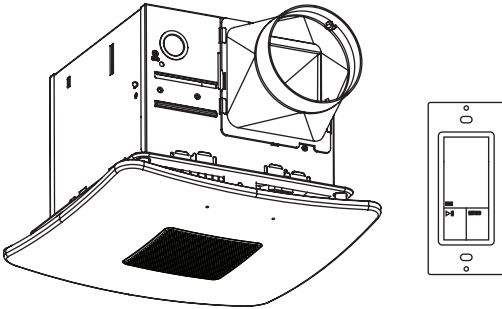

Avez-vous besoin d'aide?

Regardez la vidéo d'installation à :
reventfans.com/install

Avez-vous des questions?
Téléphonez au 1 800 615-5439 (français)
ou au 1 877 543-8698 (anglais).

Veillez lire ces instructions et les conserver.

Table des matières

page 1	Table des matières
page 1	Fiche technique
page 2	Contenu de la boîte
page 3-4	Consignes de sécurité
page 4-5	Planification de l'installation
page 5	Branchement du conduit
page 6	Retrait du ventilateur existant
page 7-12	Installation facile à même la pièce SheetLockMC
page 12-17	Installation sur la charpente d'une nouvelle construction
page 17	Entretien et nettoyage
page 18-20	Installation de la commande
page 20-21	Utilisation de la commande
page 21	Connexion au haut-parleur Bluetooth
page 22	Utilisation de l'assistant du téléphone
page 22	Commande vocale
page 22-23	Faire ou recevoir un appel/texto
page 23	Couplage d'une deuxième commande murale
page 24-25	Foire aux questions
page 26	Garantie limitée de 3 ans

Fiche technique

RVM80

performances avec conduits de 4 po

Pression statique (po d'eau)	Débit d'air (pi ³ /min)	Niveau de bruit (sone)	Consommation d'énergie (watts)	Format du conduit
*0,1	80	0,9	21	4 po

* certifié par HVI

Tension	120 V
Fréquence	60 Hz
Poids du ventilateur	7,8 lb (3,54 kg)
Dimensions de le déflecteur	11 x 11 po (27,9 x 27,9 cm)
Longueur du boîtier*	8 ³ / ₈ po (21,3 cm)
Largeur du boîtier*	7 ⁷ / ₈ po (20 cm)
Profondeur du boîtier*	6 ³ / ₈ po (16,2 cm)

* Une modification de l'ouverture existante pourrait être nécessaire.
Certains outils à main sont requis. Des outils électriques pourraient également être requis.

Contenu de la boîte

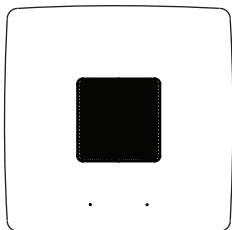

DÉFLECTEUR
Qté : 1

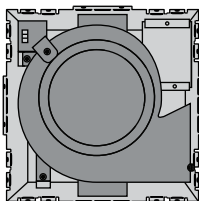

VENTILATEUR
Qté : 1

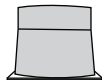

4 PO REGISTRE
Qté : 1

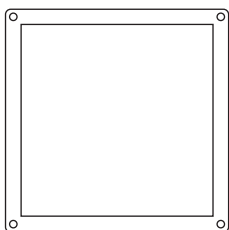

GARNITURE
DÉCORATIVE
Qté : 1

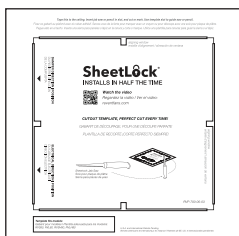

GABARIT
Qté : 1



MANUEL
Qté : 1

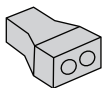

RACCORD
RAPIDE
À 2 FILS
Qté : 2

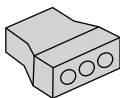

RACCORD
RAPIDE
À 3 FILS
Qté : 1



COMMANDE
Qté : 1

POUR UNE NOUVELLE CONSTRUCTION SEULEMENT



VIS À BOIS À
TÊTE RONDE
Qté : 6



VIS DE FIXATION DE
SUPPORT 3/8 PO N° 8
Qté : 3



SUPPORT LONG
Qté : 1

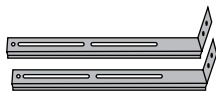

SUPPORT COURT
Qté : 2

Consignes de sécurité

1) AVERTISSEMENT : AFIN DE RÉDUIRE LES RISQUES D'INCENDIE, DE DÉCHARGE ÉLECTRIQUE OU DE BLESSURES, VEUILLEZ RESPECTER CES CONSIGNES :

- a) Les travaux d'installation et de câblage électrique doivent être réalisés par une personne qualifiée selon tous les codes et les normes applicables, y compris pour la résistance au feu.
 - b) Il doit y avoir un apport d'air suffisant pour une combustion et une évacuation des gaz appropriés par le conduit (la cheminée) provenant de l'équipement à combustible afin d'éviter une contre-explosion. Respectez les directives et les consignes de sécurité de tout équipement de chauffage telles que celles émises par la NFPA (National Fire Protection Association), l'ASHRAE (American Society for Heating, Refrigeration and Air Conditioning Engineers) et les autorités locales.
 - c) Au moment de découper ou de percer un mur ou un plafond, évitez d'endommager le câblage électrique et les autres composants dissimulés.
 - d) Les ventilateurs reliés à des conduits doivent toujours être aérés vers l'extérieur.
 - e) Si ce dispositif est installé au-dessus d'une baignoire ou d'une douche, il doit être identifié adéquatement et relié à un DDFT (disjoncteur différentiel de fuite à la terre) sur un circuit de dérivation.
- 2) Utilisez ce dispositif uniquement aux fins prévues par le fabricant. Pour toute question, communiquez avec le fabricant.
 - 3) Avant d'entretenir ou de nettoyer ce dispositif, coupez le courant au panneau d'alimentation et verrouillez le dispositif de débranchement pour éviter que le courant soit remis accidentellement. Si le dispositif de débranchement ne peut pas être verrouillé, apposez bien en vue un avertissement à cet effet au panneau d'alimentation.
 - 4) Ce ventilateur d'aération est approuvé pour un usage au-dessus d'une baignoire ou d'une douche lorsqu'il est relié à un circuit à DDFT. N'utilisez aucun ventilateur non approuvé pour une telle utilisation au-dessus d'une baignoire ou d'une douche.
 - 5) Installez les conduits en ligne droite avec un minimum de coudes.
 - 6) Utilisez une alimentation électrique de 120 V et de 60 Hz avec une mise à la terre adéquate. Respectez tous les codes locaux de sécurité et d'électricité.
 - 7) N'utilisez pas ce ventilateur avec un dispositif de commande à semi-conducteur comme un gradateur. Les commandes à semi-conducteur peuvent causer de la distorsion harmonique pouvant entraîner un bourdonnement du moteur, en plus d'augmenter les risques d'incendie ou de décharge électrique.
 - 8) Afin de réduire les risques d'incendie ou de décharge électrique, n'obstruez pas le déflecteur d'admission d'air.
 - 9) Montez ce dispositif de sorte que sa pièce mobile la plus basse se trouve à un minimum de 8,2 pi (2,5 m) du niveau du sol.
 - 10) **Ne placez** jamais un interrupteur à un endroit où on pourrait l'atteindre à partir de la baignoire ou de la douche.
 - 11) Ce dispositif ne doit pas être installé sur un plafond dont l'isolation thermique est supérieure à R40. (Cet avertissement est requis pour l'installation au Canada seulement.)
 - 12) Usage non destiné à une zone de cuisson (voir la PAGE 5 pour les détails).
 - 13) Ce dispositif doit être relié adéquatement au conducteur de mise à la terre du circuit d'alimentation.

Respectez les directives et les consignes de sécurité de tout équipement de chauffage telles que celles émises par la NFPA (National Fire Protection Association), l'ASHRAE (American Society for Heating, Refrigeration and Air Conditioning Engineers) et les autorités locales.



AVERTISSEMENT : Ne convient pas à une utilisation en tant que hotte de cuisine.



ATTENTION : Pour ventilation générale seulement. Ne pas utiliser pour évacuer des matières ou des vapeurs dangereuses ou explosives.





ATTENTION : Ne pas installer à un endroit où la température peut excéder 104 °F (40 °C).



IMPORTANT : Faites attention de ne pas endommager le câblage existant au moment de découper ou de percer les murs ou les plafonds.

 **REMARQUE** : Assurez-vous de ne pas réduire le format des conduits par rapport à la sortie d'évacuation. Le fait de réduire le format des conduits risque d'augmenter le niveau de bruit du ventilateur.

 **IMPORTANT** : Il pourrait être approprié de consulter un électricien qualifié à propos du câblage du ventilateur d'aération.

 **AVERTISSEMENT** : Afin de réduire les risques de décharge électrique, débranchez l'alimentation électrique avant de faire l'entretien.

 **ATTENTION** : Cet article doit être mis à la terre adéquatement.

Allez à reventfans.com pour obtenir une copie de ce guide.

Planification de l'installation

Pour installer le ventilateur d'aération dans une nouvelle construction, installez le boîtier du VENTILATEUR et les conduits durant la phase brute de construction. Le DÉFLECTEUR doit être installée une fois que le plafond fini est en place.

Pour installer le ventilateur d'aération dans un bâtiment existant, utilisez le GABARIT de découpage fourni pour le plafond. Le rebord de le DÉFLECTEUR doit chevaucher le plafond fini.

Usage non destiné à une zone de cuisson – Voir le schéma ci-dessous.

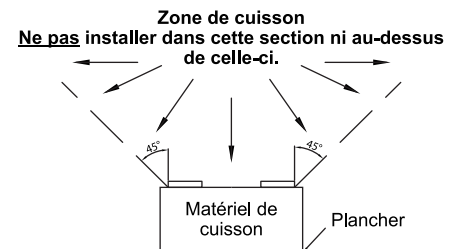

N'installez pas le ventilateur d'aération à un endroit qui nécessitera des conduits comme le montrent les illustrations ci-dessous.

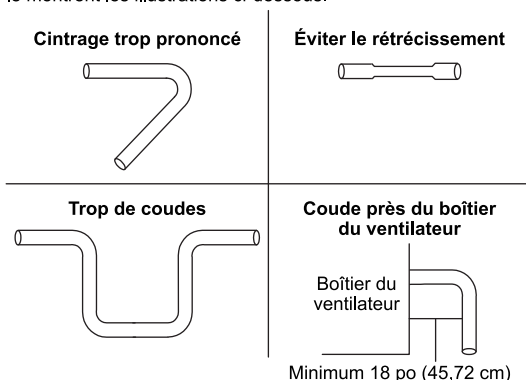

 **Remarque** : Pour installer le ventilateur d'aération dans un bâtiment existant, vous aurez peut-être besoin d'espace au-dessus et au-dessous du lieu d'installation.