



### About this Manual

This is the quick start manual for your TransmitR lighting system. Check for updates at [bontrager.com](http://bontrager.com).



# Welcome.

BT16\_I0N800RT\_FLARERT\_QSG\_V1

## TRANSMITR Quick Start Manual

This manual gives basic instructions on the installation and use of the Bontrager TransmitR lighting system, which is ANT+ compatible. For the complete manual, check our web site [trekbikes.com](http://trekbikes.com)

The full manual includes this additional information:

- Pairing
- Manual operation
- Listing of all modes, run times
- Troubleshooting
- Battery types (and installation in Remote)
- Turn signal and high beam headlight function
- Recycling and disposal
- Compliance info
- Warranty

**IMPORTANT:** Check your local lighting laws. Flashing lights and full brightness may not be allowed in all locations. Ion 800 RT and Flare RT do not conform to the German road traffic regulation StVZO.

### “To See” light

The Ion 800 RT is a “To See” light, a headlight for primary vision when riding in low light. It can also function as a “To Be Seen” light when in flash mode, although the amber side lenses do not direct a substantial amount of light. Note that for best results, a rider should employ BOTH a To See light and a To Be Seen light.

## SETUP

### Pairing the TransmitR Remote to TransmitR Lights

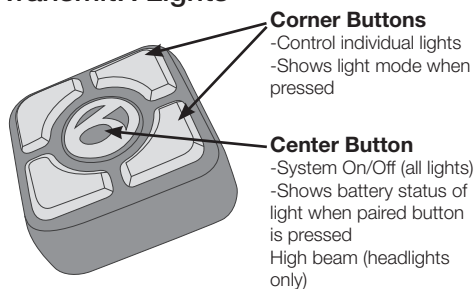

**1.** For each light to be paired, quick-press the power button on the light, then press and hold the power button to turn off.

**NOTE:** If you purchased the TransmitR Wireless Light Set, [Part Number 503063] with the Ion 800RT, Flare RT and TransmitR Remote in one package, skip ahead to section ‘Using the TransmitR Remote’

**2.** Place all TransmitR lights to be paired within 15cm/6 inches of the remote.

**3.** Press and hold the center button on the remote for 8 seconds until the corner buttons begin flashing.

The remote will find a TransmitR light and the light will begin flashing. At the same time, the center button on the remote will turn from red to green, signifying a connection.

**4.** Press the corner button on the remote that you would like to have paired to the light. The light will stop flashing when it has been paired to the remote. The center button will change back to red and search for additional lights to pair.

**5.** If the remote locates another light, repeat step 4.

**6.** When all TransmitR lights (up to seven) have been paired, press the center button of the remote to exit pairing. It will turn from red to OFF.

Your TransmitR system is now paired and ready for use.

## USING THE TRANSMITR REMOTE Controlling Lights with the TransmitR Remote

### To turn on all lights

ON: Quick-press the center button.

OFF: Press and hold the center button.

### To turn on an individual light

ON: Quick-press the corner button that controls the light.

OFF: Press and hold the same button.

### To change modes of an individual light

Each quick-press of a button that controls a light will cycle through the modes.

**Trail Configuration** enables the Ion 800 RT to toggle between 800 and 450 lumen steady modes. To enable and disable press and hold the power button for 8 seconds with the light off. The main LED will flash once indicating trail configuration has been enabled/disabled.

### Seeing Battery Power Status of the light on the Remote

When a corner button is pressed, the center button will show the battery status of the light

Button light color	Power remaining
Green	More than 25%
Red	Between 5% and 25%
Blinking red	Less than 5%

## CAUTION

The light may be hot to touch.

## CHARGING THE LIGHT

Locate and open the USB cover and insert the Micro USB charging cable. The light can charge from a wall USB or laptop USB source.

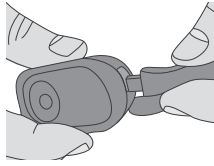

Flare RT

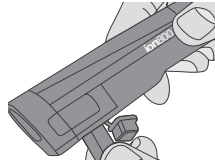

Ion 800 RT

**IMPORTANT:** Ensure USB cover is latched before riding in the rain or in wet conditions. If USB cover is not closed, damage to the light may occur.

## Installing the remote on the bike

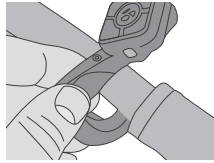

Put the remote bracket over the bar

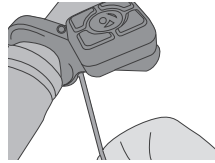

Use a 2.5mm hex wrench to tighten

**Note:** Use the adapter ring if installing on a bar with a 22.2mm diameter

## LIGHT MOUNTING OPTIONS

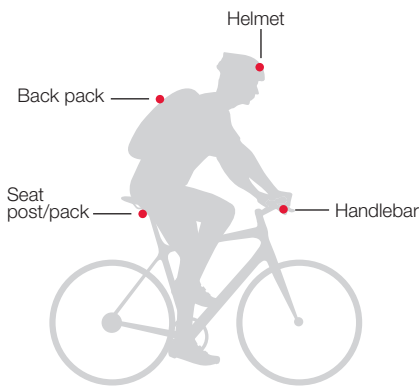

## INSTALLING THE ION 800 RT

The Ion 800 RT can be mounted on a handlebar as well as on select Bontrager helmets with Blendr integrated light mount (or for other helmets, using the Bontrager Universal Helmet Bracket.)

## INSTALLING THE FLARE RT

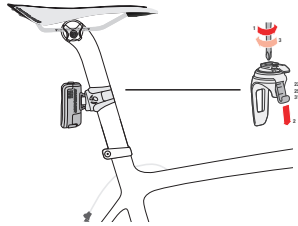

The Sync Bracket should be installed with the hook on the non-drive side of the bike. The mount should be rotated so that the light is perpendicular to the ground plane as shown. The Flare RT can also be mounted on a seat pack or backpack using the included clip.

**IMPORTANT:** Ensure the light's lens is oriented perpendicular to the ground to optimize visibility.

## If you have questions

If after reading this manual you have additional questions, contact your dealer or the technical support team:

Bontrager Attn: Customer Service  
801 W. Madison Street  
Waterloo, Wisconsin 53594  
920.478.4678 [www.bontrager.com](http://www.bontrager.com)

## ⚠ WARNING

A bicycle without correct lights and reflectors might be difficult for other people to see, and you might not be able to see. If you can not see, or other people can not see you, you could have an accident. Make sure your lights operate correctly and that batteries are charged.

## Statements of Regulatory Compliance

### FCC Compliance

**TransmitR Remote** - FCC ID: 04GTRMTE  
**Ion 800 RT Head Light** - FCC ID: 2AHXDC97371576  
**Flare RT Tail Light** - FCC ID: 2ADH7Q97371576  
This device complies with part 15 of the FCC Rules. Operation is subject to the following conditions:  
(1) this device may not cause harmful interference, and (2) this device must accept any interference received, including interference that may cause undesired operation.

**NOTE:** This equipment has been tested and found to comply with the limits for a Class B digital device, pursuant to Part 15 of the FCC Rules. These limits are designed to provide reasonable protection against harmful interference in a residential installation. This equipment generates uses and can radiate radio frequency energy and, if not installed and used in accordance with the instructions, may cause harmful interference to radio communications. However, there is no guarantee that interference will not occur in a particular installation.

If this equipment does cause harmful interference to radio or television reception, which can be determined by turning the equipment off and on, the user is encouraged to try to correct the interference by one or more of the following measures:  
-- Reorient or relocate the receiving antenna.  
-- Increase the separation between the equipment and receiver.  
-- Connect the equipment into an outlet on a circuit different from that to which the receiver is connected.  
-- Consult the dealer or experienced radio / TV technician for help.

### NOTES:

THE MANUFACTURER IS NOT RESPONSIBLE FOR ANY RADIO OR TV INTERFERENCE CAUSED BY UNAUTHORIZED MODIFICATIONS TO THIS EQUIPMENT. ANY CHANGES OR MODIFICATIONS NOT EXPRESSLY APPROVED BY THE MANUFACTURER OF THIS DEVICE COULD VOID THE USER'S AUTHORITY TO OPERATE THE DEVICE.

### Industry Canada Compliance

**Bontrager TransmitR Remote** - (P/N 502865),  
CAN ICES-3(B)/NMB-3(B) IC: 7666A-REMOTE  
**Bontrager Ion 800 RT Head Light** - (P/N 538885),  
CAN ICES-3(B)/NMB-3(B) IC: 21334-C97371576  
**Bontrager Flare RT Tail Light** - (P/N 438818),  
CAN ICES-3(B)/NMB-3(B) IC: 12468A-Q97371576  
This device complies with Industry Canada license-exempt RSS standard(s). Operation is subject to the following two conditions:  
(1) this device may not cause interference, and (2) this device must accept any interference, including interference that may cause undesired operation of the device.

Le présent appareil est conforme aux CNR d'Industrie Canada applicable aux appareils radio. Exempt de licence. L'exploitation est autorisée aux deux conditions suivantes: (1) l'appareil ne doit pas produire de brouillage, et (2) l'utilisateur de l'appareil doit accepter tout brouillage radioélectrique subi, même si le brouillage est susceptible d'en compromettre le fonctionnement.

This Bontrager TransmitR equipment complies with FCC and IC radiation exposure limits set forth for an uncontrolled environment. The radiated output power of the TransmitR Wireless Device is below the Industry Canada (IC) radio frequency exposure limits. This equipment is in direct contact with the body of the user under normal operating conditions. This transmitter must not be co-located or operating in conjunction with any other antenna or transmitter.

Status of the listing in the Industry Canada's REL (Radio Equipment List) can be found at the following web address:  
<http://www.ic.gc.ca/app/sitt/relet/srch/nwRdSrch.do?lang=eng>

Additional Canadian information on RF exposure also can be found at the following web address:  
<http://www.ic.gc.ca/eic/site/smt-gst.nsf/eng/sf08792.html>

Cet appareil est conforme aux limites d'exposition à la fréquence radio (FR) d'IC et de FCC. La puissance de sortie émise par l'appareil de sans fil TransmitR est inférieure à la limite d'exposition aux fréquences radio d'Industrie Canada (IC). Cet appareil est en contact direct avec l'utilisateur dans des conditions normales d'utilisation. L'émetteur ne doit pas être co-implémenté ou utilisé conjointement avec une autre antenne ou un autre émetteur.

Ce périphérique est homologué pour l'utilisation au Canada. Pour consulter l'entrée correspondant à l'appareil dans la liste d'équipement radio (REL - Radio Equipment List) d'Industrie Canada rendez-vous sur:  
<http://www.ic.gc.ca/app/sitt/relet/srch/nwRdSrch.do?lang=fra>

Pour des informations supplémentaires concernant l'exposition aux RF au Canada rendez-vous sur:  
<http://www.ic.gc.ca/eic/site/smt-gst.nsf/eng/sf08792.html>