

VIMBLE ONE

Foldable Smartphone Gimbal

Quick Start Guide

EN V.1.1

Overview

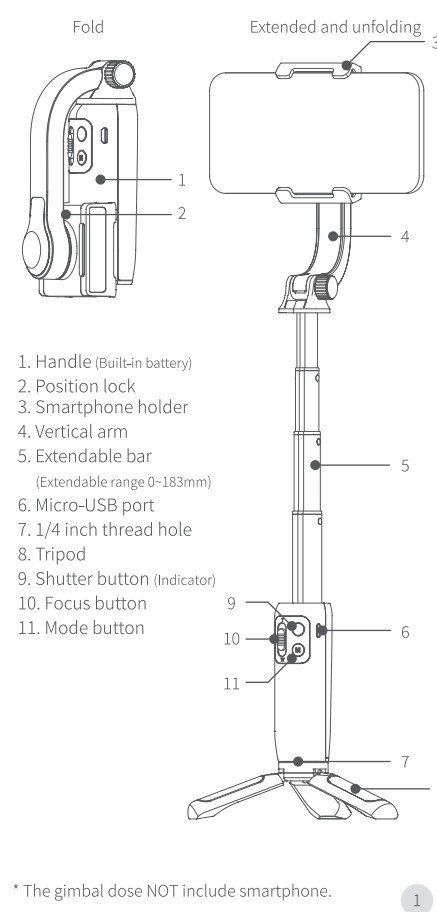

1. Handle (built-in battery)
2. Position lock
3. Smartphone holder
4. Vertical arm
5. Extendable bar (Extendable range 0-183mm)
6. Micro-USB port
7. 1/4 inch thread hole
8. Tripod
9. Shutter button (indicator)
10. Focus button
11. Mode button

* The gimbal does NOT include smartphone.

Download the Feiyu ON App

Scan the QR code to download the app, or search for "Feiyu ON" in the App Store or Google Play. Watch tutorials in video skill page on Feiyu ON.

* Requires iOS 9.0 or above, Android 6.0 or above.



Tutorial

The tutorial videos can be watched at FeiyuTech official website or scan the QR code. <https://www.feiyu-tech.com/play/>



TIPS

- (1) Unlock position lock before powering on the gimbal.
- (2) Please fully charge gimbal before power on for the first time.
- (3) Install smartphone in landscape mode.
- (4) If the power is too low, the indicator will flash red for three times every five seconds. It is recommended to charge it immediately.
- (5) When not in use for a long time, please turn off the gimbal.

Unfold and fold

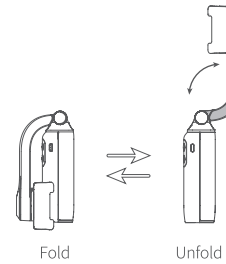

Unlock and Lock

There is a position lock behind smartphone holder, rotate it with a little strength to unlock. Rotate it in the reverse direction to lock.

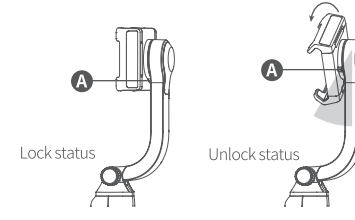

Charging

When charging with Micro-USB cable, indicator keeps solid red. When fully charged, the indicator keeps solid green.

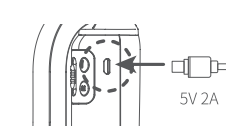

Smartphone Installation

It is recommended to remove the smartphone case before installation. Keep the logo of the smartphone holder upward. Keep the smartphone holder in center. If the smartphone tilts after installed the smartphone, please slide the smartphone to left or right to balance.

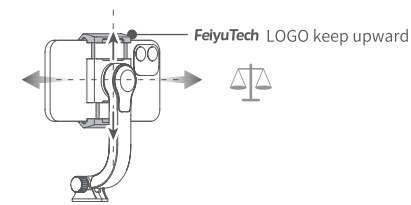

Extend and Reset the Handle

- (1) Hold the handle with one hand, hold upper grip with other hand.
- (2) Extending: Pull the extendable bar out to suitable length (Extendable range 0-183mm). Reset: Push upper grip to make the extendable bar down to handle part.

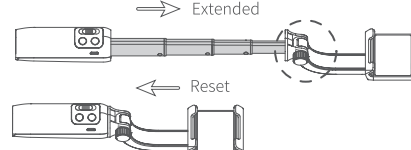

Bluetooth Connection

Turn on the gimbal. Method one: Download and install Feiyu ON App, run the App, follow the prompts to turn on and connect with the bluetooth. Method two: Turn on the smartphone bluetooth, Connect the gimbal bluetooth in the setting of phone, e.g. FV_VB01_xx. (If the bluetooth can't be found, please turn off Feiyu ON App in the background.)

Common Operation

- 1. Shutter Button**
Single tap: Take photo/video
Long press: Switch between video/photo mode
Double tap: Switch the front and rear camera

Indicator:

Power on	Green light changes to blue
Power off	Red light turn off
Normal working status	Constant blue light
Red light flashes three times	Low power
Red light keeps flashing	Low power and then power off
Green light flashes twice	Bluetooth connected
Constant green light	Fully charged
Constant red light	Charging (other status are not indicated)

2. Mode Button

TIP: Unlock the position lock before powering on the gimbal.

Single tap: Roll follow mode

Long press: **Power On/Off**

Double tap: Switch between landscape and portrait mode

- 2.1 Roll Follow Mode**
Single tap function button then the smartphone moves according to the movements of the handle.

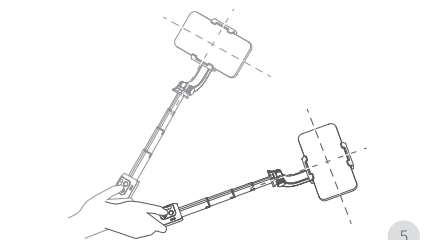

2.2 Power On/Off

Long time press the function button and release it when you hear the tone.

- 2.3 Landscape & Portrait Mode Switching**
Double click the function button or manually rotate the smartphone holder (according to the picture below) to switch between landscape and portrait mode. Tap again to quit.

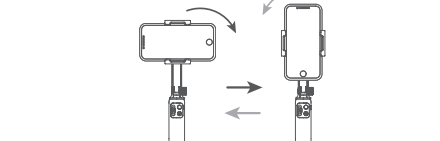

Kindly Reminder:
Do not make anti-clockwise rotation in landscape mode. Do not make clockwise rotation in portrait mode.

3. Focus Button

Slide up and down to adjust focus. Slide up (T direction): Zoom in. Slide down (W direction): Zoom out

■ Tripod

The tripod is connected to the bottom of the main unit in a rotating manner. According to the needs of shooting and storage, choose whether to install it.

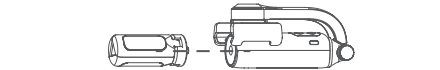

■ Specifications

Roll Range: 323°
Theoretical Battery Life: 6h (For different smartphone you installed, it's slightly different)
Net gimbal Weight: 186g (Not including tripod)
Payload: 250g (Well-balanced)
Adapter Smartphones: iPhone and Android phones (The width of the phone is between 41-89mm)

Disclaimer

Thanks for using Feiyu Gimbal. The information in this document affects your safety and your legal rights and responsibilities. Read the entire document carefully to ensure proper configuration before use. Failure to read and follow instructions and warnings in this document may result in serious injury to yourself or others, or damage to your products or damage to other objects in the vicinity.

Thanks for using Feiyu Gimbal. The information in this document affects your safety and your legal rights and responsibilities. Read the entire document carefully to ensure proper configuration before use. Failure to read and follow instructions and warnings in this document may result in serious injury to yourself or others, or damage to your products or damage to other objects in the vicinity.

FeiyuTech will not provide any service for any product obtained from abnormal channels.

Notice

1. Make sure motor spinning is not blocked by external force when gimbal is power on.
2. DO NOT contact the gimbal with water or other liquid if the gimbal is not mark waterproof or splash-proof. Waterproof and splash-proof product DO NOT contact sea water or other corrosive liquid.
3. DO NOT disassemble the gimbal except marked detachable. It need send to FeiyuTech after-sales or authorized service center to fix it if you accidently disassemble it and cause abnormal work. The relevant costs are borne by user.
4. Prolonged continuous operation may cause the motor surface temperature to rise, please operate carefully.
5. DO NOT drop or strike the gimbal. If the battery is abnormal, contact Feiyu After-sales support.

Storage and Maintenance

1. Keep the gimbal out of the reach of children and pets.
2. DO NOT leave the gimbal near heat sources such as a furnace or heater. DO NOT leave the gimbal inside of a vehicle on hot days.
3. Please storage the gimbal in dry environment.
4. DO NOT overcharge or overuse the battery, otherwise it will cause damage to the battery core.
5. Never use the gimbal when the temperature is too high or too low.

This device complies with part 15 of the FCC Rules. Operation is subject to the condition that this device does not cause harmful interference (1) this device may not cause harmful interference, and (2) this device must accept any interference received, including interference that may cause undesired operation.

Changes or modifications not expressly approved by the party responsible for compliance could void the user's authority to operate the equipment. NOTE: This equipment has been tested and found to comply with the limits for a Class B digital device, pursuant to Part 15 of the FCC Rules. These limits are designed to provide reasonable protection against harmful interference in a residential installation. This equipment generates, uses and can radiate radio frequency energy and, if not installed and used in accordance with the instructions, may cause harmful interference to radio communications. However, there is no guarantee that interference will not occur in a particular installation. If this equipment does cause harmful interference to radio or television reception, which can be determined by turning the equipment off and on, the user is encouraged to try to correct the interference by one or more of the following measures:
-- Reorient or relocate the receiving antenna.
-- Increase the separation between the equipment and receiver.
-- Connect the equipment into an outlet on a circuit different from that to which the receiver is connected.
-- Consult the dealer or an experienced radio/TV technician for help. The device has been evaluated to meet general RF exposure requirement. The device can be used in portable exposure condition without restriction.

Guilin Feiyu Technology Incorporated Company

For more information, please visit our official website www.feiyu-tech.com
E-mail: service@feiyu-tech.com Tel: +86 773 2320865

Due to software and hardware improvements, your actual product might differ from the descriptions and pictures in this user manual. You can get the latest user manual from the official website.

VIMBLE ONE

可折叠手机稳定器

快速入门

CN V.1.1

产品概览

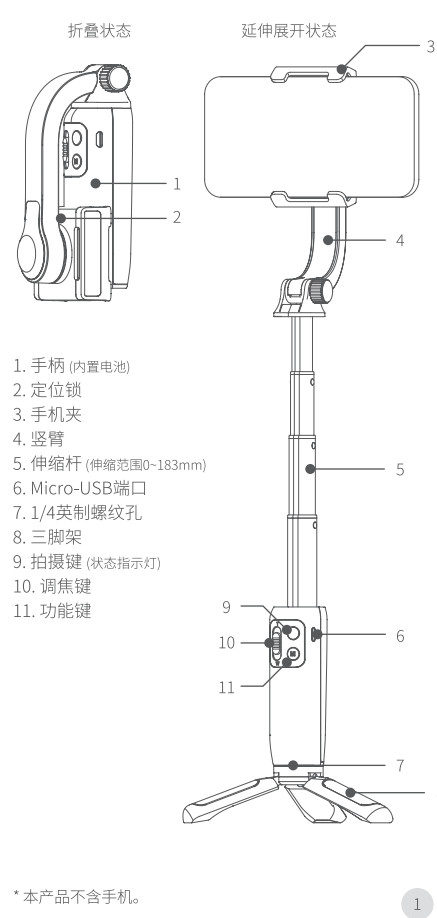

1. 手柄 (内置电池)
2. 定位锁
3. 手机夹
4. 竖臂
5. 伸缩杆 (伸缩范围0-183mm)
6. Micro-USB端口
7. 1/4英寸螺纹孔
8. 三脚架
9. 拍摄键 (状态指示灯)
10. 调焦键
11. 功能键

* 本产品不含手机。

下载安装 Feiyu ON App

扫描二维码或在应用商店搜索“Feiyu ON”下载。可在Feiyu ON App-技巧页面查看教学视频。

* 系统要求: iOS 9.0或更高版本, Android 6.0或更高版本
* Android版本请使用浏览器扫描二维码下载



教程

可在飞宇官网 <https://www.feiyu-tech.cn/play/> 观看教学视频或扫描二维码前往。



使用提示

- (1) 开机使用前, 请务必解锁定位锁。
- (2) 首次使用时, 请务必给稳定器充满电。
- (3) 安装手机时请手机横屏安装。
- (4) 若电量过低, 状态灯将每隔5秒红灯3闪, 请尽快充电。
- (5) 当长时间不使用时, 请关闭电源。

折叠/展开

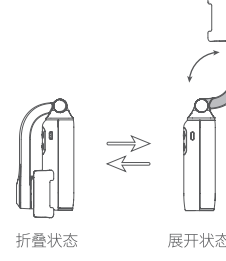

解锁/锁定

手机夹后方设有定位锁, 稍微施力即可使卡位偏离解锁。反之可锁定。

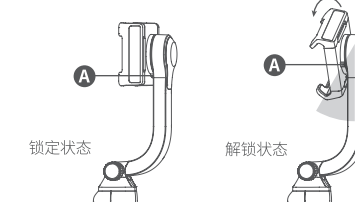

充电

采用Micro-USB数据线充电, 充电时状态指示灯为红灯, 充满电为绿灯常亮。

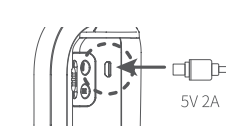

安装手机

安装前建议取下手机保护套。拉开手机夹具, 将手机左右居中置入。若手机倾斜, 可在右移动手机至水平。

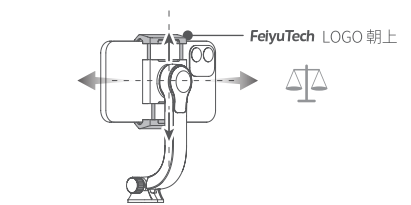

伸缩杆的使用

- (1) 机身展开后, 一手握住手柄, 一手握住竖臂部分。
- (2) 拉伸: 施力将伸缩杆拉出到适合长度 (伸缩范围0-183mm)。还原: 施力使竖臂下端与手柄上端贴合。

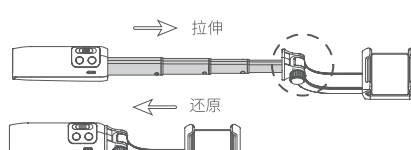

蓝牙连接

开启稳定器。
方法一: 下载安装Feiyu ON App, 打开App, 按提示开启蓝牙并连上App。
方法二: 手机设置打开蓝牙。连接稳定器蓝牙, 如 FV_VB01_xx。(如搜不到, 请后关闭Feiyu ON App)

功能操作

1. 拍摄键

单击: 拍照/录像
长按: 切换拍照/录像
双击: 切换手机前后摄像头

· 指示灯状态

开机	绿灯常亮蓝灯
关机	红灯常亮熄灭
正常工作状态	蓝灯常亮
红灯3闪	低电量提示
绿灯3闪	低电量提示
绿灯5闪	手机App蓝牙连接成功
绿色常亮	电量充满状态
红灯常亮	充电中(此时其它状态不提示)

2. 功能键

单击: 换模式
长按: **开/关机**
双击: 横竖切换

2.1 换模式

单击功能键, 手机跟随手柄转动。



2.2 开/关机

长按功能键, 听到提示音后松开。

2.3 横竖切换

双击功能键或手动转动手机夹具, 可切换横拍/竖拍。再次单击可退出。

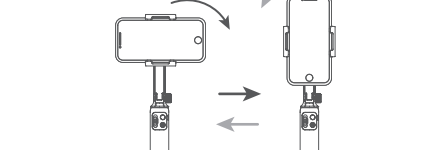

*手动转动时请注意, 横拍时手机不可再逆时针转动, 竖拍时手机不可再顺时针转动。

3. 调焦键

上下拨动可控制手机的相机调焦。上推 (T方向): 近焦效果。下推 (W方向): 远焦效果

■ 三脚架

三脚架与主机底部以旋转方式连接, 根据拍摄和收纳的需要, 选择安装。

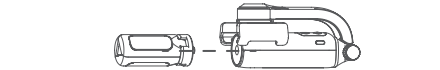

■ 参数

横滚角度: 323°
续航时间: 6小时 (根据搭载手机, 时长略有浮动)
产品重量: 186g (不含三脚架)
最大载重: 250g (重心平衡状态下)
适配手机: iPhone系列及Android系列手机 (宽度41-89mm)

免责声明:

感谢您使用飞宇稳定器。本文所提及的内容关系到您的安全、合法权益及责任, 请务必认真阅读, 以及按照指导正确设置和使用本产品。不按本文的说明和警告来操作, 可能会给您和周围的人带来伤害, 损坏本产品或周围产品。

禁止任何用户的任何非法用途。用户将为购买和使用产品的一切行为负责。对于本产品, 本公司不承担终端客户对本产品所有调试和使用当中的风险和责任 (包括直接间接或者第三方的损失)。我公司对于任何从非正常渠道获得或不明确用途的产品, 将不予任何服务。

注意:

1. 确保稳定器开启及关闭后, 电机转动不受外力阻挡。
2. 请勿将稳定器接触到水或其他液体。
3. 请勿拆卸稳定器整机, 如不慎拆开导致工作异常, 请寄回重新调试。由此产生的费用全部由客户承担。
4. 长时间持续工作可能导致电机表面温度升高, 请谨慎操作。
5. 严禁摔落或碰撞, 摔落或碰撞稳定器有可能使其损坏, 导致工作异常。如出现摔落或碰撞导致工作异常, 请及时联系客服。

存储和维护:

1. 请将本产品存放在儿童及宠物接触不到的地方。
2. 禁止将本产品放在靠近热源 (火炉或加热器等) 的地方以及将置于热热的汽车内。
3. 请在干燥的环境中存储。
4. 切勿过充、过放电池, 否则将对电池造成损害。
5. 切勿在高温或过低的环境下使用本产品。

售后服务卡 / Warranty Card

产品型号 Product Model	
序列号 Serial Number	
购买日期 Purchase Date	
客户姓名 Customer Name	
客户电话 Customer Tel	
客户邮箱 Customer Email	

保修范围:
(1) 自购买之日起, 产品在正常使用情况下出现非人为的故障。
(2) 无擅自改装或加装产品, 其它人为引起的故障。
(3) 因不可抗力造成损坏, 如: 火灾、水灾、地震、海啸、台风、雷电、战争等。

以下情况不在保修范围内:
(1) 非正常使用造成的损坏。
(2) 人为或不可抗力造成的损坏。
(3) 未经授权私自拆卸、改装、维修、更换零件。
更多保修细则以售后政策为准: <https://www.feiyu-tech.cn/service.html>
* 本公司保留对上述条款和限制进行最终解释权的权利。

Warranty:
(1) Within one year from the date of selling, the product is malfunctioning under normal due to non-artificial reasons.
(2) The malfunction of the product is not caused by artificial reasons such as unauthorized disassemble or conversion or addition.
(3) The buyer is able to provide the certificate of maintenance service: the warranty card, the legitimate receipts, invoices, or screenshot of purchasing.

The followings cases are not included under the warranty:
(1) Unable to provide legitimate receipt and warranty card with buyer's info.
(2) The damage caused by human or irresistible factor.
More details about after-sales policy, please refer to after-sales page on website: <https://www.feiyu-tech.com/service.html>
* Our company reserves the right of final interpretation on the above-mentioned after sales terms and limitations.

