

# AK4000

3-Axis Stabilized Handheld Gimbal for Camera

## Quick Start Guide

EN V1.0

## AK4000 Overview

**Touch Display (Home page)**

Please download and refer to the detailed manual for other interface and specific operation

**Mode Button**

Switch among multiple working modes  
Please download and refer to the detailed manual for specific operation

**Camera Button**

Control the photographing  
Need to connect to the shutter release cable or the camera WiFi (for Camera with WiFi function)  
Please download and refer to the detailed manual for specific operation

**Joystick**

**Video Button**

Control the shooting  
Need to connect to the shutter release cable or the camera WiFi (for Camera with WiFi function)  
Please download and refer to the detailed manual for specific operation

**Shortcut Button**

Quick access to multiple modes  
Please download and refer to the detailed manual for specific operation

**Accessories**

- Follow Focus System X1
- Stable and Extension Support of Tilting Axis X1
- Micro USB Cable X1
- 18650 Li-ion Battery X4
- Shutter Release Cable for Sony Cameras (3.5 audio to multi) X1
- Extension Rod X1
- Shutter Release Cable for Canon Cameras (RS-80N3) X1
- Tripod X1
- Shutter Release Cable for Panasonic Cameras (Shift audio 3.5 to 2.5) X1
- Charger X1
- Thumb Screw (Short) X1

\* This product does not include the camera shown.  
\* Scan QR codes to download detailed manual for more usage of the gimbal.



AK4000 Detailed Manual



AK4000 How to Use

## User Guide

- TIPS**
- Please mount the camera before powering on the gimbal.
  - When the battery is low, please charge the gimbal.
  - When not in use, turn off the gimbal and then remove the batteries.

### 1 Charge the Batteries

Please fully charge the batteries before powering on the gimbal for the first time. Charge the batteries with the charger.

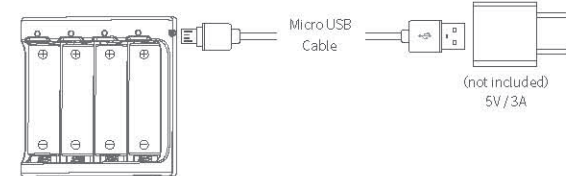

### 2 Install the Batteries

Remove the tail cap, open the batteries compartment, and install the batteries correctly.

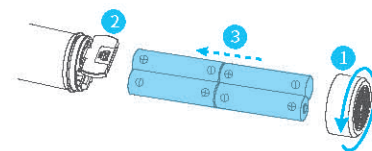

Battery Model:  
18650 Li-ion Battery

### 3 Mount the Camera

Lock the camera with the thumb screw from the bottom slot of the quick release plate, use the screw to lock the lens support frame bracket on the quick release plate and fix the camera lens, press and hold the anti-column, then place the quick release plate on the slide plate, tighten the fixed screw and safety lock.

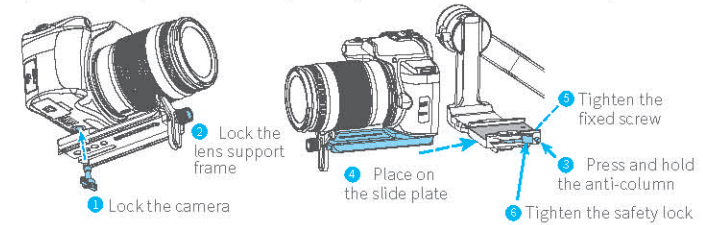

### 4 Balance the Gimbal (Before power on)

Slightly adjust the positions of quick release plate, sliding arm, cross arm and vertical arm, power on the gimbal after the center of gravity of 3 axis is balanced. Please download and refer to the detailed manual for specific operation.

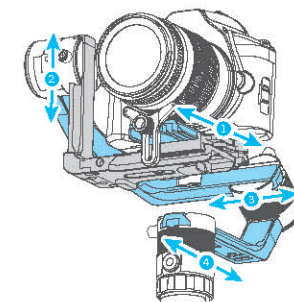

- Steps**
- Quick Release Plate
  - Sliding Arm
  - Cross Arm
  - Vertical Arm

### 5 Power on / off

Long press the power button, the display will show **HF** and release it when you hear the beep tone.

## Download and Install Feiyu ON App

\* Requires iOS 9.0 or later, Android 5.0 or later



iOS Version



Android Version

## Specifications

Max. Tilting Range	230°
Max. Rolling Range	360°
Max. Panning Range	360°
Tilting Speed	2°/s ~ 75°/s
Panning Speed	3°/s ~ 150°/s
Operation Time	12 Hours
Weight	About 1436g (not including the batteries)
Payload	4000g (In center of gravity balanced state)
Adapter Camera	Some of the camera like Canon, SONY, Panasonic and etc. (Please download the detailed manual for the specific compatible camera and lens)

### DISCLAIMER

Prohibit any user for any illegal purpose. Users will be responsible for all behaviors of purchase and use products. The Company assumes no liability for any risks related to or resulting from the debug and use of this product (including the direct, indirect or third-party losses). For any unknown sources of using, we will not be at any services. The updating and changes of product, firmware and program may cause changes in function descriptions in this user manual, please read the instructions carefully before upgrading the firmware and use the corresponding user manual. You can get the latest user manual from the official website: [www.feiyu-tech.com](http://www.feiyu-tech.com). FeiyuTech reserves the right to amend this manual and the terms and conditions of use the gimbal at any time.

#### Bluetooth operation instruction:

1. Turn on the cellphone Bluetooth, open the Feiyu ON APP
2. Switch on the AK4000, search AK4000 bluetooth on APP and connect.
3. Gimbal/stabilizer can be controlled via APP after bluetooth is connected.

#### Wifi operation instruction:

1. Turn on the Camera Wifi and enter into the Wifi information page.
  2. AK4000 connect with APP
  3. Click the icon "connect camera" button on the virtual joystick, and select the matched camera brand and model.
  4. Select the matched camera model and enter the wifi password, then click confirm.
- Camera can be controlled via gimbal/stabilizer after wifi is connected.

AUX-in port: The stabilizer can control the camera to take photos through the wire connection to the camera's wire control camera interface□□

USB port: Reserved extension interface, it can output 5V/1A

This device complies with Part 15 of the FCC Rules. Operation is subject to the following two conditions: (1) this device may not cause harmful interference, and (2) this device must accept any interference received, including interference that may cause undesired operation.

Changes or modifications not expressly approved by the party responsible for compliance could void the user's authority to operate the equipment.

NOTE: This equipment has been tested and found to comply with the limits for a Class B digital device, pursuant to Part 15 of the FCC Rules. These limits are designed to provide reasonable protection against harmful interference in a residential installation. This equipment generates, uses instructions, may cause harmful interference to radio communications. However, there is no guarantee that interference will not occur in a particular installation. If this equipment does cause harmful interference to radio or television reception, which can be determined by turning the equipment off and on, the user is encouraged to try to correct the interference by one or more of the following measures:

- Reorient or relocate the receiving antenna.
- Increase the separation between the equipment and receiver.
- Connect the equipment into an outlet on a circuit different from that to which the receiver is connected.
- Consult the dealer or an experienced radio/TV technician for help.