

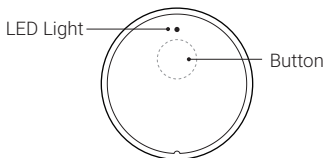

User Manual

SMART MARKER

Device Figure Guide



When completing bluetooth connection and the button pressed, LED light is on.

You can press the button in one or two times for audio guide and shot tracking.

Replacing the Battery

You can take off the back sticker with a paper clip, and replace the battery when needed.

After inserting the battery, attach the extra sticker.

* Be careful not to install the batteries with their terminals (+, -) reserved.

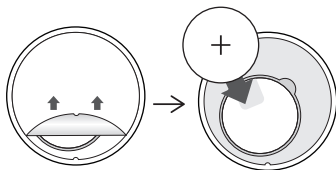

How to Use

Step1. Install the app

Smart Marker uses your smartphone's GPS, carry your phone when playing on the course.

Step2. Connect Smart Marker with App

Register Smart Marker on the app by bluetooth connection.(Once the connection is completed, it will be connected automatically.)

Step3. Click the Smart Marker

You just click in one time on the device and then the sound of distance will be come out from Smart phone.

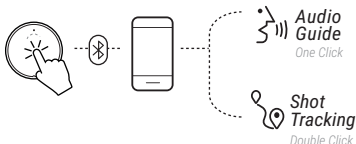

App Download

Step1. Download Golfwith app

Search the App Store or Google Play for "Golfwith" for using Smart Marker.

Or scan the QR code on the bottom.



Android



iOS

Step2. Install the app

Start the Golfwith app installed on your phone.

Compatible Devices

iPhone 4s & later, and Android 4.3 & later

Pairing

Step1. Open the Golfwith app

When opened, Wait for the update process.
Golfwith app continuously syncs up the new course data on the cloud.

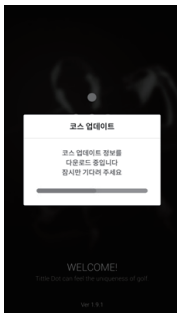

Step2. Turn on Bluetooth

Make sure your phone's bluetooth is turned ON.



If you are on an iOS device, you must accept the Bluetooth and Location permissions. Follow the screen instructions.

Specification

Product name	Smart Marker
Bluetooth 4.0	Bluetooth® low energy / About 10m
Processor	32-bit ARM® Cortex™ M0
Chipset	nRF51822
Supported Smartphones	Android 4.3 or higher iPhone 8.0 or higher
Power source	Coin-type lithium Battery(CR2016/3.0V)
Running Time	Over 365 days & 200 Rounds
Size/Weight	34mm x 3.4mm (LxH) / 2g (0.07 oz)

Warranty and A/S

- One year warranty from the date of original retail purchase.
(No warranty against damages or loss caused by accident, abuse, or natural disasters.)
- For support, please contact the following email :
sales@ulike.co.kr
- For more details, check the Website : tittlegolf.com

Free App Download



MSIP-CRM-ulk-SM200
FCC ID : 2AHUGSM200



RoHS
Compliant



8 809437 150058 >

MADE IN KOREA

Pairing

Step3. Activate Your Smart Marker

Press the button of Smart Marker on the main screen.

When the Bluetooth connection is completed, the device registration proceeds automatically.



One Click



Tip!

If there are multiple Smart Marker devices nearby ensure that your connection was made correctly. (A message stating, 'Connect to a new device' will pop-up, which you can accept or reject,)

Pairing

Step4.Golfwith Provides the Course Information Automatically

After connecting Smart Marker with app, the service is ready to start.

Current
Golf
Course



Smart Marker pinpoints the current location using the smartphone's GPS, then automatically selects for you the appropriate golf course.

(You can browse the available golf courses on the app.)

App Guide

Course Setting

You can set the pin position, green position, unit, and voice guidance personally.



Hole Setting

After setting the manual mode, hole information is not provided automatically. When you move on, you have to select the hole number.

Notice & Warranty

Everyday Use Warnings

Smart Marker is only water-resistant in very small amounts of rain. Therefore please pay caution in the following circumstances:

- Don't expose Smart Marker to large amounts of water.
- After replacing battery, please attach the sticker firmly.
- Prevent Smart Marker's exposure from water sprays.
- Do not take off Smart Marker's Sticker for covering
- Do not use it in a wet state or with wet hands.
- Don't store Tittle in moist areas.

Usage & Liabilities

- Before first use, check the battery life status.
- Do not use the product for purposes other than its intended functions.
- Do not separate and disassemble the product.
- Do not subject the product to severe impact, such as one caused by a drop.
- Do not use unauthorized components.
- We hold no liability for information that may leak from Bluetooth communications.
- We hold no liability for damage to clubs such as scratches, spots, etc.
- Do not expose the product to severe temperature or humidity.
- Ensure there are no nearby obstacles or people when you playing.
- Do not use on a hard surface such as concrete or asphalt.
- Optimal Temperature : -10~50℃
- Frequency Band : 2402~2480MHz

FCC

This device complies with part 15 of the FCC Rules. Operation is subject to the following two conditions: (1) This device may not cause harmful interference, and (2) this device must accept any interference received, including interference that may cause undesired operation.

This equipment has been tested and found to comply with the limits for a digital device, pursuant to part 15 of the FCC Rules. These limits are designed to provide reasonable protection against harmful interference in a residential installation. This equipment generates, uses and can radiate radio frequency energy and, if not installed and used in accordance with the instructions, may cause harmful interference to radio communications. However, there is no guarantee that interference will not occur in a particular installation. If this equipment does cause harmful interference to radio or television reception, which can be determined by turning the equipment off and on, the user is encouraged to try to correct the interference by one or more of the following measures:

Reorient or relocate the receiving antenna.

Increase the separation between the equipment and receiver.

Connect the equipment into an outlet on a circuit different from that to which the receiver is connected.

Consult the dealer or an experienced radio/TV technician for help.

Changes or modifications not expressly approved by the party responsible for compliance could void the user's authority to operate the equipment.

CE

Hereby, Ulike Co., Ltd., declares that this device is compliant with the essential requirements and other relevant provisions of Directive 1999/5/EC.

RF Exposure statement

This device complies with RF exposure requirement.