





(4) FM Radio

Press  to enter into FM radio mode, press SCAN to enter into radio program automatic scan. Press ◀▶ for radio program manual scan, ▲▼ Top and bottom trimming, Turn the TUNER button radio station can be adjusted. Slide around to adjust radio frequency between 87.5MHz~108.0MHz.

(5) Bluetooth connection

Press  to enter into Bluetooth Control connection page, then click "Speaker Pro BLE" to connect to the speaker.

(6) Line In input- mute

Press  to enter into Line IN input page, press  to mute music, press  insert a line continue play. Press "Back" to main page.

(7) Equalizer regulation

Press  to enter into Sound Set page, and then turn volume or bass or treble to adjust the volume. There are 4 pre-set EQ modes: dance, Classical, Jazz and Rock. You can also press G-Eq to access the graphic equalizer to set up your preferred equalize specification.

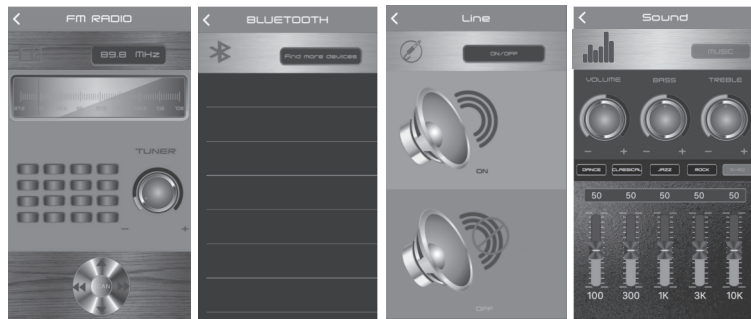

(4)

(5)

(6)

(7)

PORTABLE BATTERY SPEAKER

User Manual RM-610E



Specifications:

Power:	9W
Frequency Response for main speaker:	80Hz-20KHz
Power Supply:	DC9V

PANEL LAYOUT & FUNCTIONS

- 1.MIC VOLUME-/+ : Mic volume adjustment.
- 2.LED display.
- 3.VOLUME-/+ : Master volume adjustment.
- 4.MIC1: Microphone signal input.
- 5.MIC2: Microphone signal input.
- 6.USB: USB Player/Power Bank 5V 1A output.
- 7.POWER/INPUT button.
- 8.LIGHT/MODE (Light mode selection & switch on/off button).
- 9.EQ selection button.
- 10.Previous song.
- 11.Play/Pause (In FM mode, hold for 3 seconds the device will enter into automatic scan).
- 12.Next song.
- 13.LINE input.
- 14.LED CHARGE STATUS:
RED = Charging
GREEN = Fully charged
- 15.DC 9V external input.

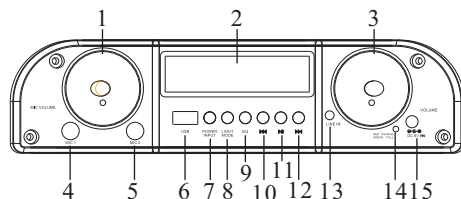

BASIC OPERATION

1. POWER/INPUT: long press (for above 2 seconds) to turn on the machine; during working status, short press to select mode: BT/LINE/FM (circulating); during working status, long press (for above 2 seconds) to turn off the machine.
2. PLAY/PAUSE: during playing status, short press to pause/mute; during FM mode, long press to automatically scan radio station.
3. MIC VOLUME-/+ : Twist the dial anticlockwise to decrease the volume and clockwise to increase the volume.
4. PREVIOUS/NEXT: during playing status, press to get back to a previous or next song.
5. VOLUME-/+ : adjust volume size.
- 6.USB: USB Player/PowerBank 5V 1A output.
- 7.Press EQ to switch among BA, tb, JAZZ, ROCK, POP, CLAS, G-EQ; When the screen displays BA, long press fast forward button to increase BA; long press backward button to decrease BA. When it displays tb, long press fast forward button to increase tb; long press backward button to decrease tb.

FM Operation

- A. Lightly press Power/Input button to switch to FM mode, long press PLAY/PAUSE button to automatically scan radio station, by pressing PREVIOUS or NEXT you can select a previous or next song.
- B. When scanning radio programs, adjust the antenna to obtain the best reception.

Bluetooth:

Please press INPUT button on control panel to select Bluetooth mode. Simultaneously open the Bluetooth setting on your phone, tablet or any other bluetooth enabled audio device and select "RM-610E"(no need to match code), the unit and device will then connected via Bluetooth. Press the "next song" and "previous song" button on the control panel to select the song, press "play/pause" button to control the playing status.

To control the device via your phone, please find and install the app " Speaker Pro ". Open the App "Speaker Pro" on your phone, there are 8 function icons on the main page :

1. Bluetooth Music play
2. USB card play
3. Light control colour, brightness and light flash mode
4. FM Radio
5. Control Bluetooth connect
6. Line In input- mute
7. Equalizer, volume adjustment for music, Microphone and guitar input.

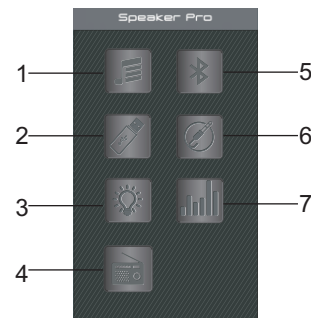

(1) Bluetooth Music play

Press  to enter into Bluetooth Music play page, Press "Pick songs to play" to Pick Song page to choose the song you want to play, press "Done" to return to Bluetooth Music play page, also you can operate pause, play, backward, forward & volume adjustment, repeat, random play. Press "Back" to return to the main page.

(2) USB card play

When inserting a USB into the speaker, press  to enter the USB Card play page. To choose a song and play music on the USB card, press "Play" to enter into the play control page, where you can operate pause, play, backward, forward & volume adjustment. Press "List" to return to USB list page, press "Back" to return to the main page.

(3) Light control colours, brightness and colour change mode

Press  to enter into Light Control page, you can select any colour to show the light colour on the speaker, as well as adjust the brightness of the light. To go back to main page, press " " in the left corner. Press "Profiles" to enter into Light Effect mode page, you can choose from a total of 12 pre-set light effect modes. To return to Light Control page, press "Light" in the left corner.

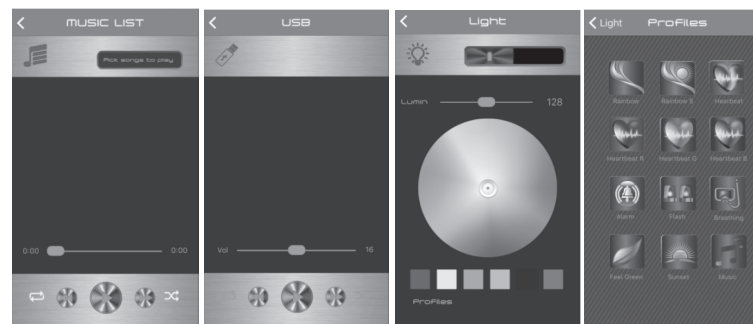

(1)

(2)

(3)

FCC Statement

1. This device complies with Part 15 of the FCC Rules.

Operation is subject to the following two conditions:

(1) This device may not cause harmful interference.

(2) This device must accept any interference received, including interference that may cause undesired operation.

2. Changes or modifications not expressly approved by the party responsible for compliance could void the user's authority to operate the equipment.

Note: This equipment has been tested and found to comply with the limits for a Class B digital device, pursuant to Part 15 of the FCC Rules. These limits are designed to provide reasonable protection against harmful interference in a residential installation. This equipment generates, uses, and can radiate radio frequency energy and, if not installed and used in accordance with the instructions, may cause harmful interference to radio communications. However, there is no guarantee that interference will not occur in a particular installation. If this equipment does cause harmful interference to radio or television reception, which can be determined by turning the equipment off and on, the user is encouraged to try to correct the interference by one or more of the following measures:

(1) Reorient or relocate the receiving antenna.

(2) Increase the separation between the equipment and receiver.

(3) Connect the equipment into an outlet on a circuit different from that to which the receiver is connected.

(4) Consult the dealer or an experienced radio / TV technician for help.