

KS-602_User manual

Product Description

Installation

Product Features

Attention

Thank you for your reading



Please see overleaf for instructions

FCC NOTE :
This device complies with Part 15 of the FCC Rules. Operation is subject to the following two conditions:
(1) this device may not cause harmful interference,
(2) this device must accept any interference received, including interference that may cause undesired operation.

The manufacturer is not responsible for any radio or tv interference caused by unauthorized modifications or change to this equipment. Such modifications or change could void the user's authority to operate the equipment.

This equipment has been tested and found to comply with the limits for a Class B digital device, pursuant to part 15 of the FCC Rules. These limits are designed to provide reasonable protection against harmful interference in a residential installation. This equipment generates, uses and can radiate radio frequency energy and, if not installed and used in accordance with the instructions, may cause harmful interference to radio communications. However, there is no guarantee that interference will not occur in a particular installation. If this equipment does cause harmful interference to radio or television reception, which can be determined by turning the equipment off and on, the user is encouraged to try to correct the interference by one or more of the following measures:

- Reorient or relocate the receiving antenna.
- Increase the separation between the equipment and receiver.
- Connect the equipment into an outlet on a circuit different from that to which the receiver is connected.
- Consult the dealer or an experienced radio/TV technician for help.

RF warning statement:
To maintain compliance with FCC's RF exposure guidelines, this equipment should be installed and operated with a minimum distance of 20cm between the radiator and your body.

Version :TKS6021801091.0

- Works with Amazon Alexa and Google Home, commanded by you voice.
- Control you home with your smart phone app or tablets from anywhere at anytime.
- Timing switch to turn ON/OFF your lights and appliances automatically.
- Intelligent sharing can be freely Shared with family members
- Refined appearance and made of fire resistant material, Safe and Durable.
- Overload protection, easy to replaces your traditional mechanical switch (Requires a neutral wire).
- The Smart Switch blends well with any room decor with its elegant, minimal design with sensitive capacitive touch control.
- Its LEDs can guide you at night when lights go off and you an simply turn it ON/OFF by directly pressing.

Specifications

Type	120 Wi-Fi Smart Wall Light Switch
Model	KS-602
Power supply mode	Neutral-Live Wire
Rated Current	15A(Max)
Rated Voltage	AC110-125V-50/60Hz
Rated Power	1650W
Wireless Frequency	2.4GHZ
Wireless Standard	IEEE802.11 b/g/n

- Cut off the power before installation
- Please use it only when it's installed with RCD or current leakage protector at home

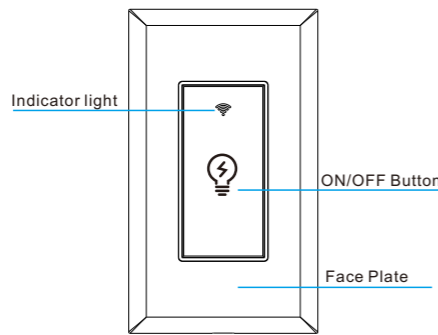

Facade

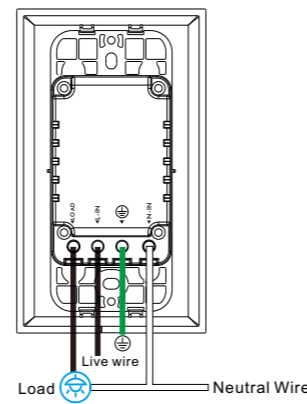

- Cut off the power before installation
- Please use it only when it's installed with RCD or current leakage protector at home

Amazon Alexa Tutorial



Google Home Tutorial



Smart Wall Light Switch User Manual

Add Device

1.1 Download "Smart Life" APP



Please scan the QR Code, or search by "Smart life" to download on APP Store or Google Play

1.2 Registration&Login

- Enter the register/login interface, input the phone number for getting verification code to register or through other methods at the bottom of page connecting to related authorization interface to log in.

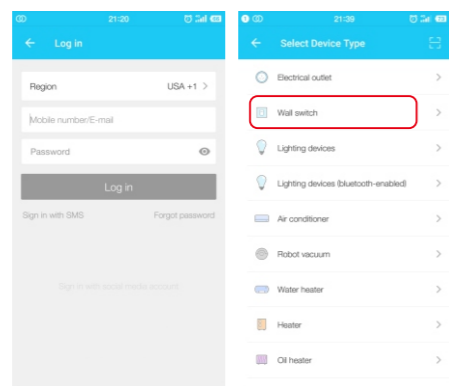

1.3 Easy Mode(Recommend)

Preparation:

- Device has been connected with electricity,
- Phone has connected to Wi-Fi router and been able to connected to internet
- The application already stepped into "My Device" interface

- Long press ON/OFF button for 5 seconds until indicator light quickly flashes,

Pairing steps:

- Tap the icon "+" on the top right corner of "My Device", choose your device type. Enter into "Add Device"
- Make sure the indicator light is flashing quickly, then tap the related button in application.
- Choose the local Wi-Fi and enter the correct password, tap "Next"
- Wait for configuring successfully, then tap "Complete".

Attention: there is no Internet connected while the blue light flashing slowly.

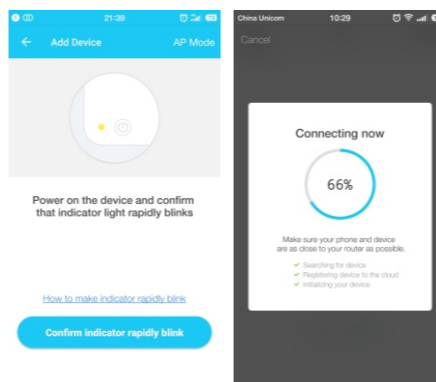

KS-602S_User manual

Product Description

Installation

Product Features

Attention

Thank you for your reading



Please see overleaf for instructions

FCC NOTE :
This device complies with Part 15 of the FCC Rules. Operation is subject to the following two conditions:
(1) this device may not cause harmful interference,
(2) this device must accept any interference received, including interference that may cause undesired operation.

The manufacturer is not responsible for any radio or tv interference caused by unauthorized modifications or change to this equipment. Such modifications or change could void the user's authority to operate the equipment.

This equipment has been tested and found to comply with the limits for a Class B digital device, pursuant to part 15 of the FCC Rules. These limits are designed to provide reasonable protection against harmful interference in a residential installation. This equipment generates, uses and can radiate radio frequency energy and, if not installed and used in accordance with the instructions, may cause harmful interference to radio communications. However, there is no guarantee that interference will not occur in a particular installation. If this equipment does cause harmful interference to radio or television reception, which can be determined by turning the equipment off and on, the user is encouraged to try to correct the interference by one or more of the following measures:

- Reorient or relocate the receiving antenna.
- Increase the separation between the equipment and receiver.
- Connect the equipment into an outlet on a circuit different from that to which the receiver is connected.
- Consult the dealer or an experienced radio/TV technician for help.

RF warning statement:
To maintain compliance with FCC's RF exposure guidelines, this equipment should be installed and operated with a minimum distance of 20cm between the radiator and your body.

Version :TKS602S1801091.0

- Works with Amazon Alexa and Google Home, commanded by you voice.
- Control you home with your smart phone app or tablets from anywhere at anytime.
- Timing switch to turn ON/OFF your lights and appliances automatically.
- Intelligent sharing can be freely Shared with family members
- Refined appearance and made of fire resistant material, Safe and Durable.
- Overload protection, easy to replaces your traditional mechanical switch (Requires a neutral wire).
- The Smart Switch blends well with any room decor with its elegant, minimal design with Mechanical button control.

Specifications

Type	120 Wi-Fi Smart Wall Light Switch
Model	KS-602S
Power supply mode	Neutral-Live Wire
Rated Current	15A(Max)
Rated Voltage	AC110-125V-50/60Hz
Rated Power	1650W
Wireless Frequency	2.4GHZ
Wireless Standard	IEEE802.11 b/g/n

- Cut off the power before installation
- Please use it only when it's installed with RCD or current leakage protector at home

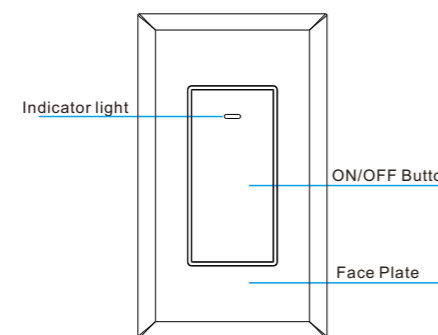

Facade

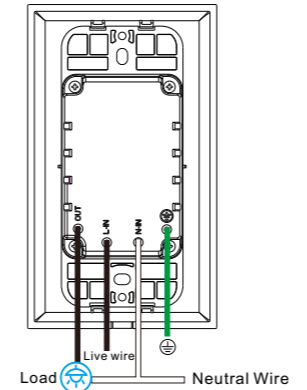

- Cut off the power before installation
- Please use it only when it's installed with RCD or current leakage protector at home

Amazon Alexa Tutorial



Google Home Tutorial



Smart Wall Light Switch User Manual

Add Device

1.1 Download "Smart Life" APP



Please scan the QR Code, or search by "Smart life" to download on APP Store or Google Play

1.2 Registration&Login

- Enter the register/login interface, input the phone number for getting verification code to register or through other methods at the bottom of page connecting to related authorization interface to log in.

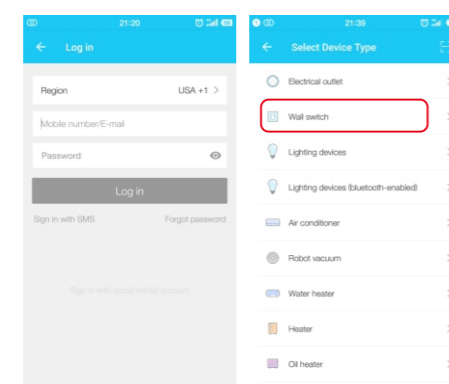

1.3 Easy Mode(Recommend)

Preparation:

- Device has been connected with electricity,
- Phone has connected to Wi-Fi router and been able to connected to internet
- The application already stepped into "My Device" interface

- Long press ON/OFF button for 5 seconds until indicator light quickly flashes,

Pairing steps:

- Tap the icon "+" on the top right corner of "My Device", choose your device type. Enter into "Add Device"
- Make sure the indicator light is flashing quickly, then tap the related button in application.
- Choose the local Wi-Fi and enter the correct password, tap "Next"
- Wait for configuring successfully, then tap "Complete".

Attention: there is no Internet connected while the blue light flashing slowly.

