

Connecting to BT

- Press "CH SET" until you hear two beeps. BT Mode is on.
- Turn on your smartphone's BT and search for the device. Then you will read "BT SPEAKER" on smartphone.
- Connect with "BT SPEAKER", click the OK on smartphone.
- "Connected" message will appear. Connection is successful.

(play and select music with smartphone when connected through BT).

SD/MMC Function

- Press "CH SET" on remote or "MODE" on back panel to switch to SD Mode or just insert a SD/MMC card. SD mode will start automatically.
- Press "PLAY/PAUSE" to continue play/pause music.
- Press "NEXT" button to go to next song.
- Press "PREVIOUS" to go back to previous song.
- Press "REPEAT" to replay same song.

USB Function

- Press "CH SET" on remote or "MODE" on back panel to switch to USB Mode or just insert a USB flash drive. USB mode will start automatically.
- Press "PLAY/PAUSE" to continue play/pause music.
- Press "NEXT" button to go to next song.
- Press "PREVIOUS" to go back to previous song.
- Press "REPEAT" to replay same song.

FM Radio Function

- Press "CH SET" on remote or "MODE" on back panel to switch to FM Mode. Radio will start automatically.
- Press "PLAY/PAUSE" to enter into automatic FM channel searching.
- Press "NEXT" button to go to next frequency.
- Press "PREVIOUS" to go back to previous frequency.

DJ SPEAKER SYSTEM OPERATING MANUAL

MODEL:MPD1002M

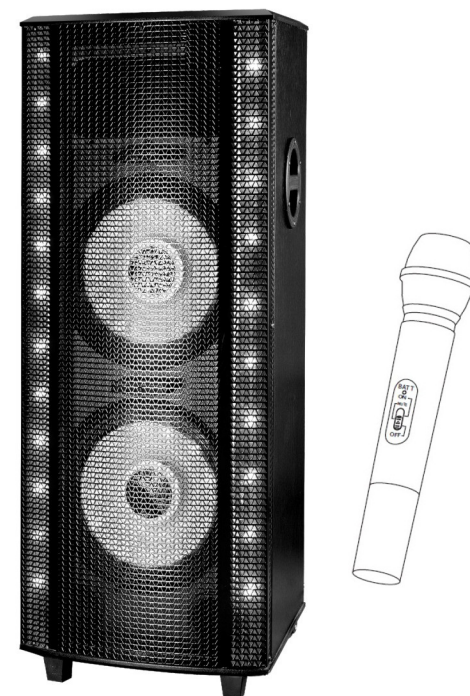

Carefully read User Guide to operate this unit properly.
Keep for future reference.

Wireless Microphone

Working Frequency:202.2MHz
Frequency control: Fixed frequency
Channel number: one
Frequency response:50-18KHz
Wireless distance:30m indoor, 15m outdoor

- Open the battery cover, load two pieces of "AA" battery.
Note : ensure the battery loaded correct(negative to negative and positive to positive), otherwise it will damage to the equipment.
- Pushing the switch to "ON" and turn on the speaker, they will connect automatically.
- Then you can enjoy singing.

Note: If red light flashing or long bright means battery electricity shortage, need to replace.

Remote Control Guide

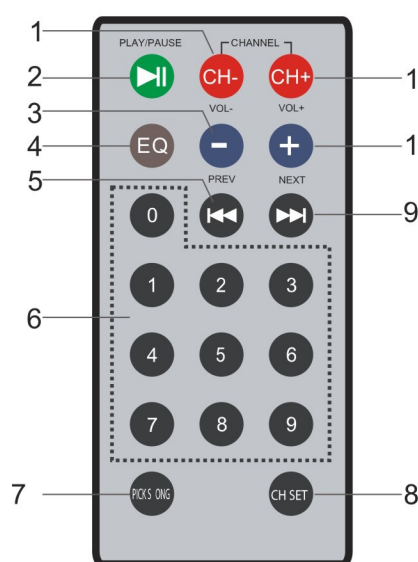

1. Channel down
2. Play / Pause
3. Volume down
4. Equalizer
5. Previous
6. Number Selecton (0-9)
7. Switch song
8. Mode Selecton (switch BT, USB, SD, Radio, & LINE)
9. Next
10. Volume up
11. Channel up

Important Notes: CAUTION

1. Do not use the machine while charging. This may cause battery damage.
2. To save battery power, turn off speaker lights when not in-use.
3. Please keep machine away from water and moisture.
4. Do not open the machine or remove the back panel. This machine carries high voltage and could be very dangerous.
5. In case of service needed, please call a certified technician or our customer service department. Do not attempt to fix yourself.

Panel Function That

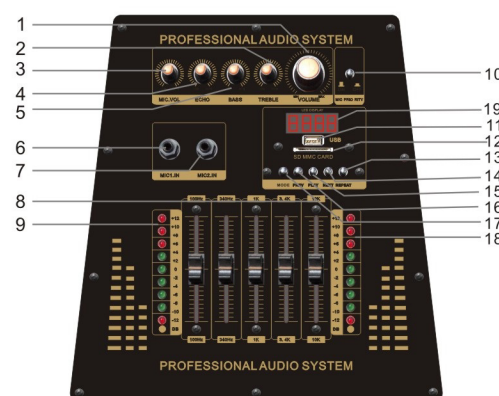

1. The main volume
2. High regulating
3. Microphone volume
4. Echo control
5. Bass adjustment
6. Mic1 input
7. Mic2 input
8. 100Hz~10KHz Balance adjustment
9. Output level indicator
10. Microphone switch priority
11. Usb socket
12. SD card socket
13. Repeat play
14. Next song (FM: The next channel)
15. Play/pause (FM: Automatic search)
16. Previous (FM: A channel)
17. Input selection
18. Output level indicator
19. LED Display

After the board function

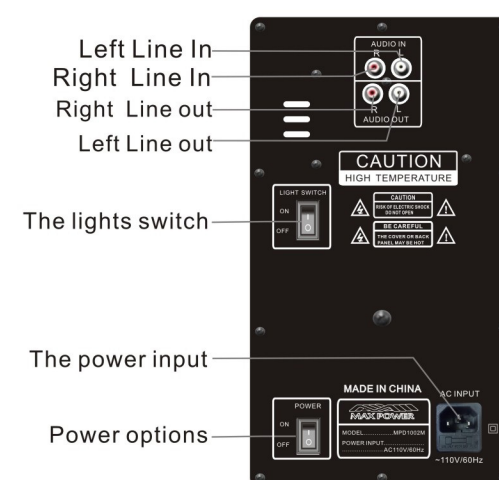

Bluetooth connection

Press mode key to select to bluetooth mode (bLUE), open the device with bluetooth function to search, when the search is made to "BT SPEAKER" match, select "BT SPEAKER" connection can play music.

FCC statement

This device complies with Part 15 of the FCC rules. Operation is subject to the following two conditions: 1) this device may not cause harmful interference, and 2) this device must accept any interference received, including interference that may cause undesired operation.
Note: This equipment has been tested and found to comply with the limits for a Class B digital device, pursuant to part 15 of the FCC Rules. These limits are designed to provide reasonable protection against harmful interference in a residential installation. This equipment generates uses and can radiate radio frequency energy and, if not installed and used in accordance with the instructions, may cause harmful interference to radio communications. However, there is no guarantee that interference will not occur in particular installation. If this equipment does cause harmful interference to radio or television reception, which can be determined by turning the equipment off and on, the user is encouraged to try to correct the interference by one or more of the following measures:
--Reorient or relocate the receiving antenna.
--Increase the separation between the equipment and receiver.
--Connect the equipment into an outlet on a circuit different from that to which the receiver is connected.
--Consult the dealer or an experienced radio/TV technician for help.
Changes or modifications not expressly approved by the party responsible for compliance could void the user's authority to operate the equipment.

This device is measured RF output power is less than the SAR exclusion threshold value for human head and body. Therefore, SAR test is not necessary.