

## NOTE:

- This equipment has been tested and found to comply with the limits for a Class B digital device, pursuant to Part 15 of the FCC Rules. These limits are designed to provide reasonable protection against harmful interference in a residential installation. This equipment generates, uses and can radiate radio frequency energy and, if not installed and used in accordance with the instructions, may cause harmful interference to radio communications. However, there is no guarantee that interference will not occur in a particular installation.
- If this equipment does cause harmful interference to radio or television reception, which can be determined by turning the equipment off and on, the user is encouraged to try to correct the interference by one or more of the following measures:
  - a. Increase the separation between the equipment and receiver.
  - b. Consult an authorized dealer or an experienced radio technician for help.

## UNCONNECT VOICE RECOGNITION QUICK TIPS

### Introducing Uconnect

Start using Uconnect Voice Recognition with these helpful quick tips. It provides the key Voice Commands and tips you need to know to control your Uconnect system.

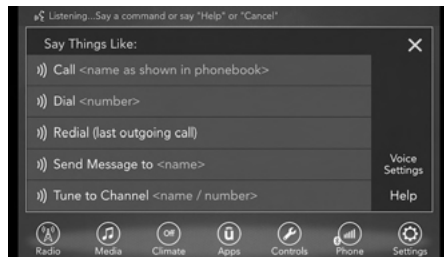

Uconnect 4



Uconnect 4C/4C NAV

## NOTE:

If you see the NAV icon on the bottom bar, or in the Apps menus, of your touchscreen, you have the Uconnect 4C NAV system. If not, you have a Uconnect 4C system.

## Get Started

All you need to control your Uconnect system with your voice are the buttons on your steering wheel.

Helpful hints for using Voice Recognition:

- Visit [UconnectPhone.com](http://UconnectPhone.com) to check mobile device and feature compatibility and to find phone pairing instructions.
- Reduce background noise. Wind and passenger conversations are examples of noise that may impact recognition.
- Speak clearly at a normal pace and volume while facing straight ahead. The microphone is positioned on the rearview mirror and aimed at the driver.
- Each time you give a Voice Command, you must first push either the Voice Recognition (VR) or Phone button, wait until after the beep, then say your Voice Command.

- You can interrupt the help message or system prompts by pushing the VR or Phone button and saying a Voice Command from the current category.



**Uconnect Voice Command Buttons**

- 1 – Push To Initiate Or To Answer A Phone Call, Send Or Receive A Text
- 2 – For All Radios: Push To Begin Radio, Media, Or Climate Functions. For Uconnect 4C NAV System Only: Push To Begin Navigation Function
- 3 – Push To End Call

## Basic Voice Commands

The basic Voice Commands below can be given at any point while using your Uconnect system.

Push the VR button . After the beep, say:

- **“Cancel”** to stop a current voice session
- **“Help”** to hear a list of suggested Voice Commands
- **“Repeat”** to listen to the system prompts again

Notice the visual cues that inform you of your voice recognition system’s status. Cues appear on the touchscreen.

## Radio

Use your voice to quickly get to the AM, FM, or SiriusXM® Satellite Radio stations you would like to hear. (Subscription or included SiriusXM® Satellite Radio trial required.)

Push the VR button . After the beep, say:

- “Tune to ninety-five-point-five FM”
- “Tune to Satellite Channel Hits 1”

### TIP:

At any time, if you are not sure of what to say or want to learn a Voice Command, push the VR button  and say, “Help.” The system provides you with a list of commands.

## Media

Uconnect offers connections via USB, Bluetooth® and auxiliary ports (if equipped). Voice operation is only available for connected USB and AUX devices.

Push the VR button . After the beep, say one of the following commands and follow the prompts to switch your media source or choose an artist.

- “Change source to Bluetooth®”
- “Change source to AUX”
- “Change source to USB”
- “Play artist Beethoven”; “Play album Greatest Hits”; “Play song Moonlight Sonata”; “Play genre Classical”

### TIP:

Press the Browse button on the touchscreen to see all of the music on your USB device. Your Voice Command must match exactly how the artist, album, song, and genre information is displayed.

## Phone

Making and answering hands-free phone calls is easy with Uconnect. When the Phonebook button is illuminated on your touchscreen, your system is ready. Check [UconnectPhone.com](http://UconnectPhone.com) for mobile phone compatibility and pairing instructions.

Push the Phone button . After the beep, say one of the following commands:

- “Call John Smith”
- “Dial 123-456-7890 and follow the system prompts”
- “Redial (call previous outgoing phone number)”
- “Call back (call previous incoming phone number)”

### TIP:

When providing a Voice Command, push the Phone button  and say “Call,” then pronounce the name **exactly** as it appears in your phone book. When a contact has multiple phone numbers, you can say “Call John Smith work.”

## Voice Text Reply

Uconnect announces **incoming** text messages. Push the Phone button  and say “**Listen.**” (Must have compatible mobile phone paired to Uconnect system.)

1. Once an incoming text message is read to you, push the Phone button . After the beep, say: “**Reply.**”
2. Listen to the Uconnect prompts. After the beep, repeat one of the pre-defined messages and follow the system prompts.

PRE-DEFINED VOICE TEXT REPLY RESPONSES		
Yes.	Stuck in traffic.	See you later.
No.	Start without me.	I'll be late.
Okay.	Where are you?	I will be <number> minutes late.
Call me.	Are you there yet?	

PRE-DEFINED VOICE TEXT REPLY RESPONSES		
I'll call you later.	I need directions.	See you in <number> of minutes.
I'm on my way.	Can't talk right now.	Thanks.
I'm lost.		

### TIP:

Your mobile phone must have the full implementation of the **Message Access Profile (MAP)** to take advantage of this feature. For details about MAP, visit [UconnectPhone.com](http://UconnectPhone.com).

Apple® iPhone® iOS 6 or later supports reading **incoming** text messages only.

### TIP:

Voice Text Reply is not compatible with iPhone®, but if your vehicle is equipped with Siri® Eyes Free, you can use your voice to send a text message.

## Climate

Adjust vehicle temperatures hands-free and keep everyone comfortable while you keep moving ahead. (If vehicle is equipped with climate control.)

Push the VR button . After the beep, say one of the following commands:

- “**Set driver temperature to 70 degrees**”
- “**Set passenger temperature to 70 degrees**”

### TIP:

Voice Command for Climate may only be used to adjust the interior temperature of your vehicle. Voice Command will not work to adjust the heated seats or steering wheel if equipped.

## Navigation (4C NAV)

The Uconnect navigation feature helps you save time and become more productive when you know exactly how to get to where you want to go.

1. To enter a destination, push the VR button . After the beep, say: “**Find address** 800 Chrysler Drive Auburn Hills, Michigan.”
2. Then follow the system prompts.

### TIP:

To start a POI search, push the VR button . After the beep, say: “**Find nearest** coffee shop.”

## Siri® Eyes Free — If Equipped

Siri lets you use your voice to send text messages, select media, place phone calls and much more. Siri uses your natural language to understand what you mean and responds back to confirm your requests. The system is designed to keep your eyes on the road and your hands on the wheel by letting Siri help you perform useful tasks.

To enable Siri, push and hold, then release the Uconnect Voice Recognition (VR) button on the steering wheel. After you hear a double beep you can ask Siri to play podcasts and music, get directions, read text messages and many other useful requests.

## Using Do Not Disturb

With Do Not Disturb, you can disable notifications from incoming calls and texts, allowing you to keep your eyes on the road and hands on the wheel. For your convenience, there is a counter display to keep track of your missed calls and text messages while you were using Do Not Disturb.

Do Not Disturb can automatically reply with a text message, a call or both, when declining an incoming call and send it to voicemail.

Automatic reply messages can be:

- “I am driving right now, I will get back to you shortly.”
- Create a custom auto reply message up to 160 characters.

While in Do Not Disturb, Conference Call can be selected so you can still place a second call without being interrupted by incoming calls.

### NOTE:

- Only the beginning of your custom message will be seen on the touchscreen.
- Reply with text message is not compatible with iPhones®.
- Auto reply with text message is only available on phones that supporting Bluetooth® MAP.

## Android Auto™ — If Equipped

### NOTE:

Feature availability depends on your carrier and mobile phone manufacturer. Some Android Auto™ features may or may not be available in every region and/or language.

Android Auto™ allows you to use your voice to interact with Android's™ best-in-class speech recognition technology through your vehicle's voice recognition system, and use your smartphone's data plan to project your Android™ powered smartphone and a number of its apps onto your Uconnect touchscreen. Connect your Android™ 5.0 (Lollipop), or higher, to one of the

media USB ports, using the factory-provided USB cable, and press the new Android Auto™ icon that replaces your “Phone” icon on the main menu bar to begin Android Auto™. Push and hold the VR button on the steering wheel, or press and hold the “Microphone” icon within Android Auto™, to activate Android’s™ VR, which recognizes natural voice commands, to use a list of your smartphone’s features:

- Maps
- Music
- Phone
- Text Messages
- Additional Apps

Refer to your Uconnect Owner’s Manual Supplement for further information.

**NOTE:**

Requires compatible smartphone running Android™ 5.0 (Lollipop) or higher and download app on Google Play. Android™, Android Auto™, and Google Play are trademarks of Google Inc.

**Apple CarPlay® — If Equipped**

**NOTE:**

Feature availability depends on your carrier and mobile phone manufacturer. Some Apple CarPlay® features may or may not be available in every region and/or language.

Apple CarPlay® allows you to use your voice to interact with Siri through your vehicle’s voice recognition system, and use your smartphone’s data plan to project your iPhone® and a number of its apps onto your Uconnect touchscreen. Connect your iPhone® 5, or higher, to one of the media USB ports, using the factory-provided Lightning cable, and press the new Apple CarPlay® icon that replaces your “Phone” icon on the main menu bar to begin Apple CarPlay®. Press and hold the VR button on the steering wheel, or press and hold the “Home” button within Apple CarPlay®, to activate Siri, which recognizes natural voice commands to use a list of your iPhone’s® features:

- Phone
- Music
- Messages

- Maps
- Additional Apps

Refer to your Uconnect Owner’s Manual Supplement for further information.

**NOTE:**

Requires compatible iPhone®. See dealer for phone compatibility. Data plan rates apply. Vehicle user interface is a product of Apple®. Apple CarPlay® is a trademark of Apple® Inc. iPhone® is a trademark of Apple® Inc., registered in the US and other countries. Apple® terms of use and privacy statements apply.

## General Information

The following regulatory statement applies to all Radio Frequency (RF) devices equipped in this vehicle:

This device complies with Part 15 of the FCC Rules and with Innovation, Science and Economic Development Canada license-exempt RSS standard(s). Operation is subject to the following two conditions:

1. This device may not cause harmful interference, and
2. This device must accept any interference received, including interference that may cause undesired operation.

Le présent appareil est conforme aux CNR d'Innovation, Science and Economic Development applicables aux appareils radio exempts de licence. L'exploitation est autorisée aux deux conditions suivantes:

1. l'appareil ne doit pas produire de brouillage, et
2. l'utilisateur de l'appareil doit accepter tout brouillage radioélectrique subi, même si le brouillage est susceptible d'en compromettre le fonctionnement.

La operación de este equipo está sujeta a las siguientes dos condiciones:

1. es posible que este equipo o dispositivo no cause interferencia perjudicial y
2. este equipo o dispositivo debe aceptar cualquier interferencia, incluyendo la que pueda causar su operación no deseada.

### NOTE:

Changes or modifications not expressly approved by the party responsible for compliance could void the user's authority to operate the equipment.

## Additional Information

© 2019 FCA US LLC. All rights reserved. Mopar and Uconnect are registered trademarks and Mopar Owner Connect is a trademark of FCA US LLC. Android™ is a trademark of Google Inc. SiriusXM® and all related marks and logos are trademarks of SiriusXM® Radio Inc.

Uconnect System Support:

- US residents visit [www.DriveUconnect.com](http://www.DriveUconnect.com) or call: 1-877-855-8400(24 hours a day 7 days a week)
- Canadian residents visit [www.DriveUconnect.ca](http://www.DriveUconnect.ca) or call: 1-800-465-2001(English) or 1-800-387-9983(French)

SiriusXM Guardian™ services support:

- US residents visit [www.siriusxm.com/guardian](http://www.siriusxm.com/guardian) or call: 1-844-796-4827
- Canadian residents visit [www.siriusxm.ca/guardian](http://www.siriusxm.ca/guardian) or call: 1-877-324-9091

# CUSTOMER ASSISTANCE

## SUGGESTIONS FOR OBTAINING SERVICE FOR YOUR VEHICLE

### Prepare For The Appointment

If you are having warranty work done, be sure to have the right papers with you. Take your warranty folder. All work to be performed may not be covered by the warranty. Discuss additional charges with the service manager. Keep a maintenance log of your vehicle's service history. This can often provide a clue to the current problem.

### Prepare A List

Make a written list of your vehicle's problems or the specific work you want done. If you've had an accident or work done that is not on your maintenance log, let the service advisor know.

### Be Reasonable With Requests

If you list a number of items and you must have your vehicle by the end of the day, discuss the situation with the service advisor and list the items in order of priority. At many authorized dealers, you may obtain a rental vehicle at a minimal daily charge. If you need a rental, it is advisable to make these arrangements when you call for an appointment.

## IF YOU NEED ASSISTANCE

The manufacturer and its authorized dealers are vitally interested in your satisfaction. We want you to be happy with our products and services.

Warranty service must be done by an authorized dealer. We strongly recommend that you take the vehicle to an authorized dealer. They know your vehicle the best, and are most concerned that you get prompt and high quality service. The manufacturer's authorized dealers have the facilities, factory-trained technicians, special tools, and the latest information to ensure the vehicle is fixed correctly and in a timely manner.

This is why you should always talk to an authorized dealer service manager first. Most matters can be resolved with this process.

- If for some reason you are still not satisfied, talk to the general manager or owner of the authorized dealer. They want to know if you need assistance.
- If an authorized dealer is unable to resolve the concern, you may contact the manufacturer's customer center.

Any communication to the manufacturer's customer center should include the following information:

- Owner's name and address
- Owner's telephone number (home, mobile, and office)
- Authorized dealer name
- Vehicle Identification Number (VIN)
- Vehicle delivery date and mileage



### **FCA US LLC Customer Center**

P.O. Box 21-8004

Auburn Hills, MI 48321-8004

Phone: (800) 247-9753

### **FCA Canada Inc. Customer Center**

P.O. Box 1621

Windsor, Ontario N9A 4H6

Phone: (800) 465-2001 English / (800) 387-9983 French

### **In Mexico Contact**

Av. Prolongacion Paseo de la Reforma, 1240

Sante Fe C.P. 05109

Mexico, D. F.

In Mexico City: 800-505-1300

Outside Mexico City: +(52)55 50817568

### **Puerto Rico And US Virgin Islands**

FCA Caribbean LLC

P.O. Box 191857

San Juan 00919-1857

Phone: (800) 247-9753

Fax: (787) 782-3345

### **Customer Assistance For The Hearing Or Speech Impaired (TDD/TTY)**

To assist customers who have hearing difficulties, the manufacturer has installed special TDD (Telecommunication Devices for the Deaf) equipment at its customer center. Any hearing or speech impaired customer, who has access to a TDD or a conventional teletypewriter (TTY) in the United States, can communicate with the manufacturer by dialing 1-800-380-CHRY.

Canadian residents with hearing difficulties that require assistance can use the special needs relay service offered by Bell Canada. For TTY teletypewriter users, dial 711 and for Voice callers, dial 1-800-855-0511 to connect with a Bell Relay Service operator.

### **Service Contract**

You may have purchased a service contract for a vehicle to help protect you from the high cost of unexpected repairs after the manufacturer's New Vehicle Limited Warranty expires. The manufacturer stands behind only the manufacturer's service contracts. If you purchased a manufacturer's service contract, you will receive Plan Provisions and an Owner Identification Card in the mail within three weeks of the vehicle delivery date. If you have

any questions about the service contract, call the manufacturer's Service Contract National Customer Hotline at 1-800-521-9922 (Canadian residents, call (800) 465-2001 English / (800) 387-9983 French).

The manufacturer will not stand behind any service contract that is not the manufacturer's service contract. It is not responsible for any service contract other than the manufacturer's service contract. If you purchased a service contract that is not a manufacturer's service contract, and you require service after the manufacturer's New Vehicle Limited Warranty expires, please refer to the contract documents, and contact the person listed in those documents.

We appreciate that you have made a major investment when you purchased the vehicle. An authorized dealer has also made a major investment in facilities, tools, and training to assure that you are absolutely delighted with the ownership experience. You will be pleased with their sincere efforts to resolve any warranty issues or related concerns.

**WARNING!**

Engine exhaust (internal combustion engines only), some of its constituents, and certain vehicle components contain, or emit, chemicals known to the State of California to cause cancer and birth defects, or other reproductive harm. In addition, certain fluids contained in vehicles and certain products of component wear contain, or emit, chemicals known to the State of California to cause cancer and birth defects, or other reproductive harm.

**WARRANTY INFORMATION**

See the Warranty Information for the terms and provisions of FCA US LLC warranties applicable to this vehicle and market.

**MOPAR PARTS**

Mopar fluids, lubricants, parts, and accessories are available from an authorized dealer. They are recommended for your vehicle in order to help keep the vehicle operating at its best.

**REPORTING SAFETY DEFECTS****In The 50 United States And Washington, D.C.**

If you believe that your vehicle has a defect that could cause a crash or cause injury or death, you should immediately inform the National Highway Traffic Safety Administration (NHTSA) in addition to notifying FCA US LLC.

If NHTSA receives similar complaints, it may open an investigation, and if it finds that a safety defect exists in a group of vehicles, it may order a recall and remedy campaign. However, NHTSA cannot become involved in individual problems between you, an authorized dealer or FCA US LLC.

To contact NHTSA, you may call the Vehicle Safety Hotline toll free at 1-888-327-4236 (TTY: 1-800-424-9153); or go to <http://www.safercar.gov>; or write to: Administrator, NHTSA, 1200 New Jersey Avenue, SE., West Building, Washington, D.C. 20590. You can also obtain other information about motor vehicle safety from <http://www.safercar.gov>.

**In Canada**

If you believe that your vehicle has a safety defect, you should contact the Customer Service Department immediately. Canadian customers who wish to report a safety defect to the Canadian government should contact Transport Canada, Motor Vehicle Defect Investigations and Recalls at 1-800-333-0510 or go to <http://www.tc.gc.ca/roadsafety/>.

## PUBLICATION ORDER FORMS

To order the following manuals, you may use either the website or the phone numbers listed below.

### Service Manuals

These comprehensive Service Manuals provide the information that students and professional technicians need in diagnosing/troubleshooting, problem solving, maintaining, servicing, and repairing FCA US LLC vehicles. A complete working knowledge of the vehicle, system, and/or components is written in straightforward language with illustrations, diagrams, and charts.

### Diagnostic Procedure Manuals

Diagnostic Procedure Manuals are filled with diagrams, charts and detailed illustrations. These practical manuals make it easy for students and technicians to find and fix problems on computer-controlled vehicle systems and features. They show exactly how to find and correct problems the first time, using step-by-step troubleshooting and drivability procedures, proven diagnostic tests and a complete list of all tools and equipment.

### Owner's Manuals

These Owner's Manuals have been prepared with the assistance of service and engineering specialists to acquaint you with specific FCA US LLC vehicles. Included are starting, operating, emergency and maintenance procedures as well as specifications, capabilities and safety tips.

Call toll free at:

- **1-800-890-4038 (US)**
- **1-800-387-1143 (Canada)**

Or

Visit us on the Worldwide Web at:

- [www.techauthority.com](http://www.techauthority.com) (US)

# INDEX

- A**
- About Your Brakes .....383
  - Adaptive Cruise Control (ACC) (Cruise Control) .....236
  - Adding Engine Coolant (Antifreeze) .....357
  - Additives, Fuel .....385
  - Adjust
    - Down .....45
    - Forward .....45
    - Rearward .....45
    - Up .....45
  - Air Bag .....184
    - Air Bag Operation .....185
    - Air Bag Warning Light .....183, 186
    - Driver Knee Air Bag .....190
    - Enhanced Accident Response .....194, 339
    - Event Data Recorder (EDR).....339
    - Front Air Bag .....186
    - If Deployment Occurs .....193
    - Knee Impact Bolsters .....190
    - Maintaining Your Air Bag System.....195
    - Maintenance .....195
    - Redundant Air Bag Warning Light.....183
    - Side Air Bags.....190
    - Transporting Pets .....213
  - Air Bag Light .....141, 183, 214
  - Air Cleaner, Engine (Engine Air Cleaner Filter).....348
  - Air Conditioner Maintenance .....349
  - Air Conditioner Refrigerant.....349, 350
  - Air Conditioner System.....349
  - Air Conditioning Filter .....93, 350
  - Air Conditioning, Operating Tips .....92
  - Air Filter .....348
  - Air Pressure
    - Tires .....369
  - Alarm
    - Arm The System .....22
    - Disarm The System .....22
    - Security Alarm.....143
  - Alterations/Modifications
    - Vehicle .....10
  - Android Auto .....490
  - Antifreeze (Engine Coolant).....357, 387
    - Disposal .....358
  - Anti-Lock Brake System (ABS).....152
  - Anti-Lock Warning Light.....144
  - Apple CarPlay .....491
  - Ashtray .....121
  - Assist, Hill Start.....157
  - Audio Jack .....461
  - Audio Settings .....439
  - Audio Systems (Radio).....391
  - Automatic Dimming Mirror.....57
  - Automatic Headlights .....62
  - Automatic Temperature Control (ATC) .....92
  - Automatic Transaxle .....225
  - Automatic Transmission .....226
    - Adding Fluid .....361, 390
    - Fluid And Filter Change .....361
    - Fluid Change .....361
    - Fluid Level Check .....360, 361
    - Fluid Type .....360, 390
    - Special Additives .....360
  - AUX Cord .....461
  - Aux Mode .....442
  - Auxiliary Electrical Outlet (Power Outlet).....119
  - Axle Lubrication .....390
- B**
- Back-Up Camera .....278
  - Battery .....143, 346
    - Charging System Light .....143
    - Jump Starting .....331
    - Keyless Key Fob Replacement.....14
  - Battery Saver Feature .....63
  - Belts, Seat .....214
  - Blind Spot Monitoring.....159

Bluetooth		
Connect Or Disconnect Link Between the Uconnect Phone And Mobile Phone .....	459	
Connecting To A Particular Mobile Phone Or Audio Device After Pairing .....	454	
Bluetooth Mode.....	443	
Body Mechanism Lubrication.....	351	
B-Pillar Location .....	366	
Brake Assist System .....	153	
Brake Control System, Electronic .....	153	
Brake Fluid.....	390	
Brake System .....	359, 383	
Anti-Lock (ABS) .....	383	
Fluid Check.....	359, 390	
Master Cylinder .....	359	
Parking .....	222	
Warning Light.....	141	
Brake/Transmission Interlock.....	226	
Brightness, Interior Lights .....	64	
Bulb Replacement .....	300, 304	
Bulbs, Light .....	215, 300, 304	
<b>C</b>		
Camera .....	278	
Camera, Rear .....	278, 279	
Capacities, Fluid .....	387	
Caps, Filler		
Fuel.....	282, 333	
Oil (Engine).....	344	
Radiator (Coolant Pressure).....	358	
Car Washes.....	380	
Carbon Monoxide Warning.....	213, 386	
Cargo		
Vehicle Loading .....	103	
Cargo Area Cover.....	103	
Cargo Compartment		
Luggage Carrier .....	122	
Cargo Load Floor .....	103	
Cargo Tie-Downs .....	103	
Cellular Phone .....	485	
Center High Mounted Stop Light .....	305	
Certification Label .....	283	
Chains, Tire .....	377	
Change Oil Indicator .....	130	
Changing A Flat Tire .....	314, 361	
Chart, Tire Sizing .....	362	
Check Engine Light (Malfunction Indicator Light).....	151	
Checking Your Vehicle For Safety .....	213	
Checks, Safety .....	213	
Child Restraint.....	196	
Child Restraints		
Booster Seats .....	199	
Center Seat LATCH.....	205	
Child Seat Installation.....	207, 209	
How To Stow An unused ALR Seat Belt ...	206	
Infant And Child Restraints .....	198	
Lower Anchors And Tethers For Children .....	201	
Older Children And Child Restraints .....	199	
Seating Positions.....	200	
Using The Top Tether Anchorage .....	211	
Cigar Lighter .....	121	
Clean Air Gasoline .....	384	
Cleaning		
Wheels.....	376	
Climate Control.....	68	
Automatic .....	80	
Manual .....	68	
Rear .....	77, 89	
Coat Hook .....	118	
Cold Weather Operation.....	220	
Compact Spare Tire .....	374	
Computer, Trip/Travel .....	140	
Contract, Service.....	494	
Cooling Pressure Cap (Radiator Cap) .....	358	

- Cooling System .....356
- Adding Coolant (Antifreeze).....357
  - Coolant Level .....358
  - Cooling Capacity .....387
  - Disposal Of Used Coolant.....358
  - Drain, Flush, And Refill .....357
  - Inspection .....356, 358
  - Points To Remember.....359
  - Pressure Cap .....358
  - Radiator Cap.....358
  - Selection Of Coolant  
(Antifreeze) .....357, 387, 388
- Corrosion Protection .....380
- Cruise Control (Speed Control) .....236
- Cruise Light .....147, 148, 149
- Customer Assistance .....493
- Cybersecurity .....391
- D**
- Daytime Brightness, Interior Lights.....64
- Daytime Running Lights .....60
- Dealer Service .....346
- Defroster, Windshield .....214
- Delay (Intermittent) Wipers .....65
- Diagnostic System, Onboard.....150
- Dimmer Switch
- Headlight .....60
- Dipsticks
- Oil (Engine) .....345
- Disable Vehicle Towing.....336
- Disposal
- Antifreeze (Engine Coolant) .....358
- Disturb.....458, 490
- Door Ajar .....142, 143
- Door Ajar Light.....142, 143
- Driver's Seat Back Tilt .....31
- Driving
- Through Flowing, Rising,  
Or Shallow Standing Water .....294
- DVD Player (Video Entertainment  
System).....462
- E**
- Electric Brake Control System.....153
- Anti-Lock Brake System .....152
  - Traction Control System.....158
- Electric Parking Brake .....222
- Electric Remote Mirrors .....58
- Electronic Speed Control (Cruise Control) ....234
- Electronic Stability Control (ESC) .....154
- Electronic Throttle Control Warning Light.....142
- Emergency, In Case Of
- Hazard Warning Flasher .....296
  - Jacking.....314, 316, 361
  - Jump Starting .....331
  - Overheating.....333
  - Towing .....336
- Emission Control System Maintenance .....151
- Engine.....344
- Air Cleaner .....348
  - Block Heater .....221
  - Break-In Recommendations .....222
  - Checking Oil Level .....345
  - Compartment .....344
  - Compartment Identification .....344
  - Coolant (Antifreeze).....388
  - Cooling.....356
  - Exhaust Gas Caution .....213, 386
  - Fails To Start .....220
  - Flooded, Starting.....220
  - Fuel Requirements .....384
  - Oil.....347, 387, 388
  - Oil Filler Cap.....344
  - Oil Filter .....348
  - Oil Selection .....347, 387
  - Oil Synthetic .....347
  - Overheating .....333
  - Starting .....216
- Engine Oil Viscosity .....347
- Engine Oil Viscosity Chart .....347
- Enhanced Accident Response
- Feature.....194, 339
- Ethanol.....385
- Exhaust Gas Cautions .....213, 386
- Exhaust System .....213, 355
- Exterior Lighting.....60, 304
- Exterior Lights .....60, 215, 300, 304

**F**

Filters	
Air Cleaner.....	348
Air Conditioning .....	93, 350
Engine Oil.....	348, 388
Engine Oil Disposal .....	348
Flashers	
Hazard Warning.....	296
Turn Signals.....	60, 148, 215, 304
Flash-To-Pass .....	60, 61
Flat Tire Changing.....	314, 361, 374
Flat Tire Stowage .....	324, 361, 374
Flooded Engine Starting .....	220
Fluid Capacities.....	387
Fluid Leaks .....	215
Fluid Level Checks	
Brake .....	359
Fluid, Brake .....	390
Fluids And Lubricants .....	388
Fog Lights .....	60, 62, 305
Fog Lights, Service .....	305
Fold In Floor (Stow 'n Go) Seating .....	39
Fold-Flat Seats .....	31
Forward Collision Warning.....	164
Freeing A Stuck Vehicle .....	335
Front Position Light .....	304

Fuel .....	384
Additives.....	385
Clean Air .....	384
Ethanol.....	385
Filler Cap (Gas Cap).....	282
Gasoline .....	384
Materials Added .....	385
Methanol .....	385
Octane Rating.....	384, 388
Requirements .....	384
Specifications .....	388
Tank Capacity .....	387
Fuses .....	306

**G**

Garage Door Opener (HomeLink).....	109
Gas Cap (Fuel Filler Cap) .....	282
Gasoline, (Fuel).....	384
Gasoline, Clean Air.....	384
Gasoline, Reformulated .....	384
Gear Ranges .....	227
Glass Cleaning.....	382
Gross Axle Weight Rating.....	285
Gross Vehicle Weight Rating .....	284
GVWR .....	283

**H**

Hazard	
Driving Through Flowing, Rising, Or Shallow Standing Water .....	294
Hazard Warning Flashers .....	296
Head Restraints.....	52
Headlights .....	60
Bulb Replacement .....	303
Cleaning .....	380
High Beam/Low Beam Select Switch.....	60
Lights On Reminder.....	60, 62
Passing .....	60, 61
Replacing .....	303
Switch.....	60
Time Delay.....	60
Washers.....	62
Heated Mirrors .....	57, 58
Heater, Engine Block.....	221
Hill Start Assist .....	157
Hitches	
Trailer Towing .....	286
HomeLink (Garage Door Opener) .....	109
Hood Prop .....	98
Hood Release.....	98
Hook, Coat .....	118

<b>I</b>		
Ignition .....	16	
Switch .....	16	
In Vehicle Help		
Vehicle User Guide .....	11	
Inside Rearview Mirror .....	57, 296	
Instrument Cluster .....	127	
Descriptions .....	148	
Display .....	128	
Menu Items .....	133	
Instrument Panel Lens Cleaning .....	382	
Interior And Instrument Lights .....	63	
Interior Appearance Care .....	381	
Interior Lights .....	63	
Intermittent Wipers (Delay Wipers) .....	65	
Inverter		
Power .....	120	
iPod/USB/MP3 Control .....	441	
<b>J</b>		
Jack Location .....	314	
Jack Operation .....	314, 361	
Jump Starting .....	331	
<b>K</b>		
Key Fob .....	12	
Arm The System .....	22	
Disarm The Alarm .....	22	
Programming Additional Key Fobs .....	15, 21	
Key Fob Battery Service (Remote Keyless Entry) .....	14	
Key Fob Programming (Remote Keyless Entry) .....	15	
Keys .....	12	
Replacement .....	21	
<b>L</b>		
Lane Change And Turn Signals .....	60	
Lane Change Assist .....	60, 63	
LaneSense .....	275	
Lap/Shoulder Belts .....	173	
Latches .....	215	
Hood .....	98	
Lead Free Gasoline .....	384	
Leaks, Fluid .....	215	
Life Of Tires .....	372	
Liftgate .....	99	
Power .....	100	
Light Bulbs .....	215, 304	
Lighter		
Cigar .....	121	
Lights .....	215	
Air Bag .....	141, 183, 214	
Battery Saver .....	63	
Brake Assist Warning .....	156	
Brake Warning .....	141	
Bulb Replacement .....	300, 304	
Center Mounted Stop .....	305	
Cruise .....	147, 148, 149	
Daytime Running .....	60	
Dimmer Switch, Headlight .....	60	
Engine Temperature Warning .....	142	
Exterior .....	215, 304	
Fog .....	62, 305	
Headlights .....	60, 62, 303	
High Beam/Low Beam Select .....	60	
Instrument Cluster .....	60	
Intensity Control .....	64	
Interior .....	63	
Lights On Reminder .....	60, 62	
Malfunction Indicator (Check Engine) .....	145	
Parade Mode (Daytime Brightness) .....	64	
Park .....	148	
Passing .....	60, 61	
Reading .....	63	
Seat Belt Reminder .....	143	
Security Alarm .....	143	
Service .....	300	
Side Marker .....	304	
SmartBeams .....	61	
Traction Control .....	156	
Turn Signals .....	60, 148, 215, 304	
Warning Instrument Cluster Descriptions .....	142, 148	
Load Floor, Cargo .....	103	
Load Shed Battery Saver Mode .....	138	
Load Shed Battery Saver On .....	138	
Load Shed Electrical Load Reduction .....	138	
Load Shed Intelligent Battery Sensor .....	138	



- Loading Vehicle ..... 103, 283
  - Tires ..... 366
- Low Tire Pressure System ..... 167
- Lubrication, Body ..... 351
- Lug Nuts ..... 383
- Luggage Carrier ..... 122
  
- M**
- Maintenance Free Battery ..... 346
- Maintenance Schedule ..... 340
- Malfunction Indicator Light  
(Check Engine) ..... 145, 151
- Manual
  - Park Release ..... 334
  - Service ..... 496
- Map/Reading Lights ..... 63
- Marker Lights, Side ..... 304
- Media Hub ..... 461
- Memory Feature (Memory Seats) ..... 31
- Memory Seat ..... 31, 58
- Memory Seats And Radio ..... 31
- Methanol ..... 385
- Mini-Trip Computer ..... 140
- Mirrors ..... 57
  - Automatic Dimming ..... 57
  - Electric Remote ..... 58
  - Exterior Folding ..... 58
  - Heated ..... 57, 58
  - Outside ..... 57
  - Rearview ..... 57, 296
  - Vanity ..... 60
- Modifications/Alterations
  - Vehicle ..... 10
- Monitor, Tire Pressure System ..... 167
- Mopar Parts ..... 495
- MP3 Control ..... 461
- Multi-Function Control Lever ..... 60
  
- N**
- New Vehicle Break-In Period ..... 222
  
- O**
- Occupant Restraints ..... 171
- Octane Rating, Gasoline (Fuel) ..... 384, 388
- Oil Change Indicator ..... 130
  - Reset ..... 130
- Oil Filter, Change ..... 348
- Oil Filter, Selection ..... 348
- Oil Pressure Light ..... 144
- Oil, Engine ..... 347, 388
  - Capacity ..... 387
  - Change Interval ..... 347
  - Checking ..... 345
  - Disposal ..... 348
  - Filter ..... 348, 388
  - Filter Disposal ..... 348
  - Identification Logo ..... 347
  - Materials Added To ..... 347
- Pressure Warning Light ..... 144
- Recommendation ..... 347, 387
- Synthetic ..... 347
- Viscosity ..... 347, 387
- Onboard Diagnostic System ..... 150
- Operating Precautions ..... 150
- Operator Manual
  - Owner's Manual ..... 9, 496
- Outside Rearview Mirrors ..... 57
- Overheating, Engine ..... 333
- Owner's Manual (Operator Manual) ..... 9
  
- P**
- Paint Care ..... 380
- Parking Brake ..... 222
- ParkSense System, Rear ..... 250, 256
- Pets ..... 213
- Placard, Tire And Loading Information ..... 366
- Power
  - Brakes ..... 383
  - Inverter ..... 120
  - Mirrors ..... 58
  - Outlet (Auxiliary Electrical Outlet) ..... 119
  - Seats ..... 45, 46
  - Steering ..... 231
- Power Seats
  - Down ..... 45
  - Forward ..... 45
  - Rearward ..... 45
  - Up ..... 45

Power Sliding Door			
On / Off Switch .....	28, 100		
Pregnant Women And Seat Belts .....	179		
Preparation For Jacking.....	315		
Pretensioners			
Seat Belts .....	180		
<b>R</b>			
Radial Ply Tires.....	371		
Radiator Cap (Coolant Pressure Cap).....	358		
Radio			
Presets .....	435		
Radio Operation .....	434, 485		
Rear Air Conditioning.....	77, 89		
Rear Camera .....	279		
Rear Cross Path .....	162		
Rear ParkSense System .....	250, 256		
Rear Seat Removal .....	33		
Rear View .....	57		
Reclining Front Seats.....	32		
Recreational Towing .....	293		
Reformulated Gasoline .....	384		
Refrigerant.....	350		
Release, Hood .....	98		
Reminder, Lights On .....	60		
Reminder, Seat Belt .....	172		
Remote Control			
Starting System .....	18		
Remote Keyless Entry			
Arm The Alarm .....	22		
Disarm The Alarm .....	22		
Programming Additional Key Fobs.....	15, 21		
Remote Starting			
Exit Remote Start Mode.....	19		
Uconnect Customer Programmable			
Features .....	20		
Uconnect Settings.....	20		
Remote Starting System.....	18		
Replacement Bulbs.....	300		
Replacement Keys.....	21		
Replacement Tires.....	372		
Reporting Safety Defects.....	495		
Restraints, Child.....	196		
Restraints, Head .....	52		
Roof Luggage Rack .....	122		
Rotation, Tires .....	377		
<b>S</b>			
Safety Checks Inside Vehicle .....	214		
Safety Checks Outside Vehicle.....	215		
Safety Defects, Reporting .....	495		
Safety Information, Tire.....	361		
Safety Tips .....	213		
Safety, Exhaust Gas .....	213		
Schedule, Maintenance .....	340		
Seat Belt Reminder.....	143		
Seat Belts .....	172, 214		
Adjustable Shoulder Belt .....	176		
Adjustable Upper Shoulder Anchorage ....	176		
Adjustable Upper Shoulder Belt			
Anchorage.....	176		
Automatic Locking Retractor (ALR).....	180		
Child Restraints.....	196		
Energy Management Feature .....	180		
Extender.....	179		
Front Seat.....	172, 173, 175		
Inspection.....	214		
Lap/Shoulder Belt Operation .....	175		
Lap/Shoulder Belt Untwisting .....	176		
Lap/Shoulder Belts .....	173		
Operating Instructions .....	175		
Pregnant Women.....	179		
Pretensioners .....	180		
Rear Seat .....	173		
Reminder .....	172		
Seat Belt Extender .....	179		
Seat Belt Pretensioner .....	180		
Untwisting Procedure .....	176		
Seat Belts Maintenance.....	381		
Seats .....	31, 45, 50		
Adjustment .....	31, 32, 33, 45		
Bench .....	33		
Heated.....	50		
Power .....	45, 46		

Rear Folding .....	31	Snow Chains (Tire Chains) .....	377	Stow 'n Vac.....	103
Reclining .....	32	Snow Tires .....	374	Stuck, Freeing .....	335
Seatback Release .....	31, 33	Spare Tire Changing.....	314	Sun Roof.....	96
Stow 'n Go (Fold in Floor) .....	39	Spare Tire Stowage.....	324	Sunglasses Storage .....	121
Tilting.....	31, 33	Spare Tires .....	314, 374, 375	Supplemental Restraint System – Air Bag ...	184
Security Alarm.....	143	Spark Plugs.....	388	Sway Control, Trailer .....	158
Arm The System.....	22	Specifications		Synthetic Engine Oil .....	347
Disarm The System.....	22	Oil .....	388	System, Remote Starting .....	18
Selection Of Coolant (Antifreeze) .....	388	Speed Control		<b>T</b>	
Sentry Key		Accel/Decel (ACC Only).....	240	Telescoping Steering Column .....	56
Key Programming .....	21	Cancel.....	236	Temperature Control, Automatic (ATC).....	92
Sentry Key (Immobilizer).....	20	Resume.....	236	Tie Down Hooks, Cargo .....	103
Sentry Key Replacement .....	21	Speed Control (Cruise Control).....	234, 236	Tilt Steering Column .....	56
Service Assistance .....	493	Starting.....	18, 216	Time Delay	
Service Contract .....	494	Button.....	16	Headlight.....	60
Service Manuals.....	496	Cold Weather .....	220	Tire And Loading Information Placard.....	366
Shifting		Engine Fails To Start.....	220	Tire Markings .....	361
Automatic Transmission.....	226	Remote .....	18	Tire Safety Information .....	361
Shoulder Belts .....	173	Starting And Operating.....	216	Tire Service Kit .....	324
Side View Mirror Adjustment.....	57	Starting Procedures .....	216	Tire Stowage .....	324
Signals, Turn .....	60, 148, 215, 304	Steering .....	231	Tires .....	215, 369, 374, 378
Siri .....	490	Tilt Column .....	56	Aging (Life Of Tires) .....	372
Sirius Satellite Radio .....	436	Wheel, Heated .....	56	Air Pressure .....	369
Favorites.....	437	Wheel, Tilt .....	56	Chains .....	377
Replay .....	437	Steering Wheel Audio Controls.....	461	Changing.....	314, 361
SiriusXM Satellite Radio		Steering Wheel Mounted Sound		Compact Spare .....	374
Browse in SXM .....	438	System Controls.....	461	General Information .....	369, 374
Favorites.....	437	Storage, Vehicle .....	92	High Speed .....	370
Replay .....	437	Store Radio Presets .....	435	Inflation Pressure .....	369
SmartBeams .....	61	Stow 'n Go (Fold In Floor) Seats .....	39		

- Jacking ..... 314, 316, 361  
 Life Of Tires ..... 372  
 Load Capacity ..... 366  
 Pressure Monitoring  
   System (TPMS)..... 133, 146, 167  
 Quality Grading..... 378  
 Radial..... 371  
 Replacement ..... 372  
 Rotation ..... 377  
 Safety..... 361, 369  
 Sizes ..... 362  
 Snow Tires..... 374  
 Spare Tires ..... 314, 374, 375  
 Spinning ..... 371  
 Trailer Towing..... 290  
 Tread Wear Indicators ..... 372  
 Wheel Nut Torque ..... 383  
 To Open Hood ..... 98  
 Tongue Weight/Trailer Weight..... 289  
 Towing ..... 284  
   Disabled Vehicle ..... 336  
   Guide ..... 286  
   Recreational ..... 293  
   Weight..... 286  
 Towing Behind A Motorhome..... 293  
 Traction ..... 294  
 Traction Control ..... 158  
 Trailer Sway Control (TSC)..... 158  
 Trailer Towing..... 284  
   Cooling System Tips ..... 292  
   Hitches..... 286  
   Minimum Requirements ..... 289  
   Tips ..... 292  
   Trailer And Tongue Weight ..... 289  
   Wiring ..... 291  
 Trailer Towing Guide..... 286  
 Trailer Weight ..... 286  
 Transaxle  
   Automatic ..... 225  
   Operation..... 225  
 Transmission..... 226  
   Automatic ..... 226, 360  
   Maintenance ..... 360  
 Transporting Pets ..... 213  
 Tread Wear Indicators ..... 372  
 Turn Signals ..... 60, 148, 304
- U**  
 Uconnect  
   Advanced Phone Connectivity..... 459  
   Phone Call Features ..... 456  
   Theater ..... 462  
   Things You Should Know About Your  
     Uconnect Phone ..... 459  
   Uconnect Settings..... 20  
 Uconnect 4 With 7-Inch Display ..... 392  
 Uconnect 4C/4C Nav With 8.4-Inch Display ..... 410  
 Uconnect Phone ..... 452, 453, 454, 455  
   Answer Or Ignore An Incoming Call –  
     Call Currently In Progress ..... 457  
     Answer Or Ignore An Incoming Call –  
       No Call Currently In Progress..... 457  
   Bluetooth Communication Link ..... 460  
   Call By Saying A Phonebook Name..... 457  
   Call Continuation..... 459  
   Call Controls..... 457  
   Call Termination ..... 458  
   Cancel Command ..... 452  
   Connect Or Disconnect Link Between  
     The Uconnect Phone And  
     Mobile Phone..... 459

## Connecting To A Particular

Mobile Phone Or Audio Device	
After Pairing .....	454
Deleting A Phone Or Audio Device .....	455
Dial By Saying A Number .....	456
Disconnecting A Phone Or Audio	
Device .....	455
Far End Audio Performance .....	460
Help Command .....	452
Join Calls .....	458
Making A Phone Or Audio Device	
A Favorite .....	455
Making A Second Call While Current	
Call Is In Progress .....	458
Managing Your Favorites .....	456
Natural Speech .....	452
Operation .....	451
Pair (Link) Uconnect Phone To A	
Mobile Phone .....	452
Pair A Bluetooth Streaming Audio Device .....	454
Pair Additional Mobile Phones .....	453
Phonebook Download .....	455
Place/Retrieve A Call From Hold .....	458
Power-Up .....	460
Recent Calls .....	457
Redial .....	458
To Remove A Favorite .....	456
Toggling Between Calls .....	458
Touch-Tone Number Entry .....	457

## Transfer Call To And From Mobile

Phone .....	459
Voice Command .....	459
Ways To Initiate A Phone Call .....	456
Uconnect Settings	
Customer Programmable Features .....	20
Uconnect Voice Command .....	486
Umbrella Holder .....	115
Uniform Tire Quality Grades .....	378
Universal Garage Door Opener (HomeLink) ..	109
Universal Transmitter .....	109
Unleaded Gasoline .....	384
Untwisting Procedure, Seat Belt .....	176
USB .....	461

**V**

Vacuum .....	103
Stow 'n Vac .....	103
Vanity Mirrors .....	60
Vehicle Identification Number (VIN) .....	383
Vehicle Loading .....	283, 366
Vehicle Modifications/Alterations .....	10
Vehicle Storage .....	92
Vehicle User Guide	
In Vehicle Help .....	11
Navigation .....	11
Operating Instructions .....	11
Searching User Guide .....	11
Viscosity, Engine Oil .....	347
Voice Recognition System (VR) .....	486

**W**

Warning Lights (Instrument	
Cluster Descriptions) .....	144
Warnings And Cautions .....	10
Warranty Information .....	495
Washers, Windshield .....	345
Washing Vehicle .....	380
Water	
Driving Through .....	294
Wheel And Wheel Tire Care .....	376
Wheel And Wheel Tire Trim .....	376
Wind Buffeting .....	97
Window Fogging .....	93
Windshield Defroster .....	214
Windshield Washers .....	65, 345
Fluid .....	345
Windshield Wiper Blades .....	351
Wipers Blade Replacement .....	351
Wipers, Intermittent .....	65
Wrecker Towing .....	336







Whether it's providing information about specific product features, taking a tour through your vehicle's heritage, knowing what steps to take following an accident or scheduling your next appointment, we know you'll find the app an important extension of your Chrysler brand vehicle.

Simply download the app, select your make and model and enjoy the ride. To get this app, go directly to the App Store® or Google Play® Store and enter the search keyword "Chrysler" (U.S. residents only).

U. S.



[mopar.com/om](https://mopar.com/om)

DOWNLOAD A FREE ELECTRONIC COPY OF THE MOST UP-TO-DATE  
OWNER'S MANUAL, UCONNECT AND WARRANTY BOOKLETS

Canada



[owners.mopar.ca](https://owners.mopar.ca)

©2019 FCA US LLC. All Rights Reserved. Chrysler is a registered trademark of FCA US LLC or FCA Canada Inc., used under license. App Store is a registered trademark of Apple Inc. Google Play Store is a registered trademark of Google.