

NOTE:

- This equipment has been tested and found to comply with the limits for a Class B digital device, pursuant to Part 15 of the FCC Rules. These limits are designed to provide reasonable protection against harmful interference in a residential installation. This equipment generates, uses and can radiate radio frequency energy and, if not installed and used in accordance with the instructions, may cause harmful interference to radio communications. However, there is no guarantee that interference will not occur in a particular installation.
- If this equipment does cause harmful interference to radio or television reception, which can be determined by turning the equipment off and on, the user is encouraged to try to correct the interference by one or more of the following measures:
 - a. Increase the separation between the equipment and receiver.
 - b. Consult an authorized dealer or an experienced radio technician for help.

UNCONNECT VOICE RECOGNITION QUICK TIPS

Introducing Uconnect

Start using Uconnect Voice Recognition with these helpful quick tips. It provides the key Voice Commands and tips you need to know to control your Uconnect system.

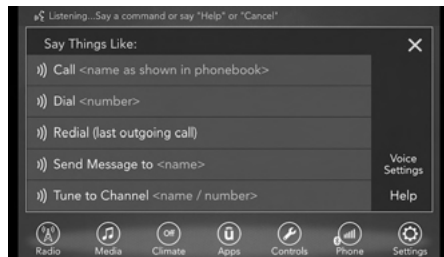

Uconnect 4



Uconnect 4C/4C NAV

NOTE:

If you see the NAV icon on the bottom bar, or in the Apps menus, of your touchscreen, you have the Uconnect 4C NAV system. If not, you have a Uconnect 4C system.

Get Started

All you need to control your Uconnect system with your voice are the buttons on your steering wheel.

Helpful hints for using Voice Recognition:

- Visit UconnectPhone.com to check mobile device and feature compatibility and to find phone pairing instructions.
- Reduce background noise. Wind and passenger conversations are examples of noise that may impact recognition.
- Speak clearly at a normal pace and volume while facing straight ahead. The microphone is positioned on the rearview mirror and aimed at the driver.
- Each time you give a Voice Command, you must first push either the Voice Recognition (VR) or Phone button, wait until after the beep, then say your Voice Command.

- You can interrupt the help message or system prompts by pushing the VR or Phone button and saying a Voice Command from the current category.



Uconnect Voice Command Buttons

- 1 – Push To Initiate Or To Answer A Phone Call, Send Or Receive A Text
- 2 – For All Radios: Push To Begin Radio, Media, Or Climate Functions. For Uconnect 4C NAV System Only: Push To Begin Navigation Function
- 3 – Push To End Call

Basic Voice Commands

The basic Voice Commands below can be given at any point while using your Uconnect system.

Push the VR button . After the beep, say:

- **“Cancel”** to stop a current voice session
- **“Help”** to hear a list of suggested Voice Commands
- **“Repeat”** to listen to the system prompts again

Notice the visual cues that inform you of your voice recognition system’s status. Cues appear on the touchscreen.

Radio

Use your voice to quickly get to the AM, FM, or SiriusXM® Satellite Radio stations you would like to hear. (Subscription or included SiriusXM® Satellite Radio trial required.)

Push the VR button . After the beep, say:

- “Tune to ninety-five-point-five FM”
- “Tune to Satellite Channel Hits 1”

TIP:

At any time, if you are not sure of what to say or want to learn a Voice Command, push the VR button  and say, “Help.” The system provides you with a list of commands.

Media

Uconnect offers connections via USB, Bluetooth® and auxiliary ports (if equipped). Voice operation is only available for connected USB and AUX devices.

Push the VR button . After the beep, say one of the following commands and follow the prompts to switch your media source or choose an artist.

- “Change source to Bluetooth®”
- “Change source to AUX”
- “Change source to USB”
- “Play artist Beethoven”; “Play album Greatest Hits”; “Play song Moonlight Sonata”; “Play genre Classical”

TIP:

Press the Browse button on the touchscreen to see all of the music on your USB device. Your Voice Command must match exactly how the artist, album, song, and genre information is displayed.

Phone

Making and answering hands-free phone calls is easy with Uconnect. When the Phonebook button is illuminated on your touchscreen, your system is ready. Check UconnectPhone.com for mobile phone compatibility and pairing instructions.

Push the Phone button . After the beep, say one of the following commands:

- “Call John Smith”
- “Dial 123-456-7890 and follow the system prompts”
- “Redial (call previous outgoing phone number)”
- “Call back (call previous incoming phone number)”

TIP:

When providing a Voice Command, push the Phone button  and say “Call,” then pronounce the name **exactly** as it appears in your phone book. When a contact has multiple phone numbers, you can say “Call John Smith work.”

Voice Text Reply

Uconnect announces **incoming** text messages. Push the Phone button  and say “Listen.” (Must have compatible mobile phone paired to Uconnect system.)

1. Once an incoming text message is read to you, push the Phone button . After the beep, say: “Reply.”
2. Listen to the Uconnect prompts. After the beep, repeat one of the pre-defined messages and follow the system prompts.

PRE-DEFINED VOICE TEXT REPLY RESPONSES		
Yes.	Stuck in traffic.	See you later.
No.	Start without me.	I'll be late.
Okay.	Where are you?	I will be <number> minutes late.
Call me.	Are you there yet?	

PRE-DEFINED VOICE TEXT REPLY RESPONSES		
I'll call you later.	I need directions.	See you in <number> of minutes.
I'm on my way.	Can't talk right now.	Thanks.
I'm lost.		

TIP:

Your mobile phone must have the full implementation of the **Message Access Profile (MAP)** to take advantage of this feature. For details about MAP, visit UconnectPhone.com.

Apple® iPhone® iOS 6 or later supports reading **incoming** text messages only.

TIP:

Voice Text Reply is not compatible with iPhone®, but if your vehicle is equipped with Siri® Eyes Free, you can use your voice to send a text message.

Climate

Adjust vehicle temperatures hands-free and keep everyone comfortable while you keep moving ahead. (If vehicle is equipped with climate control.)

Push the VR button . After the beep, say one of the following commands:

- “Set driver temperature to 70 degrees”
- “Set passenger temperature to 70 degrees”

TIP:

Voice Command for Climate may only be used to adjust the interior temperature of your vehicle. Voice Command will not work to adjust the heated seats or steering wheel if equipped.

Navigation (4C NAV)

The Uconnect navigation feature helps you save time and become more productive when you know exactly how to get to where you want to go.

1. To enter a destination, push the VR button . After the beep, say: “**Find address** 800 Chrysler Drive Auburn Hills, Michigan.”
2. Then follow the system prompts.

TIP:

To start a POI search, push the VR button . After the beep, say: “**Find nearest** coffee shop.”

Siri® Eyes Free — If Equipped

Siri lets you use your voice to send text messages, select media, place phone calls and much more. Siri uses your natural language to understand what you mean and responds back to confirm your requests. The system is designed to keep your eyes on the road and your hands on the wheel by letting Siri help you perform useful tasks.

To enable Siri, push and hold, then release the Uconnect Voice Recognition (VR) button on the steering wheel. After you hear a double beep you can ask Siri to play podcasts and music, get directions, read text messages and many other useful requests.

Using Do Not Disturb

With Do Not Disturb, you can disable notifications from incoming calls and texts, allowing you to keep your eyes on the road and hands on the wheel. For your convenience, there is a counter display to keep track of your missed calls and text messages while you were using Do Not Disturb.

Do Not Disturb can automatically reply with a text message, a call or both, when declining an incoming call and send it to voicemail.

Automatic reply messages can be:

- “I am driving right now, I will get back to you shortly.”
- Create a custom auto reply message up to 160 characters.

While in Do Not Disturb, Conference Call can be selected so you can still place a second call without being interrupted by incoming calls.

NOTE:

- Only the beginning of your custom message will be seen on the touchscreen.
- Reply with text message is not compatible with iPhones®.
- Auto reply with text message is only available on phones that supporting Bluetooth® MAP.

Android Auto™ — If Equipped

NOTE:

Feature availability depends on your carrier and mobile phone manufacturer. Some Android Auto™ features may or may not be available in every region and/or language.

Android Auto™ allows you to use your voice to interact with Android's™ best-in-class speech technology through your vehicle's voice recognition system, and use your smartphone's data plan to project your Android™ powered smartphone and a number of its apps onto your Uconnect touchscreen. Connect your Android™ 5.0 (Lollipop), or higher, to one of the

media USB ports, using the factory-provided USB cable, and press the new Android Auto™ icon that replaces your “Phone” icon on the main menu bar to begin Android Auto™. Push and hold the VR button on the steering wheel, or press and hold the “Microphone” icon within Android Auto™, to activate Android’s™ VR, which recognizes natural voice commands, to use a list of your smartphone’s features:

- Maps
- Music
- Phone
- Text Messages
- Additional Apps

Refer to your Uconnect Owner’s Manual Supplement for further information.

NOTE:

Requires compatible smartphone running Android™ 5.0 (Lollipop) or higher and download app on Google Play. Android™, Android Auto™, and Google Play are trademarks of Google Inc.

Apple CarPlay® — If Equipped

NOTE:

Feature availability depends on your carrier and mobile phone manufacturer. Some Apple CarPlay® features may or may not be available in every region and/or language.

Apple CarPlay® allows you to use your voice to interact with Siri through your vehicle’s voice recognition system, and use your smartphone’s data plan to project your iPhone® and a number of its apps onto your Uconnect touchscreen. Connect your iPhone® 5, or higher, to one of the media USB ports, using the factory-provided Lightning cable, and press the new Apple CarPlay® icon that replaces your “Phone” icon on the main menu bar to begin Apple CarPlay®. Press and hold the VR button on the steering wheel, or press and hold the “Home” button within Apple CarPlay®, to activate Siri, which recognizes natural voice commands to use a list of your iPhone’s® features:

- Phone
- Music
- Messages

- Maps
- Additional Apps

Refer to your Uconnect Owner’s Manual Supplement for further information.

NOTE:

Requires compatible iPhone®. See dealer for phone compatibility. Data plan rates apply. Vehicle user interface is a product of Apple®. Apple CarPlay® is a trademark of Apple® Inc. iPhone® is a trademark of Apple® Inc., registered in the US and other countries. Apple® terms of use and privacy statements apply.

General Information

The following regulatory statement applies to all Radio Frequency (RF) devices equipped in this vehicle:

This device complies with Part 15 of the FCC Rules and with Innovation, Science and Economic Development Canada license-exempt RSS standard(s). Operation is subject to the following two conditions:

1. This device may not cause harmful interference, and
2. This device must accept any interference received, including interference that may cause undesired operation.

Le présent appareil est conforme aux CNR d'Innovation, Science and Economic Development applicables aux appareils radio exempts de licence. L'exploitation est autorisée aux deux conditions suivantes:

1. l'appareil ne doit pas produire de brouillage, et
2. l'utilisateur de l'appareil doit accepter tout brouillage radioélectrique subi, même si le brouillage est susceptible d'en compromettre le fonctionnement.

La operación de este equipo está sujeta a las siguientes dos condiciones:

1. es posible que este equipo o dispositivo no cause interferencia perjudicial y
2. este equipo o dispositivo debe aceptar cualquier interferencia, incluyendo la que pueda causar su operación no deseada.

NOTE:

Changes or modifications not expressly approved by the party responsible for compliance could void the user's authority to operate the equipment.

Additional Information

© 2019 FCA US LLC. All rights reserved. Mopar and Uconnect are registered trademarks and Mopar Owner Connect is a trademark of FCA US LLC. Android™ is a trademark of Google Inc. SiriusXM® and all related marks and logos are trademarks of SiriusXM® Radio Inc.

Uconnect System Support:

- US residents visit www.DriveUconnect.com or call: 1-877-855-8400(24 hours a day 7 days a week)
- Canadian residents visit www.DriveUconnect.ca or call: 1-800-465-2001(English) or 1-800-387-9983(French)

SiriusXM Guardian™ services support:

- US residents visit www.siriusxm.com/guardian or call: 1-844-796-4827
- Canadian residents visit www.siriusxm.ca/guardian or call: 1-877-324-9091

CUSTOMER ASSISTANCE

SUGGESTIONS FOR OBTAINING SERVICE FOR YOUR VEHICLE

Prepare For The Appointment

If you are having warranty work done, be sure to have the right papers with you. Take your warranty folder. All work to be performed may not be covered by the warranty. Discuss additional charges with the service manager. Keep a maintenance log of your vehicle's service history. This can often provide a clue to the current problem.

Prepare A List

Make a written list of your vehicle's problems or the specific work you want done. If you've had an accident or work done that is not on your maintenance log, let the service advisor know.

Be Reasonable With Requests

If you list a number of items and you must have your vehicle by the end of the day, discuss the situation with the service advisor and list the items in order of priority. At many authorized dealers, you may obtain a rental vehicle at a minimal daily charge. If you need a rental, it is advisable to make these arrangements when you call for an appointment.

IF YOU NEED ASSISTANCE

The manufacturer and its authorized dealers are vitally interested in your satisfaction. We want you to be happy with our products and services.

Warranty service must be done by an authorized dealer. We strongly recommend that you take the vehicle to an authorized dealer. They know your vehicle the best, and are most concerned that you get prompt and high quality service. The manufacturer's authorized dealers have the facilities, factory-trained technicians, special tools, and the latest information to ensure the vehicle is fixed correctly and in a timely manner.

This is why you should always talk to an authorized dealer service manager first. Most matters can be resolved with this process.

- If for some reason you are still not satisfied, talk to the general manager or owner of the authorized dealer. They want to know if you need assistance.
- If an authorized dealer is unable to resolve the concern, you may contact the manufacturer's customer center.

Any communication to the manufacturer's customer center should include the following information:

- Owner's name and address
- Owner's telephone number (home, mobile, and office)
- Authorized dealer name
- Vehicle Identification Number (VIN)
- Vehicle delivery date and mileage

FCA US LLC Customer Center

P.O. Box 21-8004

Auburn Hills, MI 48321-8004

Phone: (800) 247-9753

FCA Canada Inc. Customer Center

P.O. Box 1621

Windsor, Ontario N9A 4H6

Phone: (800) 465-2001 English / (800) 387-9983 French

In Mexico Contact

Av. Prolongacion Paseo de la Reforma, 1240

Sante Fe C.P. 05109

Mexico, D. F.

In Mexico City: 800-505-1300

Outside Mexico City: +(52)55 50817568

Puerto Rico And US Virgin Islands

FCA Caribbean LLC

P.O. Box 191857

San Juan 00919-1857

Phone: (800) 247-9753

Fax: (787) 782-3345

Customer Assistance For The Hearing Or Speech Impaired (TDD/TTY)

To assist customers who have hearing difficulties, the manufacturer has installed special TDD (Telecommunication Devices for the Deaf) equipment at its customer center. Any hearing or speech impaired customer, who has access to a TDD or a conventional teletypewriter (TTY) in the United States, can communicate with the manufacturer by dialing 1-800-380-CHRY.

Canadian residents with hearing difficulties that require assistance can use the special needs relay service offered by Bell Canada. For TTY teletypewriter users, dial 711 and for Voice callers, dial 1-800-855-0511 to connect with a Bell Relay Service operator.

Service Contract

You may have purchased a service contract for a vehicle to help protect you from the high cost of unexpected repairs after the manufacturer's New Vehicle Limited Warranty expires. The manufacturer stands behind only the manufacturer's service contracts. If you purchased a manufacturer's service contract, you will receive Plan Provisions and an Owner Identification Card in the mail within three weeks of the vehicle delivery date. If you have

any questions about the service contract, call the manufacturer's Service Contract National Customer Hotline at 1-800-521-9922 (Canadian residents, call (800) 465-2001 English / (800) 387-9983 French).

The manufacturer will not stand behind any service contract that is not the manufacturer's service contract. It is not responsible for any service contract other than the manufacturer's service contract. If you purchased a service contract that is not a manufacturer's service contract, and you require service after the manufacturer's New Vehicle Limited Warranty expires, please refer to the contract documents, and contact the person listed in those documents.

We appreciate that you have made a major investment when you purchased the vehicle. An authorized dealer has also made a major investment in facilities, tools, and training to assure that you are absolutely delighted with the ownership experience. You will be pleased with their sincere efforts to resolve any warranty issues or related concerns.

WARNING!

Engine exhaust (internal combustion engines only), some of its constituents, and certain vehicle components contain, or emit, chemicals known to the State of California to cause cancer and birth defects, or other reproductive harm. In addition, certain fluids contained in vehicles and certain products of component wear contain, or emit, chemicals known to the State of California to cause cancer and birth defects, or other reproductive harm.

WARRANTY INFORMATION

See the Warranty Information for the terms and provisions of FCA US LLC warranties applicable to this vehicle and market.

MOPAR PARTS

Mopar fluids, lubricants, parts, and accessories are available from an authorized dealer. They are recommended for your vehicle in order to help keep the vehicle operating at its best.

REPORTING SAFETY DEFECTS**In The 50 United States And Washington, D.C.**

If you believe that your vehicle has a defect that could cause a crash or cause injury or death, you should immediately inform the National Highway Traffic Safety Administration (NHTSA) in addition to notifying FCA US LLC.

If NHTSA receives similar complaints, it may open an investigation, and if it finds that a safety defect exists in a group of vehicles, it may order a recall and remedy campaign. However, NHTSA cannot become involved in individual problems between you, an authorized dealer or FCA US LLC.

To contact NHTSA, you may call the Vehicle Safety Hotline toll free at 1-888-327-4236 (TTY: 1-800-424-9153); or go to <http://www.safercar.gov>; or write to: Administrator, NHTSA, 1200 New Jersey Avenue, SE., West Building, Washington, D.C. 20590. You can also obtain other information about motor vehicle safety from <http://www.safercar.gov>.

In Canada

If you believe that your vehicle has a safety defect, you should contact the Customer Service Department immediately. Canadian customers who wish to report a safety defect to the Canadian government should contact Transport Canada, Motor Vehicle Defect Investigations and Recalls at 1-800-333-0510 or go to <http://www.tc.gc.ca/roadsafety/>.

PUBLICATION ORDER FORMS

To order the following manuals, you may use either the website or the phone numbers listed below.

Service Manuals

These comprehensive Service Manuals provide the information that students and professional technicians need in diagnosing/troubleshooting, problem solving, maintaining, servicing, and repairing FCA US LLC vehicles. A complete working knowledge of the vehicle, system, and/or components is written in straightforward language with illustrations, diagrams, and charts.

Diagnostic Procedure Manuals

Diagnostic Procedure Manuals are filled with diagrams, charts and detailed illustrations. These practical manuals make it easy for students and technicians to find and fix problems on computer-controlled vehicle systems and features. They show exactly how to find and correct problems the first time, using step-by-step troubleshooting and drivability procedures, proven diagnostic tests and a complete list of all tools and equipment.

Owner's Manuals

These Owner's Manuals have been prepared with the assistance of service and engineering specialists to acquaint you with specific FCA US LLC vehicles. Included are starting, operating, emergency and maintenance procedures as well as specifications, capabilities and safety tips.

Call toll free at:

- **1-800-890-4038 (US)**
- **1-800-387-1143 (Canada)**

Or

Visit us on the Worldwide Web at:

- www.techauthority.com (US)

INDEX

- A**
- About Your Brakes383
 - Adaptive Cruise Control (ACC) (Cruise Control)236
 - Adding Engine Coolant (Antifreeze)357
 - Additives, Fuel385
 - Adjust
 - Down45
 - Forward45
 - Rearward45
 - Up45
 - Air Bag184
 - Air Bag Operation185
 - Air Bag Warning Light183, 186
 - Driver Knee Air Bag190
 - Enhanced Accident Response194, 339
 - Event Data Recorder (EDR).....339
 - Front Air Bag186
 - If Deployment Occurs193
 - Knee Impact Bolsters190
 - Maintaining Your Air Bag System.....195
 - Maintenance195
 - Redundant Air Bag Warning Light.....183
 - Side Air Bags.....190
 - Transporting Pets213
 - Air Bag Light141, 183, 214
 - Air Cleaner, Engine (Engine Air Cleaner Filter).....348
 - Air Conditioner Maintenance349
 - Air Conditioner Refrigerant.....349, 350
 - Air Conditioner System.....349
 - Air Conditioning Filter93, 350
 - Air Conditioning, Operating Tips92
 - Air Filter348
 - Air Pressure
 - Tires369
 - Alarm
 - Arm The System22
 - Disarm The System22
 - Security Alarm.....143
 - Alterations/Modifications
 - Vehicle10
 - Android Auto490
 - Antifreeze (Engine Coolant).....357, 387
 - Disposal358
 - Anti-Lock Brake System (ABS).....152
 - Anti-Lock Warning Light.....144
 - Apple CarPlay491
 - Ashtray121
 - Assist, Hill Start.....157
 - Audio Jack461
 - Audio Settings439
 - Audio Systems (Radio).....391
 - Automatic Dimming Mirror.....57
 - Automatic Headlights62
 - Automatic Temperature Control (ATC)92
 - Automatic Transaxle225
 - Automatic Transmission226
 - Adding Fluid361, 390
 - Fluid And Filter Change361
 - Fluid Change361
 - Fluid Level Check360, 361
 - Fluid Type360, 390
 - Special Additives360
 - AUX Cord461
 - Aux Mode442
 - Auxiliary Electrical Outlet (Power Outlet).....119
 - Axle Lubrication390
- B**
- Back-Up Camera278
 - Battery143, 346
 - Charging System Light143
 - Jump Starting331
 - Keyless Key Fob Replacement.....14
 - Battery Saver Feature63
 - Belts, Seat214
 - Blind Spot Monitoring.....159

Bluetooth		
Connect Or Disconnect Link Between the Uconnect Phone And Mobile Phone	459	
Connecting To A Particular Mobile Phone Or Audio Device After Pairing	454	
Bluetooth Mode.....	443	
Body Mechanism Lubrication.....	351	
B-Pillar Location	366	
Brake Assist System	153	
Brake Control System, Electronic	153	
Brake Fluid.....	390	
Brake System	359, 383	
Anti-Lock (ABS)	383	
Fluid Check.....	359, 390	
Master Cylinder	359	
Parking	222	
Warning Light.....	141	
Brake/Transmission Interlock.....	226	
Brightness, Interior Lights	64	
Bulb Replacement	300, 304	
Bulbs, Light	215, 300, 304	
C		
Camera	278	
Camera, Rear	278, 279	
Capacities, Fluid	387	
Caps, Filler		
Fuel.....	282, 333	
Oil (Engine).....	344	
Radiator (Coolant Pressure).....	358	
Car Washes.....	380	
Carbon Monoxide Warning.....	213, 386	
Cargo		
Vehicle Loading	103	
Cargo Area Cover.....	103	
Cargo Compartment		
Luggage Carrier	122	
Cargo Load Floor	103	
Cargo Tie-Downs	103	
Cellular Phone	485	
Center High Mounted Stop Light	305	
Certification Label	283	
Chains, Tire	377	
Change Oil Indicator	130	
Changing A Flat Tire	314, 361	
Chart, Tire Sizing	362	
Check Engine Light (Malfunction Indicator Light).....	151	
Checking Your Vehicle For Safety	213	
Checks, Safety	213	
Child Restraint.....	196	
Child Restraints		
Booster Seats	199	
Center Seat LATCH.....	205	
Child Seat Installation.....	207, 209	
How To Stow An unused ALR Seat Belt ...	206	
Infant And Child Restraints	198	
Lower Anchors And Tethers For Children	201	
Older Children And Child Restraints	199	
Seating Positions.....	200	
Using The Top Tether Anchorage	211	
Cigar Lighter	121	
Clean Air Gasoline	384	
Cleaning		
Wheels.....	376	
Climate Control.....	68	
Automatic	80	
Manual	68	
Rear	77, 89	
Coat Hook	118	
Cold Weather Operation.....	220	
Compact Spare Tire	374	
Computer, Trip/Travel	140	
Contract, Service.....	494	
Cooling Pressure Cap (Radiator Cap)	358	

Cooling System	356	Disposal		Engine.....	344
Adding Coolant (Antifreeze).....	357	Antifreeze (Engine Coolant)	358	Air Cleaner	348
Coolant Level	358	Disturb.....	458, 490	Block Heater	221
Cooling Capacity	387	Door Ajar	142, 143	Break-In Recommendations	222
Disposal Of Used Coolant.....	358	Door Ajar Light.....	142, 143	Checking Oil Level	345
Drain, Flush, And Refill	357	Driver's Seat Back Tilt	31	Compartment	344
Inspection	356, 358	Driving		Compartment Identification	344
Points To Remember.....	359	Through Flowing, Rising,		Coolant (Antifreeze).....	388
Pressure Cap	358	Or Shallow Standing Water	294	Cooling.....	356
Radiator Cap.....	358	DVD Player (Video Entertainment		Exhaust Gas Caution	213, 386
Selection Of Coolant		System).....	462	Fails To Start	220
(Antifreeze)	357, 387, 388	E		Flooded, Starting.....	220
Corrosion Protection	380	Electric Brake Control System.....	153	Fuel Requirements	384
Cruise Control (Speed Control)	236	Anti-Lock Brake System.....	152	Oil.....	347, 387, 388
Cruise Light	147, 148, 149	Traction Control System.....	158	Oil Filler Cap.....	344
Customer Assistance	493	Electric Parking Brake	222	Oil Filter	348
Cybersecurity.....	391	Electric Remote Mirrors	58	Oil Selection	347, 387
D		Electronic Speed Control (Cruise Control)	234	Oil Synthetic	347
Daytime Brightness, Interior Lights.....	64	Electronic Stability Control (ESC)	154	Overheating	333
Daytime Running Lights	60	Electronic Throttle Control Warning Light.....	142	Starting.....	216
Dealer Service	346	Emergency, In Case Of		Engine Oil Viscosity	347
Defroster, Windshield	214	Hazard Warning Flasher	296	Engine Oil Viscosity Chart.....	347
Delay (Intermittent) Wipers	65	Jacking.....	314, 316, 361	Enhanced Accident Response	
Diagnostic System, Onboard.....	150	Jump Starting	331	Feature.....	194, 339
Dimmer Switch		Overheating.....	333	Ethanol.....	385
Headlight	60	Towing	336	Exhaust Gas Cautions	213, 386
Dipsticks		Emission Control System Maintenance	151	Exhaust System	213, 355
Oil (Engine).....	345			Exterior Lighting.....	60, 304
Disable Vehicle Towing.....	336			Exterior Lights	60, 215, 300, 304

F

Filters	
Air Cleaner.....	348
Air Conditioning	93, 350
Engine Oil.....	348, 388
Engine Oil Disposal	348
Flashers	
Hazard Warning.....	296
Turn Signals.....	60, 148, 215, 304
Flash-To-Pass	60, 61
Flat Tire Changing.....	314, 361, 374
Flat Tire Stowage	324, 361, 374
Flooded Engine Starting	220
Fluid Capacities.....	387
Fluid Leaks	215
Fluid Level Checks	
Brake	359
Fluid, Brake	390
Fluids And Lubricants	388
Fog Lights	60, 62, 305
Fog Lights, Service	305
Fold In Floor (Stow 'n Go) Seating	39
Fold-Flat Seats	31
Forward Collision Warning.....	164
Freeing A Stuck Vehicle	335
Front Position Light	304

Fuel	384
Additives.....	385
Clean Air	384
Ethanol.....	385
Filler Cap (Gas Cap).....	282
Gasoline	384
Materials Added	385
Methanol	385
Octane Rating.....	384, 388
Requirements	384
Specifications	388
Tank Capacity	387
Fuses	306

G

Garage Door Opener (HomeLink).....	109
Gas Cap (Fuel Filler Cap).....	282
Gasoline, (Fuel).....	384
Gasoline, Clean Air.....	384
Gasoline, Reformulated	384
Gear Ranges	227
Glass Cleaning.....	382
Gross Axle Weight Rating.....	285
Gross Vehicle Weight Rating	284
GVWR	283

H

Hazard	
Driving Through Flowing, Rising, Or Shallow Standing Water	294
Hazard Warning Flashers	296
Head Restraints.....	52
Headlights	60
Bulb Replacement	303
Cleaning	380
High Beam/Low Beam Select Switch.....	60
Lights On Reminder.....	60, 62
Passing	60, 61
Replacing	303
Switch.....	60
Time Delay.....	60
Washers.....	62
Heated Mirrors	57, 58
Heater, Engine Block.....	221
Hill Start Assist	157
Hitches	
Trailer Towing	286
HomeLink (Garage Door Opener)	109
Hood Prop	98
Hood Release.....	98
Hook, Coat	118

I		
Ignition	16	
Switch	16	
In Vehicle Help		
Vehicle User Guide	11	
Inside Rearview Mirror	57, 296	
Instrument Cluster	127	
Descriptions	148	
Display	128	
Menu Items	133	
Instrument Panel Lens Cleaning	382	
Interior And Instrument Lights	63	
Interior Appearance Care	381	
Interior Lights	63	
Intermittent Wipers (Delay Wipers)	65	
Inverter		
Power	120	
iPod/USB/MP3 Control	441	
J		
Jack Location	314	
Jack Operation	314, 361	
Jump Starting	331	
K		
Key Fob	12	
Arm The System	22	
Disarm The Alarm	22	
Programming Additional Key Fobs	15, 21	
Key Fob Battery Service (Remote Keyless Entry)	14	
Key Fob Programming (Remote Keyless Entry)	15	
Keys	12	
Replacement	21	
L		
Lane Change And Turn Signals	60	
Lane Change Assist	60, 63	
LaneSense	275	
Lap/Shoulder Belts	173	
Latches	215	
Hood	98	
Lead Free Gasoline	384	
Leaks, Fluid	215	
Life Of Tires	372	
Liftgate	99	
Power	100	
Light Bulbs	215, 304	
Lighter		
Cigar	121	
Lights	215	
Air Bag	141, 183, 214	
Battery Saver	63	
Brake Assist Warning	156	
Brake Warning	141	
Bulb Replacement	300, 304	
Center Mounted Stop	305	
Cruise	147, 148, 149	
Daytime Running	60	
Dimmer Switch, Headlight	60	
Engine Temperature Warning	142	
Exterior	215, 304	
Fog	62, 305	
Headlights	60, 62, 303	
High Beam/Low Beam Select	60	
Instrument Cluster	60	
Intensity Control	64	
Interior	63	
Lights On Reminder	60, 62	
Malfunction Indicator (Check Engine)	145	
Parade Mode (Daytime Brightness)	64	
Park	148	
Passing	60, 61	
Reading	63	
Seat Belt Reminder	143	
Security Alarm	143	
Service	300	
Side Marker	304	
SmartBeams	61	
Traction Control	156	
Turn Signals	60, 148, 215, 304	
Warning Instrument Cluster Descriptions	142, 148	
Load Floor, Cargo	103	
Load Shed Battery Saver Mode	138	
Load Shed Battery Saver On	138	
Load Shed Electrical Load Reduction	138	
Load Shed Intelligent Battery Sensor	138	

Loading Vehicle	103, 283	Rearview	57, 296	Pressure Warning Light	144
Tires	366	Vanity	60	Recommendation	347, 387
Low Tire Pressure System	167	Modifications/Alterations		Synthetic	347
Lubrication, Body	351	Vehicle	10	Viscosity	347, 387
Lug Nuts	383	Monitor, Tire Pressure System	167	Onboard Diagnostic System	150
Luggage Carrier	122	Mopar Parts	495	Operating Precautions	150
M		MP3 Control	461	Operator Manual	
Maintenance Free Battery	346	Multi-Function Control Lever	60	Owner's Manual	9, 496
Maintenance Schedule	340	N		Outside Rearview Mirrors	57
Malfunction Indicator Light		New Vehicle Break-In Period	222	Overheating, Engine	333
(Check Engine)	145, 151	O		Owner's Manual (Operator Manual)	9
Manual		Occupant Restraints	171	P	
Park Release	334	Octane Rating, Gasoline (Fuel)	384, 388	Paint Care	380
Service	496	Oil Change Indicator	130	Parking Brake	222
Map/Reading Lights	63	Reset	130	ParkSense System, Rear	250, 256
Marker Lights, Side	304	Oil Filter, Change	348	Pets	213
Media Hub	461	Oil Filter, Selection	348	Placard, Tire And Loading Information	366
Memory Feature (Memory Seats)	31	Oil Pressure Light	144	Power	
Memory Seat	31, 58	Oil, Engine	347, 388	Brakes	383
Memory Seats And Radio	31	Capacity	387	Inverter	120
Methanol	385	Change Interval	347	Mirrors	58
Mini-Trip Computer	140	Checking	345	Outlet (Auxiliary Electrical Outlet)	119
Mirrors	57	Disposal	348	Seats	45, 46
Automatic Dimming	57	Filter	348, 388	Steering	231
Electric Remote	58	Filter Disposal	348	Power Seats	
Exterior Folding	58	Identification Logo	347	Down	45
Heated	57, 58	Materials Added To	347	Forward	45
Outside	57			Rearward	45
				Up	45

Power Sliding Door		Seat Belts	172, 214
On / Off Switch	28, 100	Adjustable Shoulder Belt	176
Pregnant Women And Seat Belts	179	Adjustable Upper Shoulder Anchorage	176
Preparation For Jacking.....	315	Adjustable Upper Shoulder Belt	
Pretensioners		Anchorage.....	176
Seat Belts	180	Automatic Locking Retractor (ALR).....	180
R		Child Restraints.....	196
Radial Ply Tires.....	371	Energy Management Feature	180
Radiator Cap (Coolant Pressure Cap).....	358	Extender.....	179
Radio		Front Seat.....	172, 173, 175
Presets	435	Inspection.....	214
Radio Operation	434, 485	Lap/Shoulder Belt Operation	175
Rear Air Conditioning.....	77, 89	Lap/Shoulder Belt Untwisting	176
Rear Camera	279	Lap/Shoulder Belts	173
Rear Cross Path	162	Operating Instructions	175
Rear ParkSense System	250, 256	Pregnant Women.....	179
Rear Seat Removal	33	Pretensioners	180
Rear View	57	Rear Seat	173
Reclining Front Seats.....	32	Reminder	172
Recreational Towing	293	Seat Belt Extender	179
Reformulated Gasoline	384	Seat Belt Pretensioner	180
Refrigerant.....	350	Untwisting Procedure	176
Release, Hood	98	Seat Belts Maintenance.....	381
Reminder, Lights On	60	Seats	31, 45, 50
Reminder, Seat Belt	172	Adjustment	31, 32, 33, 45
Remote Control		Bench	33
Starting System	18	Heated.....	50
		Power	45, 46
Remote Keyless Entry			
Arm The Alarm	22		
Disarm The Alarm	22		
Programming Additional Key Fobs.....	15, 21		
Remote Starting			
Exit Remote Start Mode.....	19		
Uconnect Customer Programmable			
Features	20		
Uconnect Settings.....	20		
Remote Starting System.....	18		
Replacement Bulbs.....	300		
Replacement Keys.....	21		
Replacement Tires.....	372		
Reporting Safety Defects.....	495		
Restraints, Child.....	196		
Restraints, Head	52		
Roof Luggage Rack	122		
Rotation, Tires	377		
S			
Safety Checks Inside Vehicle	214		
Safety Checks Outside Vehicle.....	215		
Safety Defects, Reporting	495		
Safety Information, Tire.....	361		
Safety Tips	213		
Safety, Exhaust Gas	213		
Schedule, Maintenance	340		
Seat Belt Reminder.....	143		

Rear Folding	31	Snow Chains (Tire Chains)	377	Stow 'n Vac.....	103
Reclining	32	Snow Tires	374	Stuck, Freeing	335
Seatback Release	31, 33	Spare Tire Changing.....	314	Sun Roof	96
Stow 'n Go (Fold in Floor)	39	Spare Tire Stowage.....	324	Sunglasses Storage	121
Tilting.....	31, 33	Spare Tires	314, 374, 375	Supplemental Restraint System – Air Bag ...	184
Security Alarm.....	143	Spark Plugs.....	388	Sway Control, Trailer	158
Arm The System.....	22	Specifications		Synthetic Engine Oil	347
Disarm The System.....	22	Oil	388	System, Remote Starting	18
Selection Of Coolant (Antifreeze)	388	Speed Control		T	
Sentry Key		Accel/Decel (ACC Only).....	240	Telescoping Steering Column	56
Key Programming	21	Cancel.....	236	Temperature Control, Automatic (ATC).....	92
Sentry Key (Immobilizer).....	20	Resume.....	236	Tie Down Hooks, Cargo	103
Sentry Key Replacement	21	Speed Control (Cruise Control).....	234, 236	Tilt Steering Column	56
Service Assistance	493	Starting.....	18, 216	Time Delay	
Service Contract	494	Button.....	16	Headlight.....	60
Service Manuals.....	496	Cold Weather	220	Tire And Loading Information Placard.....	366
Shifting		Engine Fails To Start.....	220	Tire Markings	361
Automatic Transmission.....	226	Remote	18	Tire Safety Information	361
Shoulder Belts	173	Starting And Operating.....	216	Tire Service Kit	324
Side View Mirror Adjustment.....	57	Starting Procedures	216	Tire Stowage	324
Signals, Turn	60, 148, 215, 304	Steering	231	Tires	215, 369, 374, 378
Siri	490	Tilt Column	56	Aging (Life Of Tires)	372
Sirius Satellite Radio	436	Wheel, Heated	56	Air Pressure	369
Favorites.....	437	Wheel, Tilt	56	Chains	377
Replay	437	Steering Wheel Audio Controls.....	461	Changing.....	314, 361
SiriusXM Satellite Radio		Steering Wheel Mounted Sound		Compact Spare	374
Browse in SXM	438	System Controls	461	General Information	369, 374
Favorites.....	437	Storage, Vehicle	92	High Speed	370
Replay	437	Store Radio Presets	435	Inflation Pressure	369
SmartBeams	61	Stow 'n Go (Fold In Floor) Seats	39		

- Jacking 314, 316, 361
 Life Of Tires 372
 Load Capacity 366
 Pressure Monitoring
 System (TPMS)..... 133, 146, 167
 Quality Grading..... 378
 Radial..... 371
 Replacement 372
 Rotation..... 377
 Safety..... 361, 369
 Sizes 362
 Snow Tires..... 374
 Spare Tires 314, 374, 375
 Spinning 371
 Trailer Towing..... 290
 Tread Wear Indicators 372
 Wheel Nut Torque 383
 To Open Hood 98
 Tongue Weight/Trailer Weight..... 289
 Towing 284
 Disabled Vehicle 336
 Guide 286
 Recreational 293
 Weight..... 286
 Towing Behind A Motorhome..... 293
 Traction 294
 Traction Control 158
 Trailer Sway Control (TSC)..... 158
 Trailer Towing..... 284
 Cooling System Tips 292
 Hitches..... 286
 Minimum Requirements 289
 Tips 292
 Trailer And Tongue Weight 289
 Wiring 291
 Trailer Towing Guide..... 286
 Trailer Weight 286
 Transaxle
 Automatic 225
 Operation..... 225
 Transmission..... 226
 Automatic 226, 360
 Maintenance 360
 Transporting Pets 213
 Tread Wear Indicators 372
 Turn Signals 60, 148, 304
- U**
 Uconnect
 Advanced Phone Connectivity..... 459
 Phone Call Features 456
 Theater 462
 Things You Should Know About Your
 Uconnect Phone 459
 Uconnect Settings..... 20
 Uconnect 4 With 7-Inch Display 392
 Uconnect 4C/4C Nav With 8.4-Inch Display 410
 Uconnect Phone 452, 453, 454, 455
 Answer Or Ignore An Incoming Call –
 Call Currently In Progress 457
 Answer Or Ignore An Incoming Call –
 No Call Currently In Progress..... 457
 Bluetooth Communication Link 460
 Call By Saying A Phonebook Name..... 457
 Call Continuation..... 459
 Call Controls..... 457
 Call Termination 458
 Cancel Command 452
 Connect Or Disconnect Link Between
 The Uconnect Phone And
 Mobile Phone..... 459

Connecting To A Particular

Mobile Phone Or Audio Device	
After Pairing	454
Deleting A Phone Or Audio Device	455
Dial By Saying A Number	456
Disconnecting A Phone Or Audio	
Device	455
Far End Audio Performance	460
Help Command	452
Join Calls	458
Making A Phone Or Audio Device	
A Favorite	455
Making A Second Call While Current	
Call Is In Progress	458
Managing Your Favorites	456
Natural Speech	452
Operation	451
Pair (Link) Uconnect Phone To A	
Mobile Phone	452
Pair A Bluetooth Streaming Audio Device	454
Pair Additional Mobile Phones	453
Phonebook Download	455
Place/Retrieve A Call From Hold	458
Power-Up	460
Recent Calls	457
Redial	458
To Remove A Favorite	456
Toggling Between Calls	458
Touch-Tone Number Entry	457

Transfer Call To And From Mobile

Phone	459
Voice Command	459
Ways To Initiate A Phone Call	456
Uconnect Settings	
Customer Programmable Features	20
Uconnect Voice Command	486
Umbrella Holder	115
Uniform Tire Quality Grades	378
Universal Garage Door Opener (HomeLink) ..	109
Universal Transmitter	109
Unleaded Gasoline	384
Untwisting Procedure, Seat Belt	176
USB	461

V

Vacuum	103
Stow 'n Vac	103
Vanity Mirrors	60
Vehicle Identification Number (VIN)	383
Vehicle Loading	283, 366
Vehicle Modifications/Alterations	10
Vehicle Storage	92
Vehicle User Guide	
In Vehicle Help	11
Navigation	11
Operating Instructions	11
Searching User Guide	11
Viscosity, Engine Oil	347
Voice Recognition System (VR)	486

W

Warning Lights (Instrument	
Cluster Descriptions)	144
Warnings And Cautions	10
Warranty Information	495
Washers, Windshield	345
Washing Vehicle	380
Water	
Driving Through	294
Wheel And Wheel Tire Care	376
Wheel And Wheel Tire Trim	376
Wind Buffeting	97
Window Fogging	93
Windshield Defroster	214
Windshield Washers	65, 345
Fluid	345
Windshield Wiper Blades	351
Wipers Blade Replacement	351
Wipers, Intermittent	65
Wrecker Towing	336



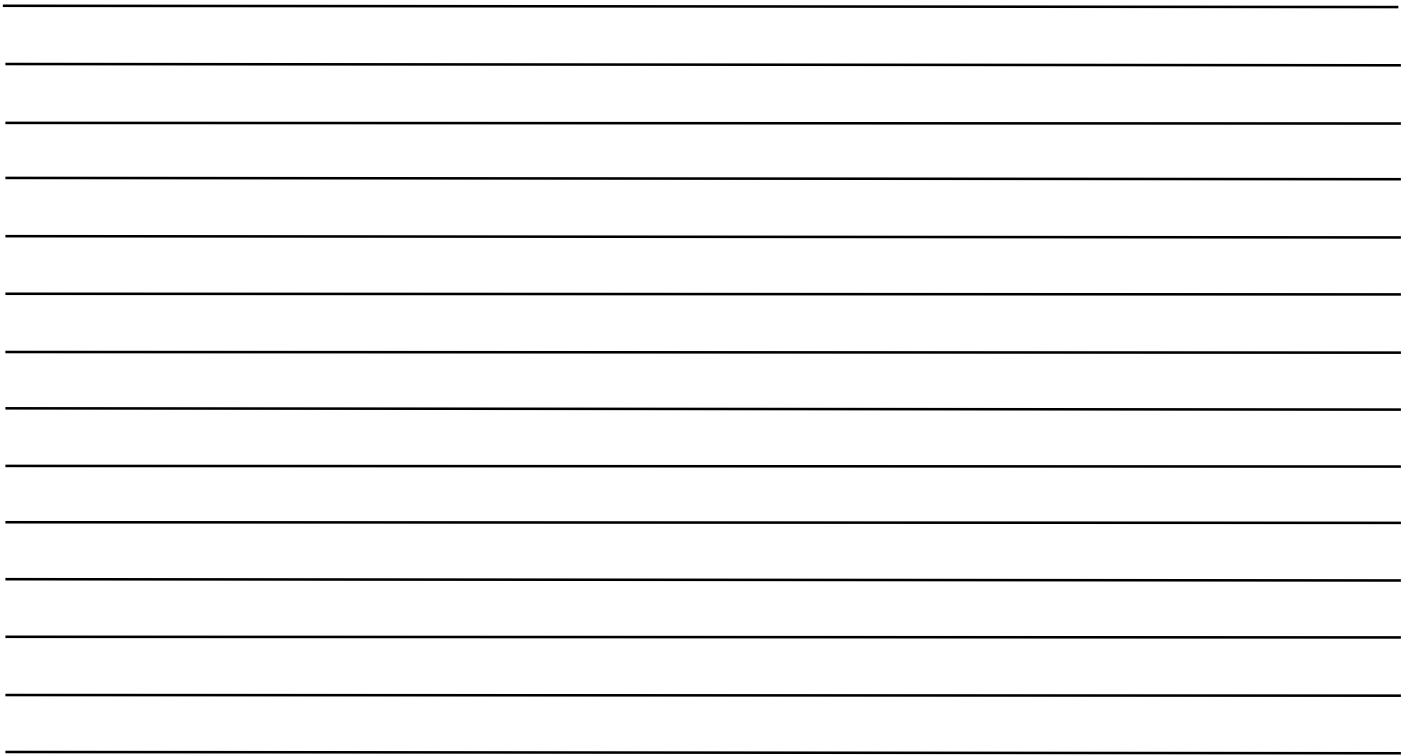



Whether it's providing information about specific product features, taking a tour through your vehicle's heritage, knowing what steps to take following an accident or scheduling your next appointment, we know you'll find the app an important extension of your Chrysler brand vehicle.

Simply download the app, select your make and model and enjoy the ride. To get this app, go directly to the App Store® or Google Play® Store and enter the search keyword "Chrysler" (U.S. residents only).

U. S.



mopar.com/om

DOWNLOAD A FREE ELECTRONIC COPY OF THE MOST UP-TO-DATE
OWNER'S MANUAL, UCONNECT AND WARRANTY BOOKLETS

Canada



owners.mopar.ca

©2019 FCA US LLC. All Rights Reserved. Chrysler is a registered trademark of FCA US LLC or FCA Canada Inc., used under license. App Store is a registered trademark of Apple Inc. Google Play Store is a registered trademark of Google.