

<i>Emne:</i>	Antenna specifications	<i>Date:</i>	19-10-2023	<i>Page:</i>	1 of 4
<i>Section:</i>	Dokumentation	<i>Respon:</i>	MBM	<i>Version:</i>	1

Antenna specifications

The antennas implemented on Audio Assistant is an PCB Inverted F-antenna. The IFA is designed to an impedance of 50 ohm at 2.45 GHz.

The PCB antenna is designed by Develco Products.

Maximum Ant gain +1 dBm

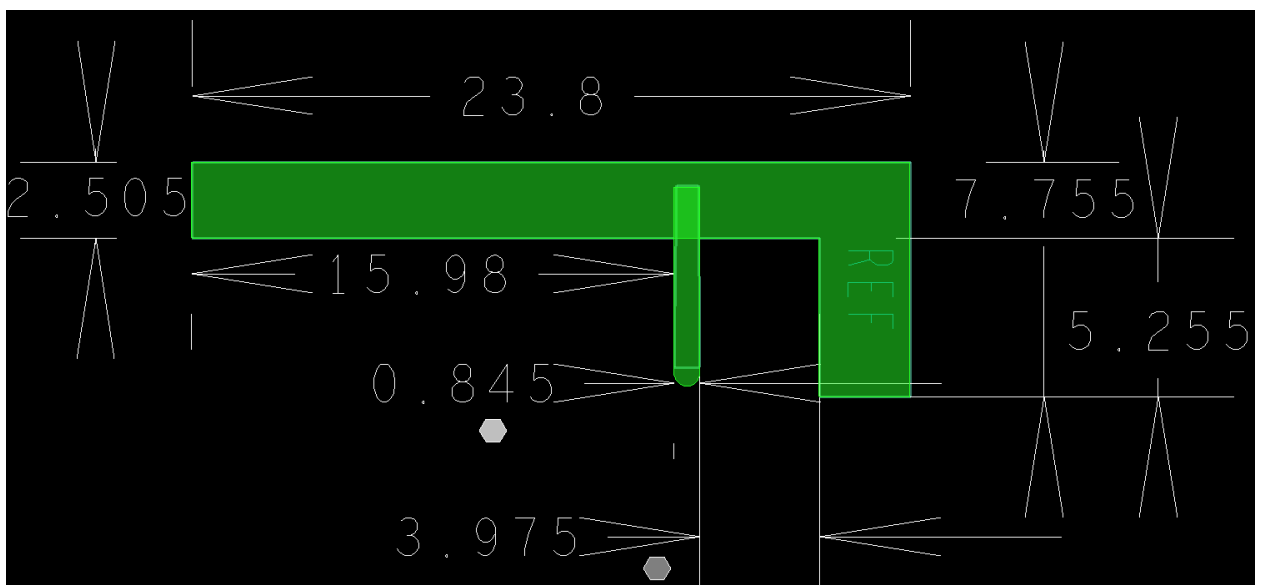

All dimensions are in millimetres.

<i>Emne:</i>	Antenna specifications	<i>Date:</i>	19-10-2023	<i>Page:</i>	2 of 4
<i>Section:</i>	Dokumentation	<i>Respon:</i>	MBM	<i>Version:</i>	1

1 Bluetooth Antenna radiation pattern

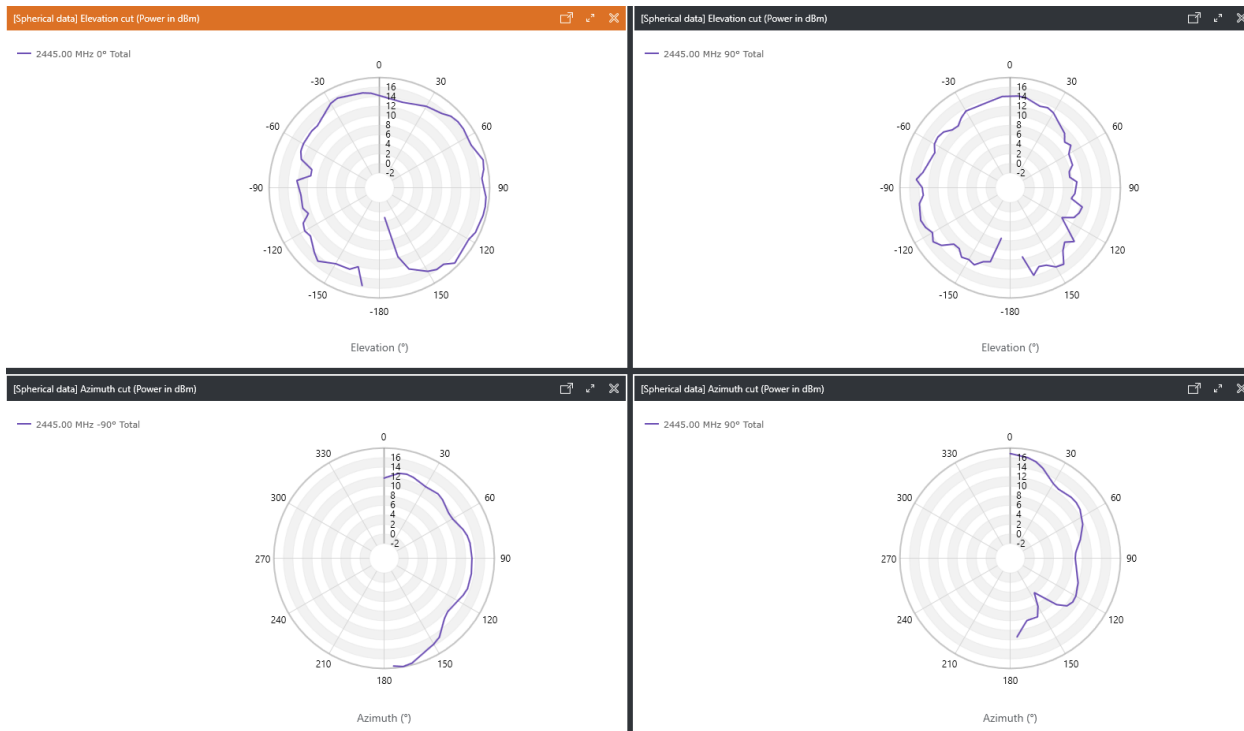

<i>Emne:</i>	Antenna specifications	<i>Date:</i>	19-10-2023	<i>Page:</i>	3 of 4
<i>Section:</i>	Dokumentation	<i>Respon:</i>	MBM	<i>Version:</i>	1

2 ZigBee Antenna radiation pattern



Emne:	Antenna specifications	Date:	19-10-2023	Page:	4 of 4
Section:	Dokumentation	Respon:	MBM	Version:	1

3 Coordinate System

