

# X9 instructions

## 一、Function parameter:

Heart rate monitor    Blood oxygen monitor    Sleep monitor

QQ/Wechat remind    Message remind    Call remind

Calories    Steps    Sedentary remind    Date display

Alarm clock    Drink water remind

Display screen	0.96 OLED
Battery capacity	75MA
Synchronization mode	Bluetooth 4.0
Working voltage	5.0V
Charging method	USBplug
Waterproof rating	IP67
Equipment requirements	IOS 7.1 and above、Android4.3 and above    Bluetooth 4.0

## 二、Charging

Equipment need to pass the professional aging test before be carried out from the factory .Please full charge the smart bracelet before first use, Charging time is about two hours.Please remove the charging head (As picture below), insert the 5V /1A standard USB interface charging, such as computer, USB interface charger, power bank.when the power

icon full grid, the charge is complete.

**In this direction to pull the connection of strap and the display bottom ,  
remove the charging head**

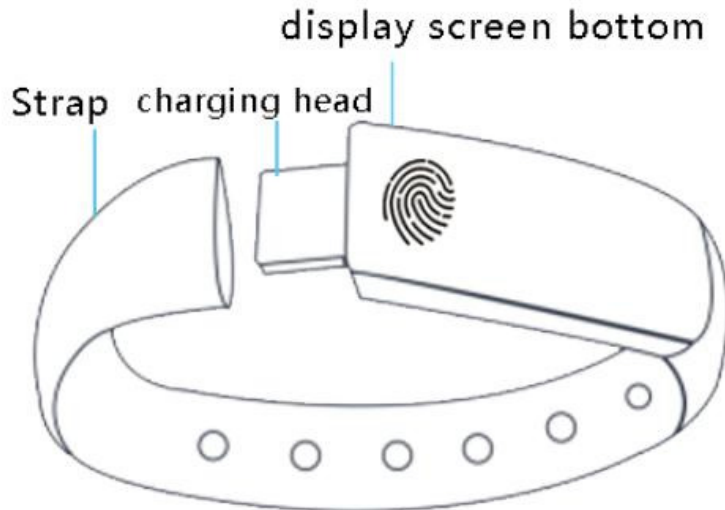

( Figure: the figure for smart bracelet USB interface to open )

### 三、 APPDownload

Way one:download APP by scan the below code



Way two: from the Apple APP Store or 360, Baidu and other

major application software market search "GetFit 3.0" download.

Way three: WeChat search "iwear" concerned about the public

number, reply "GetFit 3.0 "download.

#### 四、Bracelet Bluetooth binding APP

1. After the download is complete, open the APP, enter the login screen, according to the prompts to complete the personal information to fill out.

2. Click  to enter the "device scan" interface; click the Bluetooth icon to start scanning the device; scan is complete, click to connect your device.



#### 五、APP function description



## 六、 After-sale question

If you have any questions, please follow the instructions below:

Open the APP >>into the management menu>>click on the system settings >>click on the help

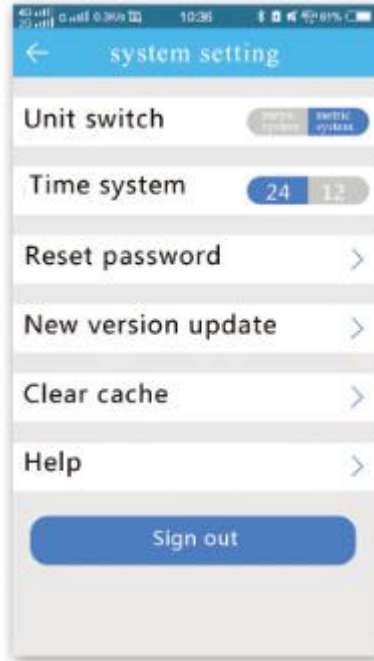
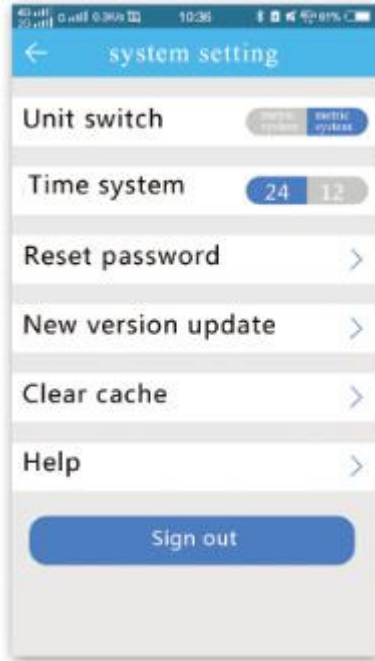

## FCC Warning:

This equipment has been tested and found to comply with the limits for a Class B digital device, pursuant to part 15 of the FCC Rules. These limits are designed to provide reasonable protection against harmful interference in a residential installation. This equipment generates, uses and can radiate radio frequency energy and, if not installed and used in accordance with the instructions, may cause harmful interference to radio communications. However, there is no guarantee that interference will not occur in a particular installation. If this equipment does cause harmful interference to radio or television reception, which can be determined by turning the equipment off and on, the user is encouraged to try to correct the interference by one or more of the following measures:

- o Reorient or relocate the receiving antenna.
- o Increase the separation between the equipment and receiver.
- o Connect the equipment into an outlet on a circuit different from that to which the receiver is connected.
- o Consult the dealer or an experienced radio/TV technician for help.

Caution: Any changes or modifications to this device not explicitly approved by manufacturer could void your authority to operate this equipment.

This device complies with part 15 of the FCC Rules. Operation is subject to the following two conditions: (1) This device may not cause harmful interference, and (2) this device must accept any interference received, including interference that may cause undesired operation.

The device has been evaluated to meet general RF exposure requirement. The device can be used in portable exposure condition without restriction.