

Universal Wireless 4.3" Mirror/Monitor and Camera

Visit IBEAMUSA.com for more detailed information about the product and up-to-date vehicle-specific applications.



Product Features

- Wireless camera and mirror/monitor kit
- 4.3" LCD Monitor
- 20 M / 65 FT range
- DC socket for monitor power with USB for smart device charging
- Video triggered by the camera's signal

Part Components

A) Mirror/Monitor B) Camera w/ dual mounting options C) Accessories

A



B



C



TABLE OF CONTENTS

| | |
|-----------------------|-----|
| Installation..... | 2-3 |
| Wireless Pairing..... | 4 |
| Display Settings..... | 5 |
| Wire Lenses..... | 6 |
| Specifications..... | 7 |

TOOLS REQUIRED

- Wire stripper
- Tape
- Digital Multi-meter
- Cutter

Attention! When testing the aftermarket equipment, ensure that all factory equipment is connected before cycling the key to ignition.

MONITOR INSTALLATION

Mirror/Monitor install and wiring

1. Carefully extend the clips on the back of the clip-on mirror and attach to the current rearview mirror in the vehicle.
2. Plug the DC socket into the mirror and run the wire in the path shown in Figure A and safely hide the wire from being pulled or caught on while operating the vehicle.
4. Plug the DC socket into the socket in the vehicle. There is an additional USB port on the back of the DC socket so smart device charging can still be done. (Figure B)

NOTE: If your vehicle DC socket has power while the vehicle is powered down, you may need to unplug the monitor while parked so the battery does not discharge.

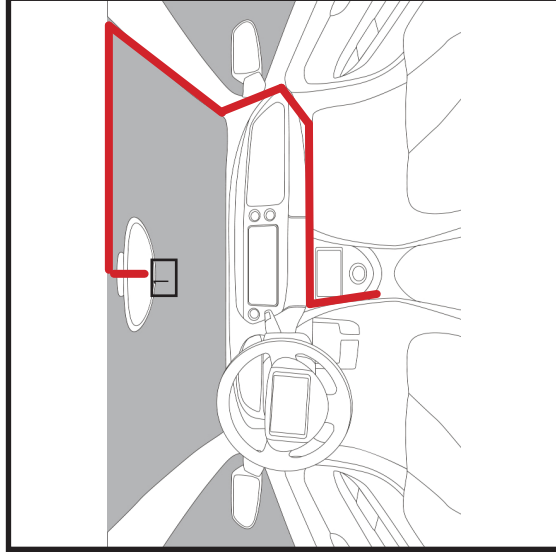

Figure A



Figure B

CAMERA INSTALLATION

Camera Installation

1. Mount the camera with either the surface mount or the license plate mount. If wanting the surface mount, the two small screws will need to be removed to remove the license plate mount and replace with surface mount.
2. Remove the tail light from the vehicle to allow access to the light bulbs wiring. (If help is needed, review the vehicles owners manual section on replacing the tail light bulbs.) **(Figure A)**
3. Find the wiring that connects to the reverse bulb. There is normally 2 wires. **(Figure B)** Strip the insulation to expose the copper wire.
4. Using a Digital Multi-meter on the DC Voltage setting, to verify the reverse wire. **(Figure C)**
5. Connect the wires from the camera
 - Connect the **RED** wire to reverse, either found at the taillight or another source for reverse.
 - Connect the **BLACK** wire to chassis ground.

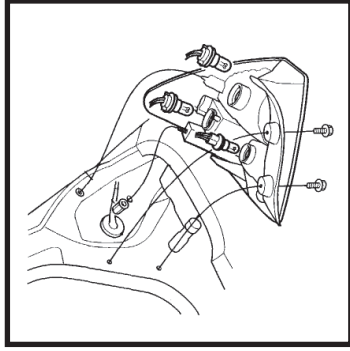

Figure A

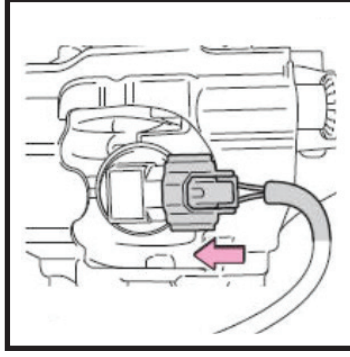

Figure B

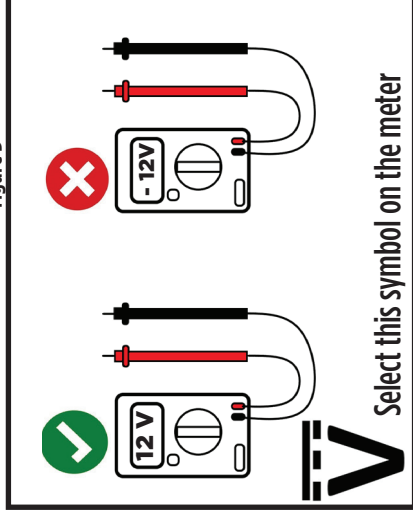

Figure C

Mirror/Monitor to Camera pairing

1. Before operation, the camera and mirror need to be paired to each other. Start by connecting power to both devices. If camera is connected to reverse, the vehicle must be put into the reverse gear. **NOTE: Please activate parking brake while pairing for safety.**
2. Once both devices are paired, Press the MENU button (middle button) on the mirror and then choose the **PAIRING** selection. Then press and hold the MENU button for 2 seconds to select **PAIRING**.
3. The monitor will count down 20 seconds to achieve the pairing of camera to monitor. Once the pairing has happened, the camera image will appear. The camera and monitor are now paired
4. Put the vehicle back into PARK, turn the vehicle off, turn the vehicle back on and shift into reverse to test the camera and monitor.



Figure A

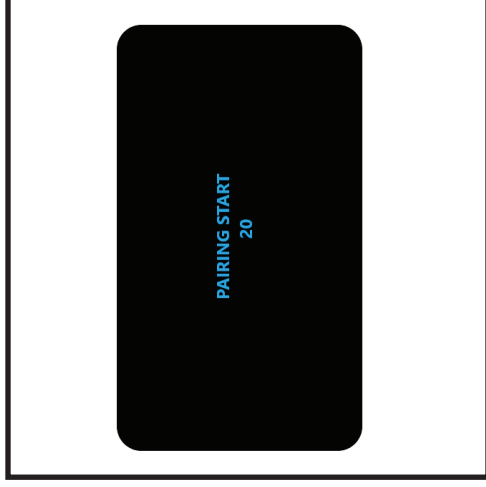

Figure B

DISPLAY SETTINGS

Display Settings

Brightness

1. Press the MENU button (middle button) to enter into the settings menu, use the + and - buttons (+ = top button, - = bottom button) to navigate to the PICTURE menu. Press and hold the MENU button for 2 seconds to enter the PICTURE menu.
2. Press the + and - buttons to navigate to the setting you want to choose. Then press and hold the MENU button for 2 seconds
3. Use the + and - buttons to increase or decrease the set values.
4. Press the MENU button to exit the settings.

Reversing/flipping the image

1. Press the MENU button to enter into the settings menu, use the + and - buttons to navigate to the MIR-FLIP menu. Press and hold the MENU button to enter the MIR-FLIP menu.
2. Using the + and - buttons to switch between NORMAL, MIRROR, FLIP or MIRROR FLIP.
3. Press the MENU button to exit the settings.

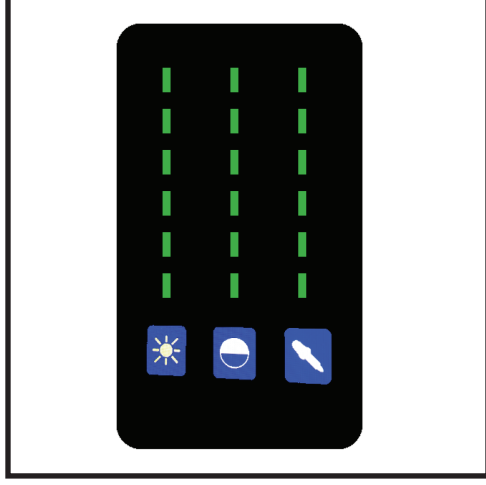
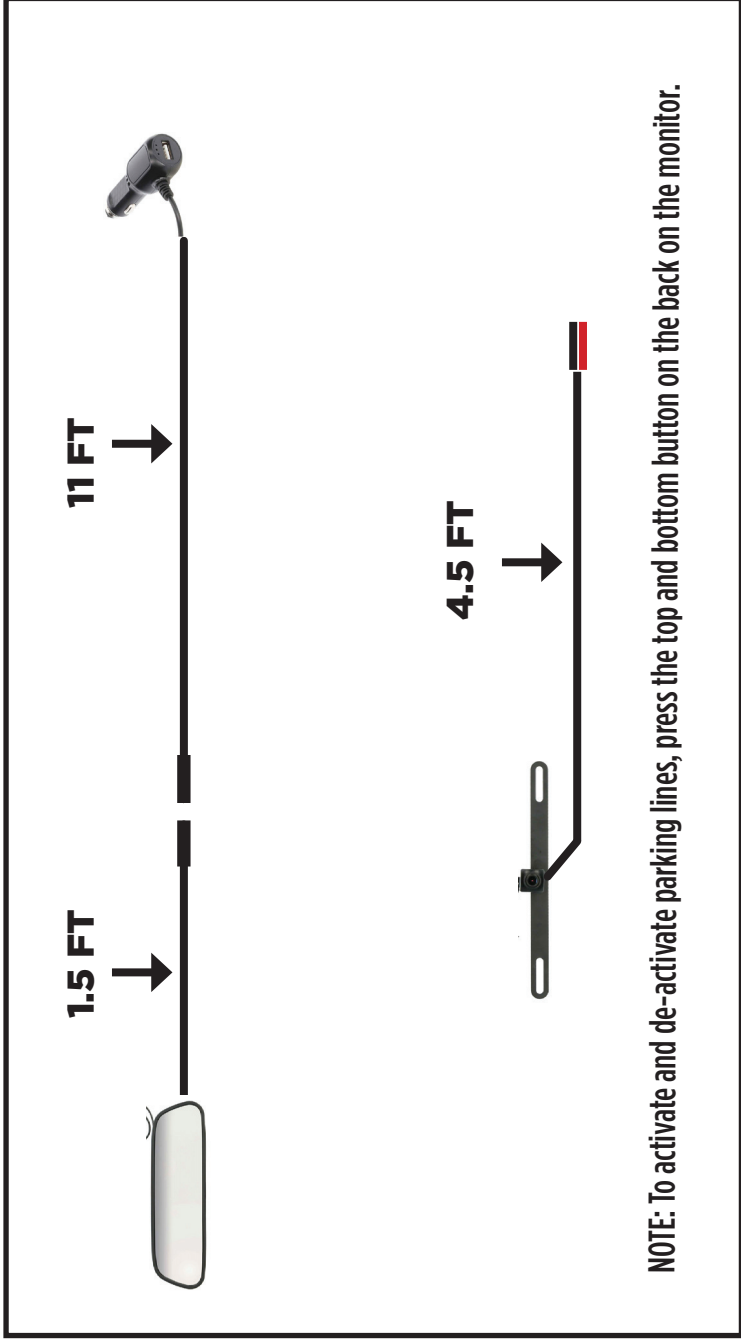

Figure A



Figure B

WIRE LENGTHS



NOTE: To activate and de-activate parking lines, press the top and bottom button on the back on the monitor.

SPECIFICATIONS

| | |
|--------------------|-----------------------------|
| TV SYSTEM | NTSC |
| EFFECTIVE PIXEL | 976 X 592 pixels |
| IP RATING | IP67 |
| VISUAL ANGLE | 120 horizontal 170 diagonal |
| MIN. ILLUMINATION | 0.1 Lux |
| WORKING VOLTAGE | 9 - 16V |
| WORKING TEMP. | -30 C ~ 70 C |
| STORAGE TEMP. | - 40 C ~ 120 C |
| SCREEN SIZE | 4.3 inch LCD |
| DISPLAY RESOLUTION | 480 X 272 |
| ASPECT RATIO | 16:9 |
| POWER CONSUMPTION | less than 3 w |



Having difficulties? We're here to help.

Contact our Tech Support line at:

386-257-1187



Or via email at:

techsupport@metra-autosound.com



Tech Support Hours (Eastern Standard Time)

Monday - Friday: 9:00 AM - 7:00 PM

Saturday: 10:00 AM - 7:00 PM

Sunday: 10:00 AM - 4:00 PM



® KNOWLEDGE IS POWER

Enhance your installation and fabrication skills by enrolling in the most recognized and respected training program in the industry. Visit www.installerinstitute.com or call 800-354-6782 for more information and take steps toward a better tomorrow.



Metra Recommends MECP
certified technicians

FCC Warnings

This device complies with part 15 of the FCC rules. Operation is subject to the following two conditions: (1) this device may not cause harmful interference, and (2) this device must accept any interference received, including interference that may cause undesired operation.

Warning: Changes or modifications to this unit not expressly approved by the party responsible for compliance could void the user's authority to operate the equipment.

NOTE: This equipment has been tested and found to comply with the limits for a Class B digital device, pursuant to Part 15 of the FCC Rules. These limits are designed to provide reasonable protection against harmful interference in a residential installation. This equipment generates, uses, and can radiate radio frequency energy and, if not installed and used in accordance with the instructions, may cause harmful interference to radio communications. However, there is no guarantee that interference will not occur in a particular installation. If this equipment does cause harmful interference to radio or television reception, which can be determined by turning the equipment off and on, the user is encouraged to try to correct the interference by one or more of the following measures:

- Reorient or relocate the receiving antenna.
- Increase the separation between the equipment and receiver.
- Connect the equipment into an outlet on a circuit different from that to which the receiver is connected.
- Consult the dealer or an experienced radio/TV technician for help.

Radiation Exposure Statement

To comply with FCC RF exposure compliance requirements, this grant is applicable to only mobile configurations. The antennas used for this transmitter must be installed to provide a separation distance of at least 20cm from all persons and must not be co-located or operating in conjunction with any other antenna or transmitter.