

# **NX529J**

## **User Manual**

### **Copyright Statement**

Copyright © 2016 by Nubia Technology Co., Ltd.

All the copyrights of this document herein belong to Nubia Technology Co., Ltd. Without the written permission of copyright owner, no part of this publication may be excerpted, reproduced, translated by any person or entity in any form or by any means.

This document is subject to change without prior notice.

Nubia Technology Co., Ltd keeps the right to make the final explanation to this document.

### **Trademarks**

Android is a trademark of Google, Inc.

All other trademarks remain the property of their respective owners.

### **Statement of Third-party Applications**

During the installation process of some third-party applications, the issues of repeated restart or abnormal use of software might be caused by incompatibility of the third-party applications, rather than the phone itself.

Version 1.0, April 2016

# Phone overview

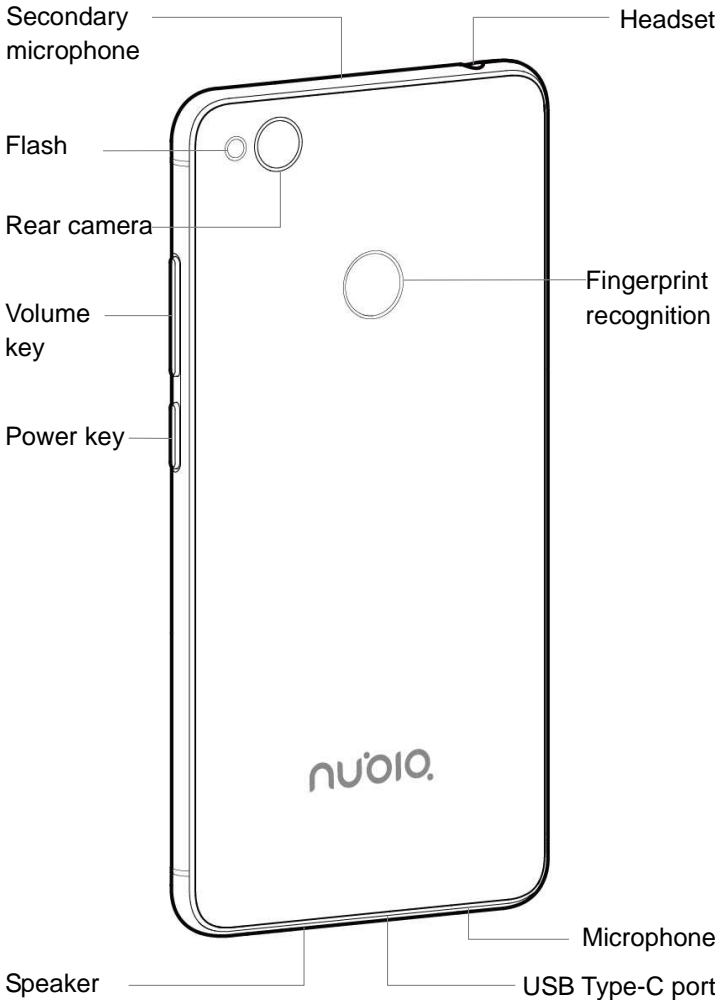
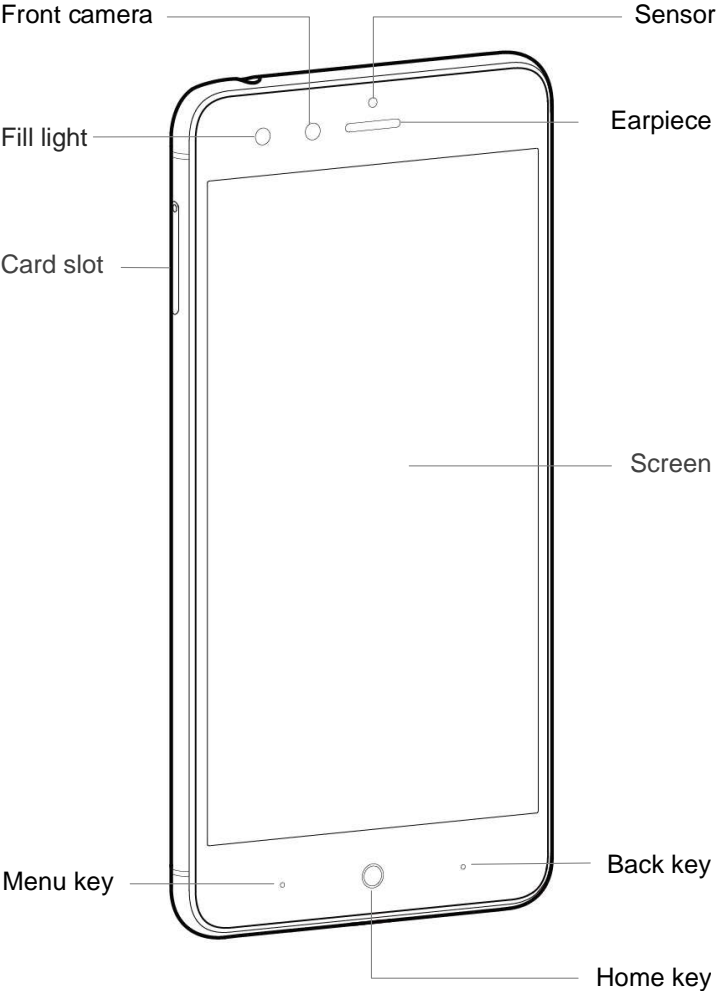

**Note:**  
Do not try to open rear cover, Battery cannot be removed by user.

## Knowing the Keys

Key	Function
Power Key	<ul style="list-style-type: none"><li>• Press and hold to power on, or power off.</li><li>• Press to turn off or on the screen display.</li><li>• Long Press 10-12 Sec to reboot handset.</li></ul>
Home Key	<ul style="list-style-type: none"><li>• Touch to return to the Home Screen from any application or screen.</li><li>• Touch and hold to switch between recent apps.</li></ul>
Menu Key	<ul style="list-style-type: none"><li>• Touch to get the options for the current screen.</li></ul>
Back Key	<ul style="list-style-type: none"><li>• Touch to go to the previous screen.</li></ul>
Volume key	<ul style="list-style-type: none"><li>• Press or hold to turn the volume up or down.</li></ul>

## Getting started

### Inserting the SIM and memory card

Please make sure that the phone is powered off before proceeding.

Install Nano-SIM & Nano-SIM card OR Install Nano-SIM & memory card.

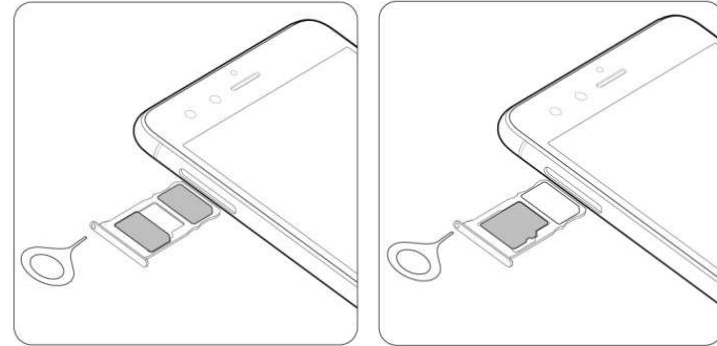

SIM SLOT 1: Nano-SIM card slot

SIM SLOT 2: Nano-SIM or memroy card slot

### Charging the battery

Connect the phone to the power outlet using the included USB cable and power adapter.

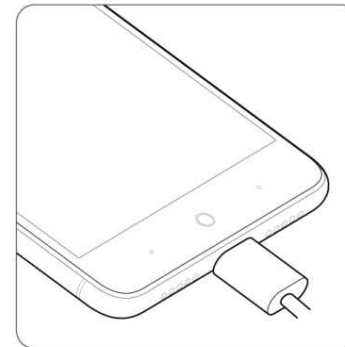

## Screen lock

You can increase the security of your phone by selecting screen lock .Screen lock settings can be found under “Settings”>“Security and Privacy”>“Screen lock”.

## Customize home screen

In standby mode, touch and hold an empty area to set wallpapers. To customize the home screen, you can move/remove/add items.

## Camera

NX529J are designed for you to share wonderful moments with friends and family.

Adjust focus, exposure, zoom in or zoom out, switch between cameras and switch between the functions by flipping the icon on the screen.

## Internet

You can enjoy network by selecting 4G, 3G, WLAN, and GSM. Enjoy music, videos, apps and news anywhere and anytime as you like.

## Make a call

You can make a call under the interface of Call log, contacts, favorites, message (which contains a phone number). In standby mode, press call key to make a call.

## Messaging

Touch and hold the text box to select an input method. You can insert pleased face to be used, audio or video files and send to multiple recipients.

## Email

The email app enables you to read, compose and send emails, and is configured to work with all the major email providers. NX529J supports multiple account mode, and you won't miss any email.

## Music

NX529J supports various music formats(supports AMR-WB,WAV MP3, iMelody, Midi ringtone and FLAC), different sound effects and categorizes your files on the basis of Artists, Albums, Songs & Playlists.

## Videos

Enjoy a visual feast in a variety of video formats(supports H.263,H.264 and mpge4 ), please choose NX529J.

## Photos

NX529J supports jpeg, jpg, bmp, gif and png. You will find it very easy to view all the photos. Flick right or left to move among images. Double-tap or pinch the photo to zoom. You can edit, share, print, and more.

## Intelligent keyboard

NX529J automatically corrects and suggests words as you type, and it also supports voice input.

## Cut, copy, and paste

Touch and hold text content to bring up the magnifying glass, and then slide your finger to move the insertion points. Then tap to cut, copy, or paste. It is very easy to copy text from web pages, email, or text messages.

## Map

You can view satellite images or street maps with detailed route instructions just as you are walking in the street. The Map app can be used to locate yourself, view real-time traffic conditions, pedestrian, bus routes or car driving route instructions.

## Extending Battery Life

- Few points, to improve battery life.
- Turn OFF radio services i.e. Wi-Fi, Bluetooth and GPS, when not needed.
- Keep screen brightness on Auto Mode.
- Use Bluetooth tethering or USB tethering (when you have a cable) instead of portable Wi-Fi hotspot to share your phone's data service.
- From the home screen, hold the home key to close the recent apps running in background.

CAUTION : RISK OF EXPLOSION IF BATTERY IS REPLACED BY AN INCORRECT TYPE. DISPOSE OF USED BATTERIES ACCORDING TO THE INSTRUCTIONS.

### Note:

Due to non-usage of Phone for long time battery may be drained out and it needs to be connected with charger and allow battery to charge about 30-40 minutes in off state. If still the problem persists, suggested to visit the nearest Device Care Centre.

## Correct disposal

- Do not dispose off your mobile and its battery in fire.
- Do not dispose your mobile with the regular waste.



This marking on the product, accessories or literature indicates that the product and its electronic accessories (e.g. charger, headset, USB cable) should not be disposed of with other household waste. This product is RoHS compliant.



This marking on the battery, manual or packaging indicates that the batteries in this product should not be disposed of with other household waste.

## Safety information

Read all safety information before using the device to ensure safe and proper use.

 **Warning**

Following the warning information provided below to prevent incidents such as fire or explosion:

- Do not expose the device to physical impact or damage.
- Do not carry your device in your back pockets or on your waist.
- Use manufacturer-approved batteries, chargers, accessories, and supplies.
- Prevent the multipurpose jack and battery terminals from contacting conductive elements, such as metal or liquids.
- Do not touch the device with wet hands. Also, do not use the device in humid environments, such as rest rooms, or during water-based activities, such as swimming.
- If any part of the device is cracked or broken, or if the device becomes very hot, stop using the device immediately and take it to a Device care Centre.
- Do not turn on or use the device when the battery compartment is exposed.

**Fellow the warnings below to prevent injury to people or damage to the device**

- Do not allow children or animals to chew or suck the device.
- Do not poke eyes, ears, or other body parts with the device or insert the device into the mouth.
- If the device has a camera flash or light, do not use it close to the eyes of people or animals.

- Do not store your device in very hot or very cold areas.
- Do not store your device near or in heaters, microwaves, cooking equipment, or high pressure containers.
- Keep your device dry.
- Do not use your device outdoor during a thunderstorm.
- Comply with all safety warnings and regulations regarding mobile device usage while operating a vehicle.
- Adapter shall be installed near the equipment and shall be easily accessible.
- The phone's normal operating temperature is 0°C ~ 45°C .In order to ensure the normal phone functions, do not use this phone outside the temperature range.



Use careful with the earphone maybe possible excessive sound pressure from earphones and headphones can cause hearing loss.

## Health and safety

### ▶ FCC Regulations:

This mobile phone complies with part 15 of the FCC Rules. Operation is subject to the following two conditions: (1) This device may not cause harmful interference, and (2) this device must accept any interference received, including interference that may cause undesired operation.

This mobile phone has been tested and found to comply with the limits for a Class B digital device, pursuant to Part 15 of the FCC Rules. These limits are designed to provide reasonable protection against harmful interference in a residential installation. This equipment generates, uses and can radiated radio frequency energy and, if not installed and used in accordance with the instructions, may cause harmful interference to radio communications. However, there is no guarantee that interference will not occur in a particular installation. If this equipment does cause harmful interference to radio or television reception, which can be determined by turning the equipment off and on, the user is encouraged to try to correct the interference by one or more of the following measures:

- Reorient or relocate the receiving antenna.
- Increase the separation between the equipment and receiver.
- Connect the equipment into an outlet on a circuit different from that to which the receiver is connected.

-Consult the dealer or an experienced radio/TV technician for help.

### FCC Note:

Caution: Changes or modifications not expressly approved by the party responsible for compliance could void the user's authority to operate the equipment.

### ▶ RF exposure information (SAR)

This phone is designed and manufactured not to exceed the emission limits for exposure to radio frequency (RF) energy set by the Federal Communications Commission of the United States.

During SAR testing, this device was set to transmit at its highest certified power level in all tested frequency bands, and placed in positions that simulate RF exposure in usage against the head with no separation, and near the body with the separation of 10 mm. Although the SAR is determined at the highest certified power level, the actual SAR level of the device while operating can be well below the maximum value. This is because the phone is designed to operate at multiple power levels so as to use only the power required to reach the network. In general, the closer you are to a wireless base station antenna, the lower the power output.

The exposure standard for wireless devices employing a unit of measurement is known as the Specific Absorption Rate, or SAR.

The SAR limit set by the FCC is 1.6 W/kg.

This device is complied with SAR for general

population /uncontrolled exposure limits in ANSI/IEEE C95.1-1992 and had been tested in accordance with the measurement methods and procedures specified in IEEE1528. This device has been tested and meets the FCC RF exposure guidelines when tested with the device directly contacted to the body.

The FCC has granted an Equipment Authorization for this model phone with all reported SAR levels evaluated as in compliance with the FCC RF exposure guidelines. SAR information on this model phone is on file with the FCC and can be found under the Display Grant section of [www.fcc.gov/oet/ea/fccid](http://www.fcc.gov/oet/ea/fccid) after searching on FCC ID: 2AHJO-NX529J.

For this device, the highest reported SAR value for usage against the head is 1.02W/kg, for usage near the body is 1.02W/kg.

While there may be differences between the SAR levels of various phones and at various positions, they all meet the government requirements.

SAR compliance for body-worn operation is based on a separation distance of 10 mm between the unit and the human body. Carry this device at least 10 mm away from your body to ensure RF exposure level compliant or lower to the reported level. To support body-worn operation, choose the belt clips or holsters, which do not contain metallic components, to maintain a separation of 10 mm between this device and your body.

RF exposure compliance with any body-worn accessory, which contains metal, was not tested

and certified, and use such body-worn accessory should be avoided.

## **Declaration of RoHS compliance**

We're determined to reduce the impact we have on the environment and take responsibility for the earth we live on. So this document allows us to formally declare that NX529J, manufactured by Nubia Technology Co., Ltd, fully complies with the European Parliament's RoHS (Restriction of Hazardous Substances) Directive 2002/95/EC, with respect to all the following substances:

- (1) Lead (Pb)
- (2) Mercury (Hg)
- (3) Cadmium (Cd)
- (4) Hexavalent Chromium (Cr (VI))
- (5) Polybrominated biphenyl (PBB)
- (6) Polybrominated diphenyl ether (PBDE)

Our compliance is witnessed by written declaration from our suppliers. This confirms that any potential trace contamination levels of the substances listed above are below the maximum level set by EU 2002/95/EC, or are exempt due to their application.

The NX529J manufactured by Nubia Technology Co., Ltd, meets all the requirements of EU 2002/95/EC.