

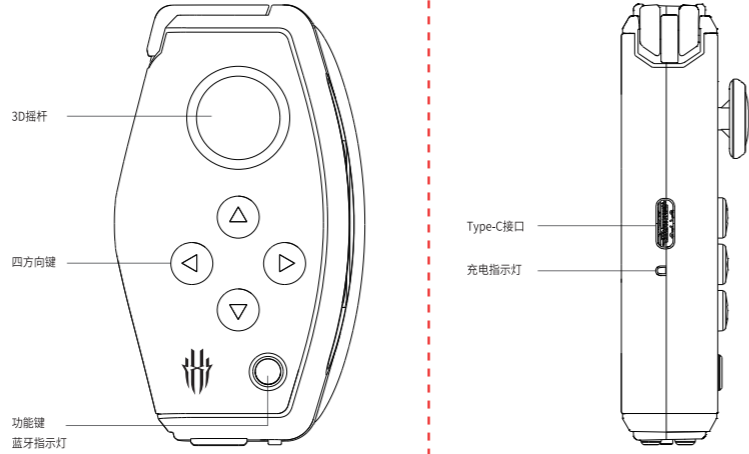

红魔电竞手柄 用户指南

手柄按键功能和说明

1. 拨动开关键, 实现手柄开机/关机功能。
2. 开启手柄后, 自动启动蓝牙配对和连接, 请打开手机蓝牙, 找到名称为: "GH1001_XXXX" 蓝牙连接配对。
3. 拨动手柄技能按键, 进入游戏空间界面, 点击 图标查看手柄连接状态和电量, 点击手柄校准可根据提示进行摇杆校准。
4. 手柄摇杆及按键已按部分热门游戏适配, 如需自定义请在手柄连接手机后, 打开游戏, 从屏幕边缘往左滑, 打开游戏控制中心, 点击手柄设置后进行自定义。

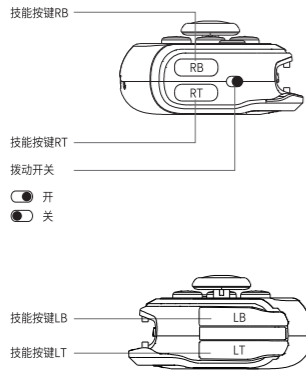

- 单击: 唤醒手柄, 启动匹配或者连接。
- 游戏中单击: 调出手柄按键映射界面。

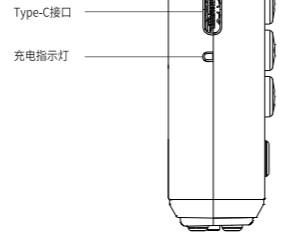

* 产品CMIT ID请参见手柄背面标识。

指示灯说明

蓝牙指示灯状态

- 休眠: 不亮
- 待配对模式: 红灯闪烁
- 配对成功: 红灯长亮

充电指示灯状态

- 低电量: 红灯闪烁
- 充电中: 红灯长亮

手柄休眠

- 处于激活状态且3分钟未配对或者未连接到手机。
- 连接到手机且5分钟未操作手柄。

充电方法

手柄内置不可拆卸的锂聚合物电池, 首次使用前请给手柄充满电。使用USB Type-C充电线连接手柄和提供USB接口的设备, 设备输出电压为5V。

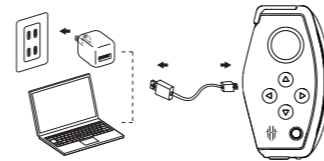

手柄使用方法

手柄需要配套专用保护套使用。

左手使用

手柄沿保护套左侧 (顶部) 划入轨道, 将手机往手柄底部推, 直至停止位后表示手柄正确安装。

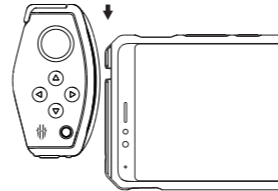

右手使用

手柄沿保护套右侧 (底部) 划入轨道, 将手机往手柄顶部推, 直至停止位后表示手柄正确安装。

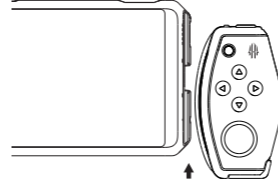

手柄性能参数

设备名称: 红魔电竞手柄
产品型号: GH1001
蓝牙芯片: 蓝牙4.2ble
载波频率: 2.402 GHz~2.480 GHz
连接距离: 10m
支持平台: 安卓4.4以上
摇杆: 1个3D摇杆

技能按键: 8个 (上、下、左、右、LT、LB、RT、RB)
功能按键: 1个 (用于调出手柄按键映射设置界面)
LED指示灯: 2个, 红
充电接口: Type-C

电池规格: 3.7 V/340 mAh锂聚合物电池
充电规格: 支持5 V/1 A-2 A充电适配器
充电时长: 2-2.5小时
持续工作时长: 40小时以上

工作温度: -5 °C~40 °C
存储温度: -20 °C~60 °C
最大输出功率: 3.0dBm (EIRP)

附件: 说明书

有毒有害物质说明

部件名称	有害物质					
	铅 (Pb)	汞 (Hg)	镉 (Cd)	六价铬 (Cr(VI))	多溴联苯 (PBB)	多溴二苯醚 (PBDE)
塑料壳	○	○	○	○	○	○
电路板	x	○	○	○	○	○
电池组	x	○	○	○	○	○
附件	○	○	○	○	○	○

本表格依据SJ/T11364的规定编制。

○: 表示该有害物质在该部件所有均质材料中的含量均在GB/T 26572规定的限量要求以下。

x: 表示该有害物质至少在该部件的某一均质材料中的含量超出GB/T 26572规定的限量要求。

红魔电竞手柄符合欧盟RoHS 2.0(2011/65/EU)指令的环保要求。



在中华人民共和国境内销售的电子产品必须标识此标志, 标志内的数字代表在正常的使用状态下的产品环保使用期限。某些部件也可能有环保使用期限标识, 其使用年限以标识内的数字为准。因型号不同, 产品可能不包括除主机外的以上所有部件, 请以产品实际销售配置为准。

保修卡

保修期:
本产品的品质保证期限为:自购买日起7天包退, 15天包换, 一年保修。

免费服务:
在产品保修期内, 凡属产品本身质量引起的故障, 请用户凭此保修卡和购物凭证与经销商取得联系, 享受免费维修。

以下情况恕不免费维修:

1. 无保修卡的或产品维修标签已破坏。
2. 自行拆卸造成损坏的。
3. 因进水或跌落而造成的故障及人为机械损坏。
4. 因不可抗力造成故障或损坏的。

用户信息	用户姓名	联系地址	联系电话	电子邮箱
产品信息	产品名称	产品型号	产品条码/编号/批号	销售日期
经销商信息	名称	地址	联系电话	销售日期
备注				

注意: (1)此表应由销售商盖章确认; (2)对于可适用相关“三包”规定的产品, 本保修卡等同于“三包”凭证; (3)维修记录以授权服务机构维修凭证为准, 申请服务后, 请妥善保管。

努比亚技术有限公司
深圳市南山区高新园北环大道9018号大族创新大厦A座10楼
服务热线: 400-700-6600
官方网站: www.nubia.com



微信扫码关注, 了解更多产品信息



Red Magic E-Sports Handle User Guide

Functional descriptions of buttons on the handle

1. Pull the switch button to turn on and off the handle.
2. Turn on the handle to automatically start Bluetooth pairing and connection. This equipment generates, uses and can radiated radio frequency energy and, if not installed and used in accordance with the instructions, may cause harmful interference to radio communications. However, there is no guarantee that interference will not occur in a particular installation. If this equipment does cause harmful interference to radio or television reception, which can be determined by turning the equipment off and on, the user is encouraged to try to correct the interference by one or more of the following measures:
-Reorient or relocate the receiving antenna.
-Increase the separation between the equipment and receiver.
-Connect the equipment into an outlet on a circuit different from that to which the receiver is connected.
-Consult the dealer or an experienced radio/TV technician for help.
Caution:
Changes or modifications not expressly approved by Nubia Technology Co., Ltd for compliance could void the user's authority to operate the equipment.
3. Pull the Game button to enter Game Space, click icon to check the connection status and battery capacity of the handle, and click the handle calibration to calibrate the joystick according to the prompt.
4. The joystick and buttons on the handle have been configured according to some popular games. Please connect the handle to your phone, open a game, swipe left on the screen from the screen edge to open Game Control Center and click Handle Settings to define custom settings.

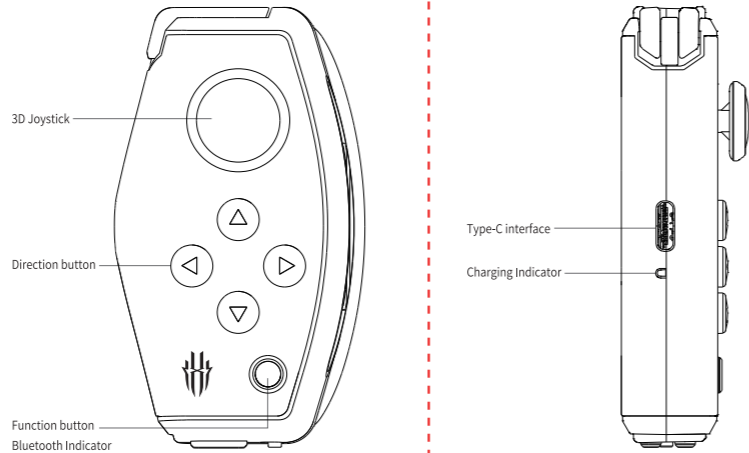
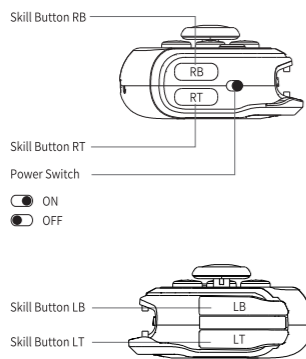

- Click: wake up the handle, start pairing or connecting.
- Click during games: display button mapping interface.

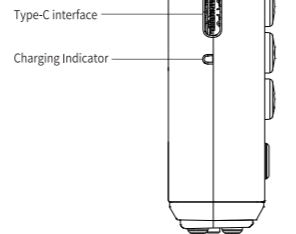

* Please see the product's CMIT ID on the label at the back side of the handle.

Descriptions of indicators

Bluetooth Indicator Status

- Sleep: Off
- Waiting to be paired: Red LED flashes
- Pairing success: Red LED always lights up

Charging Indicator Status

- Low battery: Red LED flashes
- In charging: Red LED always lights up

Sleep mode

- The handle will enter the Sleep mode when activated but not paired within three minutes or connected to the phone.
- Then handle will also enter the Sleep mode when connected to the phone but not operated within five minutes.

How to charge the handle

The handle has a built-in undetachable Li-polymer battery. Please fully charge your handle before using it for the first time.

To charge the handle, use a USB Type-C cable to connect the handle with a device with USB interface. The device's output voltage is 5V.

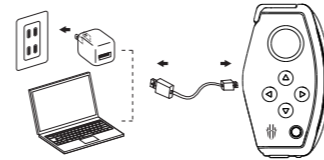

Handle Performance Parameters

Device Name: Red Magic E-Sports Handle
Device Model: GH1001
Bluetooth Chipset: Bluetooth 4.2ble
Carrier Wave Frequency: 2.402 GHz~2.480 GHz
Connection Distance: 10m
Supported Platform: Android 4.4 or above
Joystick: One 3D joystick

Skill Buttons: Eight buttons (Up, Down, Left, Right, LT, LB, RT, RB)
Function Button: One (used to display the button mapping interface)
LED indicators: Two, Red
Charging Interface: Type-C

Battery: 3.7 V/340 mAh Li-Polymer Battery
Charging Specifications: support 5 V / 1 A ~ 2 A charging adapter
Charging Time: About 2-2.5 hours
Continuous Work Duration: Above 40 hours

Work Temperature: -5 °C~40 °C
Storage Temperature: -20 °C~60 °C
Max. output power: 3.0dBm (EIRP)

Accessories: User Guide

Disposal of our Old Device

- When the wheellie bin symbol is attached to a device, it means the device is covered by the European Directive 2012/19/EU.
- All electrical and electronic devices should be disposed of separately from normal household waste via designated collection points provided by government or local authorities.
- The correct disposal of electrical and electronic products will help protect the environment and human health.



How to use the handle

The handle should be used with an exclusive protection case together.

Use by left hand

Slide the handle into the track along the left side (Top) of protection case, and then push the handle towards the bottom till the stop position.

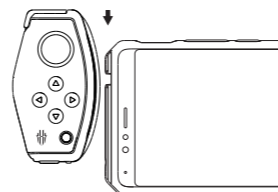

Use by right hand

Slide the handle into the track along the right side (Bottom) of protection case, and then push the handle towards the top till the stop position.

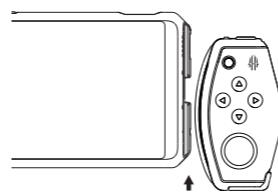

EU Declaration of Conformity (DoC)

Hereby, Nubia Technology Co., Ltd declares that this device is in conformity with the Radio Equipment Directive: 2014 / 53 / EU. For the declaration of conformity, visit <http://www.nubia.com/en/support.php?download>.



Declaration of RoHS 2.0 Compliance

We're determined to reduce the impact we have on the environment and take responsibility for the earth we live on. So this document allows us to formally declare that the GH1001, manufactured by Nubia Technology Co., Ltd, fully complies with the European Parliament's RoHS (Restriction of Hazardous Substances) 2.0 Directive 2011/65/EU, with respect to all the following substances:

- (1) Lead (Pb)
- (2) Mercury (Hg)
- (3) Cadmium (Cd)
- (4) Hexavalent Chromium (Cr (VI))
- (5) Polybrominated biphenyl (PBB)
- (6) Polybrominated diphenyl ether (PBDE)
- (7) Di(2-ethylhexyl) phthalate (DEHP)
- (8) Dibutyl phthalate (DBP)
- (9) Benzyl butyl phthalate (BBP)
- (10) Diisobutyl phthalate (DIBP)

Our compliance is witnessed by written declaration from our suppliers. This confirms that any potential trace contamination levels of the substances listed above are below the maximum level set by EU 2011/65/EU, or are exempt due to their application. The GH1001 manufactured by Nubia Technology Co., Ltd meets all the requirements of EU 2011/65/EU.

FCC Regulatory Compliance

This device has been tested and found to comply with the limits for a Class B digital device, pursuant to Part 15 of the FCC Rules. These limits are designed to provide reasonable protection against harmful interference in a residential installation. This equipment generates, uses and can radiated radio frequency energy and, if not installed and used in accordance with the instructions, may cause harmful interference to radio communications. However, there is no guarantee that interference will not occur in a particular installation. If this equipment does cause harmful interference to radio or television reception, which can be determined by turning the equipment off and on, the user is encouraged to try to correct the interference by one or more of the following measures:
-Reorient or relocate the receiving antenna.
-Increase the separation between the equipment and receiver.
-Connect the equipment into an outlet on a circuit different from that to which the receiver is connected.
-Consult the dealer or an experienced radio/TV technician for help.
Caution:
Changes or modifications not expressly approved by Nubia Technology Co., Ltd for compliance could void the user's authority to operate the equipment.

This device has been evaluated to meet general RF exposure requirement. This device can be used in portable exposure condition without restriction. This device complies with part 15 of the FCC Rules. Operation is subject to the following two conditions: (1) This device may not cause harmful interference, and (2) this device must accept any interference received, including interference that may cause undesired operation.

This device has been evaluated to meet general RF exposure requirement. This device can be used in portable exposure condition without restriction. This device complies with part 15 of the FCC Rules. Operation is subject to the following two conditions: (1) This device may not cause harmful interference, and (2) this device must accept any interference received, including interference that may cause undesired operation.

Safety Warning

- Adapter shall be installed near the equipment and shall be easily accessible.
- The device's normal operating temperature is -5°C ~ 40°C. In order to ensure the normal product functions, do not use this product outside the temperature range.

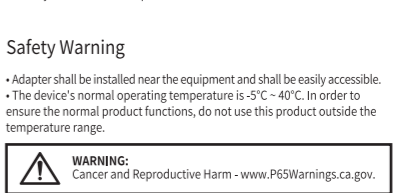

Warranty Card

Warranty Period
The product enjoys the following warranty service: refund within 7 days, replace with 15 days and repair within one year after the date of purchase. Free Repair Service
If the failure is caused by the product itself during the product's warranty period, you can show this warranty card and purchase invoice to your seller to enjoy free repair service.
The Free Repair Service does not apply to the following:
1. Defects to products without warranty card or damages to product repair label;
2. Damage caused by self-dismantling;
3. Defects and man-made damages caused by water entry or drop;
4. Defects or damages caused by force majeure.

The Free Repair Service does not apply to the following:
1. Defects to products without warranty card or damages to product repair label;
2. Damage caused by self-dismantling;
3. Defects and man-made damages caused by water entry or drop;
4. Defects or damages caused by force majeure.

The Free Repair Service does not apply to the following:
1. Defects to products without warranty card or damages to product repair label;
2. Damage caused by self-dismantling;
3. Defects and man-made damages caused by water entry or drop;
4. Defects or damages caused by force majeure.

Customer Info	Customer Name	Contact number	Mailing Address	E-mail
Product Info	Product Name	Product Model	Product Barcode/SN /Batch No.	Postcode
Seller Info	Name	Address	Contact Number	Postcode
Remarks	Purchase Date	Invoice No.		

Note: (1) This form should be stamped by Seller, (2) For those products applicable to "Three-warranties" provisions, this Warranty card is equivalent to "Three-warranties" certificate; (3) Please subject to the repairing certificate provided by the authorized service organization. Please keep the repairing records well after applying for repair service.

Nubia Technology Co., Ltd.
10F, Tower A, Hans Innovation Mansion, North Ring Road 9018, High-Tech Industrial Park, Nanshan District, Shenzhen
Service Hotline: 400-700-6600
Official Website: www.nubia.com