

Cobra[®]
microTALK

Owner's Manual



Cobra[®]
MU1500 Owner's Manual

**TWO-WAY
RADIO MODEL**

MU1500

Printed in China
Part No. AL-ML
English

Nothing Comes Close to a Cobra[®]

Nothing Comes Close to a Cobra[®]

Before operating the radio, please read all safety and operating instructions. Save all instructions in a safe place for future reference.

WARNING: Important Safety Instructions

1. Only accessories included in this package or specified by the manufacturer should be used with the radio. The 5V micro-USB charging input is compatible with most high quality micro-USB chargers that fully conform to the USB standards.
2. Do not use cleaners or solvents to clean the exterior of the radio. Use only a damp or dry cloth.
3. Do not expose this product to splashing or dripping water.
4. Do not attempt to service the receiver yourself. Removing the cover will void the warranty. Changes or modifications not expressly approved by Cobra may void the user's authority granted by the FCC to operate this device and should not be made.
5. Do not plug the wall adaptor into the power outlet if the outlet is wet.
6. Do not use any portable radio that has a damaged antenna. If a damaged antenna comes into contact with your skin, a minor burn can result.

WARNING: Important Safety Instructions for Battery

Read All Instructions

- Do not incinerate the battery even if it is severely damaged or is completely worn out.
- Do not discard battery in a fire. The battery pack can explode in a fire.
- Do not replace battery in any area labeled "Hazardous Atmosphere". Any sparks created in a potentially explosive atmosphere can cause an explosion or fire.
- Do not disassemble, crush, puncture, shred, or otherwise attempt to change the form of your battery.
- Do not dry a wet or damp battery with an appliance or heat source, such as a hair dryer or microwave oven.
- A small leakage of liquid from the battery cells may occur under extreme usage or temperature conditions. This does not indicate a failure. Do not open, deform or mutilate the battery as there may be corrosive materials which can cause damage to eyes or skin and may be toxic if swallowed.

However, if the outer seal is broken and this leakage gets on your skin:

- a. Wash quickly with soap and water.
- b. Neutralize with a mild acid such as lemon juice or vinegar.
- c. If battery liquid gets into your eyes, flush them with clean water for a minimum of 10 minutes and seek immediate medical attention.

This product uses Lithium Polymer Battery. Do not transport package if damaged, a fire hazard could exist.

Recycle Battery

Local, state or federal laws may prohibit disposal of batteries in ordinary trash. Consult your local waste authority for information regarding available recycling and/or disposal options.



Introduction

Making Life Easier and Safer

Staying in touch is convenient and easy when using your radio. Some of the many uses you will discover include:

Communicating with others while hiking, biking, and working; keeping track of family and friends at a crowded public event; checking with travel companions; connecting with neighbors; arranging meeting spots with others while shopping at the mall; talking with your colleagues in warehouse or jobsite.



Customer Assistance

Product Service & Support

For any questions about operating this new Cobra branded product, PLEASE CONTACT US FIRST...do not return this product to the retail store. The contact information for support will vary depending on the country in which you purchased and utilize the product.

To obtain warranty service or other information for products purchased from Altis itself or through its authorized reseller or agent and utilized in the U.S.A., please call our consumer support line at **(866) 721-3805**, or email us at **support@altistec.com**. You will receive instructions on how to ship the products at your expense to an Altis Global Limited Authorized Service Center. To obtain service, you must include: (a) a copy of your receipt, bill of sale or other comparable proof of purchase; (b) a written description of the problem; and, most importantly; (c) your address and telephone number.

For warranty and customer service information outside the US, please contact your local dealer.

For further information needed on its features, please visit **www.cobrawalkietalkie.com** for frequently asked questions and the electronic manual.



Operational Cautions

Exposure to high volume sound levels may cause temporary or permanent damage to your hearing. Although there is no single volume setting that is appropriate for everyone, you should always use your radio with the volume set at low level and avoid prolonged exposure to high volume sound levels.

1. Set the volume control in a low position and use as low volume as possible.
2. Avoid turning up the volume to block out noisy surroundings. Whenever possible, use your radio in a quiet environment with low background noise.
3. Limit the amount of time you use headsets or earpiece at high volume levels.
4. When using the radio without a headset or earpiece, do not place the radio's speaker directly against your ear.
5. Observe all signs and instructions that require an electrical device or RF radio product to be switched off in designated areas, such as gas/refueling stations, hospitals, blasting areas, potentially explosive atmospheres, or aircraft.
6. If you experience a skin irritation after using this product, discontinue to use and seek medical attention.
7. If the product or charger: overheats; has a damaged cord or plug; has been dropped or damaged; has been dropped into water, disconnect any charger from its power supply, discontinue use of the product.

Electromagnetic Interference

Nearly every electronic device is susceptible to electromagnetic interference (EMI) if inadequately shielded, designed, or otherwise configured for electromagnetic compatibility. Turn off your radio in any facility where posted notices instruct you to do so. These facilities may include hospitals or health care facilities that may be using equipment that is sensitive to external RF energy.

- When instructed to do so, turn off your radios when on board an aircraft. Any use of a RF device must be in accordance with applicable laws, regulations and airline crew instructions.
- Some radios may interfere with some hearing aids. In the event of such interference, you may want to consult your hearing aid manufacturer or physician to discuss alternatives.
- If you use any other personal medical device, consult the manufacturer of your device to determine if it is adequately shielded from RF energy. Your doctor or physician may be able to assist you in obtaining this information.



Product Features

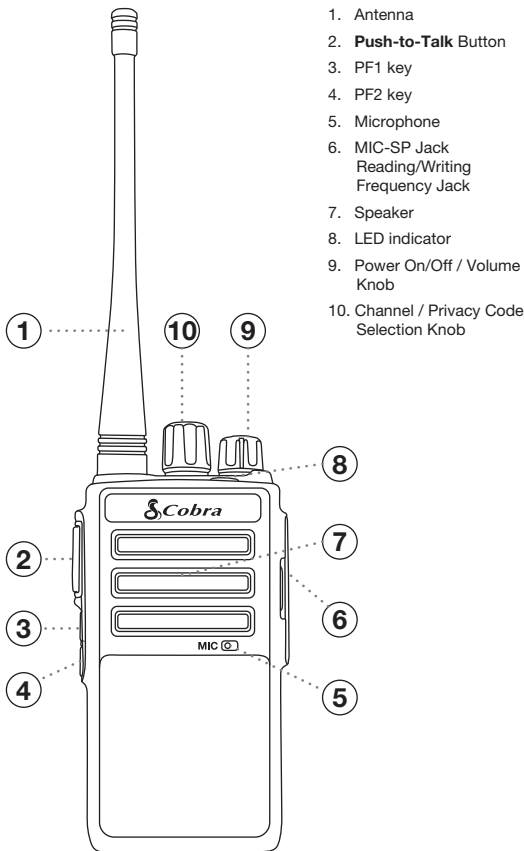

1. Antenna
2. **Push-to-Talk** Button
3. PF1 key
4. PF2 key
5. Microphone
6. MIC-SP Jack Reading/Writing Frequency Jack
7. Speaker
8. LED indicator
9. Power On/Off / Volume Knob
10. Channel / Privacy Code Selection Knob

Features

- **5 Channels with Preset privacy codes**
- **User Adjustable Privacy Codes** (39 CTCSS codes 168 DTS codes)
- **Hands-Free Operation (VOX)**
- **Button Lock**
- **Speaker/Microphone/Charge Jack**
- **Roger Beep** Selectable On/Off
- **Battery/Power Saver**
- **Low Battery Audible Alert**
- **Auto Squelch**
- **Maximum Range Extender**
- **Emergency Call**

LED indicators

Standby Mode	Green LED flashes every 5 seconds
When Battery low	Red LED flashes every 1 second
When you press and hold Talk button and the Radio is transmitting	Green LED on
During VOX feature enabled	After Green LED flashes every 5 seconds Red LED flashes 6 times
During Emergency Alert Mode	Solid Green (No flash)
Power Off the Radio during charging	
Under Charging	Solid Red (No flash)
Fully Charge	Solid Green (No flash)



Maximum range may vary and is based on unobstructed line-of-sight communication under ideal conditions.

Caring for Your microTALK® Radio

Your microTALK® radio will give you years of trouble-free service if cared for properly. Handle the radio gently. Keep the radio away from dust. Never put the radio in water or in a damp place. Avoid exposure to extreme temperatures.

Only use the supplied rechargeable batteries and desktop charger for recharging your Cobra microTALK® radio.

Please charge new batteries for 8 hours for first time of use.

Cobra recommends your radio is turned off while being charged.



Operation

Using Your Radio

Caring for Your Radio

Note : DO NOT operate the radio without a proper 50 Ohm antenna attached, as this may damage the radio

Connecting the antenna

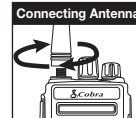

Align the base of the antenna onto the SMA connector and turn clockwise until snug. Do not over tighten.

Disconnecting the antenna

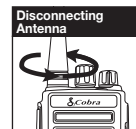

Turn the base of the antenna counter-clockwise to disconnect it from the radio.

Installing the battery



Slide the battery upward along with the rails until the battery snaps into place.

Removing the battery



Pull the battery locks downwards to release the battery from the radio.

It is suggested to remove the screws and unattached the belt clip before installing /removing the battery.

Charging the battery with the radio

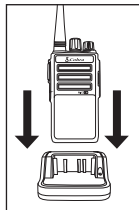

The radio is equipped with a charging base and a power supply adaptor. To charge the battery with the radio attached:

1. Place the charging base on a flat surface in a dry location.
2. Insert the AC adaptor cable connector into the port on the rear of the charging base.
3. Plug the AC adaptor into a power outlet.
4. Align the slots on the sides of the battery with the rails in the charging base.
5. Slide the radio into the charging base.

If charging light is not **on**, check position of radio. Radio should be upright. The charge indicator light on desktop charger will stay **on** (Red) as long as the radio is in the charging well, and the light will go **off** when the charging is complete.



Quick Start

1. Turn **Power On/Off / Volume Knob** clockwise to turn the radio on and counter clockwise to turn the radio off.
2. Select a desired channel. (Details please refer P.9)



Both radios must be tuned to the same channel/privacy code to communicate.

3. Press and hold the **Talk** button while speaking into the microphone.
4. When finished talking, release the **Talk** button and listen for a response.

Turning your Radio On and Off

Turn **ON/OFF** Knob clockwise to turn the radio on and counterclockwise to turn the radio off.



1. In the **ON** position, the radio chirps, and the current channel number prompted after that.

Your microTALK® radio is now in Standby mode, ready to receive transmissions. The radio is always in Standby mode except when the **Talk**, or other buttons are pressed or the **Channel/Privacy Code Selection Knob** is turned.

2. In Standby mode, **Green** LED flashes every 5 seconds.

Battery Low

When battery power is low, **Red** LED flashes every 1 second. Voice prompt **“Please charge”** will be heard approximately 1 hour before device automatically powers off. Your batteries should be recharged. It normally takes about 4 hours to fully charge batteries.

Auto Battery Save

If there are no transmissions within 10 seconds, the radio will automatically switch to **Battery Save** mode. This will not affect the radio's ability to receive incoming transmissions.

Communicating with Another Person

Talk Button



1. Press and hold the **Talk** button.
2. With the microphone about two inches (5 cm) from your mouth, speak in a normal voice.
3. Release the **Talk** button when you are finished talking and listen for a response.

Two Inches from Mouth



You cannot receive incoming calls while pressing the **Talk** button.



Both radios must be tuned to the same channel/privacy code to communicate.

Listening for a Response

Listening



Release the **Talk** button to receive incoming transmissions. Your microTALK® radio is always in **Standby** mode while the **Talk** buttons are not pressed.

To Adjust Volume

Volume Knob



Press **PF2** Button for three seconds to turn off the auto squelch, rotating **Volume** Knob until you reach a comfortable listening level.

1. Rotate **Volume** Knob clockwise to increase the volume.
2. Rotate **Volume** Knob counterclockwise to decrease the volume.

Press and hold **PF2** Button to enable the auto squelch. Do not hold the radio close to your ear. If the volume is set to an uncomfortable level, it could hurt your ear.

Auto Squelch (Maximum Range extender)

Your microTALK® radio will automatically shut off weak transmissions and unwanted noise due to terrain, conditions or if you've reached your **Maximum Range** limit.

You can turn **off** auto squelch (or turn **on** maximum range extender), allowing all signals to be received and extending the maximum range of your radio.

To turn maximum range extender on (Turn off auto squelch):

- Press the **PF2** button for at least three seconds until you hear two beeps which indicates the maximum range extender is **on**.
- Press the **PF2** button again to turn on auto squelch.

microTALK® Range

Maximum Range



Your range will vary depending on terrain and conditions. In flat, open country your radio will operate at maximum range.

Reduced Range



Buildings and foliage in the path of the signal can reduce the range of the radio.

Reduced Range



Dense foliage and hilly terrain will further reduce the range of the radio.



Remember, you can achieve maximum range by using maximum range extender. See **page 6** for details.



Both radios must be tuned to the same channel to communicate.



See Page 10 for resetting all the channels and privacy code setting to factory default.

To Select a Channel

The radio has 5 Channels that preset with customized privacy codes.

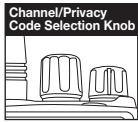

1. During **Standby** mode, turn the **Channel/Privacy Code Selection Knob** clockwise or counterclockwise to select a desired channel from CH1 to CH5.



Both radios must be tuned to the same channel to communicate.



See Page 14 for frequency allocations charts.



See Page 10 for resetting all the channels and privacy code setting to factory default.

Privacy Codes

Your radio incorporates two advanced coded squelch systems that can help to reduce interference from other users on any given channel. CTCSS (Continuous Tone Coded Squelch System) provides 39 privacy codes and DCS (Digitally Coded Squelch) provides 168 privacy codes for factory default channel preset. The CTCSS (Continuous Tone Coded Squelch System) can be used on all channels.

For ease of use and to reduce interference from other users, the 5 channels of your radio have been customized, see **Channel and Default Privacy Code Table**.

Channel and Default Privacy Code Table

Channel	Privacy Code	
	Type	Number
1	CTCSS	1
2	CTCSS	1
3	CTCSS	1
4	CTCSS	1
5	CTCSS	1



You can change your radio Privacy Codes in order to work with other radios with different privacy codes or radio without privacy codes.

Set CTCSS Privacy Codes

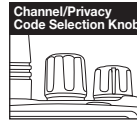

To select a CTCSS privacy code:

1. After selecting a channel, then return to **Standby** mode.
2. Press and hold the **PF1** and **PF2** buttons for at least 5 seconds until the current channel and code number prompted. The following messages may be prompted:
 - a. The current channel number,
 - b. The current CTCSS Code Number, or
 - c. **“Code Off”** means no privacy code was set on the current channel, and allows all signals to be heard on a channel.
3. After the current code number prompted, press **PF1** or **PF2** button to select a desired CTCSS code number;
4. When the desired CTCSS code number selected, choose one of the following.
 - a. Press **PF1** or **PF2** button to change a new CTCSS code number.
 - b. Press the **Talk** button to save the new setting and return to **Standby** mode.
 - c. Do not press any buttons or turn the **Channel/Privacy Code Selection Knob** for 6 seconds to save the new setting, the current channel number and privacy code setting (if any) prompted again, and then return to **Standby** mode.



To successfully communicate using a privacy code, both the sending and receiving radios must be tuned to the same channel with the same privacy code number (CTCSS or DCS). Each channel will remember the last privacy code system and number you select.



The privacy code OFF is not a privacy code, but allowing all signals to be heard on a channel that is set to 0 on both the CTCSS and DCS systems.



See Page 10 for resetting all the channels and privacy code setting to factory default.

Reset all channels with factory default privacy codes

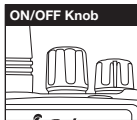

1. Power off the radio. Press and hold the **PF1** button and turn the **Talk** button, and turn the **Power On/Off** knob to turn on the radio simultaneously.
2. 2 consecutive beeps following with a message "*Code Memory OFF*" prompted, all the channels on the radio has been reset to factory default privacy codes successfully.



Operation

More Functions

PC Program Software Setting

Running MU1500 PC software on your computer, by setting the key functions in PC software -> Key Settings, you will be able to select or turn on preferred features of your microTALK® radio.

Default Key function

PF1 key function

Press: Check Power

Hold : VOX ON/OFF

PF2 Key function

Press: Squelch Off

Hold: RB ON/OFF

Voice Activated Transmit (VOX)

In **VOX** mode, your microTALK® radio can be used "hands-free," automatically transmitting when you speak.

To turn **VOX** mode on or off:

1. During **Standby** mode, press and hold **PF1** button for at least 3 seconds to turn **VOX** On or Off, the current **VOX** status is prompted.
2. Once the **VOX** is turned on, **Red** LED flashes after **Green** LED flash every 5 seconds.

To set **VOX** sensitivity:

1. Run MU1500 PC Software on your computer.
2. Function Setup -> **VOX** Setting, tick on "**VOX function**" and select "**VOX Level**" for your radio. The value would be from 1 to 9. **VOX 9** is the most sensitive level and **VOX 1** is the least sensitive level.

Roger Beep Confirmation Tone

Your listener will hear an audible tone when you release the **Talk** button. This alerts the other party that you are finished talking and it is OK for them to speak.

To turn roger beep on or off:

Press and Hold **PF2** button for at least 3 seconds to turn **Roger Beep** On or Off, the current **Roger Beep** status is prompted.

Check Power (Battery Capacity)

During standby mode, press **PF1** key to check the battery capacity. The current battery capacity status is prompted.

Monitor

During standby mode, press the programmed key of Monitor function. The **"DU"** beep is prompted and radio comes into the monitor state. The radio will ignore **CTCSS/DCS** decode and start receiving as long as receiving the matched carrier. Press this key again, the **"Du Du"** beep is prompted and radio exits the monitor state.

Current Channel Power Enquiry

During standby mode, press the programmed key of current channel power enquiry, the power level is prompted, **"Du Du"** beep stands for high power, **"Du"** beep standas for low power.

Scan

During standby mode, turn the channel knob to 6, **"Scan"** is prompted and radio starts scanning. **Green** LED flashes every second.

It scans channel 1-5 one by one, when one channel receives a matched signal, the radio temporarily stays in this channel until the signal disappears.

Turn the **channel** knob to other channels to exit scan.

Emergency Alert Mode

The Emergency Alert feature can be used to signal receiver in your current channel of your need for urgent help. To get the Emergency Alert function work, you should assign **PF1** or **PF2** key function to "Alert Key" in PC software first. The alert tone is emitted from your own radio speaker and the receiving radios in your current channel.

1. Assign **PF1** or **PF2** key to **"Alert Key"** function in PC software.
2. Press the **"Alert Key"** button. Release the button after the alert tone begins to sound, **Green** LED stays on. There is no need to continue to hold the **Emergency Alert** button or use PTT for your message to be transmitted
3. Press **"Alert Key"** again to stop the Emergency Alert, **Green** LED Off. Operation then return to normal twoway mode.



Warning: The Emergency Alert feature should only be used in the event of an actual emergency. Cobra is not responsible if there is no response to the emergency alert from the receiving radios.



General Specifications

Frequency Allocation and Compatibility

A = Channel No. for 5 Channel Models

B = Frequency in MHz

C = Power Output

A	B	C
1	154.7500	High
2	154.6000	High
3	151.8200	High
4	151.8800	High
5	151.9400	High

IMPORTANT NOTICE:

WARNING: Changes or modifications to this unit not expressly approved by the party responsible for compliance could void the user's authority to operate the equipment.

This device complies with part 15 of the FCC Rules. Operation is subject to the following two conditions: 1) This device may not cause harmful interference, and 2) this device must accept any interference received, including interference that may cause undesired operation.

NOTE: This equipment has been tested and found to comply with the limits for a Class B digital device, pursuant to Part 15 of the FCC Rules. These limits are designed to provide reasonable protection against harmful interference in a residential installation. This equipment generates, uses and can radiate radio frequency energy and, if not installed and used in accordance with the instructions, may cause harmful interference to radio communications.

However, there is no guarantee that interference will not occur in a particular installation. If this equipment does cause harmful interference to radio or television reception, which can be determined by turning the equipment off and on, the user is encouraged to try to correct the interference by one or more of the following measures:

- Reorient or relocate the receiving antenna.
- Increase the separation between the equipment and receiver.
- Connect the equipment into an outlet on a circuit different from that to which the receiver is connected.
- Consult the dealer or an experienced radio/TV technician for help.

Safety Information for microTALK® Radios

Your wireless handheld portable transceiver contains a low power transmitter. When the talk button is pushed, it sends out radio frequency (RF) signals. The device is authorized to operate at a duty factor not to exceed 50%. In August 1996, the Federal Communications Commission (FCC) adopted RF exposure guidelines with safety levels for handheld wireless devices

Important

FCC RF Exposure Requirements: For body-worn operation, this radio has been tested and meets the FCC RF exposure guidelines when used with Cobra accessories supplied or designated for this product. Use of other accessories may not ensure compliance with FCC

RF exposure guidelines. Use only the supplied antenna. Unauthorized antennas, modifications or attachments could damage the transmitter and may violate FCC regulations.

Normal Position

Hold the transmitter approximately 25mm from your face and speak in a normal voice, with the antenna pointed up and away.

FCC Part 15.21 Warning Statement-

NOTE: THE GRANTEE IS NOT RESPONSIBLE FOR ANY CHANGES OR MODIFICATIONS NOT EXPRESSLY APPROVED BY THE PARTY RESPONSIBLE FOR COMPLIANCE. SUCH MODIFICATIONS COULD VOID THE USER'S AUTHORITY TO OPERATE THE EQUIPMENT.

IC RSS-GEN

This device complies with ISED license-exempt RSS standard(s). Operation is subject to the following two conditions: (1) this device may not cause interference, and (2) this device must accept any interference, including interference that may cause undesired operation of the device.

Under ISED regulations, this radio transmitter may only operate using an antenna of a type and maximum (or lesser) gain approved for the transmitter by ISED. To reduce potential radio interference to other users, the antenna type and its gain should be so chosen that the equivalent isotropically radiated power (e.i.r.p.) is not more than that necessary for successful communication.

The applicant is responsible for providing proper instructions to the user of the radio device, and any usage restrictions, including limits of exposure durations. The user manual shall provide installation and operation instructions, as well as any special usage conditions, to ensure compliance with SAR and/or RF field strength limits. For instance, compliance distance shall be clearly stated in the user manual.

ISED Radiation Exposure Statement:

Any Changes or modifications not expressly approved by the party responsible for compliance could void the user's authority to operate the equipment.

Your wireless handheld portable transceiver contains a low power transmitter. When the talk button is pushed, it sends out radio frequency (RF) signals. The device is authorized to operate at a duty factor not to exceed 50%.

For body worn operation, this model device has been tested and meets the ISED RF exposure guidelines when used with an accessory designated for this product or when used with an accessory that Contains no metal and that positions of the face up minimum distance is 25 mm.



MODEL MU1500:

This device complies with part 15 of the FCC Rules. Operation is subject to the following two conditions: 1) This device may not cause harmful interference, and 2) this device must accept any interference received, including interference that may cause undesired operation.

FCC Warnings: Replacement or substitution of transistors, regular diodes or other parts of a unique nature, with parts other than those recommended by Cobra may cause a violation of the technical regulations of part 95 of the FCC rules, or violation of type acceptance requirements of part 2 of the rules.



Warranty & Trademark Acknowledgment

Limited One-Year Warranty

Altis Global Limited warrants to the original consumer purchaser only that this product and the component parts thereof, will be free from defects in workmanship and materials for a period of one year from the date of first consumer purchase. During this period, Altis will repair or replace, at its sole option and discretion, this product or any defective parts. Altis' liability hereunder shall be limited to repair or replacement of the defective part or parts, and such correction shall constitute a fulfillment of all of Altis' warranties hereunder.

This limited warranty is only valid for the original consumer purchaser in limited jurisdictions and is not transferrable. This limited warranty will automatically terminate prior to expiration if this product is sold or otherwise transferred to another party. The product must be purchased from Altis or an authorized dealer or the warranty is void. This limited warranty is valid only for products purchased and utilized in specific jurisdictions. Please visit our website at www.cobrawalkietalkie.com for a list of jurisdictions wherein this limited warranty is valid.

This limited warranty does not cover damage due to misuse, abuse, negligence, acts of God, accident, commercial use or modification of, or to any part of this product. This warranty does not cover damage due to improper operation, maintenance or installation; ordinary wear and tear; or attempted alterations or repairs by anyone other than Altis or someone authorized by Altis to do warranty work. Any unauthorized alterations or repairs will void this warranty. This limited warranty does not cover product sold AS IS or WITH ALL FAULTS. This limited warranty is invalid if the factory applied serial number or date stamp has been altered, defaced or removed from this product. This limited warranty does not cover product purchased or utilized in a jurisdiction not covered.

The procedure for obtaining service and support, and the applicability of this warranty, will vary depending on the country or jurisdiction in which you purchase and utilize the product. For details on obtaining product service, support and other warranty information please visit www.cobrawalkietalkie.com.

This warranty gives you specific legal rights, and you may also have other rights which vary from state to state and country to country.

EXCEPT AS EXPRESSLY SET FORTH IN THIS WARRANTY, ALTIS MAKES NO OTHER WARRANTIES, EXPRESSED OR IMPLIED, INCLUDING ANY IMPLIED WARRANTIES OF MERCHANTABILITY AND FITNESS FOR A PARTICULAR PURPOSE. ALTIS EXPRESSLY DISCLAIMS ALL WARRANTIES NOT STATED IN THIS LIMITED WARRANTY. ANY IMPLIED WARRANTIES THAT MAY BE IMPOSED BY LAW ARE LIMITED TO THE TERMS OF THIS EXPRESSED WARRANTY.

LIMITATION OF REMEDIES AND DAMAGES. REPAIR OR REPLACEMENT AS PROVIDED UNDER THIS WARRANTY IS THE EXCLUSIVE REMEDY OF THE CONSUMER. ALTIS SHALL NOT BE LIABLE FOR ANY INCIDENTAL OR CONSEQUENTIAL DAMAGES, INCLUDING BUT NOT LIMITED TO ATTORNEYS' FEES AND/OR COSTS OF LITIGATION, FOR BREACH OF ANY EXPRESS OR IMPLIED WARRANTY ON THIS PRODUCT. ALTIS IS NOT LIABLE FOR ANY DAMAGES CAUSED BY THE PRODUCT OR BY THE PRODUCT TO PERFORM, INCLUDING ANY LOST PROFITS, LOST SAVINGS, INCIDENTAL DAMAGES, OR CONSEQUENTIAL DAMAGES.

ALTIS IS NOT LIABLE FOR ANY CLAIM MADE BY A THIRD PARTY OR MADE BY YOU FOR A THIRD PARTY. THIS LIMITATION APPLIES WHETHER DAMAGES ARE SOUGHT, OR A CLAIM MADE, UNDER THIS WARRANTY OR AS A TORT CLAIM (INCLUDING NEGLIGENCE OR STRICT PRODUCT LIABILITY), A CONTRACT CLAIM, OR ANY OTHER CLAIM. THIS LIMITATION CANNOT BE WAIVED OR AMENDED BY ANY PERSON. THIS LIMITATION OF LIABILITY WILL BE EFFECTIVE EVEN IF ALTIS OR AN AUTHORIZED REPRESENTATIVE OF ALTIS HAS BEEN ADVISED BY YOU OF THE POSSIBILITY OF ANY SUCH DAMAGES.

Some states and countries do not allow limitations on how long an implied warranty lasts and do not allow the exclusion or limitation of incidental or consequential damages, so the above limitations may not apply to you. This warranty gives you specific legal rights, and you may also have other rights which vary from state to state and country to country.

Provided that the product was purchased from Altis itself or through its authorized reseller or agent and utilized in the U.S.A., Altis will, without charge, repair or replace, at its option, defective products, products or component parts upon delivery to the authorized Altis Global Limited Authorized Service Center, accompanied by proof of the date of first customer purchase, such as a duplicated copy of a sales receipt.

You must pay any initial shipping charges required to ship the product for warranty service, but the return charges, to an address in the U.S.A, will be at Altis' expense, if the product is under warranty.

For Products Purchased Outside the U.S.A.

Please contact your authorized local reseller or agent for warranty information.

Trademark Acknowledgment

Manufactured, distributed, or sold by Altis Global Limited, official licensee for this product. Cobra®, microTALK®, Nothing Comes Close to a Cobra®, and the snake design are registered trademarks of Cobra Electronics Corporation, USA. Cobra Electronics Corporation™ is a trademark of Cobra Electronics Corporation, USA. All other product or service names are the property of their respective owners.

©Cobra Electronics Corporation, USA 2021. All rights reserved.

Altis Global Limited,
2140 McGee Road,
Suite A-2200,
Snellville, GA, USA
support@altistec.com



