



FitPro

wired & wireless earbud set

FITPRO WIRED EARBUD WITH MIC

2



2 Basic Use for the Wired earbuds:

For your own safety we suggest to lower the volume of your device before plugging in the wired earbuds and wearing it.



1 AUX 3.5 mm end

1. Make sure that your media device is compatible with AUX 3.5mm before connecting.



MICROPHONE MULTI-FUNCTIONAL CONTROL 2

1. **Pause/Play:** While listening, press the multi-functional button once to pause music; Press the button again to play music.
2. **Answer/End call:** Tap the multi-functional button once.
3. **Reject call:** Press the multi-functional 2 times.
4. **Next Track:** While listening, press multi-functional button twice rapidly.
5. **Previous Track:** While listening, press multi-functional button three times rapidly.

DESIGNED FOR PEACE OF MIND

1 Wireless earbuds Specifications

Bluetooth Specification:	V4.0
Bluetooth Profiles Supported:	HSP, HFP, A2DP, AVRCP
Support For Audio Decoding:	SBC, MP3
Operation Range :	33 Ft
Frequency Range:	2.402Hz-2.480GHz
Battery (Built-in):	3.7v / 60mAH
Charging Voltage:	DC 4.75-5.25v
Charging Time:	About 2 Hours
Playing Music Time:	Up to 6 Hours
Talk Time:	Up to 6 Hours
Standby Time:	Up to 200 Hours
Driver:	630* 21* 23mm*
Weight:	13g

2 Wired earbuds Specifications

Style:	IN-EAR
Driver:	10mm
Frequency Range:	20Hz-20,000Hz
Connectors:	AUX 3.5mm end
Support For:	SBC, MP3
Operation Wire Length:	46in
Weight	13gm

- **Warnings and Notes**
Do not store unit in a high temperature environment, including intense sunlight or heat. Do not place unit near fire or other excessively hot environments.
Be cautious of excessive drops, bumps, abrasions or other types of impact. If there is any damage to the battery such as dents, punctures, tears, deformities of corrosion, due to any cause, discontinue use and contact manufacturer or dispose of in an appropriate manner.
Do not disassemble or attempt to modify or replace any part of this unit.
Do not expose unit to moisture, snow or submerge it in liquid. Do not use unit in the vicinity of flammable fumes or gases (such as propane tanks or large engines).
Do not attempt to operate unit using any other method than directed.

- **Warranty and Limitations**
Limited 3 Year Warranty. To activate product warranty go to our website www.pomgear.com and register this product. Guarantee will not be applied to the damages caused by faulty usages.
Products that have been subjected to abuse, misuse, accident, alteration, modification, tampering, negligence, faulty connection, attachment to any unauthorized accessory, lack of responsible care, repair or service in any way that is not mentioned in this manual for the product. Such as any damage caused by dust, wetness, coldness, overheating, placement near hot objects, near fire storage or use of corrosive elements. No warranty in damage caused by natural disasters such as floods, fires, typhoons, earthquakes and related matters. To the extent permitted by law, POM GEAR Inc. Shall not be liable for damages beyond replacing the defective product.

- **Technical Support:**
Please do not attempt to fix the product by yourself. If you are experiencing any problems with the product, please do not return it to the store you purchased it from. You can contact a POM Gear representative and they will assist you with any questions, problems or concerns you may have.

Send an email to warranty@pomgear.com

FCC NOTICE TO USERS:

NOTE: This equipment has been tested and found to comply with the limits for a Class B digital device, pursuant to part 15 of the FCC Rules. These limits are designed to provide reasonable protection against harmful interference in a residential installation. This equipment generates uses and can radiate radio frequency energy and, if not installed and used in accordance with the instructions, may cause harmful interference to radio communications. However, there is no guarantee that interference will not occur in a particular installation. If this equipment does cause harmful interference to radio or television reception, which can be determined by turning the equipment off and on, the user is encouraged to try to correct the interference by one or more of the following measures:
- Reorient or relocate the receiving antenna.
- Increase the separation between the equipment and receiver.
- Connect the equipment into an outlet on a circuit different from that to which the receiver is connected.
- Consult the dealer or an experienced radio/TV technician for help.
Changes or modifications not expressly approved by the party responsible for compliance could void the user's authority to operate the equipment. This device complies with Part 15 of the FCC Rules.

Operation is subject to the following two conditions:
(1) This device may not cause harmful interference, and
(2) This device must accept any interference received, including interference that may cause undesired operation.

IMPORTANT NOTE: To comply with the FCC RF exposure compliance requirements, no change to the antenna or the device is permitted. Any change to the antenna or the device could result in the device exceeding the RF exposure requirements and void user's authority to operate the device.

CE NOTICE TO USERS: Hereby, POM Gear Inc. declares that this device is in compliance with the essential requirements and other relevant provisions of Directive 1999/5/EC. Declaration of Confirmation Additional Information FCC ID: 2AH16NEWELL Additional Information

1. Radio Frequency: This POM Gear Bluetooth® headset, is a radio transmitter and receiver. When in operation it communicates with a POM Gear Bluetooth® equipped mobile device by receiving and transmitting radio frequency (RF) electromagnetic fields (microwaves) in the frequency range 2.4 to 2.480 GHz. Your POM Gear Bluetooth® headset is designed to operate in compliance with the RF exposure guidelines and limits set by national authorities and international health agencies when used any compatible mobile phone.

2. Battery information: A rechargeable battery has a long service life if treated properly. A new battery or one that has not been used for a long period of time could have reduced capacity the first few times it is used. Do not expose the battery to extreme temperatures, never above +60°C(+140°F) or under -20°C(-4°F). For maximum battery capacity, use the battery at room temperature. If the battery is used in low temperatures, the battery capacity will be reduced. The battery can only be charged in temperatures between +10°C(+50°F) and +45°C (+113°F). For your safety, do not remove the battery incorporated in the product. Please only charge using included charging cable for correct frequency charging. If you need to replace the battery, contact POM Gear Inc. at info@pomgear.com for assistance. Recycling the battery in your POM Gear Bluetooth® headset requires that it be disposed of properly and should never be placed in municipal waste. If POM Gear Inc. removes the battery it will be disposed of according to local regulations.

Emergency calls: This POM Gear Bluetooth® headset and the electronic device connected to the headset operate using radio signals, mobile and landline networks as well as user-programmed functions, which cannot guarantee connection under all conditions. Therefore you should never rely solely upon any electronic device for essential emergency calls. Remember, in order to make or receive calls, the headset and the electronic device connected to the headset must be switched on and in a service area with adequate mobile signal strength. Emergency calls may not be possible on all mobile phone networks or when certain network services and/or phone features are in use. Check with your local service provider.



user manual

FitPro

wired & wireless earbud set



DESIGNED FOR PEACE OF MIND

THANK YOU FOR PURCHASING

FitPro

wired & wireless earbud set

by POM Gear

All POM Gear products are developed to give the user Peace Of Mind. In today's hectic world, managing our on-the-go lifestyle is a challenge of its own. POM's mission is to create products that provide simple solutions by combining the latest technology and top quality gear to exceed all expectations. We're sure you'll have an enjoyable user experience.

To get the most of your new POM Gear product, please read the user manual carefully before use.



FitPro

wired & wireless earbud set

FITPRO WIRELESS EARBUD WITH MIC

1

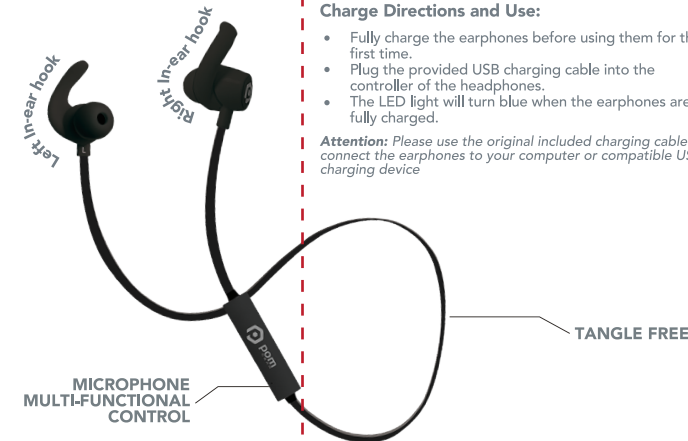

1 Basic Use for Wireless earbuds:

Charge Directions and Use:

- Fully charge the earphones before using them for the first time.
- Plug the provided USB charging cable into the controller of the headphones.
- The LED light will turn blue when the earphones are fully charged.

Attention: Please use the original included charging cable to connect the earphones to your computer or compatible USB charging device

TANGLE FREE

MICROPHONE MULTI-FUNCTIONAL CONTROL

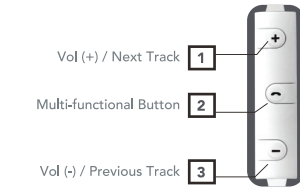

1. **Power on:** Press & hold the multi-functional button until blue LED goes on.
2. **Power off:** Press & hold the multi-functional button until red LED goes on and release.
3. **Pairing:** When unit is powered off, press & hold the multi-functional button for about 8-10 seconds until rapid blinking blue & red LED lights appear. Unit is now in pairing mode. Make sure you Bluetooth enable device is on and search for "Pom FitPro" to appear and select to pair.
4. **Pause/Play:** While listening, press the multi-functional button to pause music; Press the button again to play music.
5. **Answer/End call:** Tap the multi-functional button.
6. **Reject call:** Press the multi-functional button for to 1-2 seconds.



7. **Redial last number:** Double click the multi-functional button to redial. When dialing a call, keep a fair distance between your Pom FitPro earbuds and your cellular phone.
1. **Volume control:** While listening, press the V+ button to increase volume, or the V- button to decrease volume.
2. **Music track:** While listening, press & hold the V+ button for the next song, press & hold the V- button for the previous song.

LED Indicator:

1. **Low battery warning:** Red LED flashing.
2. **Charging:** Red LED on when charging and blue LED on when fully charged.
3. **Bluetooth connected:** Blue LED flashing slowly.
4. **Power on/off:** When turning the earphones on the LED light will blink blue. When turning off the LED will turn red.
5. **Bluetooth pairing:** Blue and red LED flashing rapidly together

Pairing (Connecting) The Bluetooth Earphones:

1. Put the earbuds and compatible Bluetooth device close to each other (no more than 3 feet apart) and press then hold the button until the LED light starts flashing blue and red. The voice prompt will say "Your POM Gear Device is ON." Then "Your POM Gear Device is Ready to Pair."

Making and Receiving Calls:

1. If the earphones are in use (ie. playing music) and you receive an incoming call, the music will be paused while you take that call. Music will resume automatically when the call is over.
2. When you hear an incoming call, press the multi-functional button once to answer & then press once again to end the call.
3. To redial the last number called, press the multi-functional button twice quickly

Connection & Standby:

1. When the Bluetooth earphones are turned on, they will connect automatically to the last connected compatible device within range and then it will automatically enter standby mode and will be ready for use.

2. With your Bluetooth compatible device turned on you should see a list of all available Bluetooth devices within range.
3. Select "POM FitPro" from the list, and this should begin the pairing sequence. After pairing has been successfully completed, you will hear a quick tone in the earphones indicating that the connection has been established and the voice prompt will state "Your POM Gear Device is Now Paired. Enjoy!"
4. Now you can use your POM Gear FitPro Bluetooth earphones to listen to music and make phone calls.

POM Gear Inc. WWW.POMGEAR.COM
90 DAYTON AVE,
PASSAIC NJ, 07055



#UNWIREYOURSELF



©2016 POM GEAR Inc. All Rights reserved. All other trademarks and trade names are those of their respective owners. The illustrated product and specifications may differ slightly from that supplied. Designed by POM Gear USA. Manufactured in China.

FIND US ON
in LinkedIn.com/company/pom-gear f facebook.com/pomgear
Twitter.com/pomgearusa Instagram.com @pomgear

