

GuruGear 2 in 1 Wireless Headphone with BT Speaker



Owner's Manual

Model Number: BT-56

GURUGEAR™

the path to happiness.

FEATURES

- Supports Bluetooth
- Wireless range: 33 feet
- Supports profile A2DP, AVRCP, HSP, HFP
- Built-in microphone
- Micro-USB port for battery recharge
- 3.5mm audio input
- Adjustable headband
- Driver: 40mm
- DC battery power: built-in 800 mAH rechargeable lithium ion battery
- Headphone battery life: up to 30+ hours
- Speaker battery life: up to 3 hours

INCLUDES

- 3.5mm audio cable
- USB cable
- Carry pouch



THE EXTERNAL SPEAKERS ON THE HEADPHONES ARE NOT WATERPROOF. DO NOT USE IN RAINY OR DAMP WEATHER CONDITIONS.

Pairing Indicator Light

Power/Pair/Play/Pause/

Press and hold for **approx. 7 seconds** to power the unit on and begin pairing. Press to play or pause the current track. Press and hold to power off.

Volume +/-

Push up or down to adjust volume.

DC Power Input

Line In

Microphone

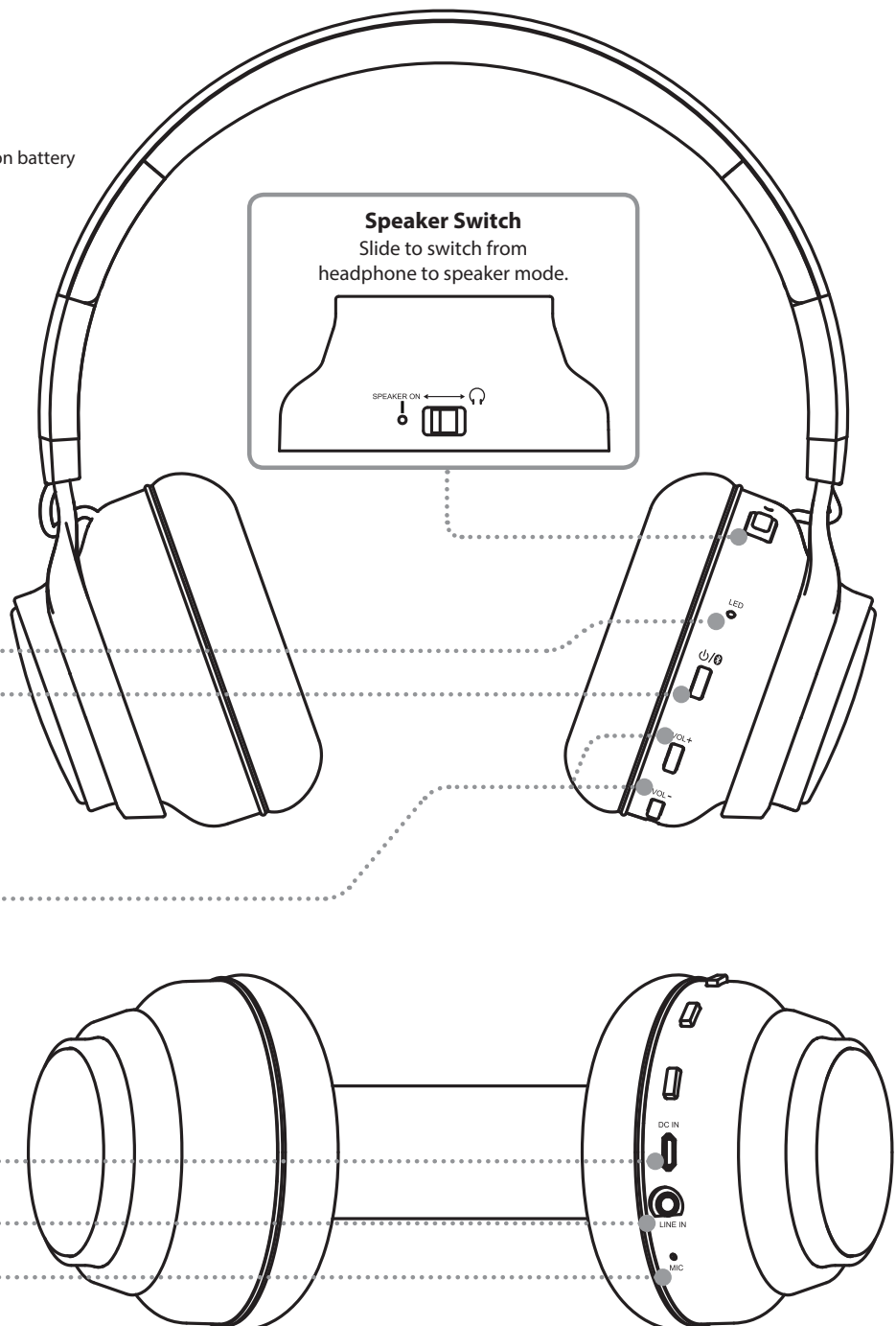

Charging the Battery

Requires a Micro-USB to USB cable (included).

1. Using a **Micro-USB to USB** cable (included), connect to the USB port of a powered on computer or USB power adaptor (not included) to charge the unit.

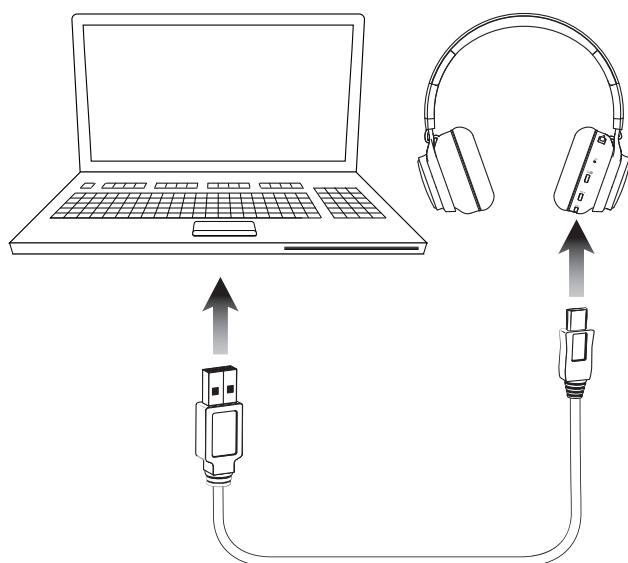

LED Indicators

Status	Indicator
Power On	Flashing Blue Light
Power Off	No Light
Charging	Solid Red Light
Charging Complete	No Light
Pairing	Flashing Red and Blue Lights

Bluetooth Wireless Audio

Pairing to a Device and Playing Audio

1. Press and hold the **Power/Pair button** on the unit for approximately **7 seconds** to power the unit on and begin pairing. The **pairing indicator** will flash red and blue. *When pairing, remain within 3 feet of the unit.*
2. Using the controls on your Bluetooth device, select **GuruGear** in your Bluetooth settings/device menu. If your device requests a password, enter the default password **0000**. *Refer to the user's manual for your specific device for instructions on pairing and connecting Bluetooth devices.*
3. When successfully paired, an audible chime will sound from the speakers and the **pairing indicator** will slowly flash blue. Audio played through the connected Bluetooth device will now be heard through the headphones.
4. Use the controls on the connected device to select and begin playing audio. Use the controls on the connected Bluetooth device or the controls on the headphones to play, pause and adjust the volume.

After initial pairing, the unit will stay paired unless unpaired manually by the user, or erased due to a reset of the device. If your device should become unpaired or you find it is unable to connect, repeat the steps listed above.

Using the Speakerphone

1. When a call is received, a ringtone will sound through the speakers.
2. Press the **Power/Pair/Play/Pause** button to accept the call or accept the call with the native controls on the connected device.
3. The incoming call received through the device will now be heard through the headphones.
4. To end the call, press the **Power/Pair/Play/Pause** button or end the call using the native controls on the connected device.

Line In

Requires a 3.5mm audio cable (included).

Note: The headphones do not have to be powered on to hear music through the Line Input. This feature can be used to conserve battery power.

1. Connect a 3.5mm audio cable to the **Line In port** on the unit and the **audio output or headphone jack** on an audio device.
2. Use the controls on the connected device to play your audio through the unit.

Federal Communications Commission notice

FCC Label

This device complies with Part 15 of the FCC Rules. Operation of this product is subject to the following two conditions: (1) this device may not cause harmful interference, and (2) this device must accept any interference received, including interference that may cause undesired operation.

This equipment has been tested and found to comply with the limits for a Class B digital device, pursuant to Part 15 of the FCC Rules. These limits are designed to provide reasonable protection against harmful interference in a residential installation. This equipment generates, uses and can radiate radio frequency energy and, if not installed and used in accordance with the instructions, may cause harmful interference to radio communications.

However, there is no guarantee that interference will not occur in a particular installation. If this equipment does cause harmful interference to radio or television reception, which can be determined by turning the equipment off and on, the user is encouraged to try to correct the interference by one or more of the following measures:

- Reorient or relocate the receiving antenna.
- Increase the separation between the equipment and receiver.
- Connect the equipment into an outlet on a circuit different from that to which the receiver is connected.
- Consult the dealer or an experienced radio/TV technician for help.

The device has been evaluated to meet general RF exposure requirement. The device can be used in portable exposure condition without restriction.

Changes or modifications not expressly approved by the party responsible for compliance with the FCC Rules could void the user's authority to operate this equipment.

FCC ID:2AH16-BT-56

MADE IN CHINA 4NN6CK000010 GuruGear™ is Distributed by Bluestem Brands Inc 6509 Flying Cloud Drive Eden Prairie, MN 55344