

## Remote Training Collar

### User manual

p-collar 680

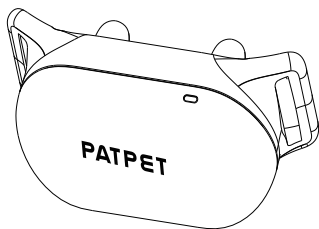

**Please read the user manual before beginning.**

## Important Safety Information

**⚠ WARNING** **Not for aggressive dogs.** Do not use this product if your dog is aggressive, or if your dog is prone to aggressive behavior. Aggressive dogs can cause severe injury and even death to their owner and others. If you are unsure whether this product is appropriate for your dog, please consult your veterinarian or certified trainer.

**⚠ CAUTION** **Safety during on-leash training.** It is vitally important that you and your dog remain safe while learning on-leash training. Your dog should be on a strong leash, long enough for him to attempt to chase an object, but short enough for him not to reach a road or other unsafe area. You must also be physically strong enough to restrain your dog when he tries to chase.

**⚠ CAUTION** **Risk of skin damage.** Please read and follow the instructions in this manual. Proper fit of the collar is important. A collar worn for too long or made too tight on the pet's neck may cause skin damage. Ranging from redness to pressure sores.

- Avoid leaving the receiver on the dog for more than 12 hours per day.
- When possible reposition the receiver on the pet's neck every 1 to 2 hours.
- Check the fit to prevent excessive pressure; follow the instructions in this manual.
- Never connect a lead to the electronic collar; it will cause excessive pressure on the contacts.
- When using a separate collar for a lead, don't put pressure on the electronic collar.

- If a rash or sore is found, stop using the collar until the injured part is healed.
- If the condition persists over 48 hours, see your veterinarian.

These steps will help keep your pet safe and comfortable. Millions of pets are comfortable while they wear stainless steel contacts. Some pets are sensitive to contact pressure. You may find after some time that your pet is very tolerant of the collar. Then, you may relax these precautions. It is important to continue daily checks of the contact area. If redness or sores are found, stop using until the skin is fully healed.

## Table of Contents

Components .....	6
Other Items you may need .....	6
Overview .....	7
<b>Operating Guide</b> .....	8
How the transmitter buttons work .....	9
Dog 1/2 button function .....	9
How to use the collar correctly .....	10
Fit the training collar .....	11
How to find the best shock level .....	12
To maximize the distance .....	13
The LCD & LED indicator .....	13
Charging the unit .....	15
How to use the test Light .....	17
<b>General Training Tips</b> .....	18
<b>Frequently Asked Questions</b> .....	19
<b>Troubleshooting</b> .....	20
<b>Warranty and Repair Information</b> .....	21
<b>Reference Size for difference Dogs</b> .....	25
<b>Reference Weight for Dogs</b> .....	25

# Components

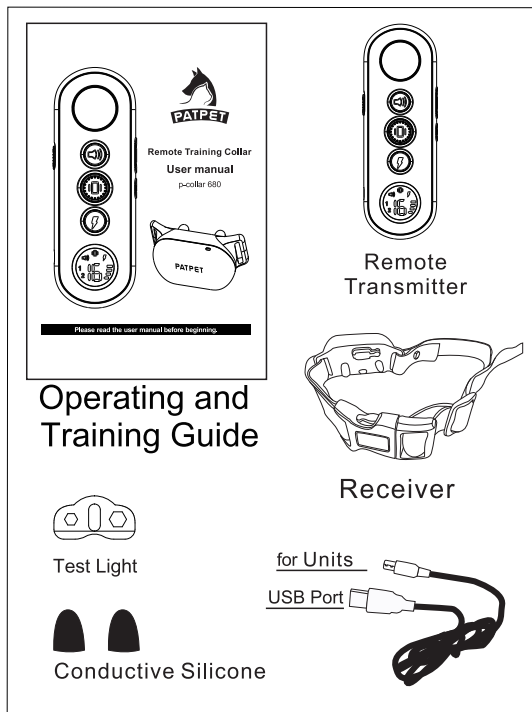

## Other Items You May Need

- Screwdriver (the Test Light can be used as a screwdriver)
- Scissors
- Lighter

# Overview

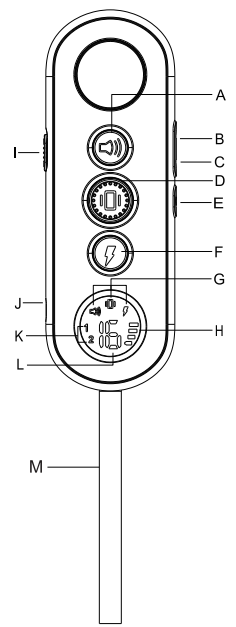

## Remote

- A. Tone Button
- B. Shock Level +
- C. Shock Level -
- D. Vibration Button
- E. On/Off Button
- F. Shock Button
- G. Mode Indication
- H. Battery Display
- I. Switch dog 1 or dog 2 mode
- J. Charging Port
- K. Dog 1 or dog 2 mode
- L. Shock Level Display
- M. String

## Receiver Collar

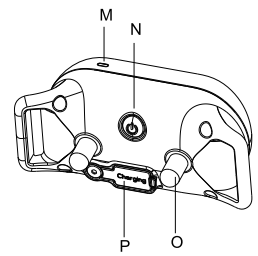

- M. LED Indicator
- N. On/Off Button
- O. Contact Points (x2)
- P. Charging Port (with cover)

# Operating Guide

## Step 1 How to turn the p-collar 680 on/off

### 1 Prepare the Remote and the Receiver

#### Turn ON/OFF the Remote

1. Long press the ON/OFF button to turn the remote ON.
2. LCD will be lighted, and show the information of current channel, battery power and levels. If not, please charge the remote.
3. Long press the ON/OFF button to turn the remote OFF.

#### Turn on the Receiver Collar

- Press the On/Off Button the Green LED light comes on.
- In normal mode, the Green LED will flash every 4 seconds, indicating the Receiver Collar is on and ready to receive a signal from the Remote.

#### Turn off the Receiver Collar

- Press long the On/Off Button until the Red LED light shuts off (This takes approximately 3 seconds).
- Release the On/Off Button.

#### NOTE:

To extend the life of the batteries, please turn the Receiver Collar off when it is not in use.

## Step 2 How the Transmitter buttons work

# 2

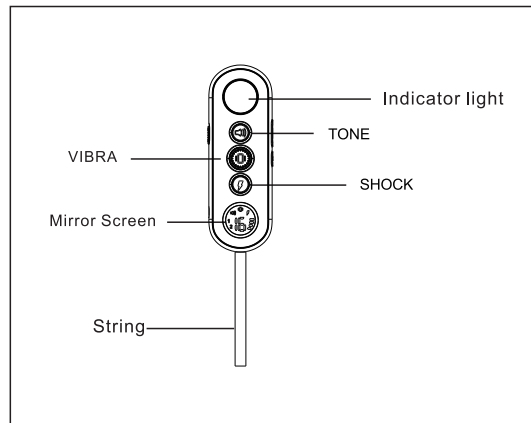

1. Press or or once to send a vibration, sound, shock command to Receiver Collar.
2. Press and hold or , Receiver Collar will have a continuous vibration/shock, It will stop automatically after 10 seconds.

**Note:** Do NOT press and hold or for long time to avoid physical or psychological hurt to the dog.

#### Dog 1/2 Button

1. Toggle once to switch between Dog 1 and Dog 2.
2. Press " " to adjust Shock Level from 1-16.

## Step How to use the collar correctly

# 3

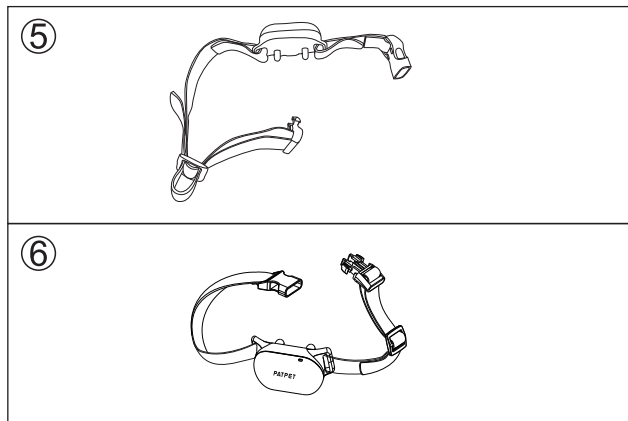
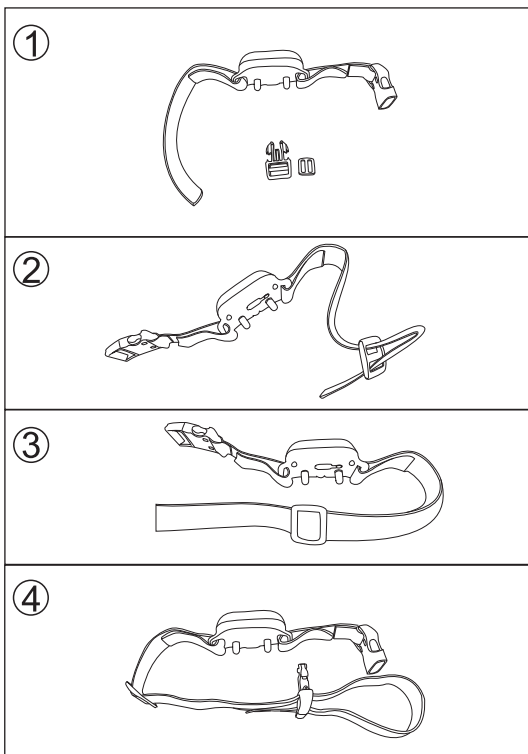

## Step Fit the Training Collar

# 4

Remark: The proper fit and placement of your training collar is important for effective operation. The contact points must directly touch the neck skin of your dog.

1. Start with the collar turned off and your dog standing comfortably, not sitting(A).
2. Put the receiver collar directly under the chin of your dog. Make sure both the contact points are in the center of your dog's neck and contacted his neck.

**NOTE:** Sometimes it's necessary to trim the hair around the contact points to make sure that contact is consistent. We've also included longer contact points.

## CAUTION

Do not shave the pet's neck as this may increase the risk of skin irritation. The training collar should not be worn for more than 12 hours each day. Leaving the training collar on too long could lead to skin irritation. Remove the collar when you're not training your dog.



## Step To maximize the distance

# 6

The range may vary depending on the way of the Transmitter being held. Hold the Transmitter away from your body to receive the greatest range. For maximum signal strength, keep the device properly charged.



Maximum range



Typical range



Minimum range

\*Avoid touching the antenna, as the range may decrease substantially.

## Step How to find the best shock level

# 5



The unit comes with Up and Down buttons to control the Shock Level, with Level 1 being the lowest level for Shock and Level 16 being the highest for Shock.

Better adjust the Shock level suitable for your dog according to his acceptance limitation for shock. Always start at the lowest level and work your way up.

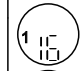
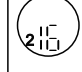

The appropriate level can be found when the dog responds to the Shock with a mild reaction, such as a tensing of the neck muscles. The Shock Level may vary depending on the training situation. When highly distracted, dogs will require a higher level of Shock.

## Step The LCD & LED indicator

# 7

	Indicates Shock levels ranging from 1-16, Appears in the right lower part.
 	Indicates the active dog receiver. Appears in the left part.
	Indicates battery's power level. Note: The battery icon will flash when battery is low.

## Transmitter LED Indicator Light – Function and Response

Button	Button Function	Transmitter Indicator Light Responses
	Delivers audible tone to collar (volume cannot be adjusted)	Green
	Delivers vibration to collar. (vibration will pause if keep pressing for more than 10 seconds)	Orange
	Delivers shock to collar base on current level (shock will pause if keep pressing for more than 10 seconds)	Red

## Receiver Indicator Light – Function and Response

Receiver Collar Function	Green LED Response
Power On	Flashes once
Normal Operation - Good battery	Flashes once every 5 seconds.
Tone	While pressed, light flashes green.
In Pairing Mode	Flashes once every second for 15 seconds.
Complete Pairing	Flashes rapidly for 3 times.
Complete Charging	Light stays green.
Receiver Collar Function	Red LED Response
Power Off	Flashes red for 3 times.
Normal Operation - Low battery	Flashes red rapidly till auto power-off
Vibration/Shock	While button is pressed, the light flashes red.
Charging	The light stays red

## Step Charging the unit

8

The unit uses Lithium-Polymer batteries.

1. Charge the unit for 4 hours before using the first time.
2. Do not charge the unit near any flammable substance.
3. Charging the unit full firstly if the device has been left unused more than 3 months.