

**F I I L**®

THE ART OF AUDIO

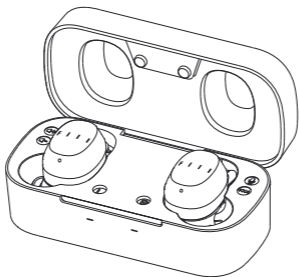

**F022**

**F I I L T1 X**

**TRUE WIRELESS EARBUDS**

---

**USER MANUAL**

# **Important Safety Instructions**

Please read the following safety instructions carefully before using this product. Please make sure to include these safety instructions with the product when deliver to a third party.

## **Health and safety**

- Do not use the product in case it is apparently damaged;
- Do not use the product at a high volume level for an extended period of time;
- Do not use the product while driving or being engaged in activities that require full concentration;
- Keep the product, its packaging and accessories out of the reach of children and pets to avoid choking hazard;
- Keep the product away from medical devices that may be affected by magnetic field, such as an implanted cardiac pacemaker.

## **Product care**

- Keep this product dry and at room temperature, avoid long time exposure to high temperature or humidity environments;
- Use accessories only provided by fiil;
- Excessive signal level may cause damaging overload;
- Clean the product only with dry and soft cloth.

## **Battery warning!**

The product uses lithium polymer battery. Improper usage may lead to the risk of fire or burn. Please use the charger only supplied by qualified manufacturer (recommended output: voltage 5V, current ~500mA) or charge the product via PC USB port.

## **Specification and disclaimer**

- The product is designed for portable devices and high-fidelity systems;
- Any usage other than those specified in the user manual is deemed as misuse;
- Please note that FIIL will accept no responsibility for any loss incurred by misuse.
- FIIL T1 X is designed by Fengfan(Beijing) Technology Co., Ltd. and made by Fengfan(Suzhou) Audio Tech. Co., Ltd.
- ‘FIIL’ is a registered trademark<sup>®</sup> of Fengfan (Beijing) Technology Co., Ltd.

# Packaging Content

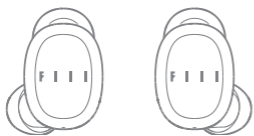

**Earbuds X2**  
(L/R)



**Charging Case X1**



**Earwings X3**  
L/M/S



**Eartips X4**  
L/M/S/XS



**Type C Charging  
Cable X1**

# Main User Interfaces

## ● Earbud

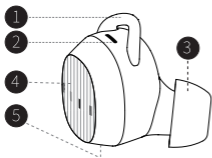

1 Earwing

2 LED indicator

3 Eartip

4 Touch control

5 Microphone

## ● Charging Case

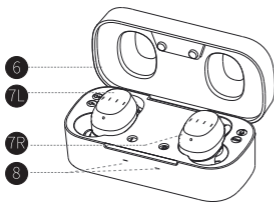

6 Charging Case Cover

7L Left earbud

7R Right earbud

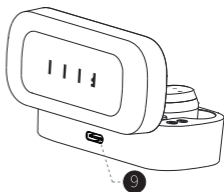

8 Charge indicators

9 Type C connector

# Get Started

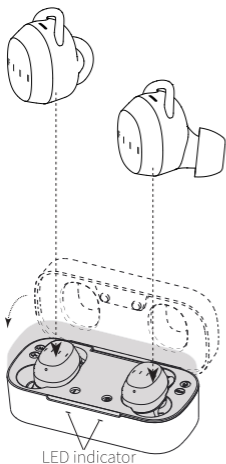

- **STEP1**  
Put earbuds into charging case and close the cover. Please connect USB cable to charge more than 10min if charging case's LED does not light on.

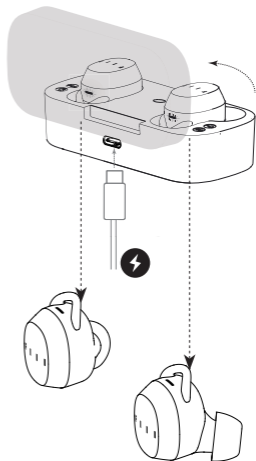

- **STEP2**  
Open the charging case then earbuds will automatically get sync and enter pairing mode without any manual operation

\*Notes : Please charge the charging case via USB adapter in advance.

# Bluetooth Pairing

## ● Bluetooth pairing

For first usage of brand new FIIL T1 X, please refer to page5 “Get Started”, the earbud status indicator will continue to blink blue once entered pairing mode.

To begin a new bluetooth pairing, please press and hold any one of earbuds until the LED indicator blinks blue, when the earbuds are turned off.

## ● Search Connection

Enter setup menu of audio source devices, select “search device” in “Bluetooth” then select “FIIL T1 X” in the device list to connect.

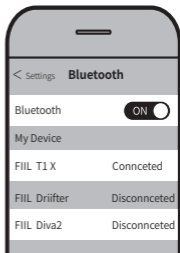

# Earbuds Sync

## ● Auto-Sync

Please refer to page5 “Get Started”, the left and right earbuds will automatically get synced after Step2.

## ● Manual Sync



### Step 1 - Power Off earbuds

Press and hold both earbuds at the same time, do not release your fingers until both red lights are on.

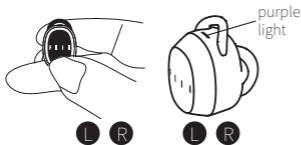

### Step 2 - Reset Sync

Press and hold the earbuds again, do not release your fingers until the purple light comes on.  
Note: Please hold your finger until purple light and ignore all other lights during above process.

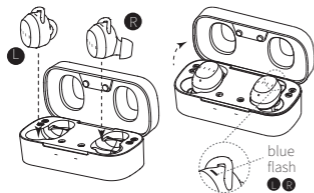

### Step 3 - Reconnect bluetooth

① Put earbuds back in the charging case and close it;  
② Delete the "FIIL T1 X" in your bluetooth device list;  
③ Repeat the "Search Connection" in Bluetooth Pairing(Page 6).  
\*Notes: If a purple light comes on in earbud during ③, please **do not** connect Bluetooth but repeat ① and wait a little longer, or repeat "Step 2 -Reset Sync".



# How to Control

## ● User Interface

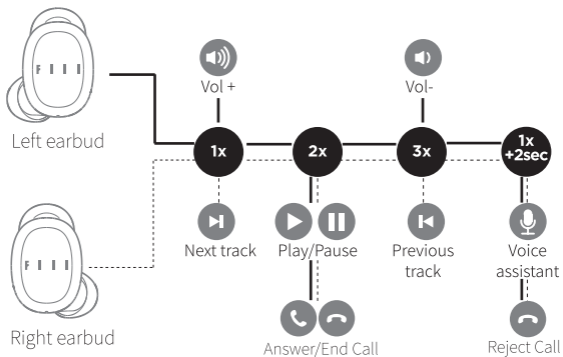

Left earbud

Right earbud

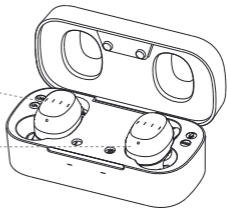

# How to charge

## ● Charge earbud

- When earbud reminds “recharge headset” or the LED indicator blinks red , that means battery is low and earbud should be charged.
- Place the earbuds into charging case and close, then earbud will be charged.

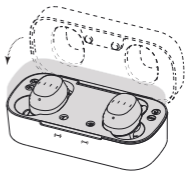

\*Notes: Earbud will power off during charging.

## ● Charging Case indicator

- When the red LED indicator (left or right) is on, it means the corresponding earbud is being charged .
- When the red LED indicator is off, it means the corresponding earbud is fully charged .

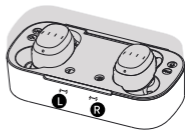

# How to charge

## ● Recharge Charging Case

- When charging case is not able to charge earbud or its LED indicator blinks red, it means battery low and charging case should be recharged.
- Please connect Type C cable with USB adapter to recharge charging case.

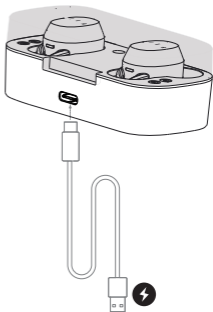

## ● Charging Case indicator

- When both red LED indicators are light on, it means the charging case is being charged.
- When both red LED indicators are light off, it means the charging case and earbuds are fully charged.



# Product Parameters

Item	Specifications
Earbud weight	~4.8g/each
Charging case weight	~40g
User Mode	Bluetooth True Wireless
Bluetooth	BT range: up to 30m. Pairing code: 0000. iOS and Android devices supported.
Audio specification	Supported Code: AAC (for iOS) /SBC; Speaker specifications: $\phi$ 6.1mm, frequency range: 15Hz-22kHz
Power and battery	Rechargeable lithium-polymer battery; music time: up to 6 Hrs (medium level) on a single charge; Bluetooth standby time: up to 6 days ; charging time: ~ 40 minutes. Charging case: add 3 more charge cycle (18Hrs+)
Operating environment	Operating temperature: 0°C~50°C; storage temperature: -30°C to 70°C; IEC60529-IP65 Certified(earbuds)
Voice reminder	English

# Warranty and Services



## **FIIL guaranteed: One Year Warranty for quality issues**

Scan the QR code above with mobile phone to download fiil+ APP(FAQ inside). Enter information to register device. Contact the customer service for any quality issue via fiil+/Facebook/ Twitter service account ( 'Fiil Headphone' ) /email customer@fiil.com

# Trouble Shooting

Problem	What to do
Earbuds don't turn on	<ul style="list-style-type: none"><li>• Power on the earbuds .</li><li>• Charge the battery.</li></ul>
Earbuds don't pair with Bluetooth device	<ul style="list-style-type: none"><li>• On your Bluetooth device:<ul style="list-style-type: none"><li>-- Turn the Bluetooth feature on and then off.</li><li>-- Delete your Fiil T1 X Earbuds from the Bluetooth list on your device. Pair again.</li></ul></li><li>• Move your Bluetooth device closer to the earbuds and away from any interference or obstructions.</li><li>• Pair a different Bluetooth device.</li></ul>
No sound	<ul style="list-style-type: none"><li>• Power on the earbuds and charge the battery.</li><li>• Increase the volume on your earbuds and Bluetooth device.</li><li>• Press the Power/Bluetooth button to hear the connected device. Make sure you are using the correct device.</li><li>• Move your Bluetooth device closer to the earbuds and away from any interference or obstructions.</li><li>• Use a different music source.</li><li>• Pair a different Bluetooth device.</li><li>• If two Bluetooth devices are connected, pause the first device and play the other device.</li></ul>

Problem	What to do
Poor sound quality	<ul style="list-style-type: none"> <li>• Use a different music source.</li> <li>• Pair a different Bluetooth device.</li> <li>• Disconnect the second device.</li> <li>• Move the Bluetooth device closer to the headphones, and away from any interference or obstructions.</li> <li>• Clear any debris or wax buildup from the earbuds and headphone nozzles.</li> </ul>
Earbuds don't charge	<ul style="list-style-type: none"> <li>• Open the USB connector and securely connect the small end of the USB cable to the USB connector. Make sure the connector on the cable is correctly aligned with the connector on the headphones.</li> <li>• Secure both ends of the USB cable.</li> <li>• If your earbuds have been exposed to high or low temperatures, let the earbuds return to room temperature and then try charging again.</li> </ul>



## FCC and IC COMPLIANCE STATEMENT

This device complies with Part 15 of the FCC Rules and Industry Canada License-exempt RSS standard(s).

Operation is subject to the following two conditions:

1. This device may not cause harmful interference, and
2. This device must accept any interference received, including interference that may cause undesired operation.

This equipment has been tested and found to comply with the limits for a Class B digital device, pursuant to Part 15 of the FCC Rules / with Canadian ICES-003. These limits are designed to provide reasonable protection against harmful interference in a residential installation. This equipment generates, uses, and can radiate radio frequency energy and, if not installed and used in accordance with the instructions, may cause harmful interference to radio communications.

However, there is no guarantee that interference will not occur in a particular installation. If this equipment does cause harmful interference to radio or television reception which can be determined by turning the radio or television off and on, the user is encouraged to try to correct interference by one or more of the following measures:

1. Reorient or relocate the receiving antenna.
2. Increase the separation between the equipment and receiver.
3. Connect the equipment into an outlet on another circuit.
4. Consult the dealer or an experienced radio/TV technician for help.

## CAUTION STATEMENT

Any changes or modifications not expressly approved by the party responsible for compliance could void the user's authority to operate the equipment.





Correct disposal of This Product (Waste Electrical & Electronic Equipment)

(Applicable in the European Union and other European countries with separate collection systems)

This marking shown on the product or its literature indicates that it should not be disposed with other household wastes at the end of its working life.

To prevent possible harm to the environment or human health from uncontrolled waste disposal, please separate this from other types of wastes and recycle it responsibly to promote the sustainable reuse of material resources. Household users should contact either the retailer where they purchased this product, or their local government office for details of where and how they can take this item for environmentally safe recycling.

Business users should contact their supplier and check the terms and conditions of the purchase contract.

This product should not be mixed with other commercial wastes for disposal.



#### **CAUTION**

Risk of explosion if battery is replaced by an incorrect type.  
Dispose of used batteries according to the instructions.



To prevent possible hearing damage, do not listen at high volume levels for long periods.



#### **CE Mark Warning**

RF Exposure Information

The device meets the EU requirements (1999/519/EC) on the limitation of exposure of the general public to electromagnetic fields by way of health protection.

Note: The maximum average emitted power of the device is less than 20mW.

FCC Radiation Exposure Statement:

The device has been evaluated to meet general RF exposure requirement . The device can be used in portable exposure condition without restriction.