

## Main User Interfaces

### ● Earphones

#### ● L Left earphone (slave)

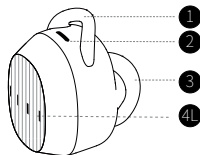

- 1 Earwing
- 2 LED indicator
- 3 Eartip

#### ● R Right earphone (master)

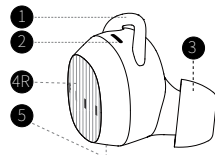

- 4L Touch control (slave)
- 4R Touch control (master)
- 5 Microphone

### ● Charging Case

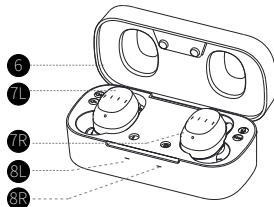

- 6 Charging Case Cover
- 7L Left earphone (slave)
- 7R Right earphone (master)

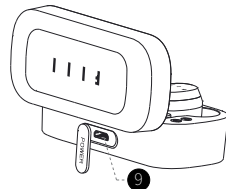

- 8L Charge indicator (slave)
- 8R Charge indicator (master)
- 9 Micro USB connector

# Get Started

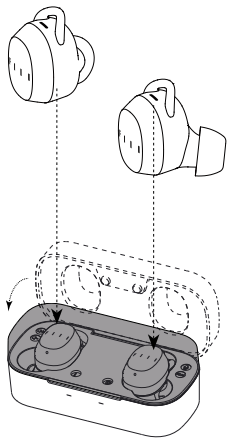

- **STEP1**  
Put earphones into charging case and close the cover.

\*Notes :  
Please charge the charging case via USB adapter in advance.

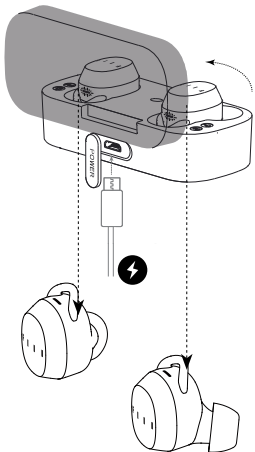

- **STEP2**  
Open the charging case then earphones will automatically get sync and enter pairing mode.

# Bluetooth Pairing

- **Bluetooth pairing**

For first usage of brand new FIIL T1, please refer to page5 “Get Started”, the earphone status indicator will continue to blink blue once entered pairing mode.

To begin a new bluetooth pairing, please press and hold the master earphone (right earphone) until the LED indicator blinks blue.

- **Search Connection**

Enter setup menu of audio source devices, select “search device” in “Bluetooth” then select “FIIL T1” in the device list to connect.

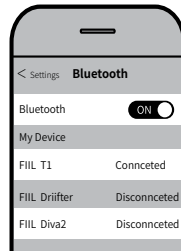

# Bluetooth Sync

## ● Auto-Sync

Please refer to page5 “Get Started”, the left and right earphones will automatically get synced after Step2.

## ● Manual Sync

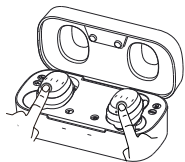

### 1st Step

Place the earphones into charging case , press and hold both earphones untill power off (LED indicates red then off).

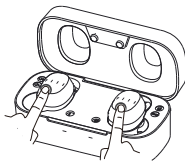

### 2nd Step

Press and hold both earphones again untill their LED indications light purple.

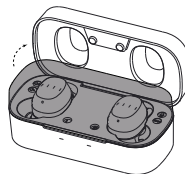

### 3rd Step

Close charging case then open again, the earphones will automatically get synced with flashing purple LED.

# How to Control

## ● User Interface

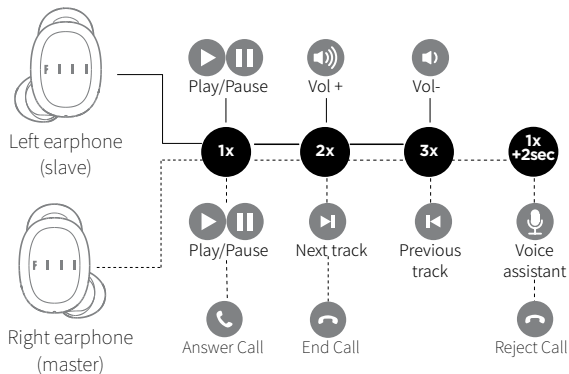

Left earphone (slave)

Right earphone (master)

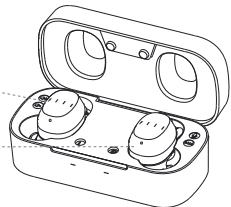

# How to charge

## ● Charge earphone

- When earphone reminds “recharge headset” or the LED indicator blinks red , that means battery is low and earphone should be charged.
- Place the earphone into charging case and close, then earphone will be charged.

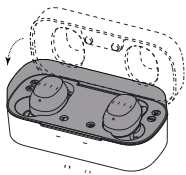

\*Notes: Earphone will power off during charging, so the left earphone (slave) can not be singly used if right earphone is being charged.

## ● Charging Case indicator

- When the red LED indicator (left or right) is on, it means the corresponding earphone is being charged .
- When the red LED indicator is off, it means the corresponding earphone is fully charged .

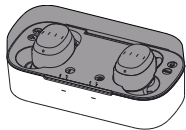

# How to charge

## ● Recharge Charging Case

- When charging case is not able to charge earphone or its LED indicator blinks red, it means battery low and charging case should be recharged.
- Please open USB door at rear side of charging case, connect Micro USB cable with USB adapter to recharge charging case.

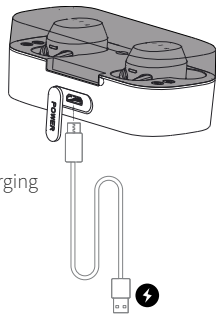

## ● Charging Case indicator

- When both red LED indicators are light on, it means the charging case is being charged.
- When both red LED indicators are light off, it means the charging case and earphones are fully charged.



## FCC Statement

Any Changes or modifications not expressly approved by the party responsible for compliance could void the user's authority to operate the equipment.

This device complies with part 15 of the FCC Rules. Operation is subject to the following two conditions:

- (1) This device may not cause harmful interference, and
- (2) This device must accept any interference received, including interference that may cause undesired operation.

## RF warning for Portable device:

The device has been evaluated to meet general RF exposure requirement.

The device can be used in portable exposure condition without restriction.